

PARTS & SERVICE NEWS

REF NO.	A910070A
DATE	Aug. 5, 1992

This **PARTS & SERVICE NEWS** supersedes the previous issue No. A910070 dated March 15, 1991. Thus, the previous issue should be discarded.

SUBJECT: NEW HYDRAULIC PUMP ON WA200-1, WA250-1 AND WA250-1LC

PURPOSE: To introduce the new hydraulic pump

APPLICATION: *WA200-1 Wheel Loaders,
Serial Nos. 10001 thru 19999, 20001 thru 2999, 30002 thru 30524

WA250-1 Wheel Loaders, Serial Nos. 10001 thru 12355
WA250-1LC Wheel Loaders, Serial Nos. A65001 thru A65140, A65141 thru A65151

DESCRIPTION:

1. Introduction

The new heat-resistant (proof temperature 120°C) hydraulic gear pumps model *SAL(2)32+32 and SAL(2)50+16 for WA200 and model SAL(2)50+25 for WA250 have become available.

*Applicable Serial Numbers of hydraulic gear pump models SAL(2)32+32 and SAL(2)50+16 to WA200-1 machines are as follows:

Pumps SAL(2)32+32	Serial Nos. 10001 thru 19999
Pumps SAL(2)50+16	Serial Nos. 20001 and up

2. Detail of modification and correspondence of current and new part numbers to each other

- 1) The sealing parts ④ ⑤ ⑥ ⑦ ⑧ ⑨ shown in Fig. 1 have been changed from standard specification (proof temp. 100°C) to heat-resistant specification (proof temp. 120°C).
- 2) The correspondence of current and new part numbers is as shown in Table 1, Table 2 and *Table 3. Change of sealing parts numbers is accompanied by changes of pump ass'y part number and pump sub-ass'y part number.

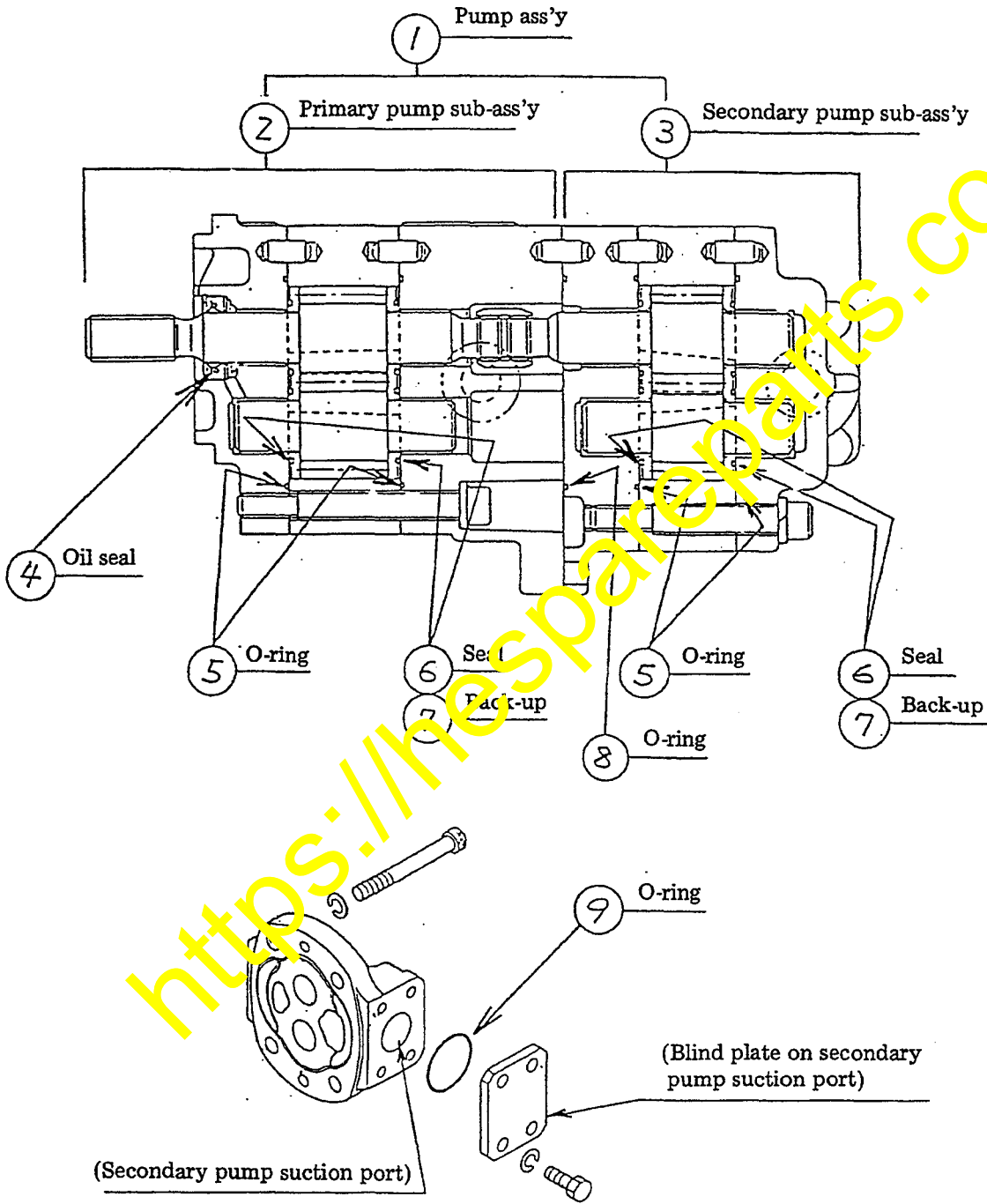

Fig. 1

* Table 1 Current Part No. vs. New Part No. for SAL(2)32 + 32 pump on WA200
Applicable machine Serial Nos. 10001 thru 19999

No.	Part Name	Current (Std. specification)	New (Heat resistant)
①	PUMP ASS'Y	705-51-20150	705-51-20400
②	PRIMARY PUMP SUB-ASS'Y	705-11-30210	705-11-30240
③	SECONDARY PUMP SUB-ASS'Y	705-11-30530	705-11-30540
④	OIL SEAL	705-17-02810	705-17-02830
⑤	O-RING	705-17-02381	705-17-02360
⑥	SEAL	705-17-02472	705-17-02460
⑦	BACK-UP	705-17-02440	705-17-02430
⑧	O-RING	705-17-02480	705-17-02420
⑨	O-RING	07000-03038	07000-33038

Table 2 Current Part No. vs. New Part No. for SAL(2)50 + 16 pump on WA200
Applicable machine Serial Nos. 20001 thru 30624

No.	Part Name	Current (Std. specification)	New (Heat resistant)
①	PUMP ASS'Y	705-51-20090	705-51-20290
②	PRIMARY PUMP SUB-ASS'Y	705-11-34210	705-11-34250
③	SECONDARY PUMP SUB-ASS'Y	705-13-24530	705-13-24540
④	OIL SEAL	705-17-02810	705-17-02830
⑤	O-RING	705-17-02381	705-17-02360
⑥	SEAL	705-17-02472	705-17-02460
⑦	BACK-UP	705-17-02440	705-17-02430
⑧	O-RING	705-17-02480	705-17-02420
⑨	O-RING	07000-03038	07000-33038

Table 3 Current Part No. vs. New Part No. for SAL(2)50 + 25 pump on WA250

No.	Part Name	Current (Std. specification)	New (Heat resistant)
①	PUMP ASS'Y	705-51-20240	705-51-20300
②	PRIMARY PUMP SUB-ASS'Y	705-11-34210	705-11-34250
③	SECONDARY PUMP SUB-ASS'Y	705-13-24530	705-13-28540
④	OIL SEAL	705-17-02810	705-17-02830
⑤	O-RING	705-17-02381	705-17-02360
⑥	SEAL	705-17-02472	705-17-02460
⑦	BACK-UP	705-17-02440	705-17-02430
⑧	O-RING	705-17-02480	705-17-02470
⑨	O-RING	07000-03038	07000-30038

3. Identification of New Pump

The new pump can be discriminated from current pump by referring to the identification mark located at the position shown in the illustration below.

