

PARTS & SERVICE NEWS

REF NO.	A920105
DATE	July 21, 1992

SUBJECT: NEW BELT TENSION PULLEY STOPPER ON WA700-1 (FOR SA6D170 ENGINE)

PURPOSE: To introduce a new improved type tension pulley stopper for the SA6D170 engine

APPLICATION: WA700-1 Wheel Loaders - Serial Nos. 10001 thru 10083
(Engine Serial Nos. 13342 thru 15289)

DESCRIPTION:

1. Introduction

If the tension pulley stopper for the subject engine is worn out or damaged, repair should be made according to this **PARTS & SERVICE NEWS**.

<https://hespareparts.com/>

2. Parts required for the repair

Part No.	Part Name	Q'ty	Purpose of part	Remarks
6162-63-3402 (6162-63-5300)	Ten. pulley ass'y (Ten. pulley ass'y)	1 (1)	Replacement	Components of Ten. pulley ass'y
6162-63-3411 (6162-63-5310)	Bracket, ten. (Bracket, ten.)	1 (1)		
6162-63-3460 (6162-63-5320)	Spring, ten. (Spring, ten.)	1 (1)		
07020-00000 (07020-00675)	Nipple (Nipple)	1 (1)	Addition	
6162-63-5330	Bracket	1	Replacement	
01011-31470 (01011-31455)	Bolt (Bolt)	2 (1)	Disused	
(01011-31460)	(Bolt)	(1)	Addition	
01643-31445 (01643-31445)	Washer (Washer)	2 (1)	Disused	
(01602-01442)	(Washer)	(1)	Replacement	
6162-63-5340 (6162-63-5350)	Screw (Screw)	1 (1)	Disused	
01580-11613 (01583-01610)	Nut (Nut)	1 (3)		
(6164-61-3780)	(Washer)	(1)	Disused	
(01643-31645)	(Washer)	(1)		
(04210-21664)	(Yoke)	(1)		
(04205-11645)	(Pin)	(1)		
(01641-21626)	(Washer)	(1)		
(04050-14028)	(Pin)	(1)		

<https://mespareparts.com/>

3. Outline of the improvement

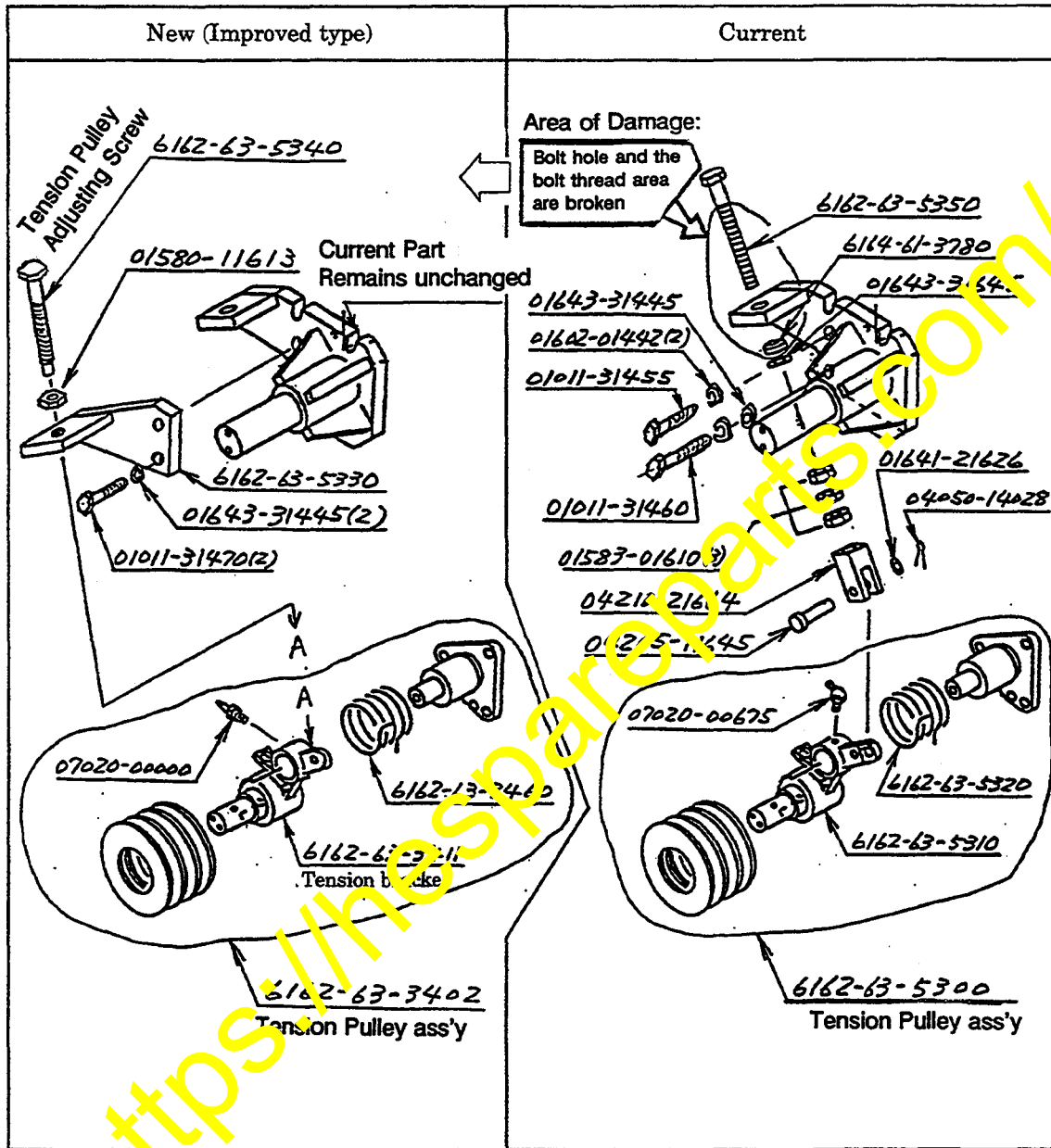

The belt slip sound preventive unit is modified entirely. Thereby, the breakage of the adjusting screw and its hole caused by the belt stretch is prevented.

4. Repair procedure

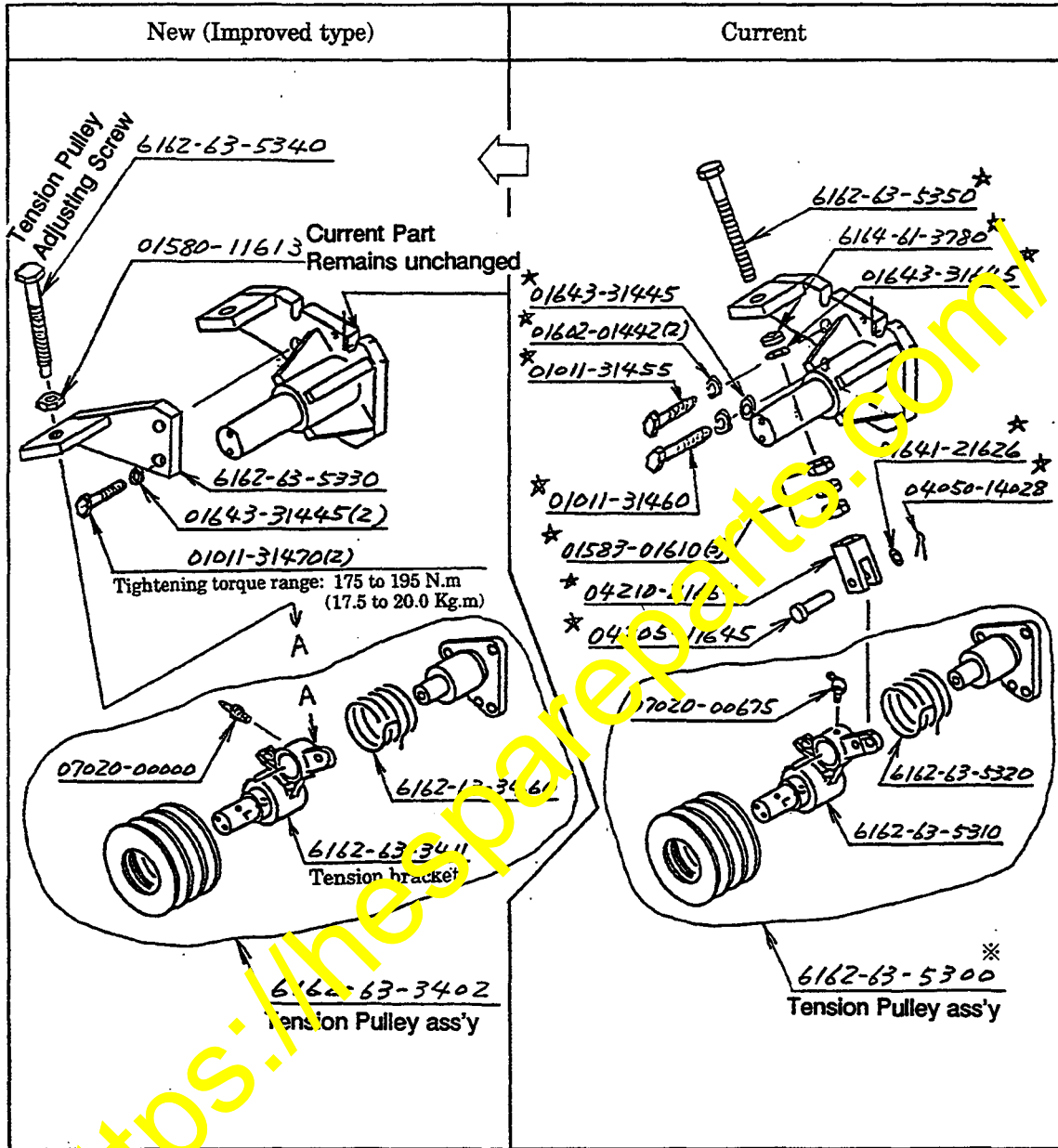

- 1) Remove the V-belt from the tension pulley.
- 2) Parts marked with a ☆ are those installed for prevention of the belt slip sound.
- 3) Remove the tension pulley ass'y marked ※.
- 4) Install a new tension pulley (6162-63-3402).
- 5) Install a new bracket (6162-63-5330).
- 6) Temporarily install a new adjustable screw (6162-63-5340).
- 7) Assemble the V-belt to the tension pulley.

- 8) Turn in the screw until its tip comes in contact with the tension pulley lever. Then, further turn it in by 1/2 turn and lock the screw firmly with the locknut.

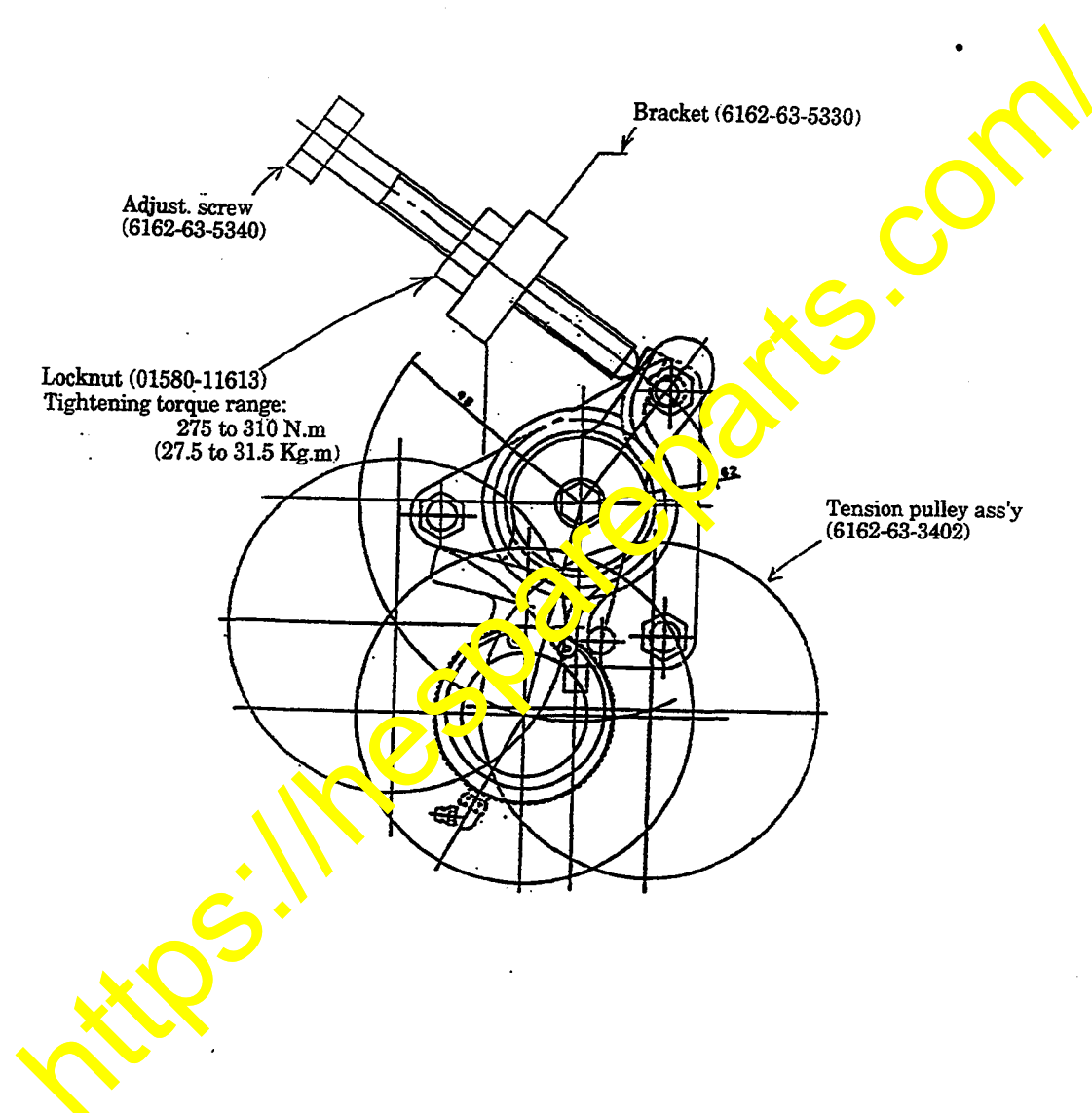

- 9) If clearance is encountered between the tension pulley lever and the adjusting screw tip, re-adjust in the same manner as described above.

<https://hespareparts.com/>