

PARTS & SERVICE NEWS

REF NO.	AA00047A
DATE	05, May 2000

This Parts and Service News supersedes the previous issue AA00047 dated March 27, 2000. The previously issued Parts and Service News should be discarded.

SUBJECT: TRANSMISSION PUMP IMPROVEMENT KIT AK4520

PURPOSE: Inform customers of improved pump

APPLICATION: 530M prior to S/N A30036

FAILURE CODE: J11099

DESCRIPTION:

A new transmission pump improvement kit (AK4520) has been introduced for the 530M truck. This pump has changes internally, but is still interchangeable at the mount of the torque converter drive. Efficiency is the same, but noise is reduced inside the operator's cab. The new pump (10, Figure 1) is built with a 10 tooth / lobe design that is quieter and produces less vibration than the original pump.

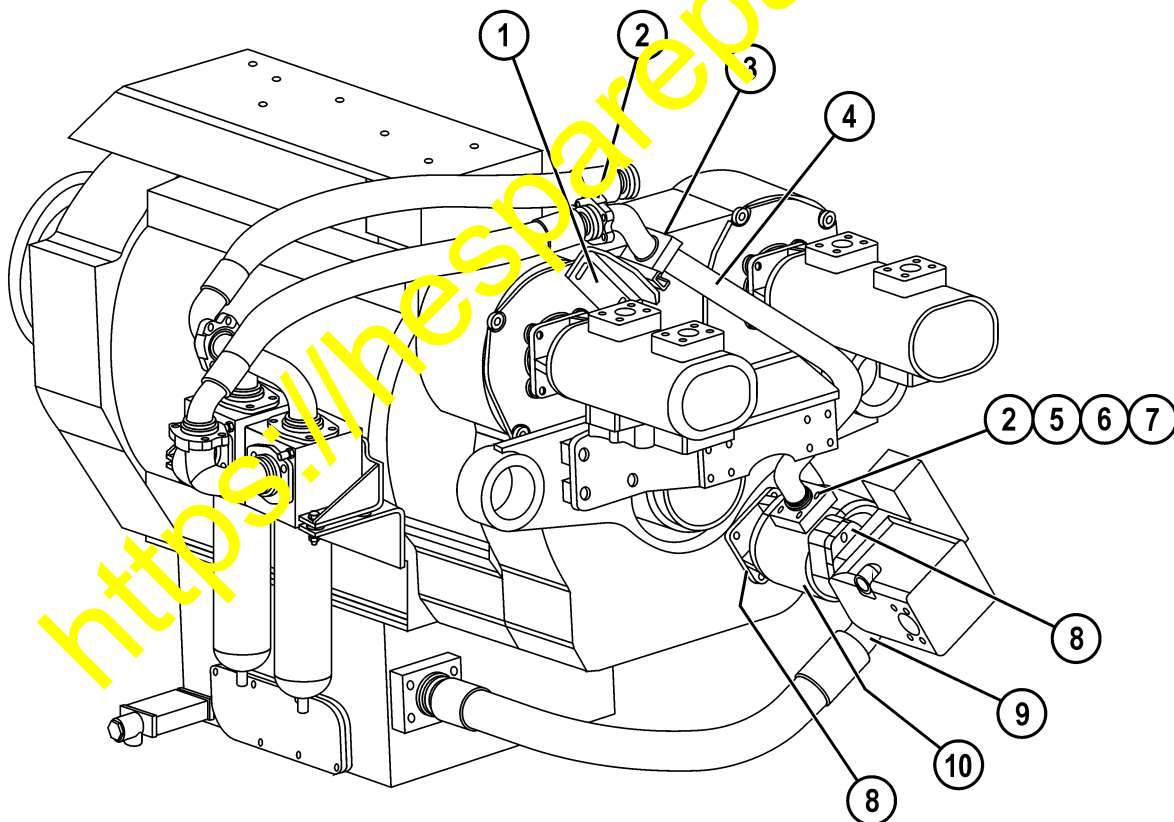

Figure 1. Transmission Pump Improvement Kit (AK4520)

70324

TRANSMISSION PUMP IMPROVEMENT KIT (AK4520)			
REF. NO.	QTY.	PART NO.	DESCRIPTION
1	1	EH3533	CLAMP STR
2	2	WA3206	O-RING
3	1	WA4712	CLAMP
4	1	EH3620	TUBE STR
5	2	300525R1	FLANGE, HALF CLAMP
6	4	C1540	LOCK WASHER
7	4	C1614	CAPSCREW
8	2	877690C1	O-RING
9	1	WA3207	O-RING
10	REF.	PC0773	TRANSMISSION PUMP (ORDER SEPARATELY)
	1	EJ1180	REFERENCE DRAWING

NOTE: CONTACT KMS PARTS DEPARTMENT FOR AVAILABILITY OF THE ABOVE PARTS.

INSTALLATION OF PUMP

1. Using a new O-ring, lift pump into position on PTO mounting studs. Install hardened flatwashers and nuts. Tighten nuts evenly to standard torque.
2. Using new O-rings on flange fittings, install suction hoses and outlet hoses. Install capscrews and lockwashers but do not tighten.
3. Refill the hydraulic tank.
4. Loosen suction hose flange clamps until air is discharged from lines. Tighten all hose flange clamp capscrews to standard torque.

When the new transmission pump is installed, ensure the pump is charged with oil before starting the unit. Crank engine over without starting while bleeding any trapped air out of the lines. **NOTE: A new filter should be installed every 500 hours or during the replacement of the transmission pump.**

The drive coupling between the transmission pump and steering pump should be inspected for any wear or damage when installing pumps. When installing the new tube (4, Figure 1), brackets and clamps must be inspected and replaced if worn or damaged. **NOTE: Cap or cover lines and openings to prevent contamination of the hydraulic system.**

After assembly is complete, insure that:

1. No leaks occur.
2. Proper oil level is in the transmission.
3. Filtration is working without bypassing.
4. Transmission shifts normally F1 through F7 and reverse.
5. All covers are installed.
6. Re-check of oil level is done after running shifting check.