

# PARTS & SERVICE NEWS

REF NO.	AA00061
DATE	May 26, 2000

**SUBJECT:** REVISED ECSS LOW PRESSURE ACCUMULATOR

**PURPOSE:** To improve absorption of shock absorber.

**APPLICATION:** WA450-3L Wheel Loader Serial Number A30001 and Up

**FAILURE CODE:** RXB099

**DESCRIPTION:** Delete spacer in accumulator. Piston stroke changed from 170.5 to 262.5.

## INTRODUCTION:

This Parts and Service News is to release the new accumulator and all service parts for the new assembly. It is also to advise the field that the old assembly service parts will remain available. Distributors should order a new accumulator if a complete accumulator is required. Additional changes include the removal of a spacer in the accumulator. As a result, the piston stroke changes from 170.5 to 262.5. This is to improve the absorption of shock absorber.

## PREPARATIONS FOR WORK:

**IMPORTANT** - Please observe all safety and precautionary standards as dictated by the environment and work conditions under which the equipment will be inspected, reworked, and repaired. Consult the **WA450-3L Shop Manual** and your **KOMATSU** Customer Support Distributor Development Manager with any/all questions regarding safety.

1. Park the machine on a flat level surface, lower the boom and bucket to the ground, shut off the engine and cycle the controls to remove any residual hydraulic pressure from boom and bucket circuits. Fully apply the parking brake.
2. Place chocks at the front and rear of all wheels to prevent machine movement.
3. Remove the key from start switch and retain it until this repair has been completed. Place a tag on the steering wheel advising: "**This machine is being repaired. It should not be started or moved for any reason until this tag is removed by the person doing repairs**".

**REQUIRED PARTS:**

Index	Part Number	Description	Qty.	Remarks
1	721-07-12121	Accumulator Assembly	1	
2	721-29-14010	Top Cover	1	
3	721-10-15010	Cylinder	1	
4	721-36-15010	Piston	1	
5	721-47-12110	Packing	1	
6	721-88-12110	Back-up Ring	1	
7	721-47-12120	Packing	1	
8	792-610-1700	Charging Tool	1	Not Illustrated

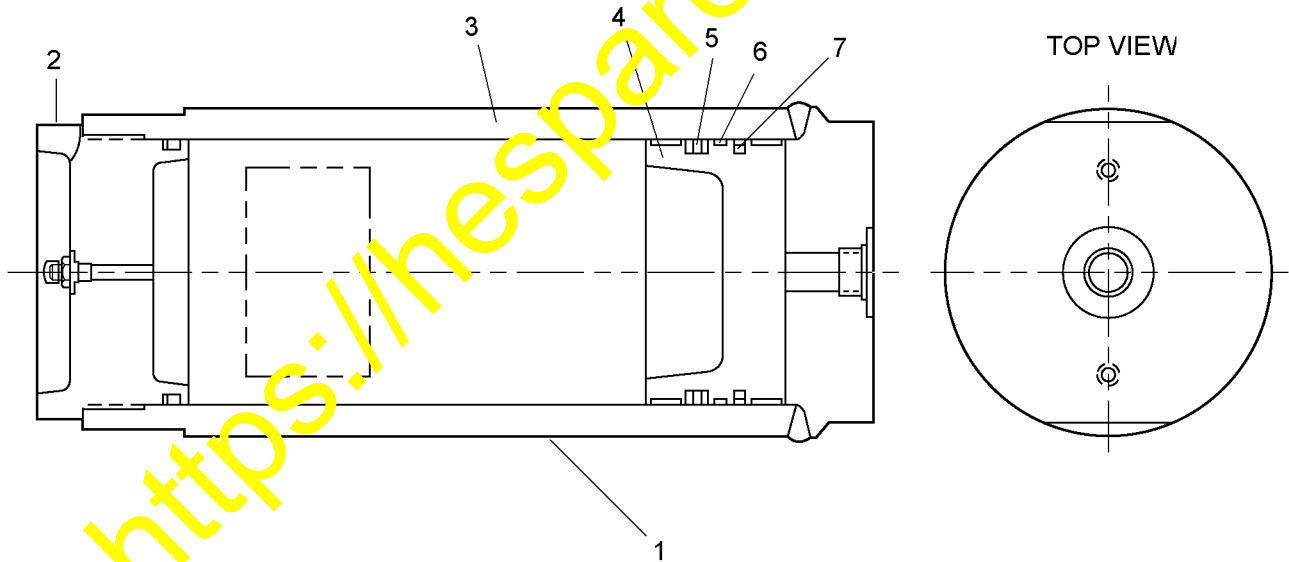

VLPS0038

Fig. 1 New Accumulator (P/N 721-07-12121)

**ACCUMULATOR CHARGING INSTRUCTIONS:**

1. Connect hose to charging valve and nitrogen bottle.
2. Hand tighten charging valve to top of accumulator.
3. Open valve on top of nitrogen bottle.
4. Turn T-handle on top of charging tool clockwise to open charging valve in accumulator.
5. Read nitrogen pressure on gauge.
6. Reverse T-handle when gauge reads desired pressure.
7. Wait several minutes for nitrogen pressure to stabilize, then repeat steps 4, 5, and 6.
8. After T-handle is completely reversed, close the valve at nitrogen bottle.
9. Vent pressure in hose by opening bleeder valve.
10. Remove charging valve and replace gas valve guard.

<https://hespareparts.com/>