

PARTS & SERVICE NEWS

REF NO.	AA00063
DATE	May 8, 2000

SUBJECT: CHANGE IN POSITION LIMIT SWITCH.

PURPOSE: The locally supplied position switch used for boom and bucket was superseded by 363-06-31121, which is functionally similar but waterproof.

APPLICATION: WA120-3L Wheel Loader Serial Number A30001 through A30058.
WA180-3L Wheel Loader Serial Number A80001 through A802043.
WA180-3PTC Wheel Loader Serial Number A85001 through A85058
WA250-3L Wheel Loader Serial Number A70001 through A70273.
WA250-3PTC Wheel Loader Serial Number A75001 through A75074.
WA320-3L Wheel Loader Serial Number A30001 through A30404.
WA380-3L Wheel Loader Serial Number A50001 through A50403.
WA420-3L Wheel Loader Serial Number A30001 through A30140.
WA450-3L Wheel Loader Serial Number A30001 through A30362.

FAILURE CODE: DN0016

DESCRIPTION: The switches installed on the listed machines (part number 363-06-31120) are not sealed effectively against water, and occasionally have failed during use. These switches should be removed and replaced with the waterproof item (363-06-31121 from Yamatake Honeywell or U-SHIN).

WARNING! Safety standards dictated by the working environment must be followed. Be sure to follow guidelines in the applicable Shop Manual and Operator and Maintenance Manual before continuing. Make sure the machine cannot be moved or started without the knowledge of the repair personnel. Check with your Komatsu District Service Manager with questions regarding safety.

INSTRUCTIONS:

1. Prepare the machine for repairs.
 - a. Park the machine on a flat, level surface.
 - b. Lower the boom and bucket to the ground, shut off the engine and cycle the controls to release residual pressure from the boom and bucket circuits.
 - c. Fully apply the parking brake.
 - d. Block all four wheels with chocks in front and behind to prevent machine movement.
 - e. Remove the key from the start switch. Make sure the key remains in the possession of repair personnel until the work has been completed.
 - f. Keep unauthorized personnel away from the machine. Place a sign or tag on the steering wheel, warning, "**This machine is being repaired. It must not be started or moved until this tag has been removed by the person doing repairs.**"

2. Obtain correct replacements (part number 363-06-321121) for the two switches, and remove the old switches from the equipment. Typical installations are shown in the illustrations. Make note of mechanical and electrical connections for later reassembly.

NOTE: The switch mounting nut is made of plastic and may break if overtightened. Tighten the nut to 6.7 Nm (4.9 lbf-ft) torque.

3. Install the new switches, and connect them to the electrical system.
4. Measure the distance between the switch's face and its target. Clearance should be 3 to 5 mm. If necessary, loosen the mounting nuts and adjust switch position for clearance of 3 mm to 5 mm between the switch and the target. Tighten the nuts to 6.7 Nm (4.9 lbf-ft) torque.

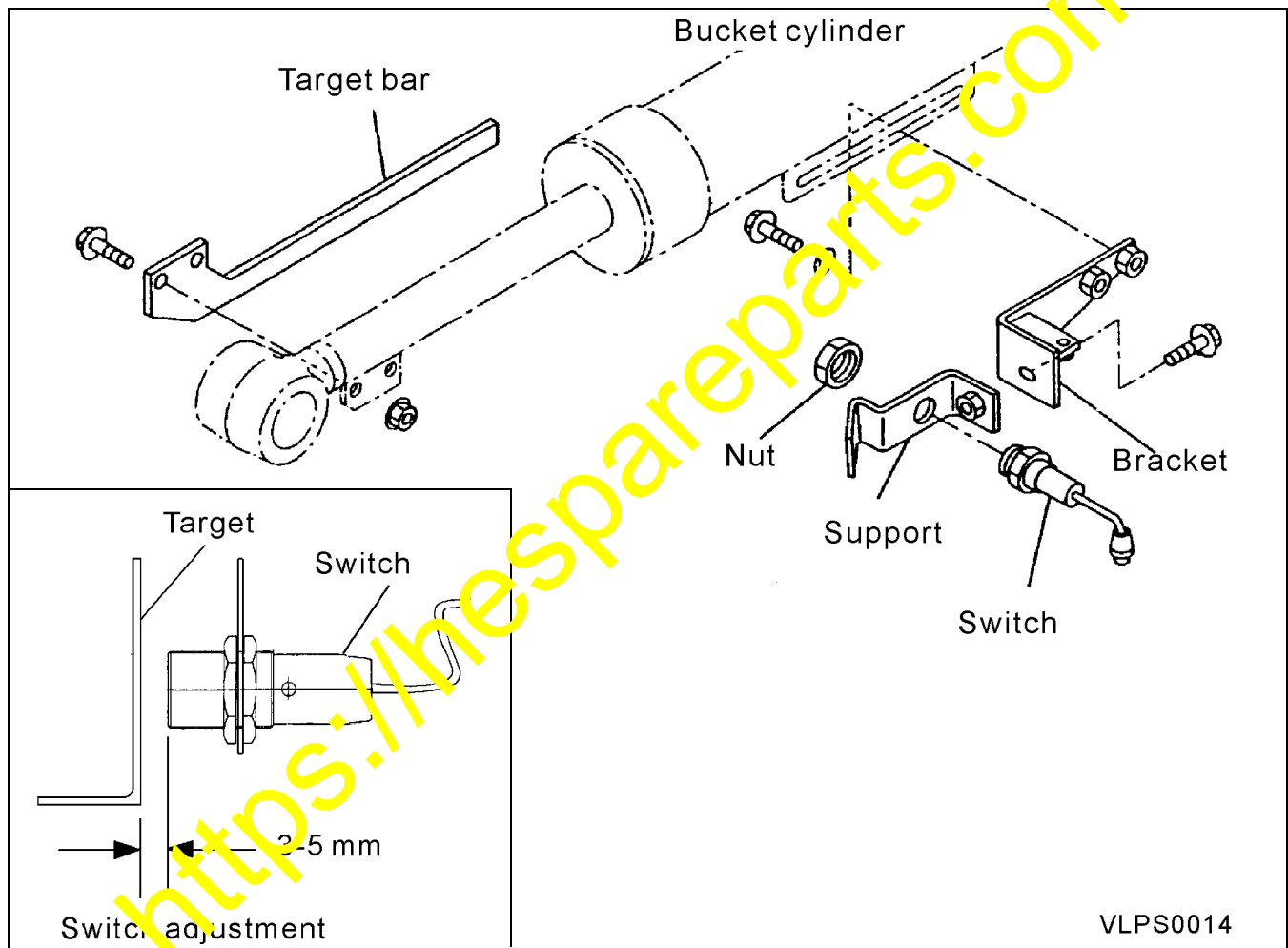

Figure 1. Typical Bucket Switch Mounting (WA120-3L and WA180-3L)

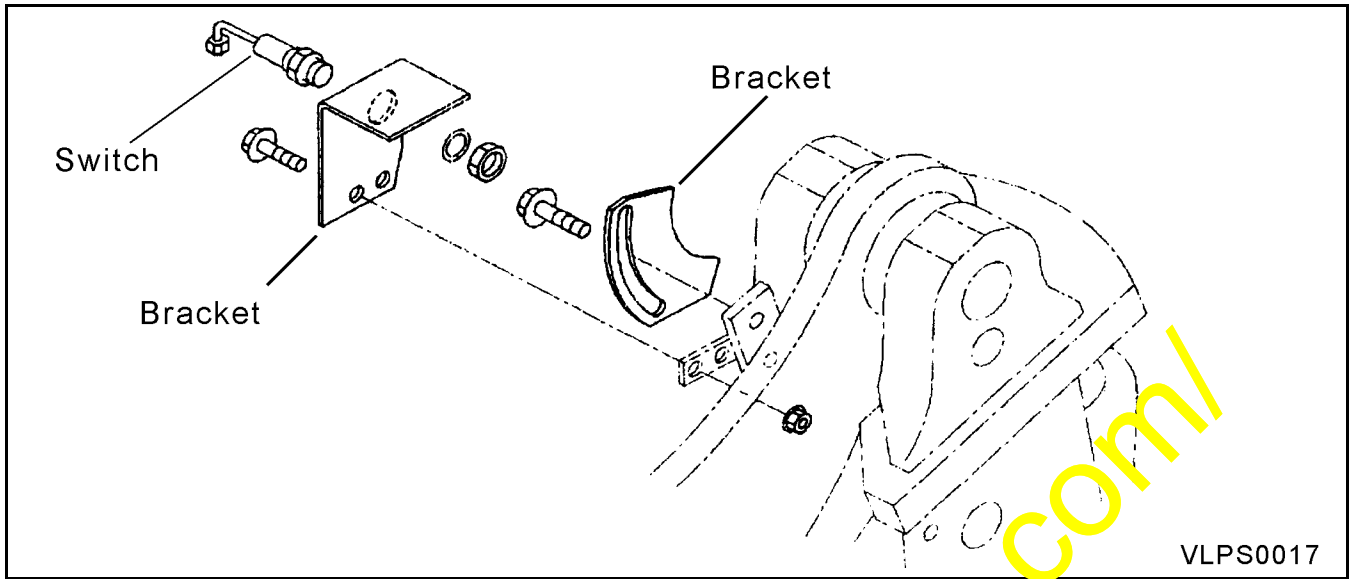

Figure 2. Typical Boom Switch Mounting (WA120-3L and WA180-3L)

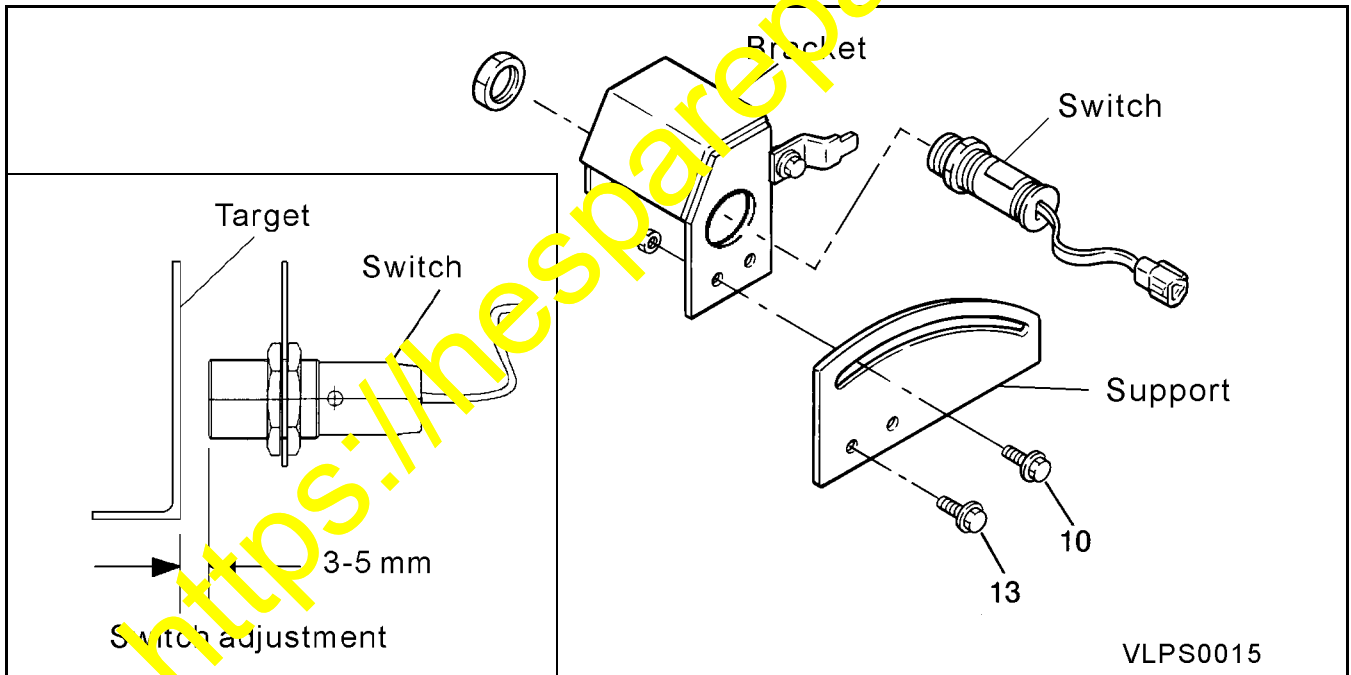

Figure 3. Typical Boom Switch Mounting (WA180-3PT and WA250-3PT)

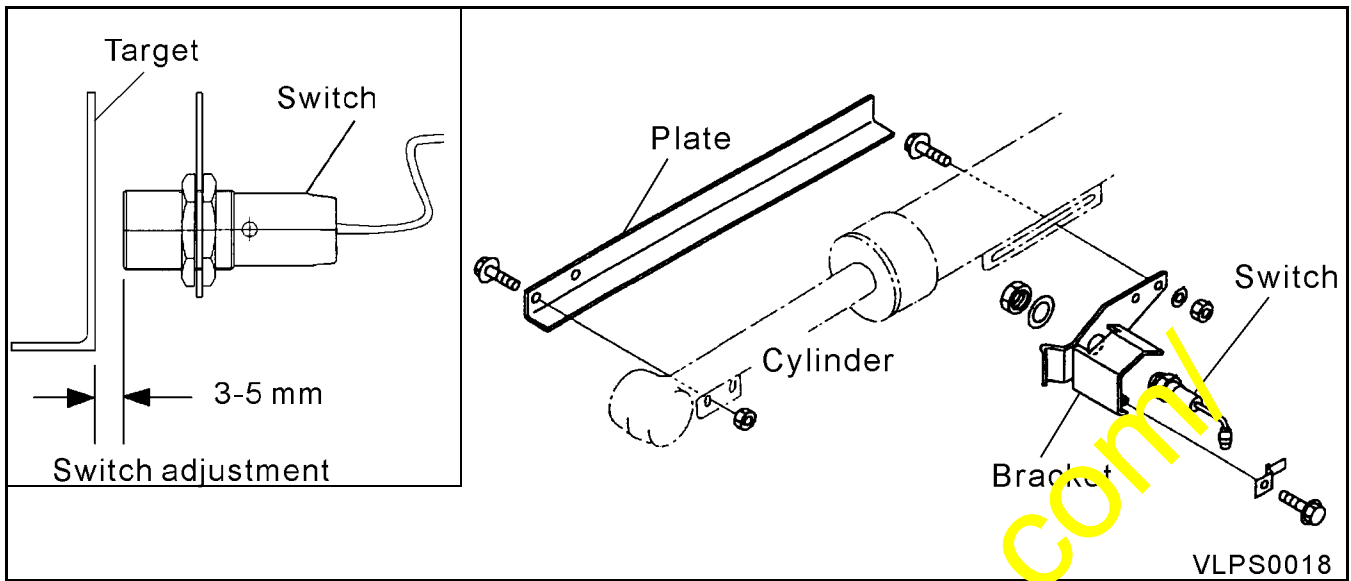

Figure 4. Typical Bucket Switch Mounting (VA250-3L)

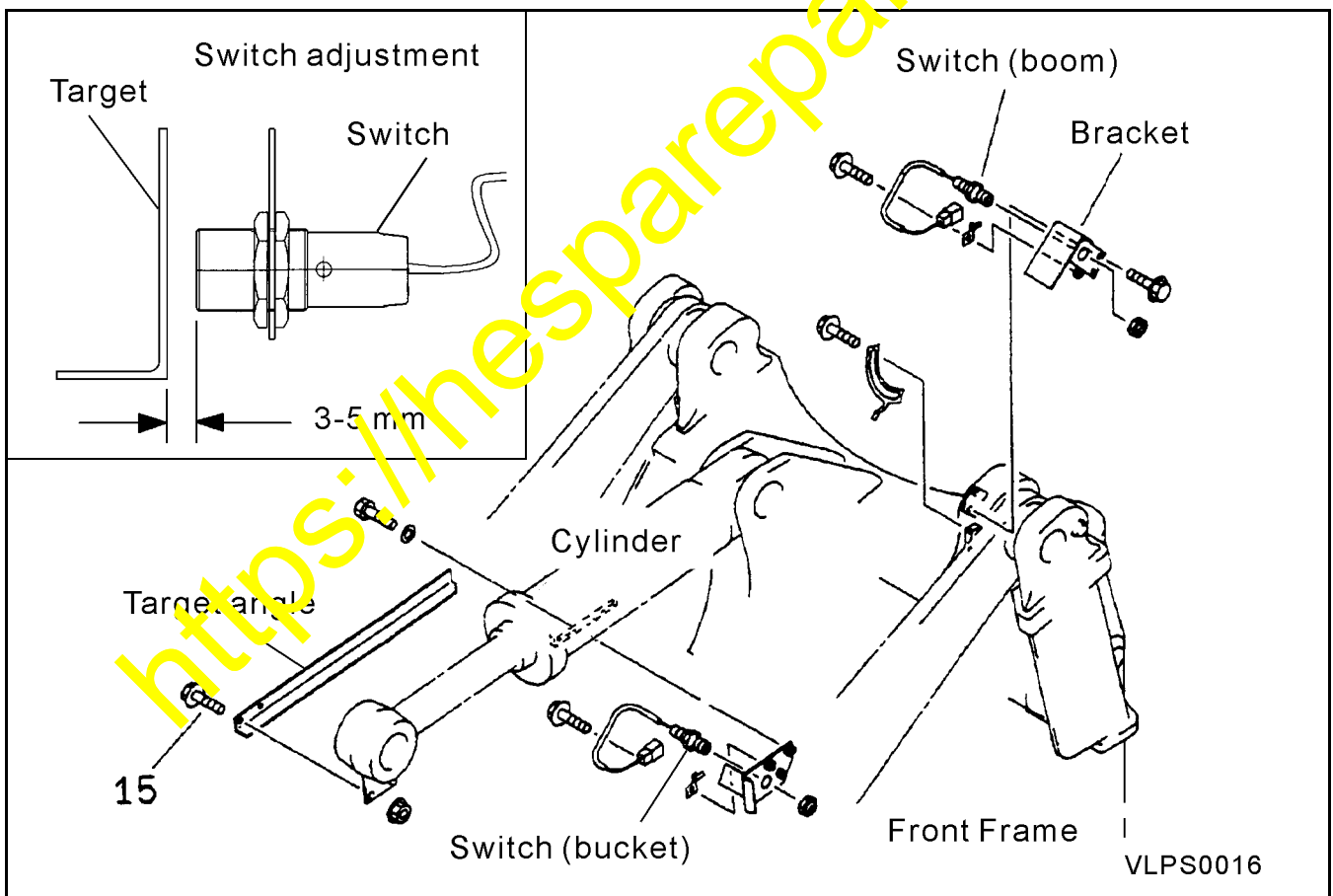

Figure 5. Typical Switch Mounting (WA320-3L, WA450-3L, WA380-3L, WA240-3L)