

PARTS & SERVICE NEWS

REF NO.	AA00072
DATE	June 20, 2000

(C)

Page 1 of 12

SUBJECT: DRIVE SHAFT MOUNTING BOLTS AND DRIVE SHAFT COMPONENTS.

PURPOSE: Drawing correction, BOM correction.

APPLICATION: WA500-1LC Wheel Loader Serial Number A60001 through A60231
WA500-1LE Wheel Loader Serial Number A61001 through A61194
WA500-3LE Wheel Loader Serial Number A70001 through A70053

FAILURE CODE: 200099

DESCRIPTION:

Introduction:

For the WA500-1LC, WA500-1LE and WA500-3LE, the supplier of the drive shafts has changed. Note that they are now being sourced from Italcordano, but there is no need to replace the parts immediately. New part numbers are provided below, referenced to the corresponding part from the previous supplier, Borg Warner. Repairs to the Borg Warner shafts should be made using the original parts, while repairs to the Italcordano shafts should be made using the new parts. As a whole the shafts are interchangeable, but DO NOT mix and match pieces. Also, WA500-3LE's that receive Italcordano shafts will have an extra bolt substitution. See Parts List below for specifics and illustrations.

PARTS LIST

Item	Old Part Number	Description	Qty	New Part Number / Remarks
1	425-20-A1110	Upper Drive Shaft Assembly	1	<u>To Be Used With Italcordano Shafts</u> Part Number 425-20-A2110
2	425-20-A1120	Yoke	1	NSS
3	425-20-A1130	Spider Assembly	2	Part Number 425-20-A2130
4	425-20A1360	Fitting, Grease	13	Part Number 425-20-A2140
5	02030-00851	Bolt	8	Part Number 25 279 R1
6	425-20-A1200	Front Drive Shaft Assembly	1	Part Number 425-20-A2310
7	425-20-A1270	Yoke and Shaft Assembly	1	NSS
8	02030-00864	Bolt	24	Part Number 80 289 R1
9	425-20-A1241	Spider Assembly	2	Part Number 425-20-A2330
10		Angle Fitting, Grease	1	Add Part Number 425-20-A2340
11	425-20-A1160	Center Drive Shaft Assembly	1	Part Number 425-20-A2510
12	425-20-A1170	Yoke and Shaft Assembly	1	NSS
13	425-20-A1141	Spider Assembly	2	Part Number 425-20-A2330
14	425-20-A1320	Rear Drive Shaft Assembly	1	Part Number 425-20-A2710
15	425-20-A1330	Yoke and Shaft Assembly	1	NSS
16	425-20-A1241	Spider Assembly	2	Part Number 425-20-A2330

- Upper Drive Shaft (See Figure 1).

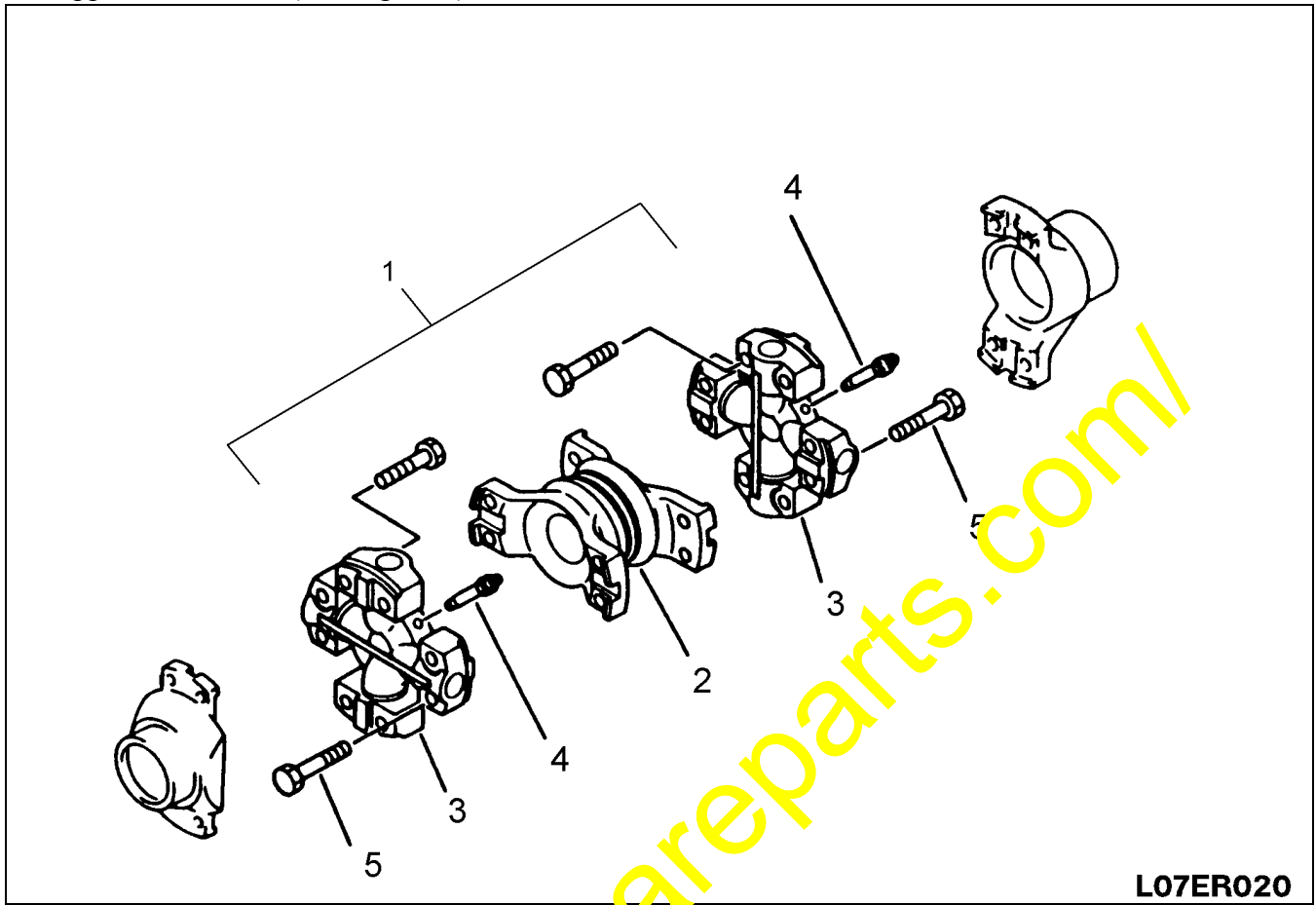

L07ER020

Figure 1

<https://hespareparts.com/>

- Front Drive Shaft (See Figure 2)

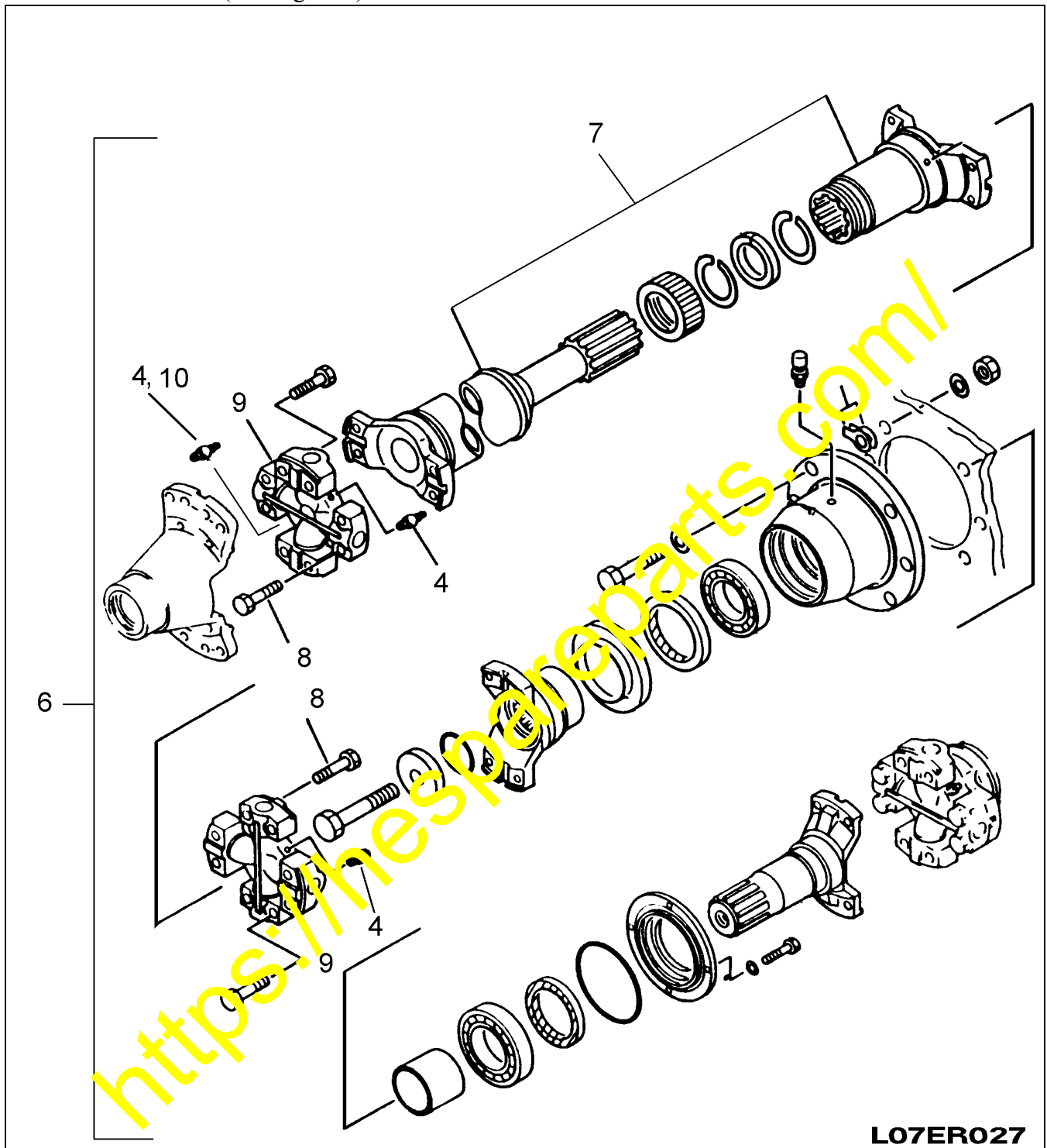

L07ER027

Figure 2

- Center Drive Shaft (See Figure 3).

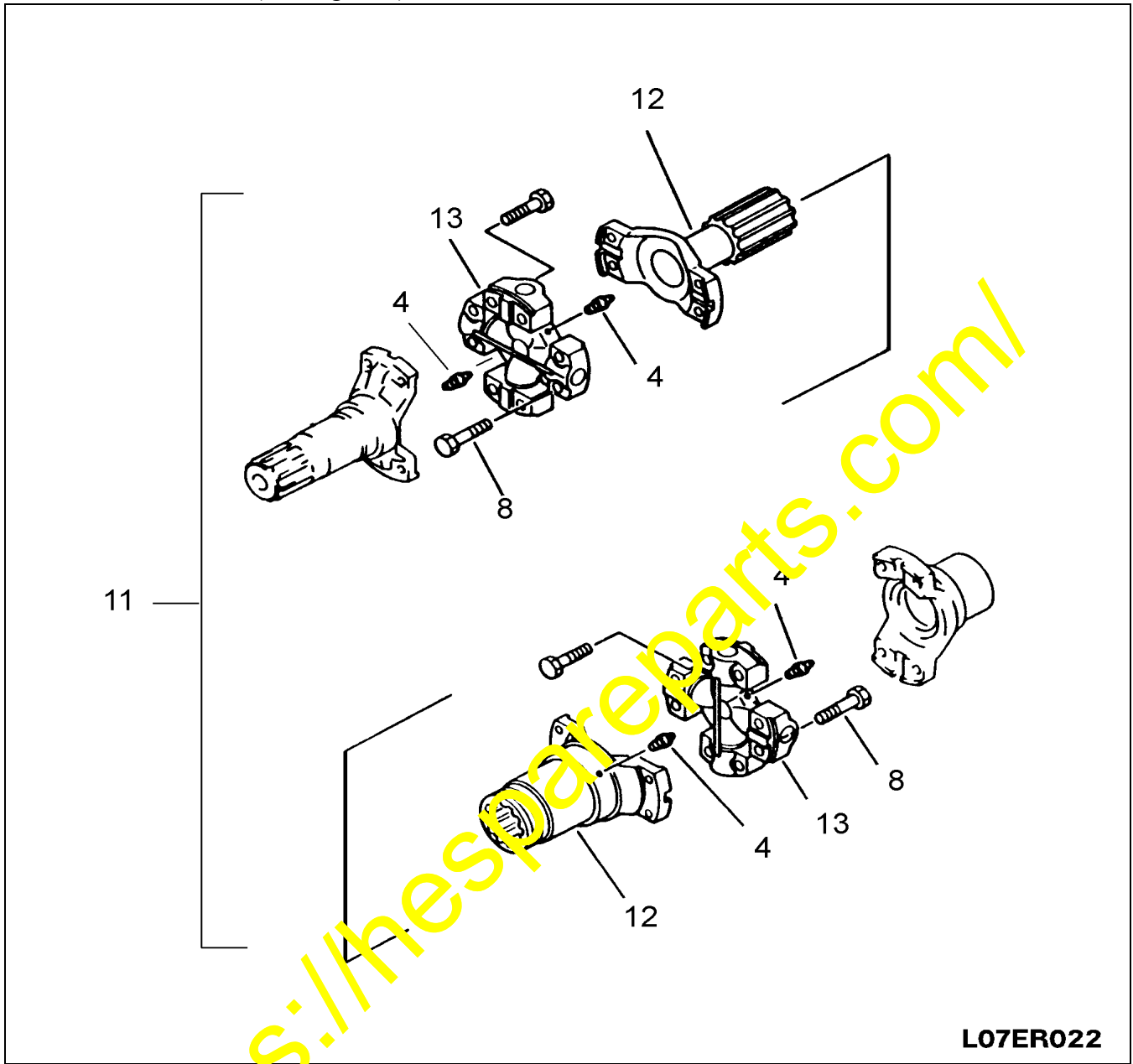

L07ER022

Figure 3

- Rear Drive Shaft (See Figure 4).

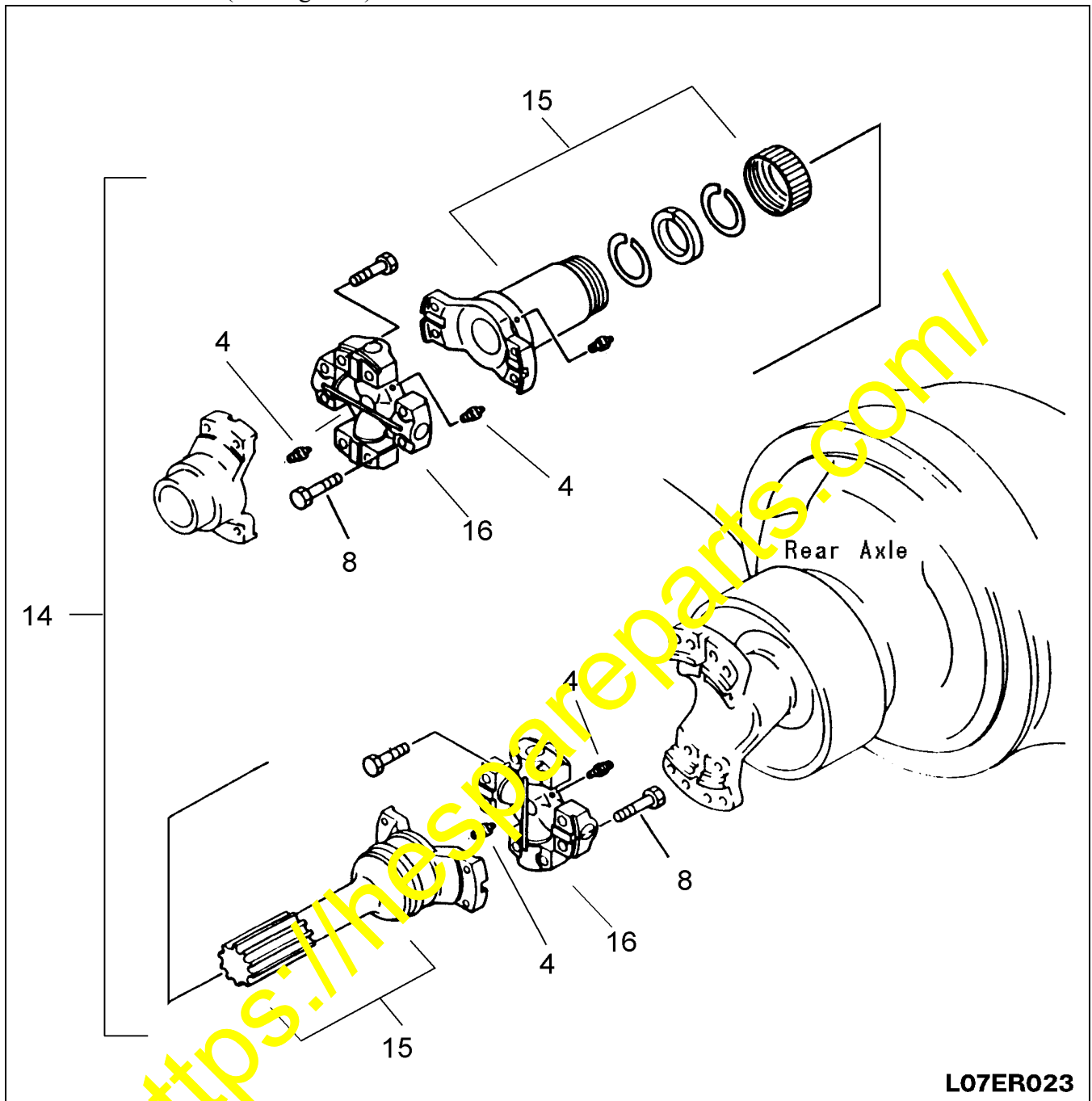

L07ER023

Figure 4

NOTE: The following contain revisions to the Operation and Maintenance Manuals and should be used in place of the old pages.

MAINTENANCE

ITEM	SERVICE	PAGE
Lubrication		
Bucket pins	Lubricate 2 points	67
Bucket link pins	Lubricate 2 points	68
Tilt lever pins	Lubricate 1 point	68
Bucket cylinder pins	Lubricate 2 points	68
Lift cylinder pins	Lubricate 4 points	69
Lift arm pivot pins	Lubricate 2 points	69
Steering cylinder housing end pins	Lubricate 2 points	70
Steering cylinder rod end pins	Lubricate 2 points	70
Wheel hub nuts	Check and retighten	70
Air conditioner compressor drive belt - if equipped	Check tension	71
EVERY 500 HOURS SERVICE		
Transmission oil filter	Replace element(s)	72, 73
Lubrication		
Center drive shaft spline	Lubricate 1 point	74
Air dryer - if equipped	Check	74
EVERY 1000 HOUR SERVICE		
Transmission oil and strainer	Change oil and clean strainer	74
Transmission case breather	Clean	75
Lubrication		
Center hinge pins	Lubricate 2 points	76
Front drive shaft	Lubricate 2 points	76
Drive shaft center support	Lubricate 1 point	76

MAINTENANCE

ITEM	SERVICE	PAGE
Center drive shaft	Lubricate 2 points	77
Rear drive shaft	Lubricate 2 points	77
Upper drive shaft	Lubricate 2 points	77
Damper	Lubricate 1 point	77
Transmission mounting trunnion	Lubricate 1 point	78
Parking brake caliper	Lubricate 2 points	78
EVERY 1500 HOURS SERVICE		
Engine valves and injectors	Check and adjust	78
Engine	Steam clean	78
Engine mounted hoses	Check and replace as required	79
Engine mounting hardware	Check and reighten	79
Turbocharger mounting	Check	79
Water pump	Check	79
EVERY 2000 HOURS SERVICE		
Batteries	Check	80
Hydraulic tank oil and filters	Change oil and replace elements	83
Hydraulic tank breather	Replace element	84
PPC (Proportional pressure control) circuit strainer	Clean	84
Cab air filter - if equipped	Replace element	85
Drive axle oil	Change	85
Parking brake disc	Check	86
Air dryer - if equipped	Replace internal parts	86
Accumulator	Check	87

MAINTENANCE

4. Center drive shaft (2 points)

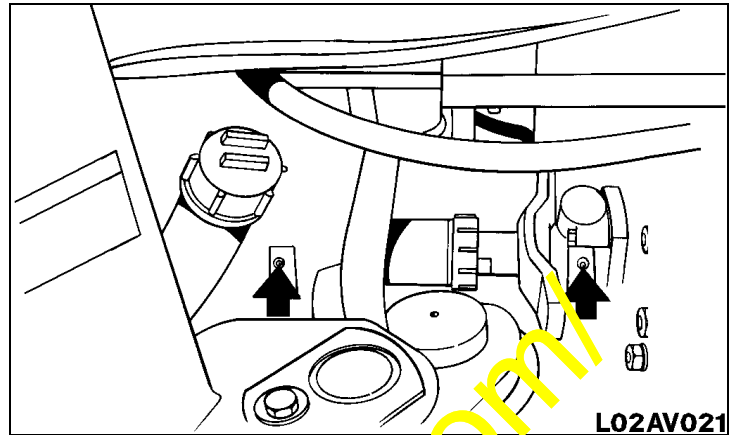

5. Rear drive shaft (2 points)

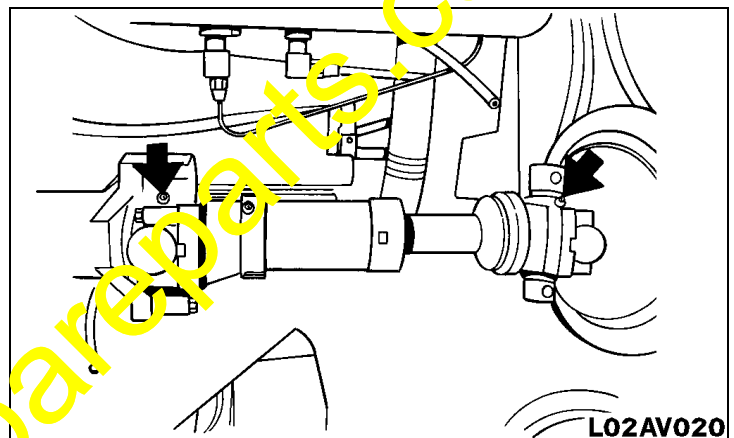

6. Upper drive shaft (2 points)

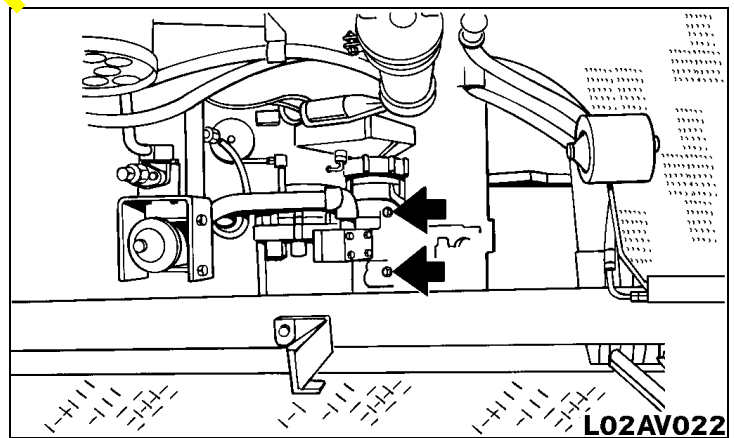

<https://hespareparts.com/>

MAINTENANCE

LUBRICATION

Apply grease to the grease fittings shown by the arrows.

1. Center hinge pins (2 points)

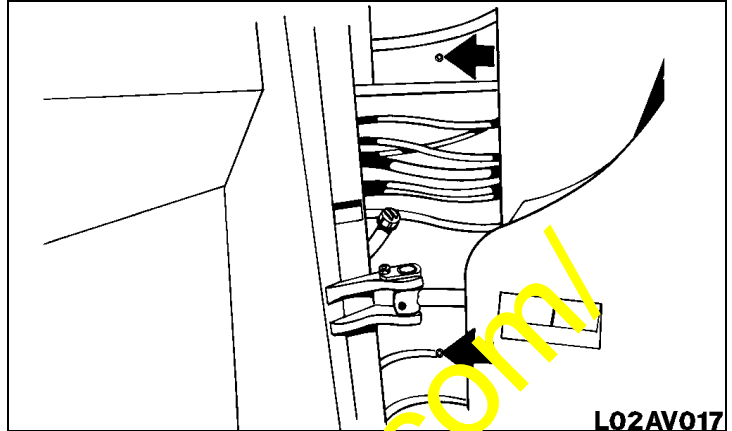

2. Front drive shaft (2 points)

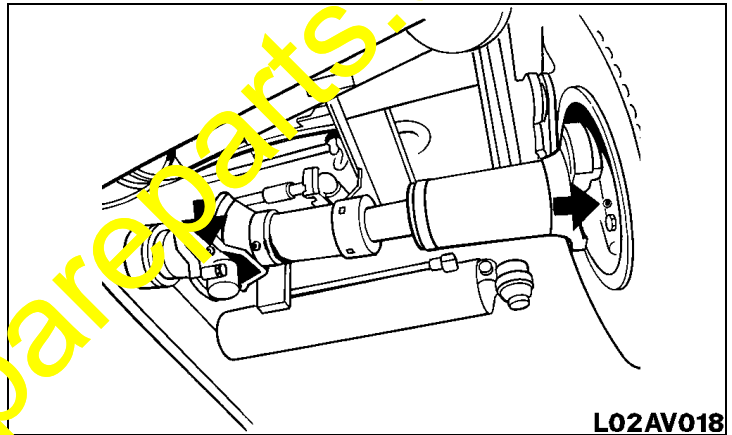

3. Drive shaft center support (1 point)

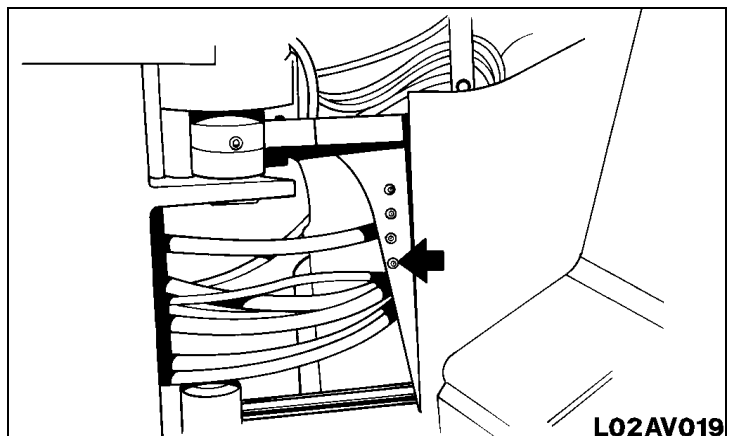

DRIVE SHAFT

DISASSEMBLY

1. Shaft.

- 1) Drive shaft splines are lubed for life and should not be dismantled.

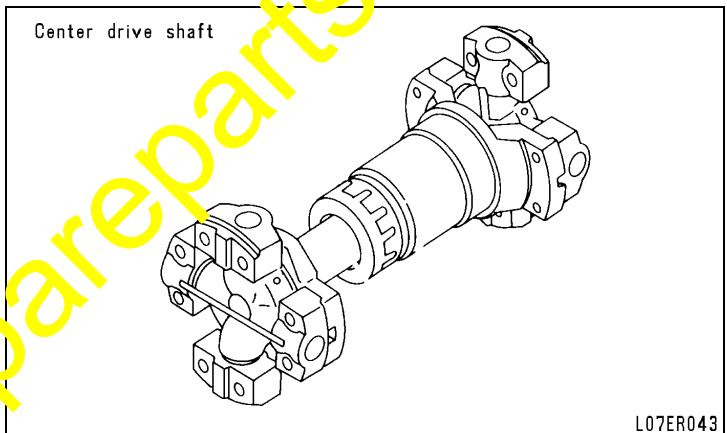
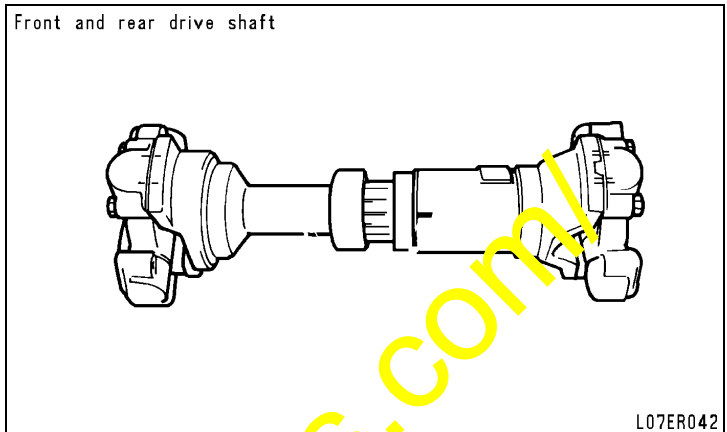

- 2) Remove mounting bolts (4), then remove spider assembly (5).
* Make match marks on yoke and spider.

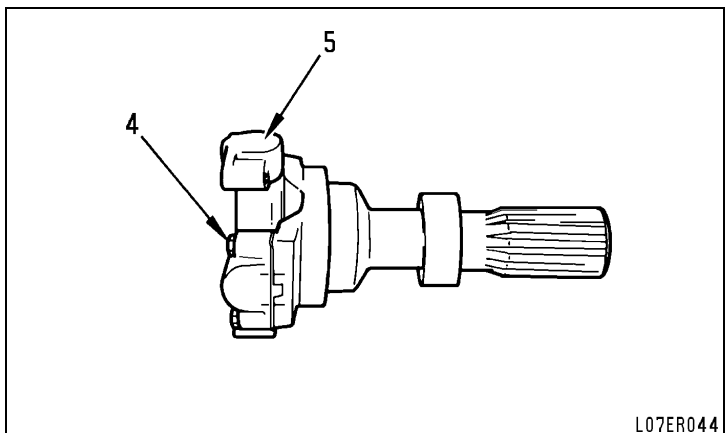

NOTE: Omit pages 23-94 and 23-95

- 3) Assemble spider assembly (5) to shaft (2).
- * Carefully align match marks.
 - * Clean the mounting face of the bearing cap by wiping with a clean cloth.
 - * Mounting bolt: 13.8 + - 0.7

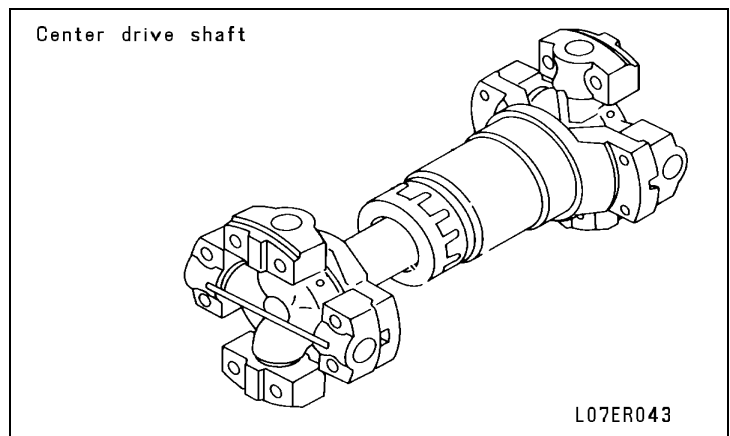
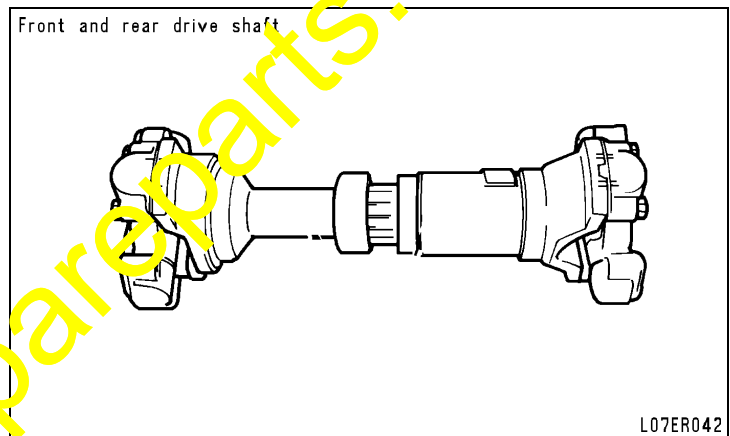
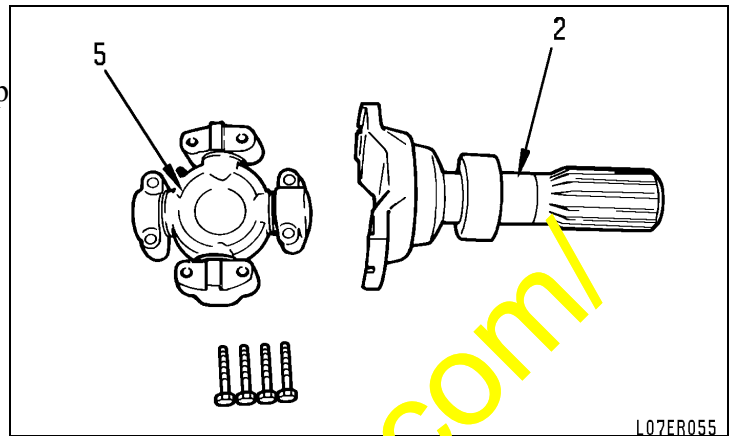

DRIVE SHAFT

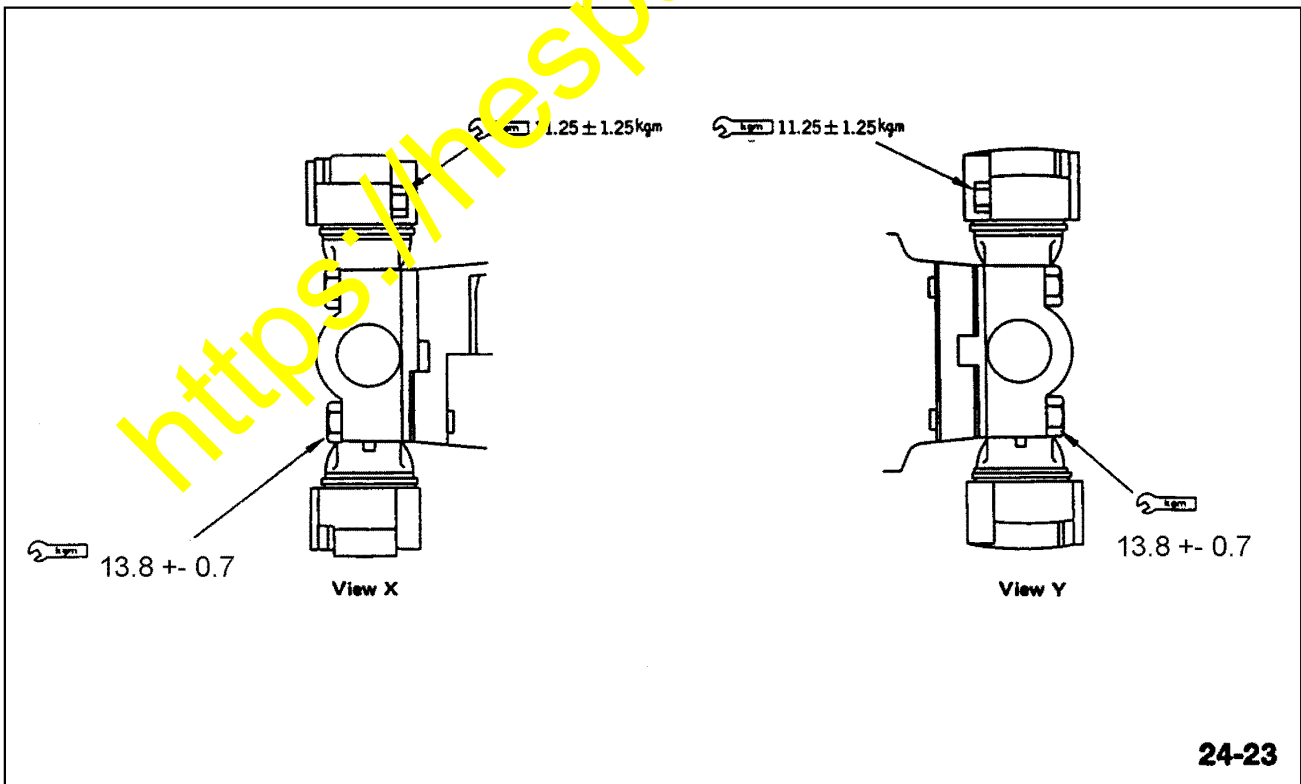
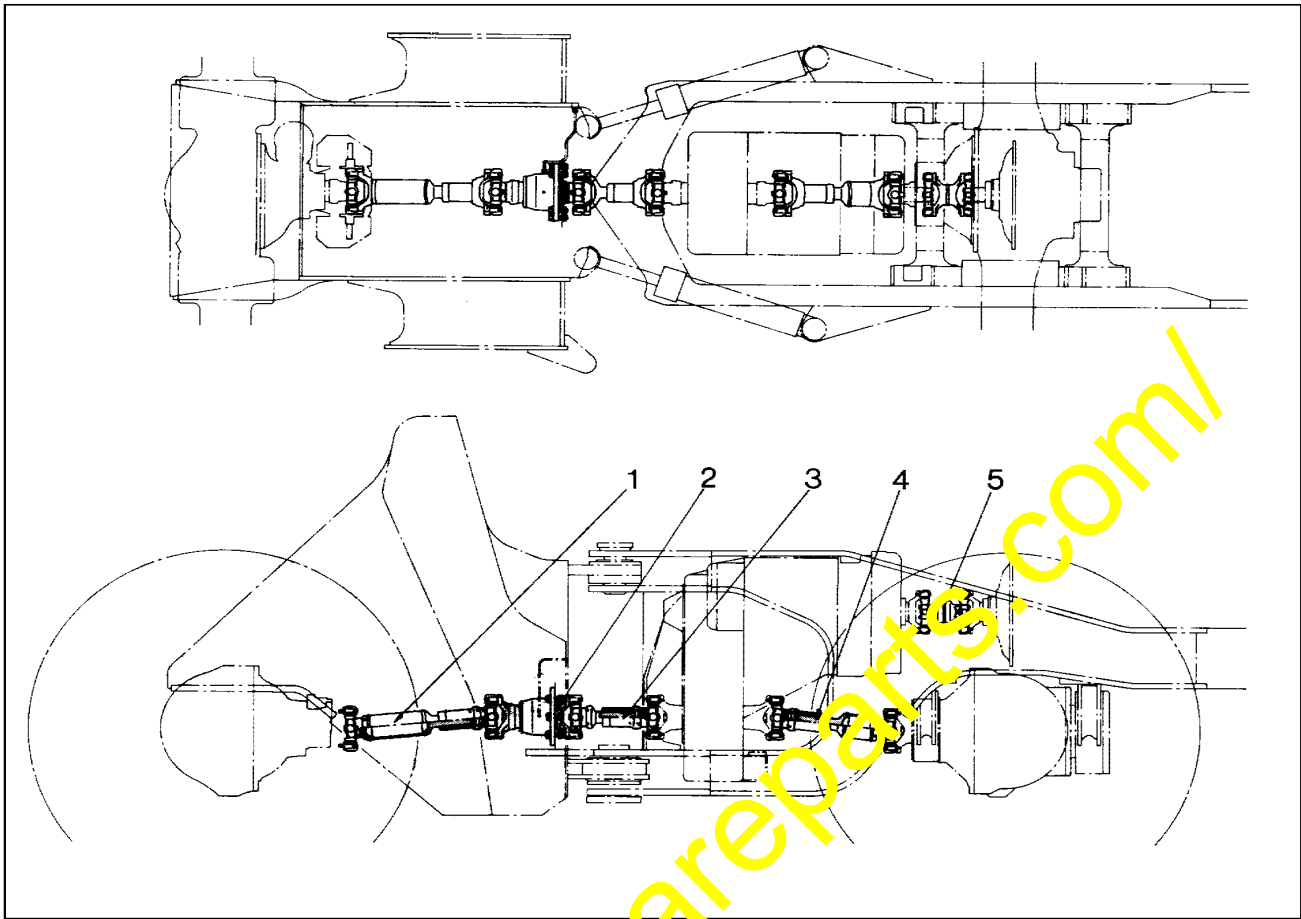

24-23