

# PARTS & SERVICE NEWS

REF NO.	AA00086
DATE	10, July 2000

**SUBJECT:** IMPROVED FACE SEAL FOR REAR BRAKE ASSEMBLIES

**PURPOSE:** Prevent leaking of the toric rings

**APPLICATION:** CFA25 140M all units  
BFA40 210M all units  
BFA36 210M units with oil brake conversion

**FAILURE CODE:** 2E4D10

**DESCRIPTION:**

Intermittent problems have been reported about leaks in the external face seal of the 140M and 210M rear brake assembly face seal (PB6727). The cause of the leak is from inadequate pressure on the toric rings, which result in decreased face pressure on the mating surfaces of the metal seal rings. These leaks result in an accumulation of oil residue on the inside of the rear wheel rims.

To prevent this failure, this *PARTS & SERVICE NEWS* introduces a new face seal assembly (PC0894) which is a direct replacement for the original seal assembly (PB6727). The new seal assembly uses toric rings that have an increased diameter cross section. The larger diameter section applies more pressure on the toric ring when it is installed, and provides increased face pressure on the mating surfaces of the metal seal rings.

The new toric rings will be marked with four pink dots around the ring for identification. The metal seal rings remain unchanged. The installation procedure for the new seal assembly is the same as for the original seal assembly. When installing the new parts, insure care is taken to prevent damage to the metal face seals. The special installation tools provided with the truck tool kit will be needed for installation.

**NOTE:** Refer to the shop manual, Section "J", "Rear Wet Disc Brake Assembly" for installation procedure.

When installing the new seals, always follow the procedure for wheel bearing adjustment located in Section "G", "Wheel Hub and Bearing".

**NOTE:** Failure to properly shim the wheel bearings may result in premature damage or wear to the face seals.

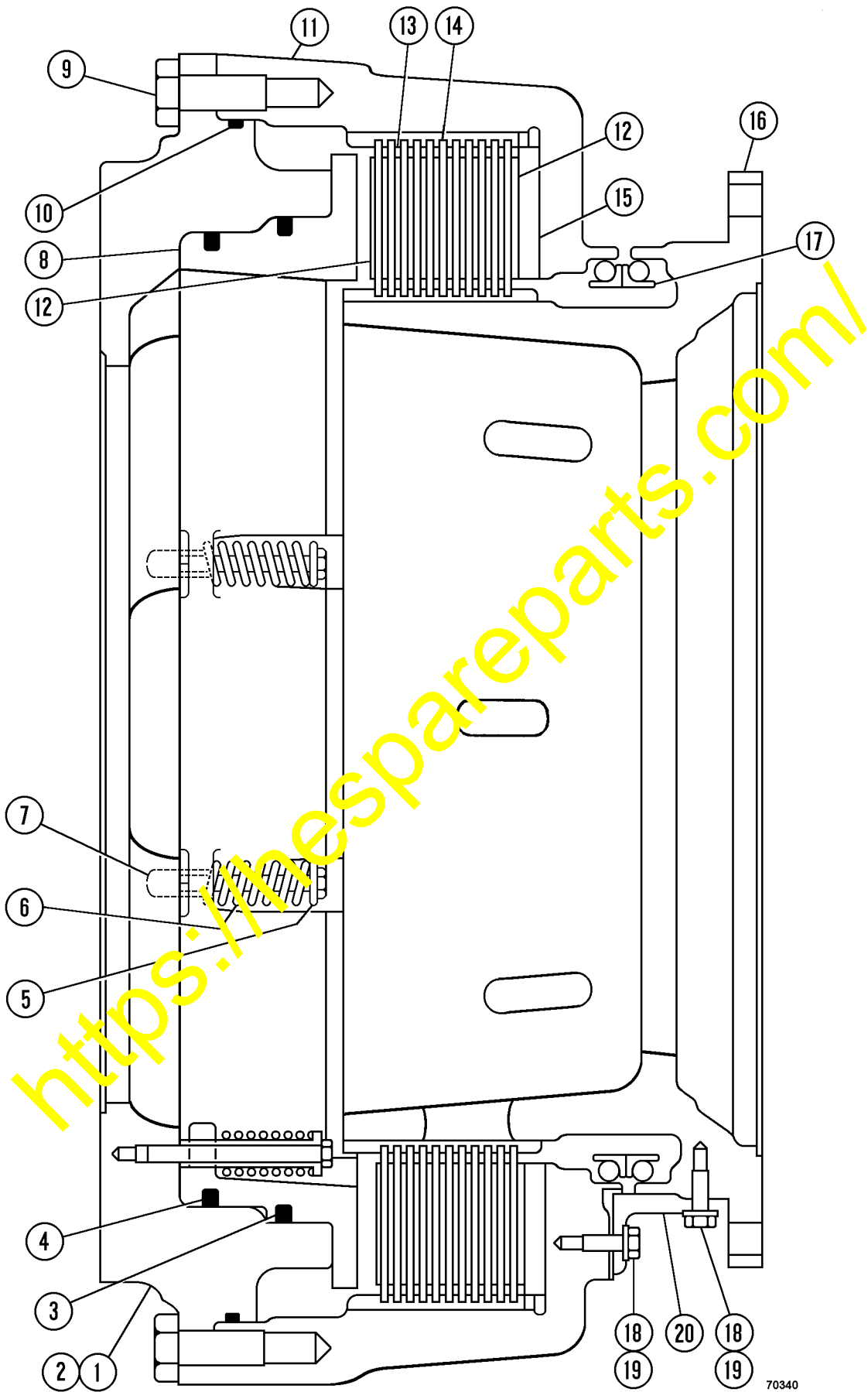

70340

**WET DISC BRAKE ASSEMBLY (EB3042)**

Item	Part No.	Qty.	Description
1	TZ8273	1	PISTON & HOUSING ASSEMBLY
2	TZ8260	1	• HOUSING, PISTON
3	PB7603	1	• SEAL (1)
4	PB7425	1	• SEAL (1)
5	TY3257	8	• GUIDE, SPRING
6	WA4765	8	• SPRING
7	VN9136	8	• CAPSCREW - 3/8" - 16NC X 4"
8	TZ8262	1	• PISTON
9	VN9066	30	CAPSCREW - 3/4" - 10NC X 2"
10	WA4647	1	O-RING (1)
11	EB3041	1	HOUSING
12	PB7602	2	DAMPER (2)
13	PB7600	11	DISC, FRICTION (2)
14	PB7601	10	PLATE SEPARATOR (2)
15	TZ8271	1	SPACER
16	EB3040	1	HUB
17	PC0894	1	SEAL, ASSEMBLY (1)
18	C1602	6	CAPSCREW - 3/8" - 16NC X 1"
19	C0312	6	LOCKWASHER - 3/8"
20	TY0235	3	ANGLE
	VM0315	3	PLUG, O-RING
NS	AK0086		NOTE: (1) INCLUDED IN AK0086 SEAL KIT
NS	AK0087		(2) INCLUDED IN AK0087 DISC - PACKAGE
NS			NOTE: NS = NOT SHOWN