

# PARTS & SERVICE NEWS

REF NO.	AA00145A
DATE	13, September 2000

**SUBJECT:** IMPROVED CUSHIONED MOUNT FOR TRANSMISSION FILTER

**PURPOSE:** To introduce cushion mount kit AK4527

**APPLICATION:** 530M units prior to S/N A30036

**FAILURE CODE:** 15B001

**DESCRIPTION:**

A new transmission filter cushion mount kit (Figure 1) for the 530M is being introduced to reduce vibration caused by loosening or breakage of clamps, brackets, bolts, tubes, and hoses in the transmission filter piping. Installing the cushion mount will also reduce noise in the cab for operator comfort.

**.530M TRANSMISSION FILTER CUSHION MOUNT (AK4527)**

REF.NO.	PART NO.	QTY.	DESCRIPTION
1	EH8754	1	BRACKET
2	0101081060	4	CAPSCREW
3	0164331032	4	WASHER
4	PC0710	4	RUBBER MOUNT
5	PC0917	4	WASHER REBOUND
6	0158011008	4	NUT
7	EH8759	1	BRACKET, LOWER
	EH4019		TRANSMISSION PIPING DWG.
	EH8766		TRANSMISSION FILTER INSTALLATION DWG.

**▲ IMPORTANT ▲**

**NOTE:** Various filter piping brackets, clamps, tubes, and hoses (items 8-12) between the transmission and filter will need to be inspected and replaced if worn or damaged.

**.PARTS TO BE INSPECTED OR REPLACED AT TIME OF INSTALLATION**

REF. NO.	PART NO.	DESCRIPTION	REMARKS
8	EF8258 EH3533	Bracket	Recommended for replacement at time of installation.
9	WA4712	Clamp, Hydrazorb	Recommended for replacement at time of installation.
10	EG2226 EH3203	Tube Str.	Inspect at time of installation.
11	HA7467	Hose Assembly	Inspect at time of installation.
12	HA7466	Hose Assembly	Inspect at time of installation.

1. Disconnect hoses (11 & 12) from filters. Remove filter assemblies from mounting bracket. Save hardware for installation of filter assemblies.
2. Use a cutting torch and carefully cut filter bracket from the mounting structure. Grind the mounting structure smooth.
3. Weld lower bracket EH8759 (7, Figure 1) to mounting structure as shown in Figure 2.
4. Install filter assemblies to upper bracket (1, Figure 1) using hardware removed from Step 1.
5. Install upper bracket to lower bracket using rubber mounts as shown on drawing EH8766.
6. Inspect items 8 through 12 for wear or damage. Replace as needed.
7. Reinstall hoses (11 & 12) to filter assemblies.

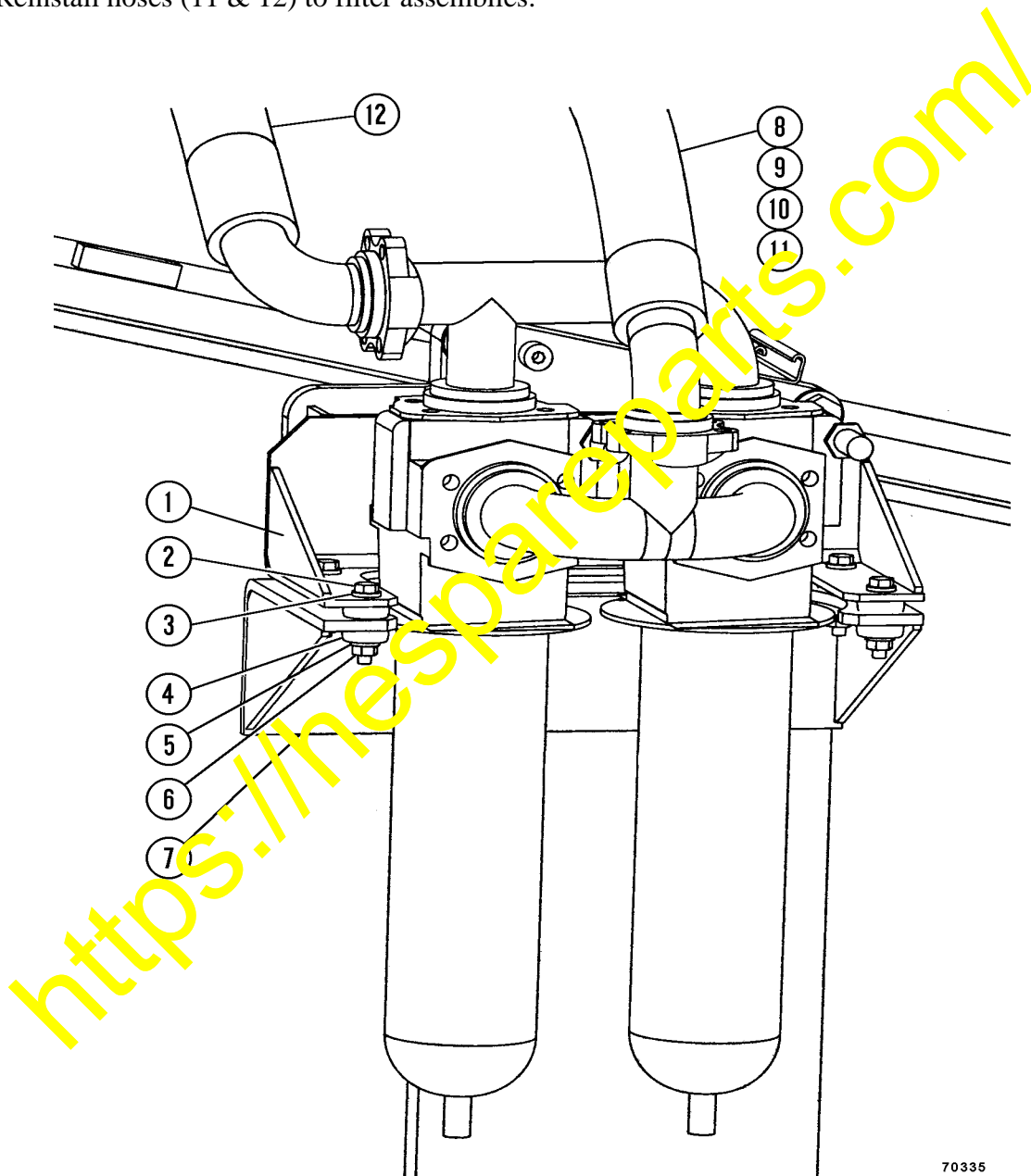

70335

Figure 1. Transmission Filter Cushion Mount

- |                   |                   |                    |                    |
|-------------------|-------------------|--------------------|--------------------|
| 1. Bracket, Upper | 4. Rubber Mount   | 7. Bracket, Lower  | 10. Tube Structure |
| 2. Capscrew       | 5. Washer Rebound | 8. Clamp Structure | 11. Hose           |
| 3. Washer         | 6. Nut            | 9. Clamp           | 12. Hose           |

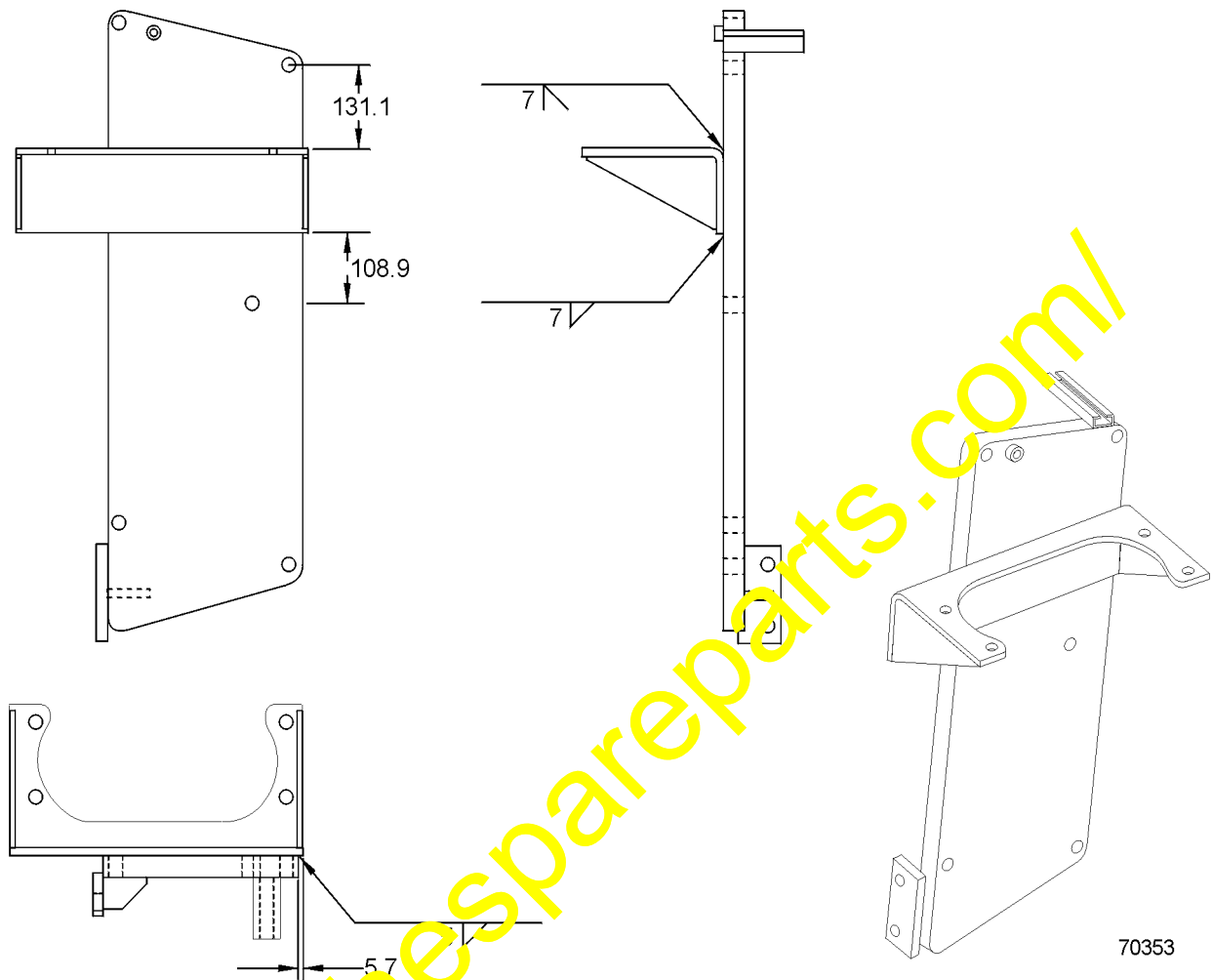

Figure 2. Lower Bracket Installation