

PARTS & SERVICE NEWS

REF NO. AA00195

DATE Aug. 17, 2000

(C)

Page 1 of 6

SUBJECT: FUEL QUICK FILL

PURPOSE: To Introduce modification procedures to improve sealing of fuel tank filler neck cap and improve fueling

APPLICATION: WA700-3L Wheel Loader, S/N A50001 thru A50012

FAILURE CODE: 041113

DESCRIPTION:

When adding fuel to the fuel tank using a Wiggins fast fill system, fuel can leak past the seal of the current fuel filler neck cap on the WA700-3L loader. It is therefore suggested to replace the existing automotive style filler neck cap with a threaded style filler neck cap. This will require that the fuel filler neck be modified to accept the threaded style cap.

1. Introduction

Remove the existing RH cover and expose the fuel filler neck to be modified. Complete modifications and replace the cover.

Preparations for work:

IMPORTANT: Please observe all safety and precautionary standards as dictated by the environment and work conditions under which the equipment will be inspected, reworked and repaired. Consult the "Shop Manual" and your Komatsu district service manager with any and all questions regarding safety.

1. Park the machine on a flat level surface, lower the boom and bucket to the ground. Shut off the engine and cycle the controls to remove any residual hydraulic pressure from the boom and bucket circuits. Fully apply the parking brake.
2. Place chocks at the front and rear of all wheels to prevent the machine from moving.
3. Place the safety bar on the machine.
4. Remove the key from the start switch and retain it until the repairs are complete. Attach a tag on the steering wheel advising: "**This machine is being repaired. It should not be started or moved for any reason until the tag is removed by the person doing the work**".

Preparations for work continued.

5. For any welding always have a trained, experienced welder carry out the work. When carrying out welding work, always wear gloves, apron, glasses, cap and other clothes suited for welding work. Gas is generated and there is danger of fire or electrocution when carrying out welding, so never allow any unqualified personnel to carry out welding. The qualified welder must follow the precautions given below.

- * Disconnect the battery terminals to prevent explosion of the battery.
- * Remove the paint from the place being welded to prevent gas from being generated.
- * If hydraulic equipment or piping or places close to these are heated, flammable vapor or spray will be generated and there is a danger of this catching fire, so avoid applying heat to such places.
- * If heat is applied directly to rubber hoses or piping under pressure, they may suddenly burst, so cover them with fireproof sheeting.
- * Always wear protective clothing.
- * Ensure that there is good ventilation.
- * Clean up any flammable materials and make sure that there is a fire extinguisher at the workplace.

2. List of Parts

Remove the following parts.

PART NO.	DESCRIPTION	QTY.	NOTES
423-04-11362	Cap	1	Discard
07056-18416	Strainer	1	Remove and Reuse
428-54-13520	Cover RH	1	Remove and Reuse

Order and install the following parts.

PART NO.	DESCRIPTION	QTY	NOTES
421-04-11260	Cap	1	
07055-31202	Filler Cap	1	

3. Contents of the modification

Remove the RH cover (428-54-13520) and set aside for re-use. See Figure 1.

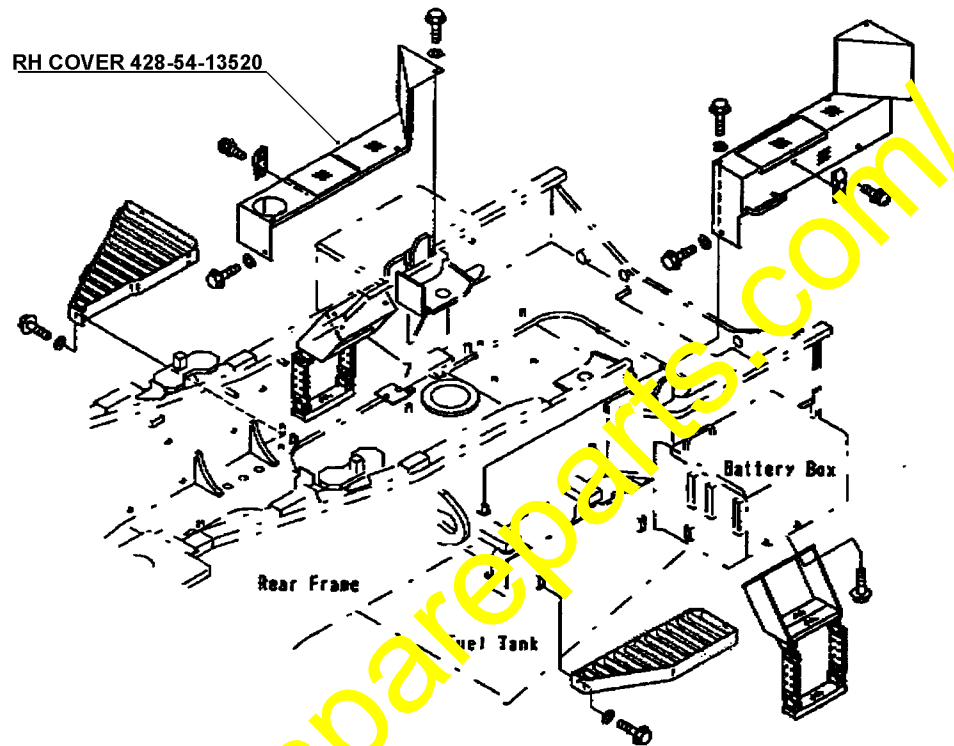

FIGURE 1

Remove cap (423-04-11362) and strainer (07056-18416). Discard cap and set strainer aside for re-use. See Figure 2.

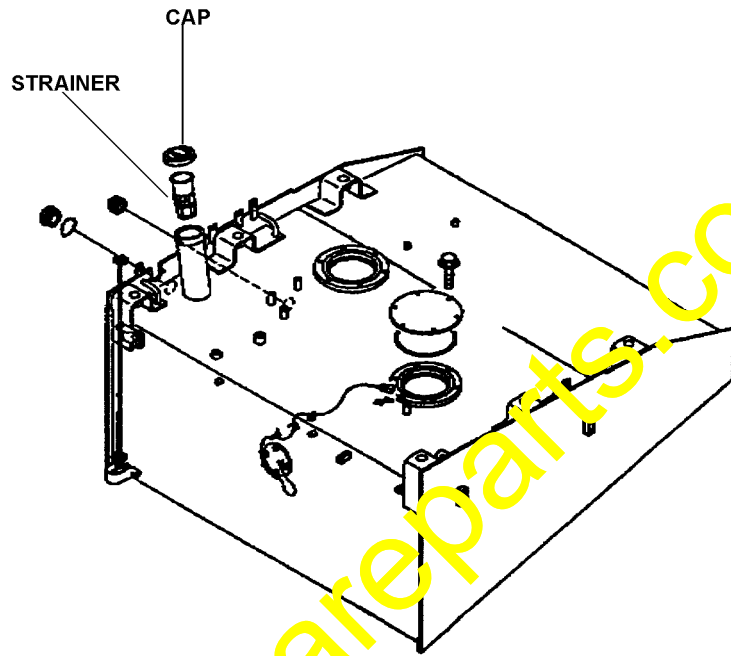

FIGURE 2

CAUTION: The following precautions must be taken before welding or cutting on the fuel tank.

1. Drain the fuel completely from the tank.
2. Disconnect all lines from the tank and plug.
3. Fill the tank completely with water (up to the cap) in order to remove any fumes.

Remove existing filler neck adapter. See Figure 3.

REMOVE EXISTING FILLER NECK ADAPTER
BY CUTTING IT AWAY

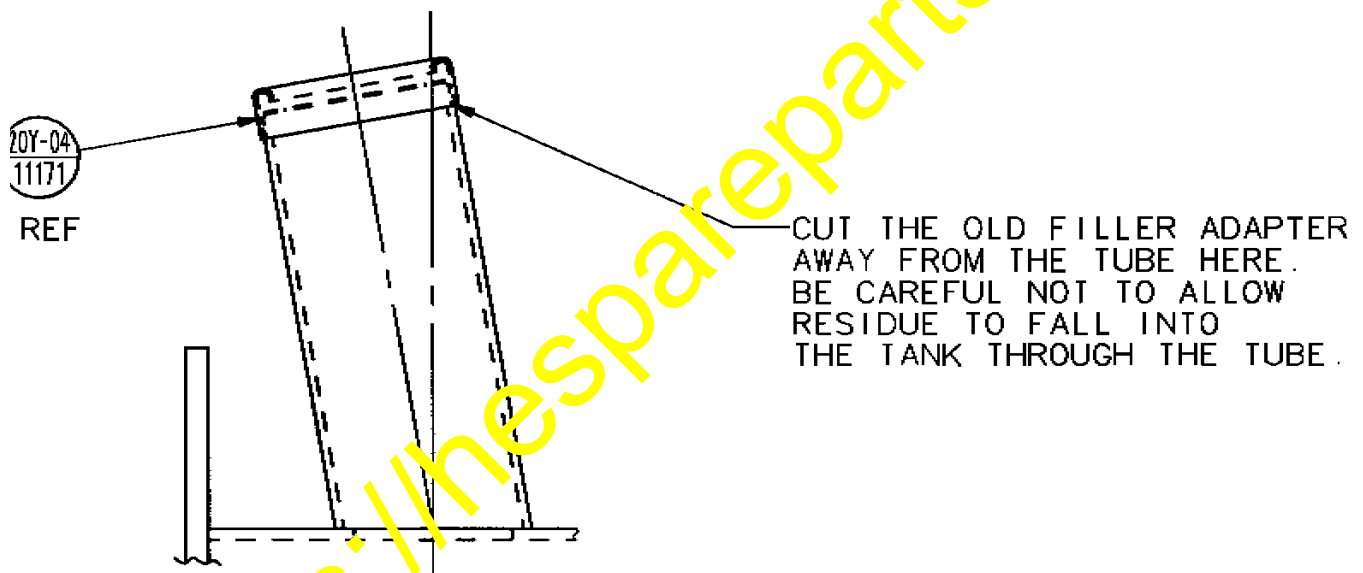

FIGURE 3

Weld new filler adapter in place and replace strainer. See Figure 4.

After all welding is completed, drain the water and dry the inside of the tank and reconnect all lines before refueling.

Reinstall the strainer removed previously. Install cap (421-04-11260). Install RH cover (428-54-13520)

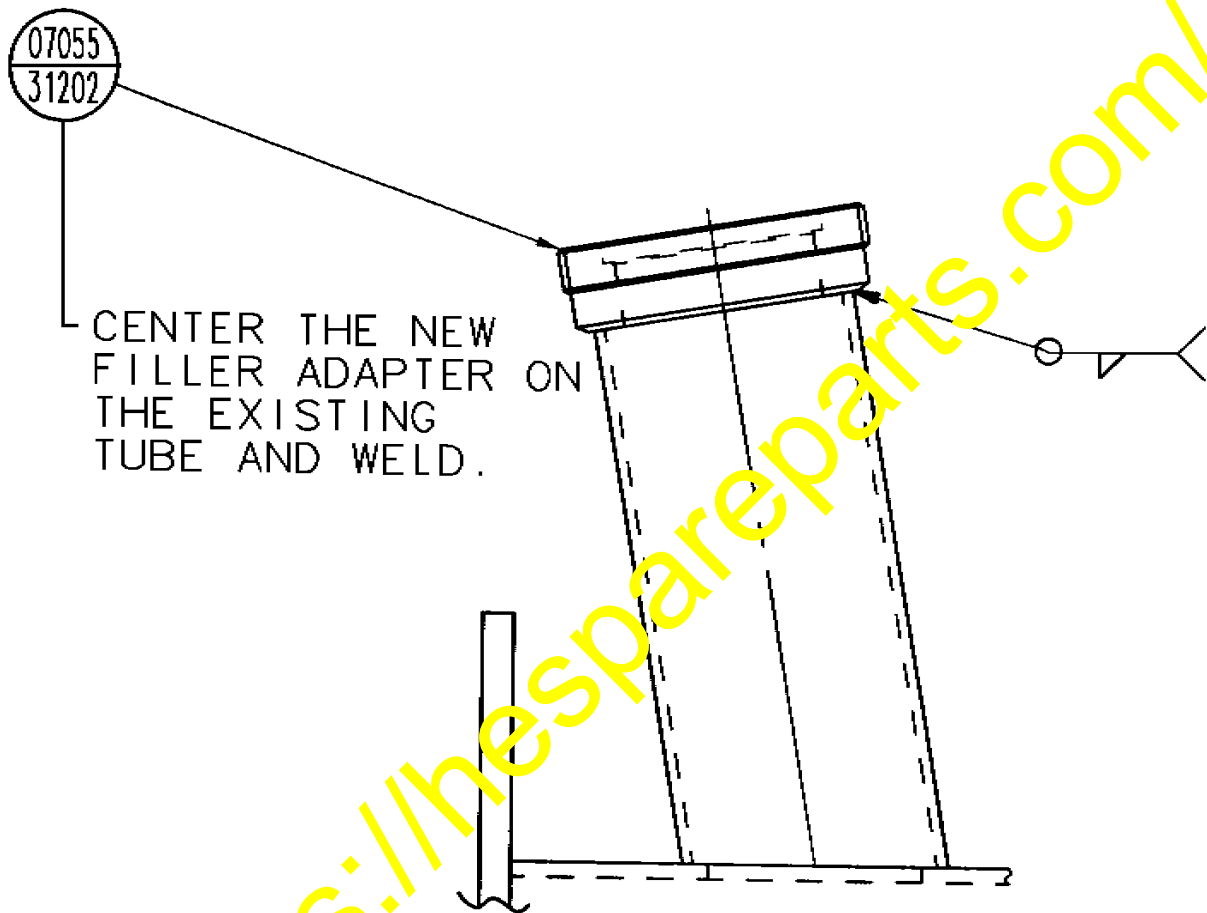

FIGURE 4