

PARTS & SERVICE NEWS

REF NO.

AA00204

DATE

September 12, 2000

(C)

Page 1 of 2

SUBJECT: JOYSTICK STEERING WIRING HARNESS

PURPOSE: To prevent damage to J/S Wiring Harness.

APPLICATION: WA600-3L Wheel Loader Serial Numbers A52001 through A52155

FAILURE CODE: D51052

DESCRIPTION: The J/S wiring harness may get caught between the J/S assembly and the left console box, causing damage to the harness.

Procedure:

1. Slide J/S Console unit and operator seat forward as far as possible.
2. Remove screws 01023-20612 (#28) and take off cover 428-S33-2280 (#27) as shown.

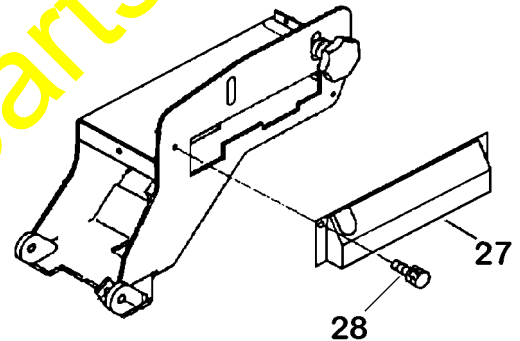

3. Install the following parts:

Part No.	Description	Qty.
426-01-11310	Bracket	1
01010-81010	Bolt	1
08036-08101	Clip	1
1400072H1	Paint	1

4. Weld bracket 426-01-11310 to the console as shown.

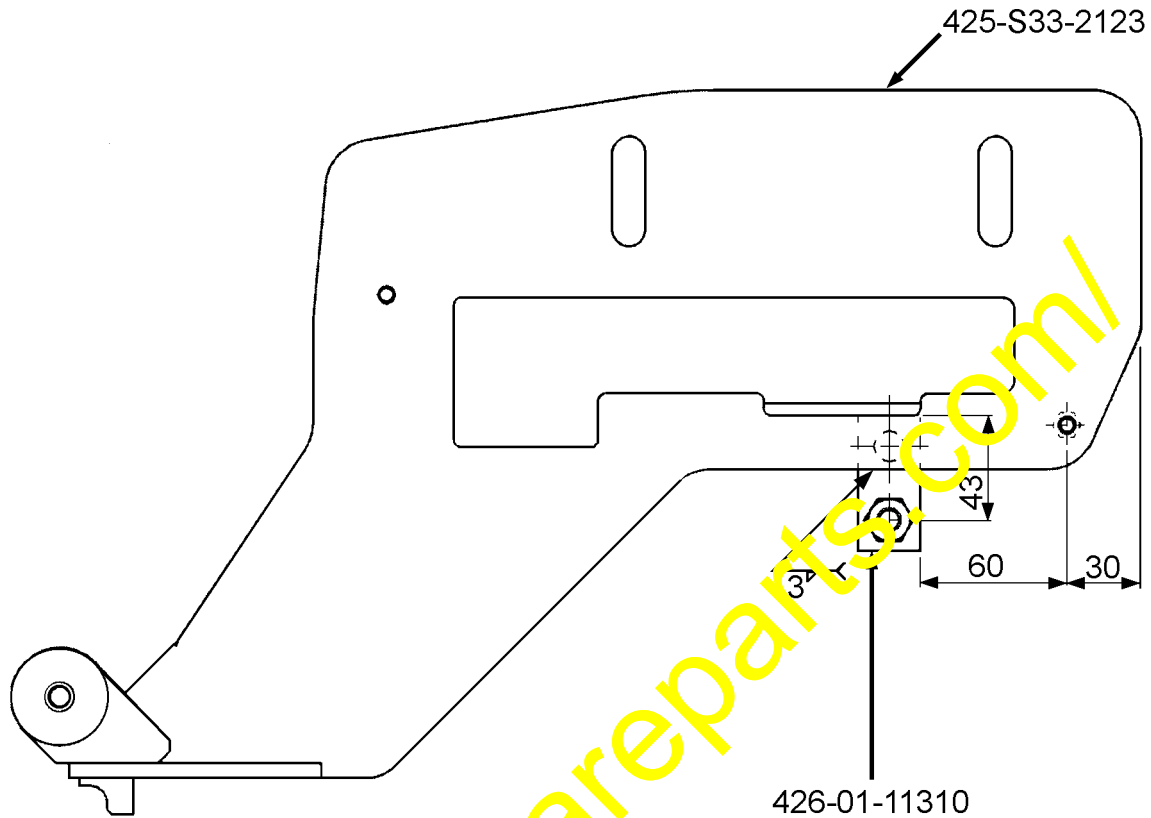

VLPS0054

5. Paint bracket 426-01-11310 to match the console.
6. Attach clip 08036-01814 to the J/S harness.
7. Use bolt 01010-81016 to attach the clip to the new bracket. When tightening bolt be sure the harness slack is toward the rear of the cab, not between the clip and J/S console.

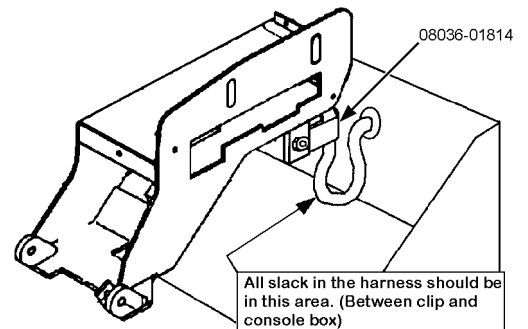

VLPS0055

8. Reattach the cover that was removed in step 3

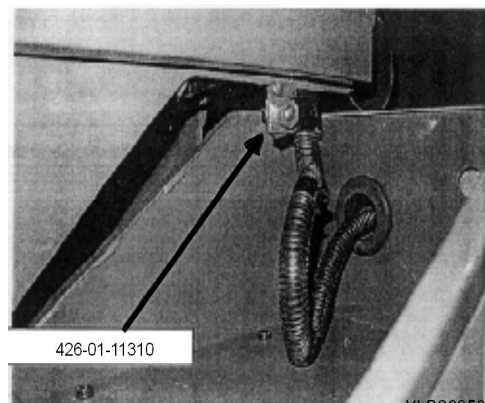

VLPS0056