

PARTS & SERVICE NEWS

REF NO. AA01010

DATE January 10, 2001

(C)

Page 1 of 4

SUBJECT: AIR CLEANER CHECK VALVE

PURPOSE: To improve durability

APPLICATION: WA600-3L Wheel Loader Serial Number A52001 through A52191

FAILURE CODE: AA00PH

DESCRIPTION:

Introduction:

This **PARTS AND SERVICE NEWS** introduces an improvement to the aspirator check valve mounting. This improvement will reduce the possibility of failure and extend the life of the check valve.

The air cleaner mount will be reworked to allow the mounting of a bracket to support the aspirator check valve.

PARTS LIST

Item	Part Number	Description	Qty	Remarks
1	426-01-A2450	Bracket	1	
2	01010-81230	Bolt	1	
3	01010-81255	Bolt	1	
4	01643-31232	Washer	8	
5	01597-01211	Nut	6	
6	426-01-A2990	Spacer	1	
7	07283-38973	U-bolt	2	
8	426-01-A7590	Hose	1	
9	07281-00709	Clamp	2	

Rework Instructions:

1. Drill two 14 mm holes in the air cleaner bracket as shown below. These holes will be used to mount the new bracket.

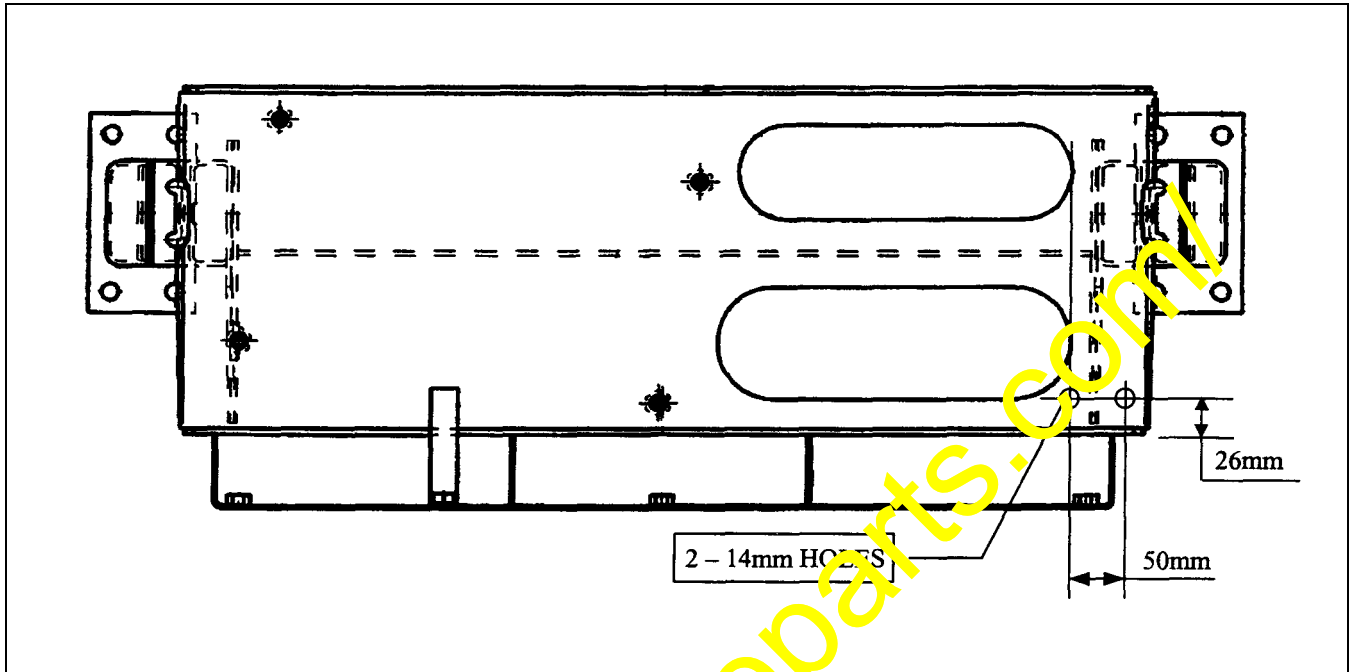

2. Cut 90 mm from tube 406-01-A2292 as shown below. Remove any sharp edges or burrs from the end after cutting.

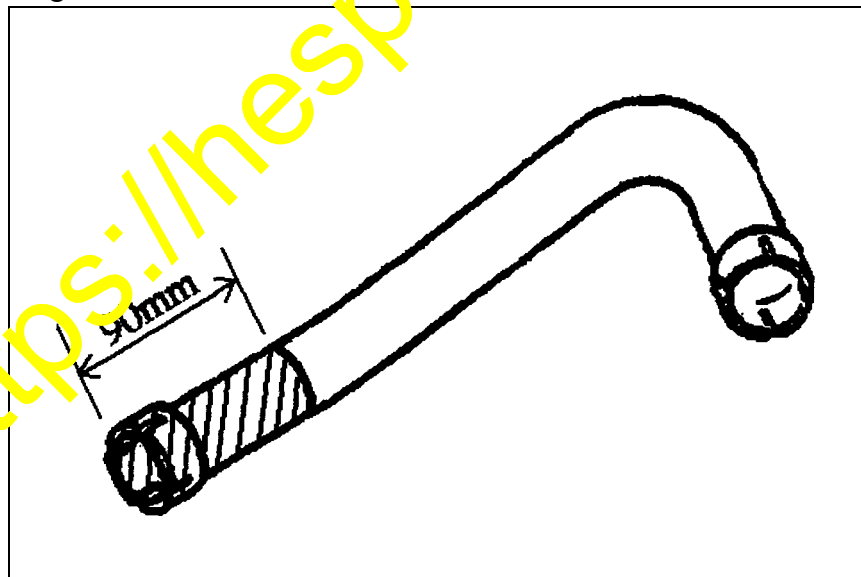

3. Install bracket (Item 1) as shown below. Make sure spacer (Item 6) is installed toward the outside of the machine.

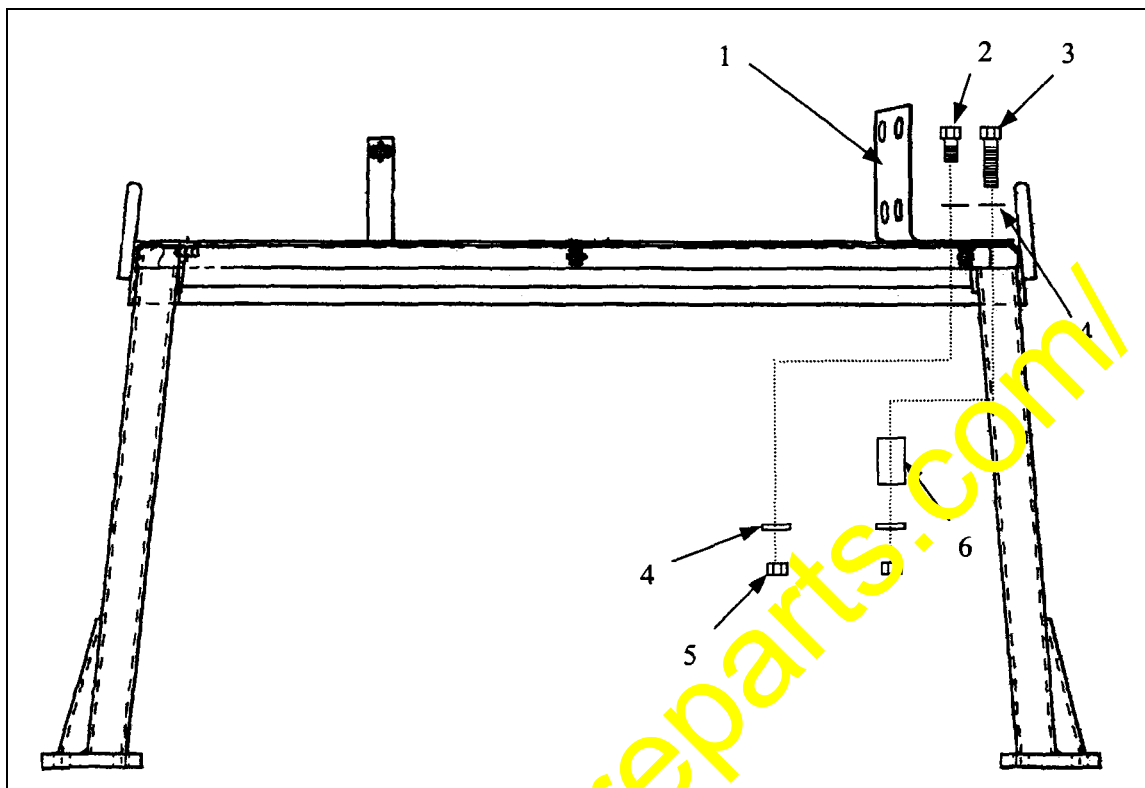

4. Install the remaining parts as shown in the figure below. Do not over tighten the nuts on the U-bolts as this will damage the check valve.

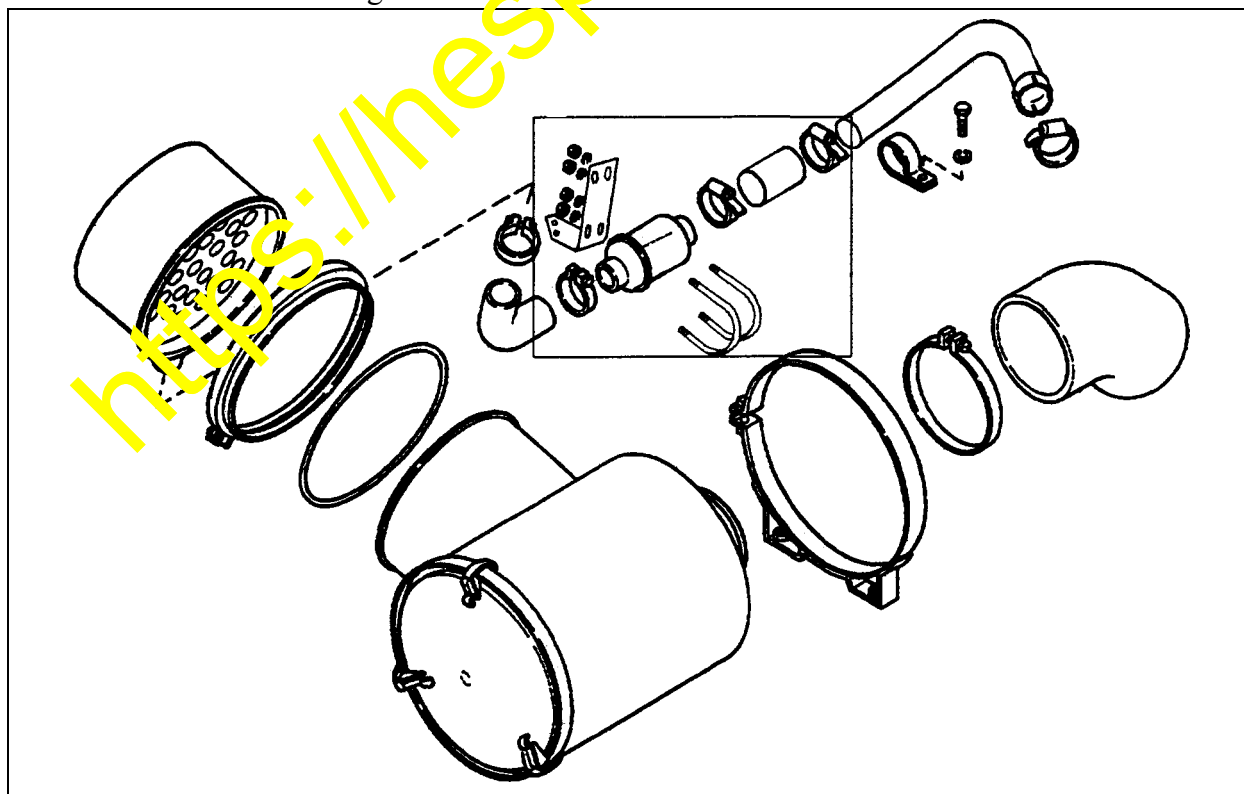

IMPORTANT: When reinstalling the check valve, make sure it is oriented properly. The figure below shows the note "TOP TO EXHAUST" which is stamped on the top of the check valve. It must be installed as shown in order for the valve to work properly.

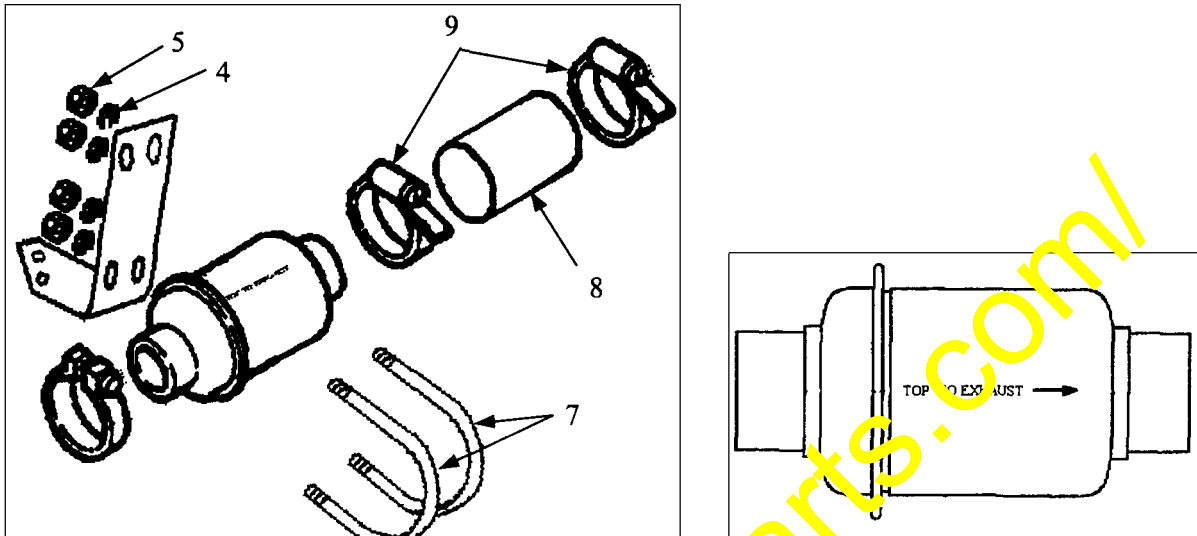

<https://hespareparts.com/>