

PARTS & SERVICE NEWS

REF NO. AA01012

DATE January 12, 2000

Page 1 of 2

SUBJECT: BATTERY BOX RELAY IMPROVEMENT KIT (MK4189)

PURPOSE: Inform Customers of Product Improvement Kit (MK4189)

APPLICATION: 530M Dump Truck - S/N (A30001 - A30038)

FAILURE CODE: D110Z9

DESCRIPTION: Replacement of Relay Switches and Wiring Contained in MK4189

A product improvement kit has been designed for use on the 530M Dump Truck. The Battery Box Relay Improvement Kit (MK4189) includes more reliable relay switches (08088-40000) for the electric power wiring. The new kit has been developed in order to replace the (PB8461) relay switches and wiring. The illustration below provides the location of the relay switches (1&2, Figure 1) in relation to the battery box (3).

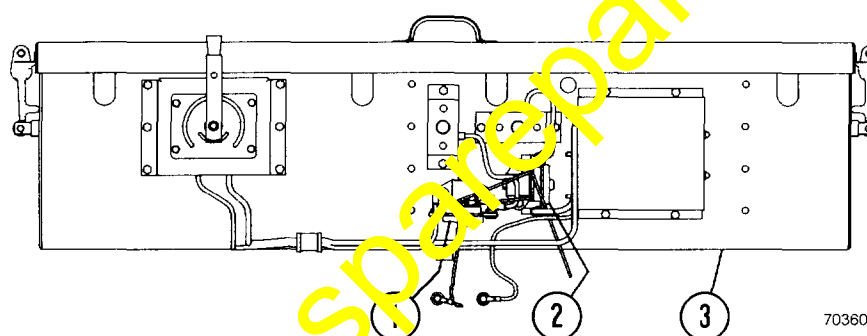

FIGURE 1. BATTERY BOX EXTERNAL COMPONENTS
 1. Power Relay (12 Volt) 3. Battery Box
 2. Power Relay (24 Volt)

Successful installation of the (MK4189) kit requires that several weld nuts be welded onto the battery box. Installation also requires that several holes be drilled into the battery box.

▲ DANGER

It will be necessary to remove the batteries from the battery box in order to prevent possible explosions ignited by welding sparks and to prevent possible punctures to the battery from drilling.

Installation of the kit (MK4189) requires the removal of some wiring and the old relay switches. The installation drawings (EJ3992 and EJ1559) will provide details that are needed in order to install the new kit. See Table 1 for the contents of the kit.

Table 1: Contents of MK4189		
EJ1559	Dwg, Lighting & Control Wiring Hook-Up	1
EJ3992	Dwg, Field Rework, Battery Box Relays	1
CH4133	Cable Str #6 Battery Red	1
CH3303	Wire Str #14 Gauge	1
CH3304	Wire Str #14 Gauge	1
CH3420	Cable Str #8 Gauge	1
CH3421	Cable Str #8 Gauge	1
0164330823	Washer	4
0101080830	Bolt	4
0808840000	Switch	2
SV7886	Nut, Weld (.25 - 20 UNC Thread)	8
MM0575	Nut, Weld M8 x 1.25	4

Prior to installing new parts, the batteries should be cleaned of dirt and corrosion in order to prevent poor connections at the terminals. Verify that all connections have been properly mated before reconnecting power. The illustration below provides the location of the relay switches (1&2, Figure 2) in relation to battery box (3) after installation.

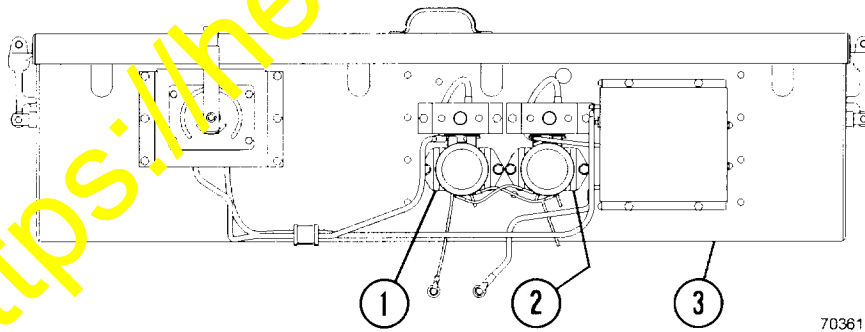

FIGURE 2. BATTERY BOX EXTERNAL COMPONENTS

- 1. Power Relay (12 Volt)
- 2. Power Relay (24 Volt)
- 3. Battery Box