

# PARTS & SERVICE NEWS

|         |               |
|---------|---------------|
| REF NO. | AA01247       |
| DATE    | Dec. 13, 2001 |

**SUBJECT:** RUBBER COMPENSATOR AT THE OIL SUCTION RESERVOIR

**PURPOSE:** Installation hints. This Parts & Service News supersedes the previous issue No. 21-272 dated November, 1988 which should be discarded

**APPLICATION:** H285S Hydraulic Shovel, S/N 78076, 78083, 78097, 78104, 78110, 78111, 78113, 78120, 78124, 78134, 78139

**FAILURE CODE:** 6A10CA

**DESCRIPTION:**

When installing a new compensator, or if during repair and maintenance work on same, the installation has to be carried out according to the following instructions:

### ASSEMBLING NEW PART

- Carefully clean sealing area ("F") of the compensator ("K") and the opposite flanges.
- Tightening torque of bolts (06)
- When mounting a new compensator or rubber below, 59 to 90 Nm.
- Do not tighten the flange connection too much, so that metal-to-metal contact would result. This would damage the rubber bead.
- Assure equal "X" dimension at the circumference of flanges.
- While tightening the bolt (06), illustration "A", do not damage the rubber below with the spanner.
- Tighten the screw connection always on the opposite side of the compensator. ***The bolt/nut on the compensator side must not be turned.***

### ASSEMBLY DURING REPAIRS AND MAINTENANCE

- Carefully clean sealing area ("F") at the compensator and the opposite flanges.
- During repairs or maintenance (without exchange of the compensator and rubber below respectfully), depending on the age hardening of the rubber material, tighten the bolts with at least 90 Nm. After putting the machine in service, check compensator for leaks and, if necessary, retighten the bolts (06) a little bit.

Drawing as example

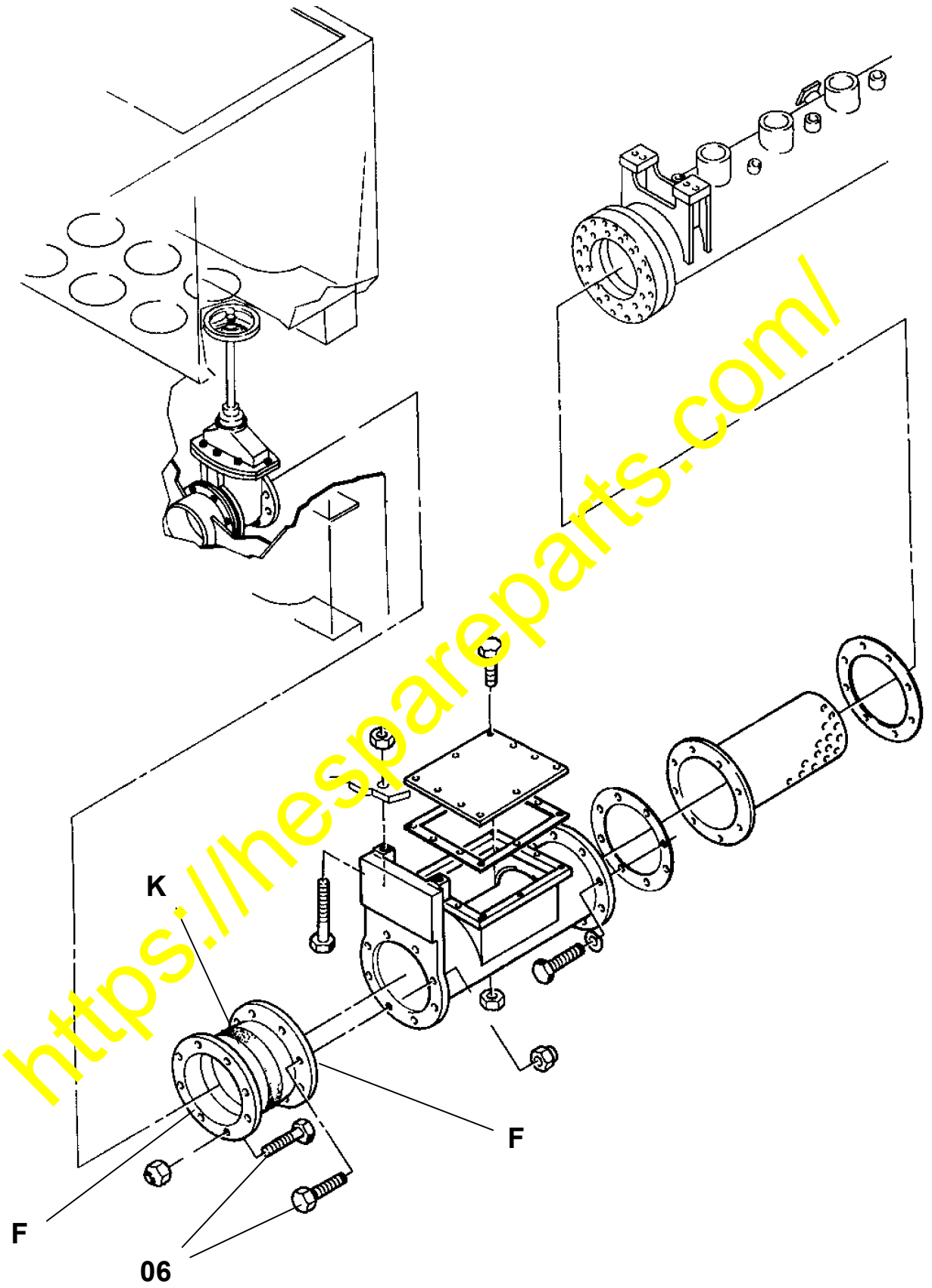

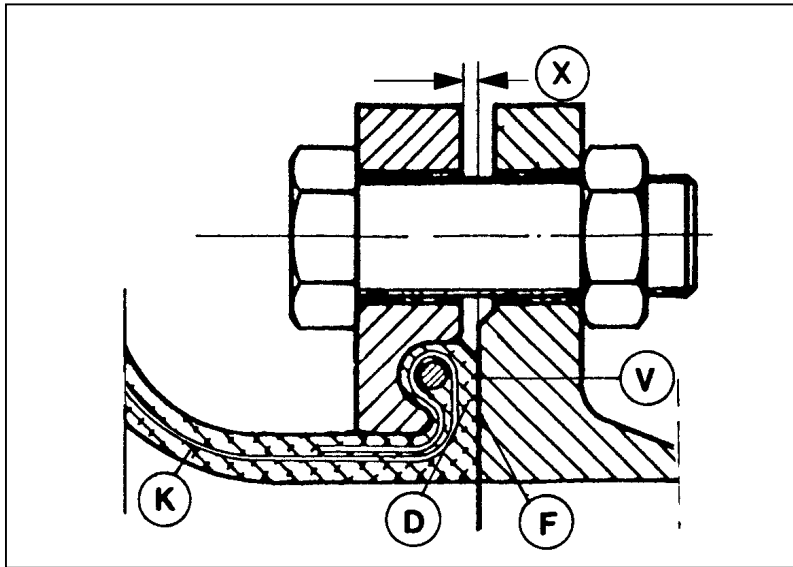

K = Compensator

D = Sealing bead

F = Sealing area

V = Compensator pretensioned

X = Gap

Y = Compensator (exchange situation)

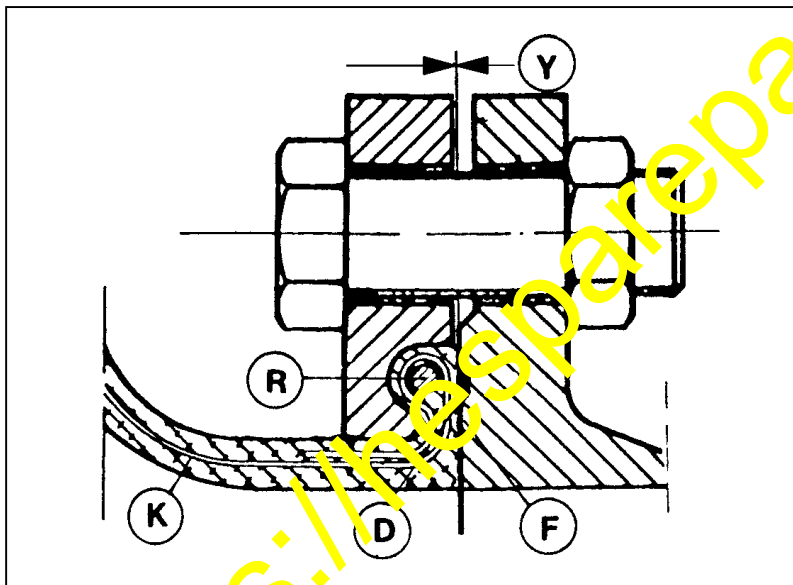

- If during removal of the compensator you notice that
  - a) the steel ring (R) in the sealing area is visible,
  - b) the sealing area (F) of the compensator (K) is porous or damaged,the rubber below has to be changed.