

PARTS & SERVICE NEWS

REF NO. AA02071

DATE March 7, 2002

(C)

Page 1 of 3

SUBJECT: NEW N14 AFTERCOOLER WATER PLUMBING**PURPOSE:** To provide the correct part numbers for the new OEM after cooler supply and return tubes, and all associated hardware.**APPLICATION:** WA500-3L Wheel Loader Serial Number A70786 thru A70832**FAILURE CODE:** A6M2AE**DESCRIPTION:****Introduction:**

The product improvements will affect engines built after 8-31-00 Engine Serial Number 12019525. The older style two-piece coolant tubes (1310 652 H1 and 1310 653 H1) with the separate elbow (6731-61-6180 and 6731-61-6190) and tube assembly is not to be used on engines after the serial number break stated above. The new style tubes (1310 652 H2 and 1310 653 H2) are one piece. See the attached diagram for proper hardware usage when replacement is required.

<https://hespareparts.com/>

COOLING SYSTEM AFTER COOLER WATER PLUMBING

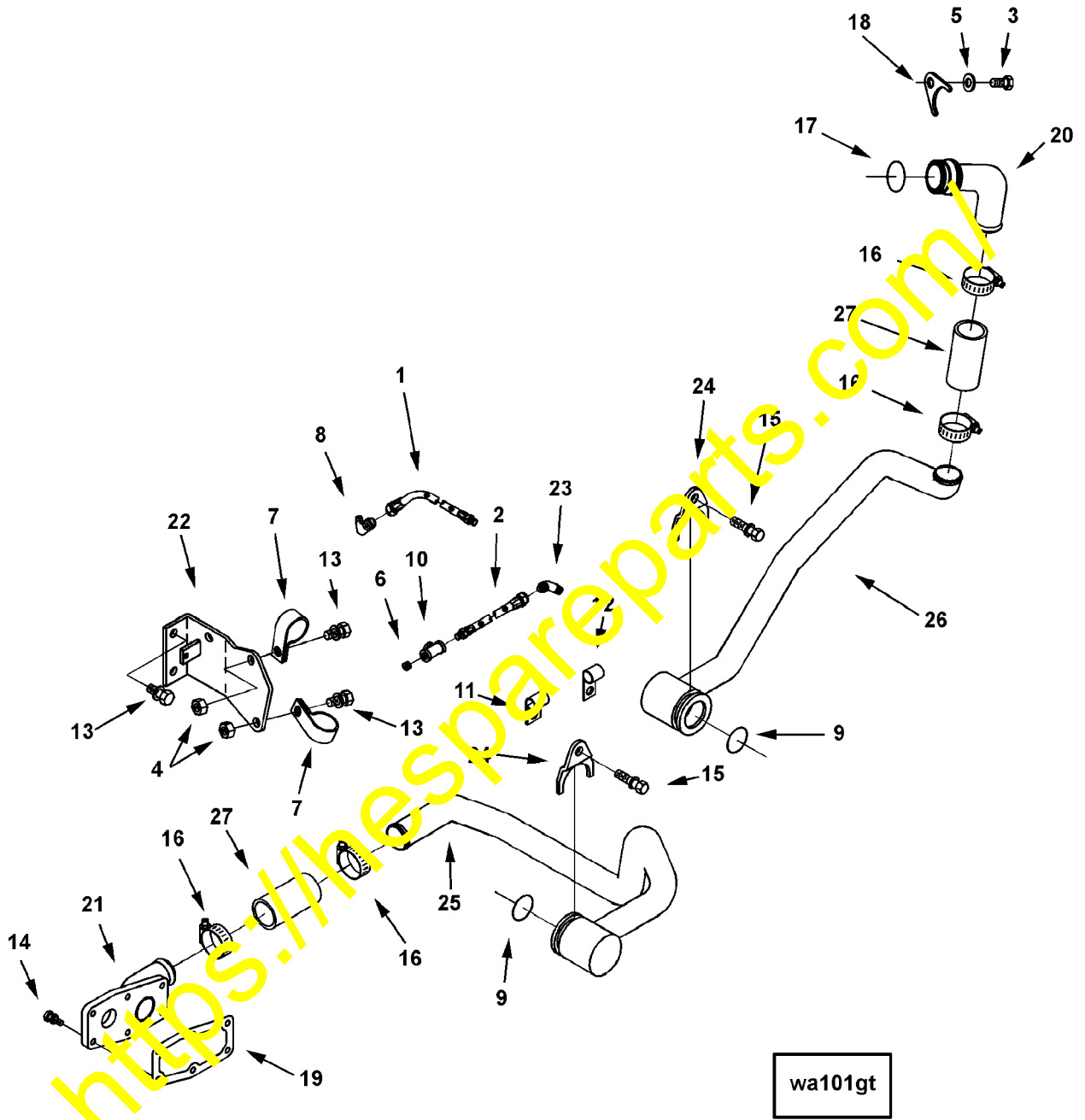

**COOLING SYSTEM
AFTER COOLER WATER PLUMBING**

Item	Part Number	Description	Qty	Remarks
1	1310 648 H1	HOSE, FLEXIBLE	1	
2	1310 649 H1	HOSE, FLEXIBLE	1	
3	1238 015 H1	SCREW, HEXAGON HEAD CAP	1	3/8 - 16 x 3/4 in.
4	25 522 R1	NUT, HEAVY HEXAGON	2	3/8 - 16 UNC.
5	6732-11-8150	WASHER, PLAIN	1	3/8 in.
6	6216-64-5810	PLUG, PIPE	1	1/8 NPT.
7	1240 404 H1	CLIP	2	
8	1240 010 H1	ELBOW, MALE ADAPTER	1	
9	1307 543 H1	SEAL, O-RING	2	
10	6733-71-5550	TEE, FEMALE PIPE	1	
11	1295 834 H1	CLIP	2	
12	6735-71-8110	CLIP	2	
13	1239 115 H1	SCREW, CAPTIVE WASHER CAP	4	3/8 - 16 x 7/8 in.
14	1239 244 H1	SCREW, CAPTIVE WASHER CAP	6	1/4 - 20 x 3/4 in.
15	1239 115 H1	SCREW, CAPTIVE WASHER CAP	2	3/8 - 16 x 1 3/8 in.
16	1239 537 H1	CLAMP, HOSE	4	
17	1307 289 H1	SEAL, O-RING	1	
18	1307 485 H1	RETAINER, PLUG	1	
19	1240 044 H2	GASKET, COVER PLATE	1	
20	1307 546 H1	TUBE, WATER TRANSFER	1	
21	1307 548 H1	CONNECTION, WATER OUTLET	1	
22	1307 549 H1	BRACKET, WATER TUBE	1	
23	1240 262 H1	ELBOW, MALE ADAPTER	1	
24	6743-62-6110	RETAINER, CONNECTION	2	
25	1310 652 H1	TUBE, WATER INLET	1	
26	1310 653 H2	TUBE, WATER OUTLET	1	
27	1246 352 H1	HOSE, PLAIN	2	