

# PARTS & SERVICE NEWS

REF NO.	AA02076
DATE	March 07, 2002

**SUBJECT:** WHEEL MOTOR DRAIN PLUGS

**PURPOSE:** To introduce to the field a new, one-piece drain plug.

**APPLICATION:** Komatsu 930E Dump Trucks AFE48-A & Up, A30019, A30026 & Up

**FAILURE CODE:** 0830Z9

**DESCRIPTION:** Drain Plug (GE0829)

A new one piece drain plug (2, Figure 1) is now available for decreasing draining time. The new plug replaces the older, two piece, pipe and cap design. The part number of the new drain plug is GE0829.

## DRAINING OIL

When draining oil from the wheel motor, rotate one of the drain plugs to the six o'clock position on the wheel. This position allows the greatest amount of oil to drain from the assembly.

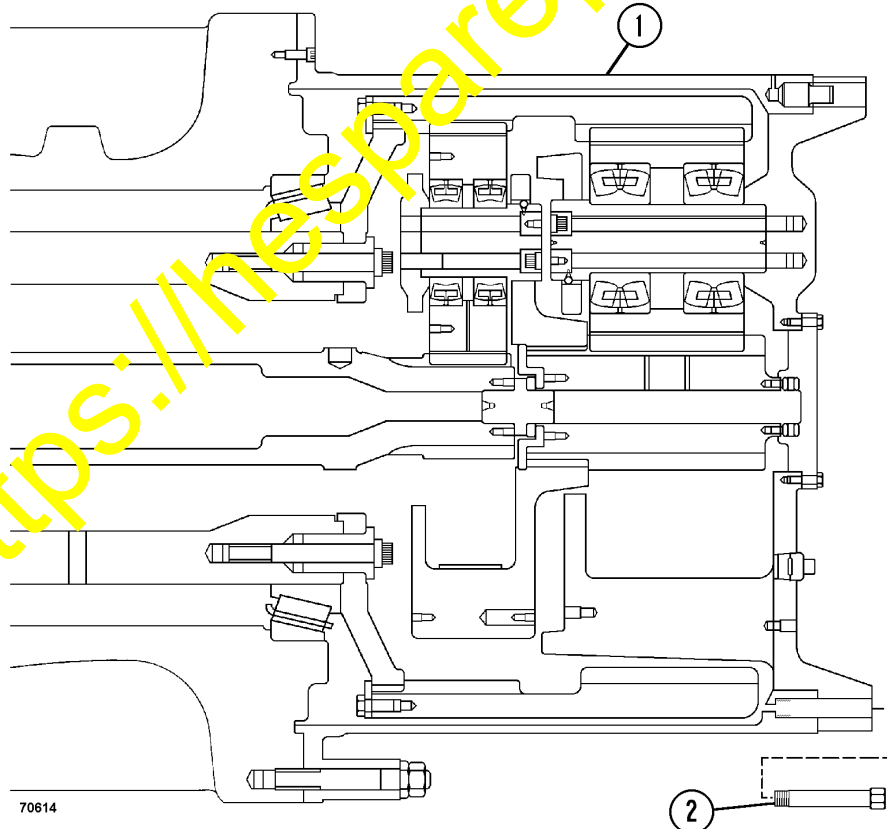

1. Wheel Motor      2. One Piece Drain Plug  
(GE0829)

FIGURE 1. WHEEL MOTOR CUTAWAY