

PARTS & SERVICE NEWS

REF NO.	AA02111
DATE	April 24, 2002

- SUBJECT:** SEVERE DUTY REAR AXLE PIVOT PIN AND BEARING KIT
- PURPOSE:** Introduce to the field a severe duty pivot pin and bearing rework kit (XK0113).
- APPLICATION:** Komatsu 930E Dump Trucks AFE48-A & UP; A30019, A30026 through A30293, A30295 through A30304
- FAILURE CODE:** 4710MA
- DESCRIPTION:** For customers that are experiencing premature rear axle pivot pin bearing failures or interference problems with the 7/8 inch diameter capscrews that clamp the bearing retainers together.

For customers that are experiencing premature pivot pin bearing failures, order and install Axle Pivot Bearing Kit (XK0113). Also, if the rear axle is oscillating to the extreme limits, the ends of the 7/8 in. diameter capscrews (5, Figure 1) may be hitting the inside walls of the frame support plates.

The kit will replace the eight existing capscrews (7/8-9 x 6 1/2 in.) with sixteen capscrews (5) that are 3/4-10 x 6 in. New bearing retainers (3) with sixteen holes are also included in the kit. The pivot eye (4) will have to be removed from the rear axle housing and have eight additional holes drilled in it to accept the additional capscrews. Refer to Figure 2 for rework information on drilling the extra holes. A new pivot pin (1) and lock plate (6) are also included in the kit. The new lock plate is now secured to the pivot pin with five capscrews (7) instead of four in previous designs.

PARTS INCLUDED IN PIVOT PIN KIT (XK0113)			
Item Number	Part Number	Description	Quantity
	JJ9925	Drawing, Axle Pivot Bearing Kit	1
1	EK0867	Pivot Pin	1
2	VL2993	Lock Nut 0.75-10 UNC G8	16
3	EK0853	Bearing Retainer	2
5	WB1154	Capscrew 12 Pt. 0.750-10 X 6	16
6	EK0866	Lock Plate	1
7	WB1059	Capscrew 12 Pt. 1.250-7 X 4.5 G9	5
8	PC1291	Spherical Bearing	1

Refer to the appropriate 930E shop manual for detailed instructions on how to remove, repair and install the pivot pin and bearing assemblies. During installation, tighten all hardware to standard torque.

NOTE: Be sure bearing (8) has received an initial application of grease before releasing the truck to production. Be certain that the automatic lubrication system is supplying grease to all locations.

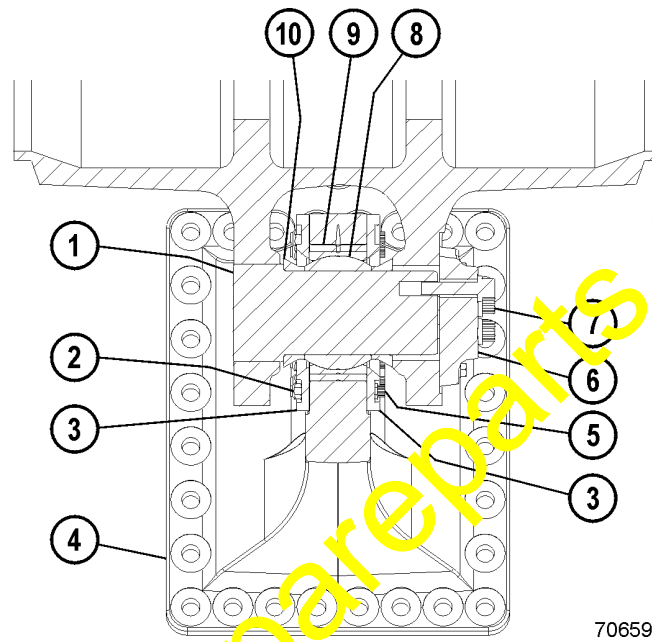

FIGURE 1. PIVOT PIN CROSS SECTION

- | | |
|--------------|--------------------|
| 1. Pin | 6. Lock Plate |
| 2. Nut | 7. Capscrew |
| 3. Retainer | 8. Bearing |
| 4. Pivot Eye | 9. Bearing Carrier |
| 5. Capscrew | 10. Spacer |

