

PARTS & SERVICE NEWS

REF NO.	AA02144
DATE	June 3, 2002

SUBJECT: ELECTRIC PILOT CONTROL HAND LEVER UNIT (JOYSTICK)

PURPOSE: Measures in case of replacement

APPLICATION: H285S Hydraulic Shovels, S/N 78076, 78083, 78097, 78104, 78110, 78111, 78113, 78120, 78124, 78134
 H455S Hydraulic Shovel, S/N 15005
 H485SE Hydraulic Shovel, S/N 12016
 PC4000-6 Hydraulic Excavator, S/N 8152

FAILURE CODE: 43A1MF

DESCRIPTION:

OLD VERSION
(903 418 40)

NEW VERSION
(894 091 40)

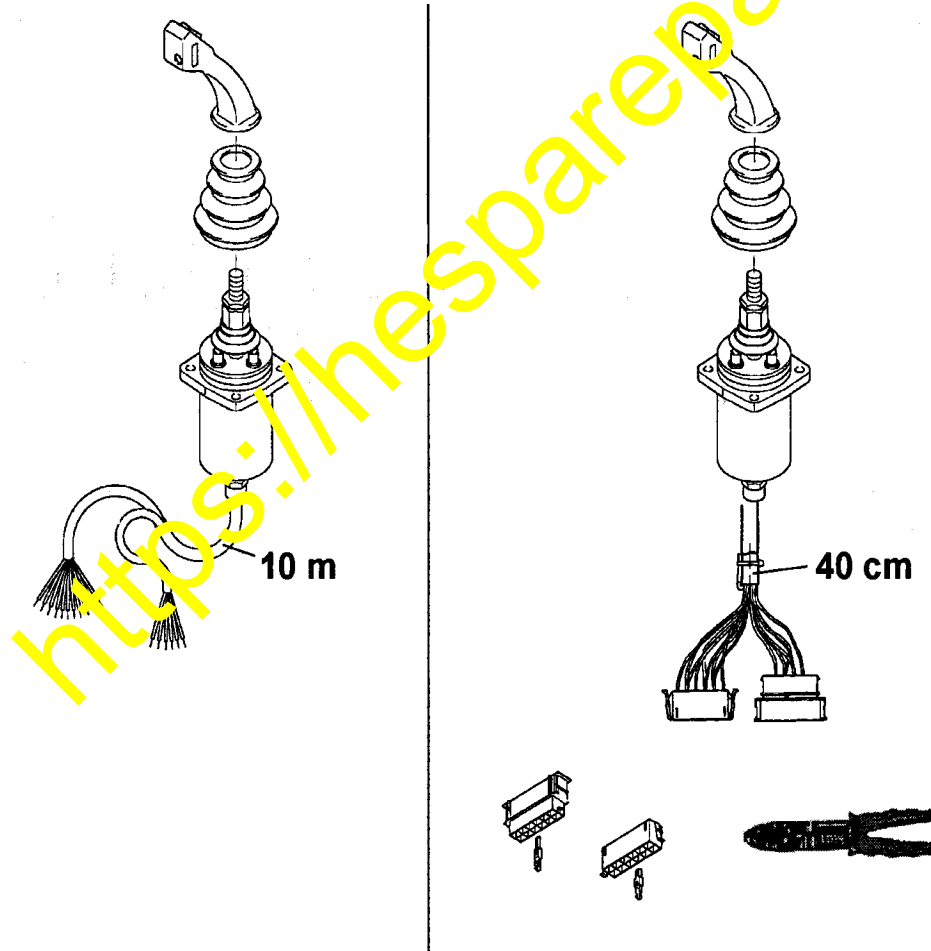

Scope of delivering

Installation

1. Cut the old cable(4) 40 cm behind the hand lever unit.
2. Replace the old hand lever unit.
3. Install the new Socket(1) and the new Housing(2) at the old cutted cable end (see table next page).
For preassembly of the contacts(3) and the tabs(3) use the Crimp pliers.
4. Connect the hand lever unit with the cable.

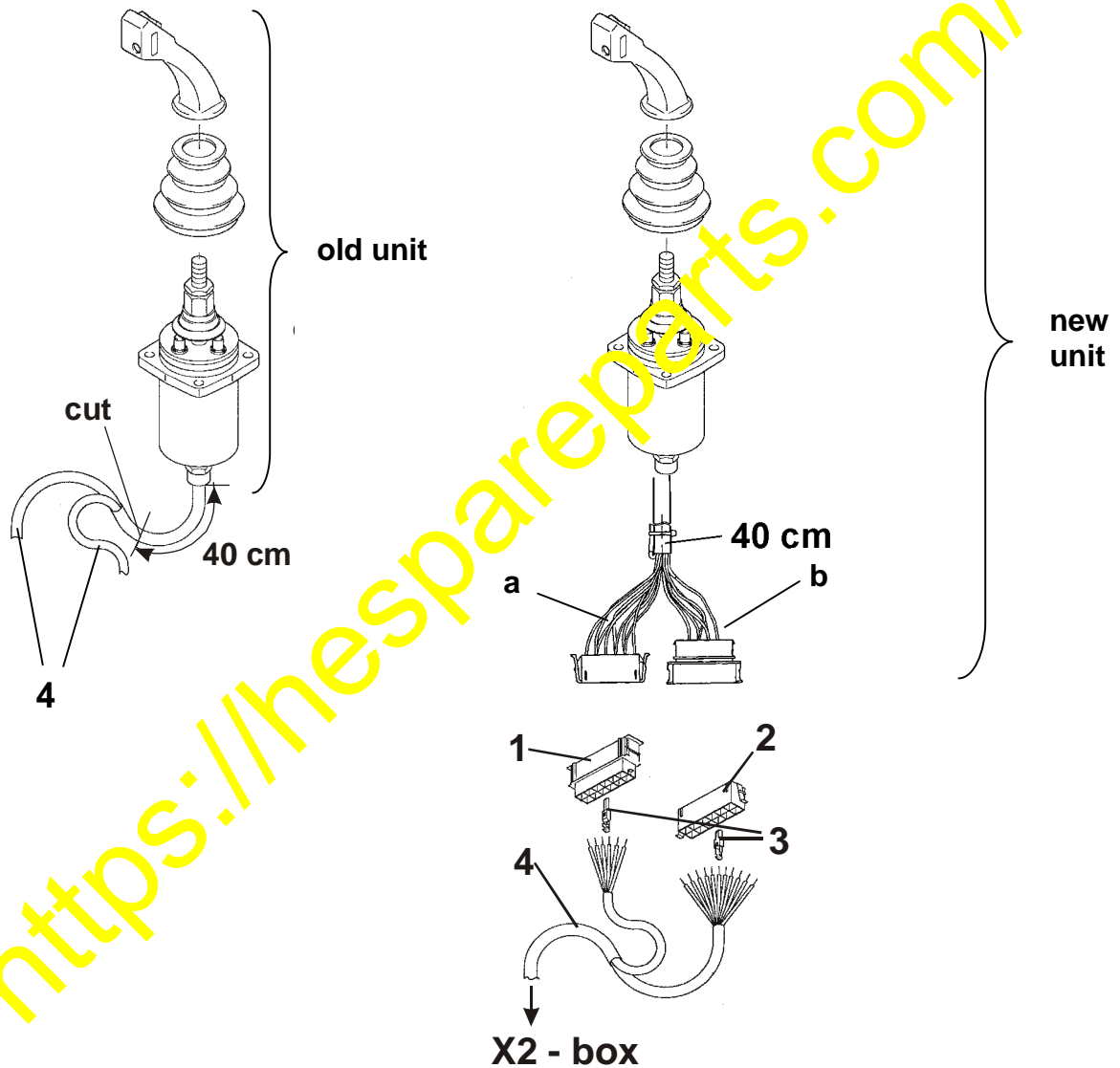

Layout for the switch unit (894 091 40)

	Hand lever unit		Old Cable	
	Male (b)		Female (2)	
	Number	Cable color	Number	Cable color
power supply (+24)	5	vio	5	vio
power supply (0V)	9	gr	9	gr
shield	3	--	3	--
signal X (-10...+10V)	8	ws gn	8	ws gn
0 V	6	ws br	6	ws br
signal Y (-10...+10V)	10	gn	10	gn

	Female (a)		Male (1)	
	Number	Cable color	Number	Cable color
0 position (X)	6	ws rs	6	ws rs
0 position (Y)	7	bl	7	bl
supply	1	ws ge	1	ws ge
direction (X+)	2	rs	2	rs
direction (X-)	3	ge	3	ge
direction (Y+)	4	ws	4	ws
direction (Y-)	5	ws bl	5	ws bl
horn	8	ws gr	8	ws gr
supply	9	sw	9	sw
rocker switch	10	rt	10	rt
tip switch (left)	11	br	11	br
tip switch (right)	12	ws rt	12	ws rt

Description of color

- be beige
- bl blue
- br brown
- ge yellow
- gn green
- gr grey
- or orange
- rs pink
- rt red
- sw black
- vio violet
- ws white