

PARTS & SERVICE NEWS

REF NO.	AA02251
DATE	November 18, 2002

SUBJECT: MODIFY FUEL TANK STEPS

PURPOSE: To resolve the Quick Fuel Fill issue.

APPLICATION: WA500-3L Wheel Loader Serial Number A70001 to A70832
WA500-3LK Wheel Loader Serial Number A71001 and up

FAILURE CODE: 0400Z9

DESCRIPTION: Modifications to the fuel tank step on the side of the machine so interference with the quick fuel fill is in resolution.

Introduction:

①	425-54-24540	STEP, RIGHT REAR	1
②	425-54-24550	STEP, ASSIST	1
③	425-54-24560	STEP, SIDE	1
④	01010-81225	BOLT, MOUNTING - M12x25	8
⑤	01010-81230	BOLT, MOUNTING - M12x30	4
⑥	01643-31232	WASHER, FLAT - M12	12
⑦	01573-22307	BOSS, FUEL TANK	1
⑧	01571-01218	BOSS, REAR FRAME	2

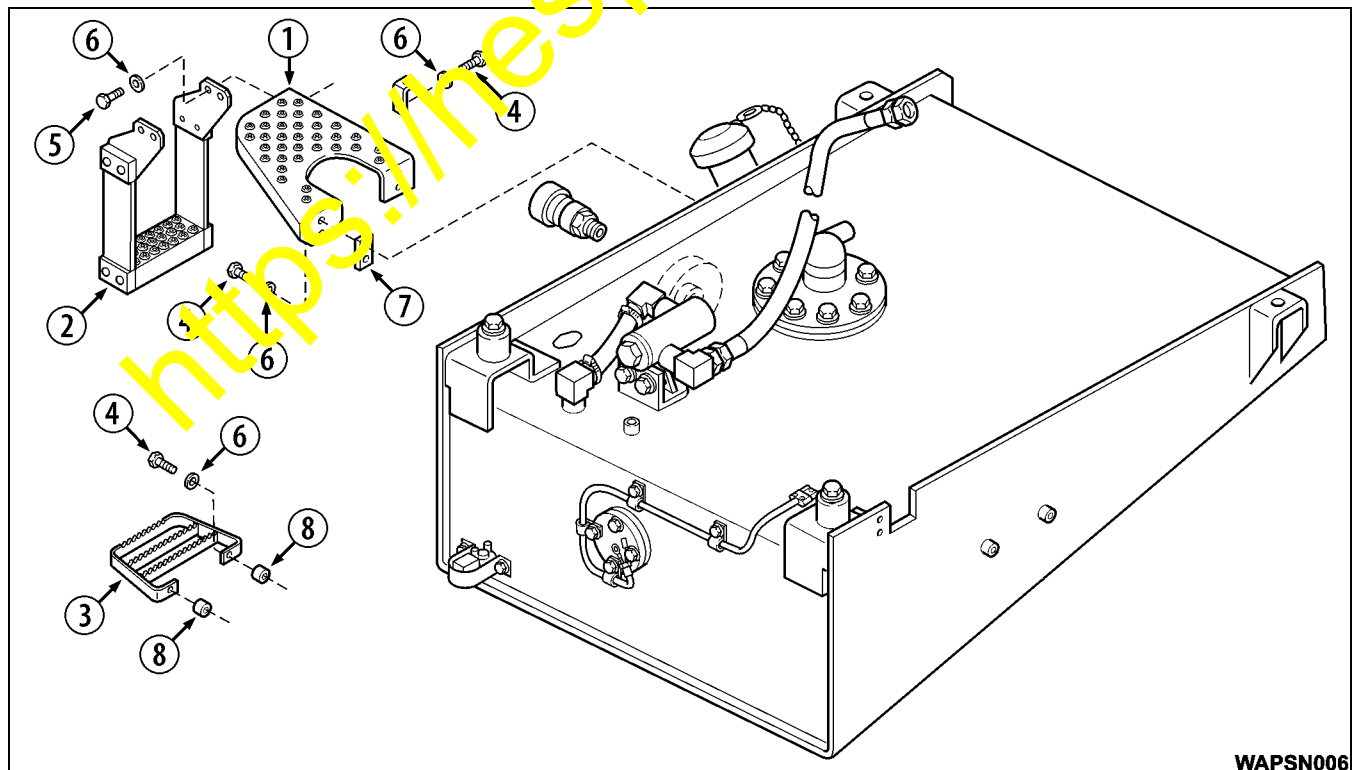

WAPSN006



WARNING! Do not weld on an empty fuel tank. Fire or explosion could result. Drain the tank completely of fuel then fill completely with water. No air or fuel vapor should be in the tank. This should prevent fire during welding.

1. Remove the two rear steps from the right side at the fuel tank and frame. Discard the steps and hardware.
2. **Rear Step:** Prepare the new surface by lightly grinding the paint away. Reposition a new boss ⑦ to the dimension shown **A**. Weld the boss in place keeping it level with the rear one.
3. **Front Step:** Prepare the new surface by lightly grinding the paint away. Reposition a new boss ⑧ to the dimension shown **B** and **C** using the same centerline as the old bosses. Weld the boss in place keeping it level.
4. Repeat the procedure for the remaining boss.
5. Clean and paint the surfaces using Komatsu Natural Yellow primer and top coat.
6. Bolt the new steps ①, ② and ③ to the fuel tank and frame using the hardware listed.
7. Drain all water from the tank and dry the inside thoroughly before refilling with fuel.

