

# PARTS & SERVICE NEWS

REF NO.	AA02252
DATE	December 19, 2002

**SUBJECT:** IMPROVED OPERATOR SEAT AND SUSPENSION ASSEMBLY

**PURPOSE:** To introduce to the field an improved operator seat and suspension assembly.

**APPLICATION:** Komatsu Wheel Loaders:  
 WA500-3LK: A71001 - A71999;  
 WA600-3LK: A53001 - A53999;  
 WA600-3L: A52001 - A52224;  
 WA700-3L: A50001 - A50027;  
 WA800-3LC: A50001 - A50024;  
 WA900-3LC: A50001 - A50028

**FAILURE CODE:** 5721ZC

**DESCRIPTION:**

Some operator seats have been found to have excessive free play and decreased stability. The operator seat suspension has not proven to be durable for heavy operator. A new operator seat (427-57-A1211) has been designed with a stronger suspension assembly. Figure 1 illustrates the new, improved seat. Refer to Table 1 for a list of parts.

In addition, suspension assembly (427-57-A1260) has been designed as a replacement suspension for current operator seats (427-57-A1210). This Part & Service News details the operator seat / seat suspension replacement procedure. Refer to Table 2 for a replacement procedure parts list.

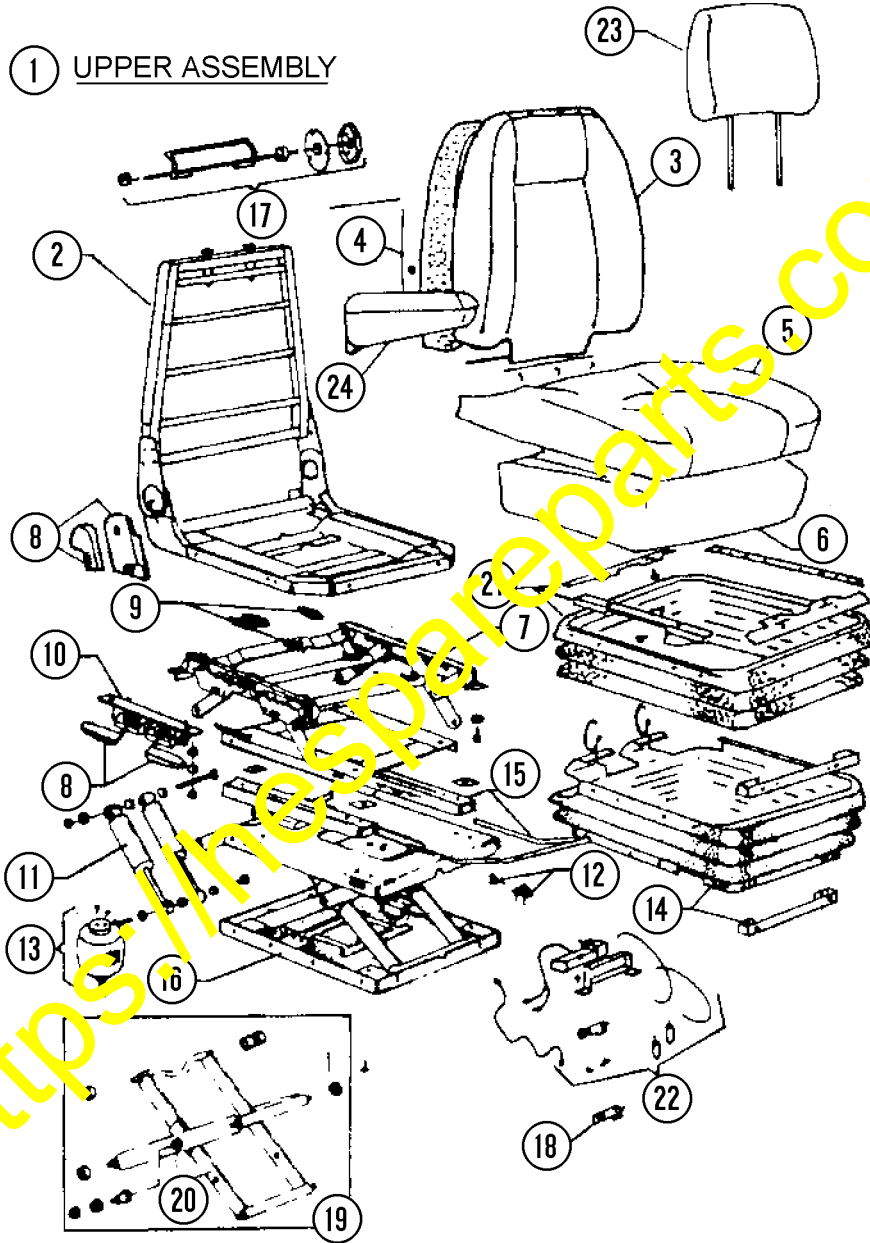

70877

FIGURE 1. OPERATOR SEAT (427-57-A1211)

**Table 1. OPERATOR SEAT (427-57-A1211)**

ITEM	PART NUMBER	DESCRIPTION	QUANTITY
1	XA0129	Upper Assembly	1
2	XA0130	Right Hand Frame Assembly	1
3	XA0131	Back Cover Kit	1
4	195-57-A0300	Back Foam Kit	1
5	195-57-A0400	Seat Cover Kit	1
6	195-57-A0500	Seat Foam Kit	1
7	XA0135	Height Riser Kit	1
8	XA0136	Handle Kit	1
9	206-57-A1480	Height Riser Spring	1
10	416-57-A1370	Height Riser Latch	1
11	XA2291	Damper Kit	1
12	195-57-A0310	Up Stop Bumper Kit	1
13	421-96-0A460	Air Spring Kit	1
14	XA0142	Suspension Cover Kit	1
15	XA0143	Fore / Aft Adjustment Kit	1
16	427-57-A1260	Suspension Assembly Kit	1
17	XA0145	Lumbar Support Kit	1
18	XA0146	Manual Valve Kit	1
19	421-96-0A490	Bearing Kit	1
20	421-96-0A510	Lever / Center Kit	1
21	XA0149	Height Riser Cover	1
22	XA0150	Compressor Kit	1
23	XA0151	Headrest Kit	1
24	XA0152	Armrest Kit	1

## Operator Seat / Seat Suspension Replacement Procedure

**Table 2. REPLACEMENT PROCEDURE PARTS LIST**

PART NUMBER	DESCRIPTION	QUANTITY	REMARKS
427-57-A1210	Operator Seat Assembly	1	Reuse with suspension (427-57-A1260) or replace with operator seat (427-57-A1211)
426-S33-2170	Bracket, Left	1	Reuse
426-S33-2180	Bracket, Right	1	Reuse
01435-00820	Bolt	6	Reuse
01580-10806	Nut	6	Reuse
01643-30823	Washer	16	Reuse
426-S33-2122	Washer	1	Reuse
02030-70725	Bolt	1	Reuse
01640-21123	Washer	1	Reuse
426-S33-2130	Plate	1	Reuse
01643-30823	Washer	1	Reuse
01252-40825	Bolt	4	Reuse
01584-00806	Nut	4	Reuse
01435-00625	Bolt	1	Reuse
01643-30623	Washer	1	Reuse
427-57-A1211	Operator Seat Assembly	1	Replacement seat with improved suspension
427-57-A1260	Suspension Assembly	1	Replacement suspension

NOTE: If operator seat and back cushions are in good condition and only the suspension needs to be replaced, then replace damaged suspension with Suspension Assembly (427-57-A1260).

## Replacing Seat Assembly

1. Disconnect joystick harness (2, Figure 2) and seat harness (7, Figure 3) from joystick console floor harness. Remove operator seat from floor frame.

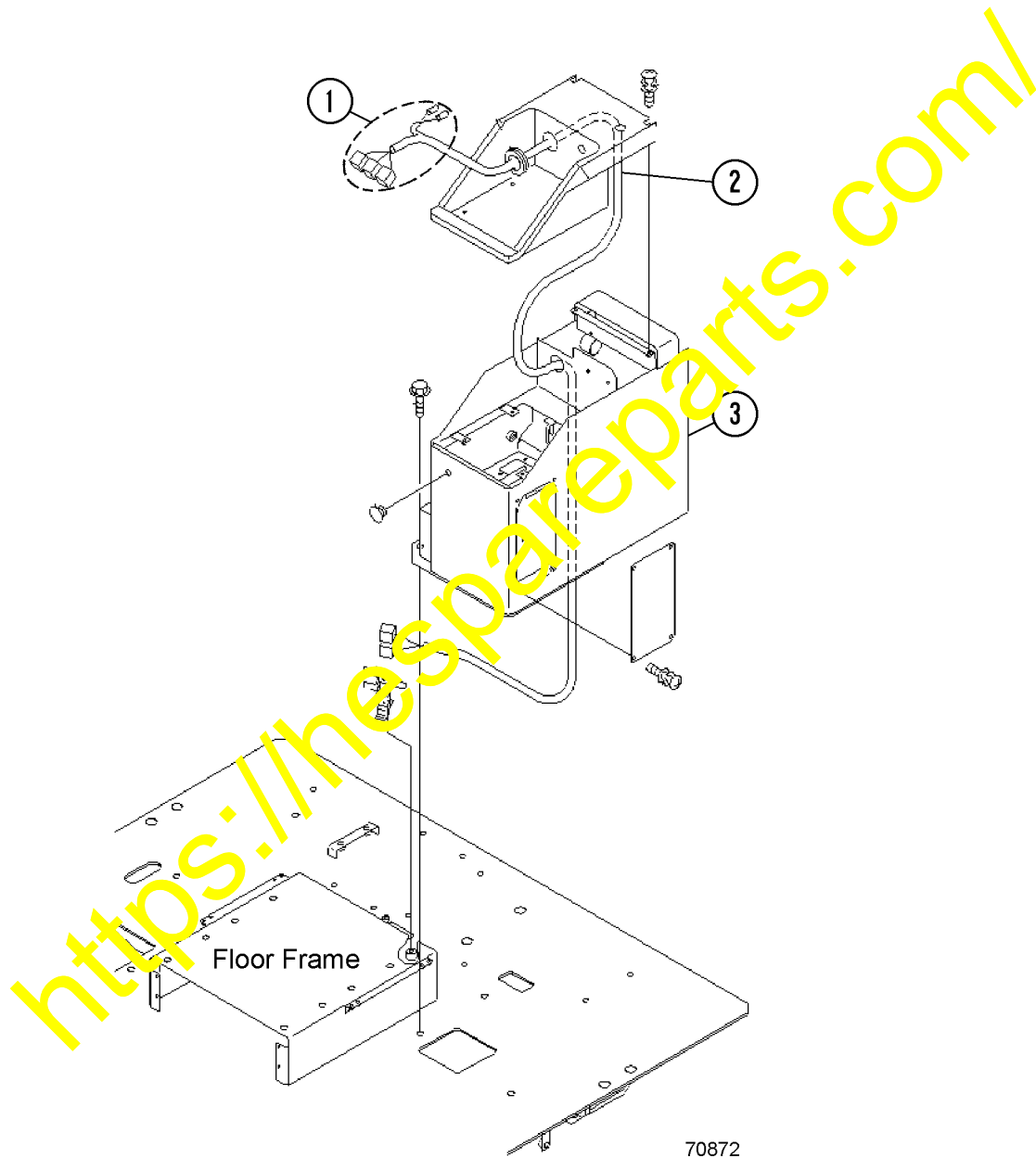
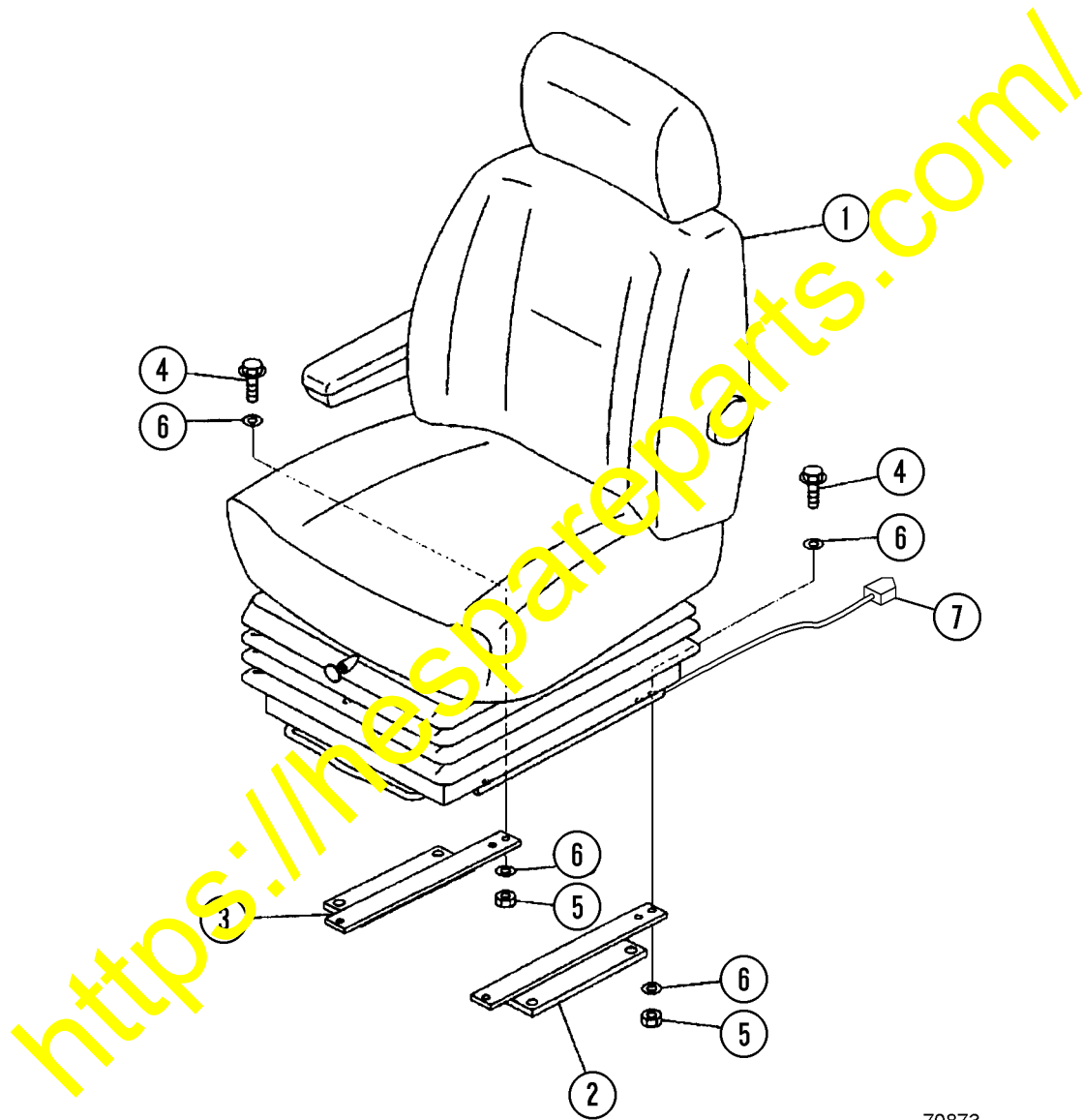

FIGURE 2. JOYSTICK HARNESS

1. Harness Connectors
2. Joystick Harness
3. Console Box

2. Remove operator seat (1, Figure 3).



70873

FIGURE 3. OPERATOR SEAT ASSEMBLY

- |                                 |                         |
|---------------------------------|-------------------------|
| 1. Operator Seat (427-57-A1210) | 5. Nut (01580-10806)    |
| 2. Left Bracket (426-S33-2170)  | 6. Washer (01643-30823) |
| 3. Right Bracket (426-S33-2180) | 7. Seat Harness         |
| 4. Bolt (01435-00820)           |                         |

3. Remove joystick assembly bracket (1, Figure 4) from the operator seat.

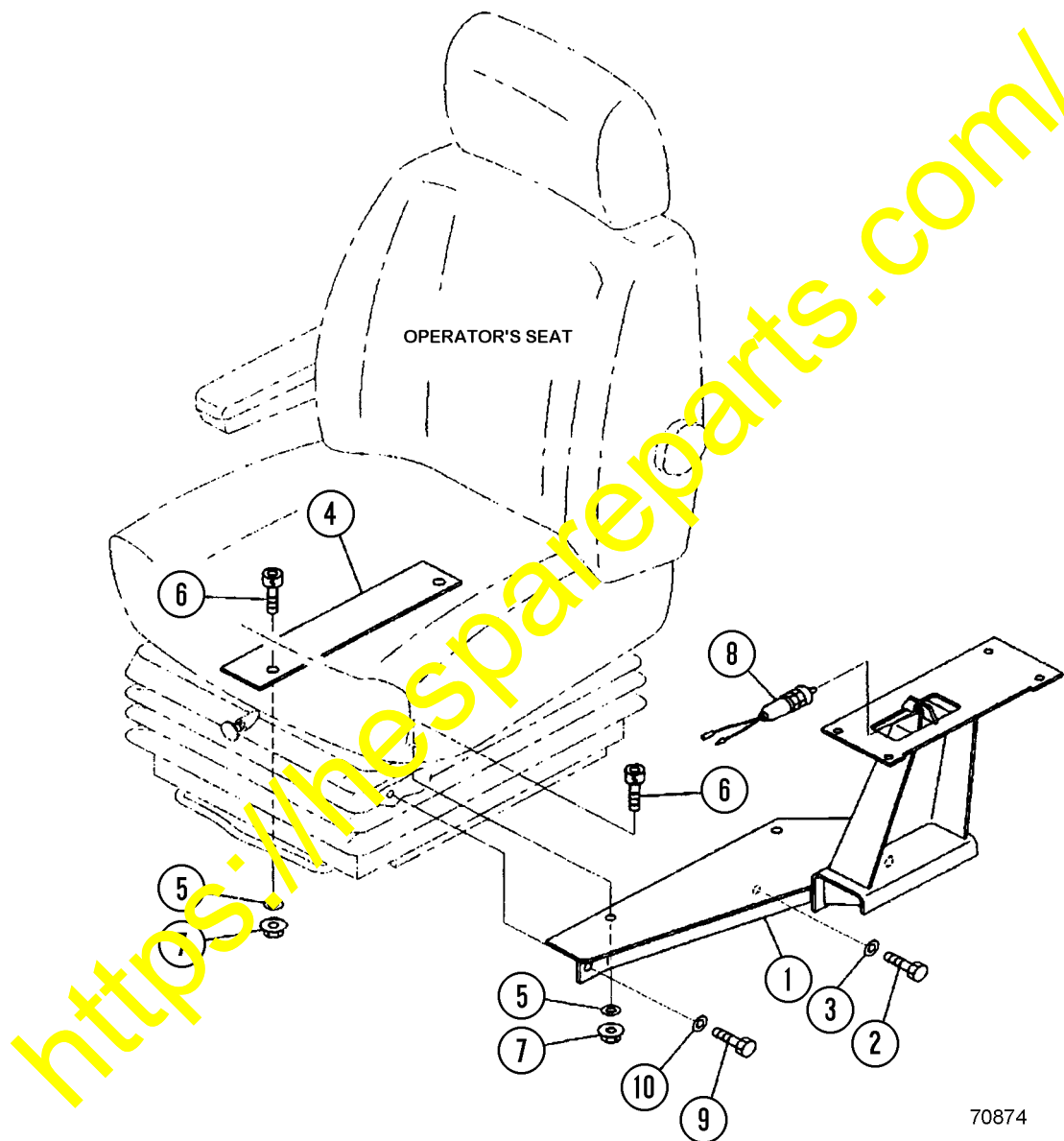

70874

FIGURE 4. JOYSTICK ASSEMBLY BRACKET

- |                           |                          |
|---------------------------|--------------------------|
| 1. Bracket (426-S33-2130) | 6. Bolt (01252-40825)    |
| 2. Bolt (02030-70725)     | 7. Nut (01584-00806)     |
| 3. Washer (01640-21123)   | 8. System Cut-Off Switch |
| 4. Plate (426-S33-2130)   | 9. Bolt (01435-00625)    |
| 5. Washer (01643-30823)   | 10. Washer (01643-30623) |

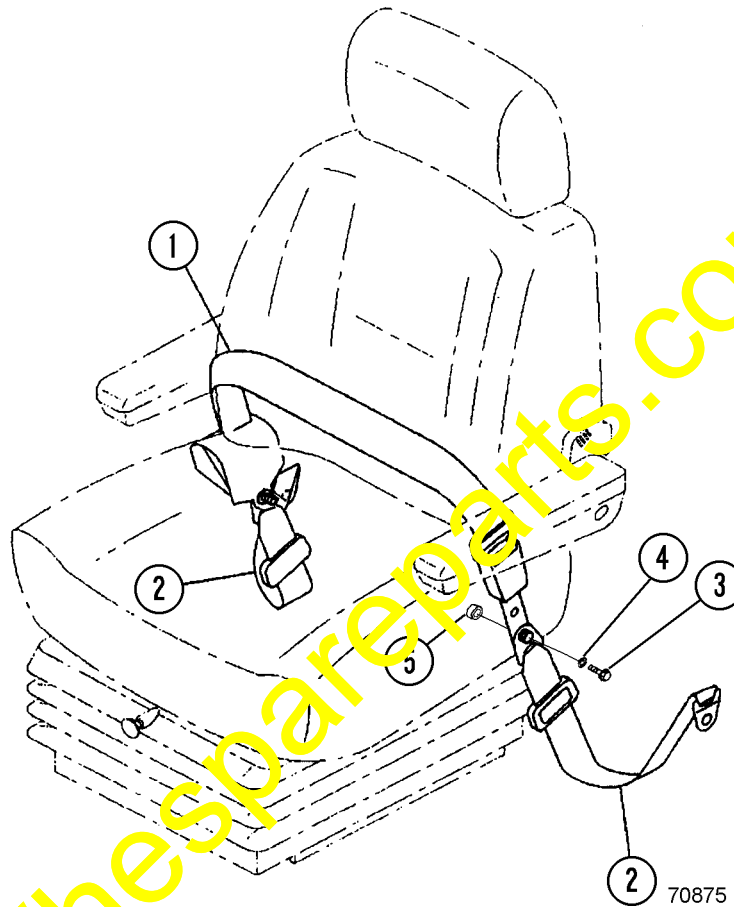

FIGURE 5. SEAT BELT

- |                                |                     |
|--------------------------------|---------------------|
| 1. Belt, Lap (427-57-A1250)    | 4. Washer (VC 6503) |
| 2. Belt, Tether (427-57-A1230) | 5. Spacer (VC 1966) |
| 3. Bolt (WA 4069)              |                     |

4. Remove seat belt (1 & 2, Figure 5) from operator seat.
5. Install joystick assembly bracket (1, Figure 4) on new seat (427-57-A1211). Separate the operator seat suspension from the seat upper (backrest and seat cushions) in order to install the joystick assembly.
6. Install seat belt (1 & 2, Figure 5) on new seat (427-57-A1211).
7. Install new seat assembly with joystick assembly on the cab floor. Refer to Figure 3. Connect seat harness (7, Figure 3) and joystick harness (2, Figure 2).



## Replacing Suspension Assembly

If current seat upper (backrest and seat cushions) is in good condition and the suspension is the problem then replace failed suspension with new suspension (427-57-A1260). Refer to Figure 6. Reuse all undamaged applicable parts.

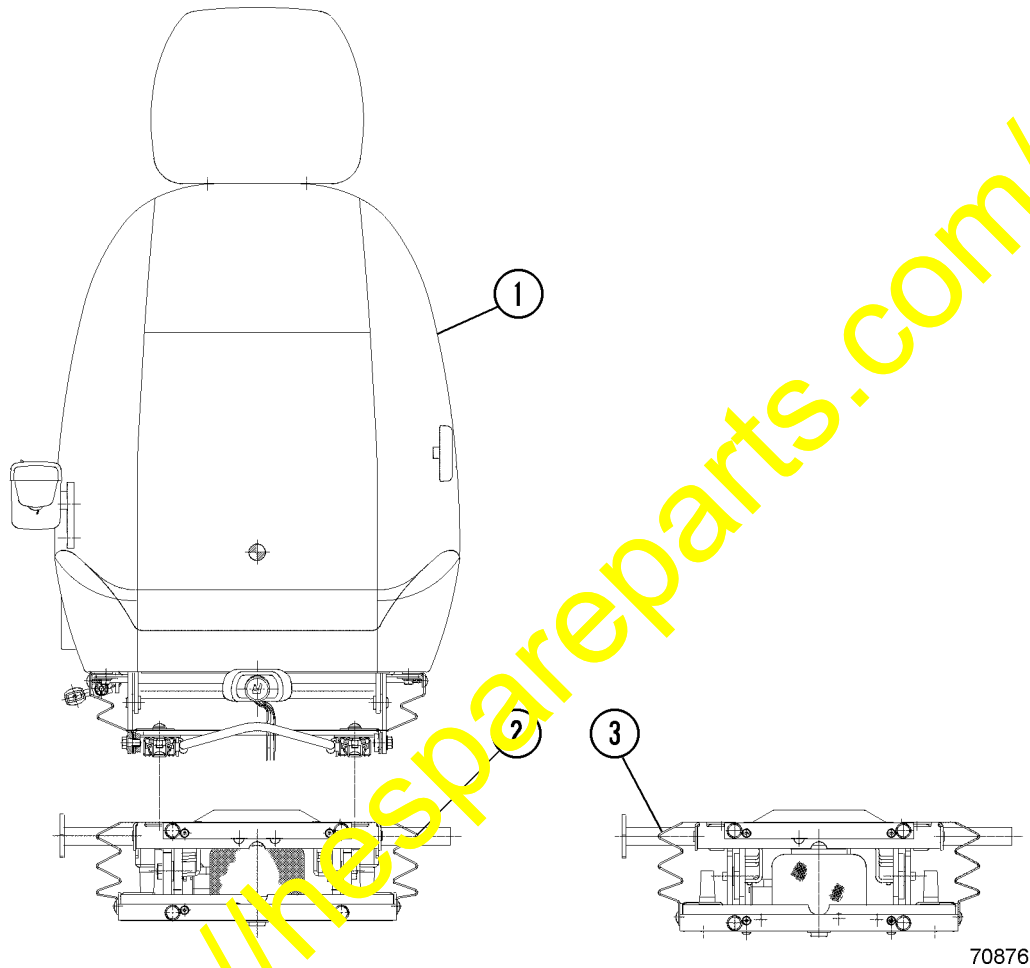

FIGURE 6. REPLACING SUSPENSION

1. Operator Seat
2. Damaged Suspension
3. Replacement Suspension (427-57-A1260)