

PARTS & SERVICE NEWS

REF NO.	AA02255
DATE	November 14, 2002

SUBJECT: HOIST PUMP CONVERSIONS FOR MINIMIZATION OF STOCK

PURPOSE: To provide the field with instructions for pump conversions that will allow a reduction in stocked parts.

APPLICATION: Komatsu 830E Dump Trucks: 31320-32825, A30544 & Up

FAILURE CODE: J150Z9

DESCRIPTION:

During the progression of the 830E dump truck throughout the years, two different hoist pumps have been used. The two pumps, while similar, are not identical. The transition plate and coupling on each pump differ for compatibility with different steering/brake pumps. To prevent the need for stocking both pumps, two procedures are outlined in this bulletin for converting the PB7943 pump to a PB8761 pump, and vice versa. Follow the procedures in this bulletin to convert the pumps.

<https://hespareparts.com/>

Converting PB7943 to PB8761

Refer to Table 1 for a listing of parts included in pump rework kit (PB8769). This kit contains the parts that are necessary to convert PB7943 to PB8761.

NOTE: O-Ring (9, Figure 2) is not part of the pump assembly, nor is it part of pump rework kit (PB8769). It is stocked separately. The O-Ring part number is WA0098.

Part Number	Description	Quantity
VE8966	Coupling	1
WA0155	O-Ring	1
WA0158	O-Ring	1
VE8967	Plate, Transition	1

1. Remove coupling (6, Figure 1) and two snap rings (5). The coupling and snap rings must be cleaned, inspected, and if acceptable for reuse, placed in parts stock.
2. Remove four nuts (7) and the washers from pump (PB7943).
3. Separate bearing plate (2) from the pump.
4. Remove and discard O-Ring (8).
5. Remove eight capscrews (1), and separate bearing plate (2) from transition plate (3). The transition plate must be cleaned, inspected, and if acceptable for reuse, placed in parts stock.
6. Remove and discard O-Ring (4).
7. Ensure all parts are clean and free of dirt and debris.
8. Lubricate the WA0155 O-Ring (4, Figure 2) and install into VE8967 transition plate (3).
9. Place bearing plate (2) into position on VE8967 transition plate (3). (The bearing plates are identical on both pumps, and therefore, the previously removed bearing plate can be reused for the conversion.)
10. Install eight capscrews (1). Tighten the capscrews to standard torque.
11. Lubricate the WA0158 O-Ring (8), and install into the O-ring groove on the pump.
12. Place the bearing plate/transition plate assembly into position on the pump.
13. Install the washers and four nuts (7). Tighten the nuts to standard torque.
14. Install coupling (6). Snap ring (5) has not only been deemed unnecessary for coupling retention, but in some cases, depending on tolerance stack-up, can also cause excessive axial loading on pump components. Do Not install this snap ring.

The pump is now a PB8761 pump. The old part number should be scratched out and the new part number stamped in place of the old.

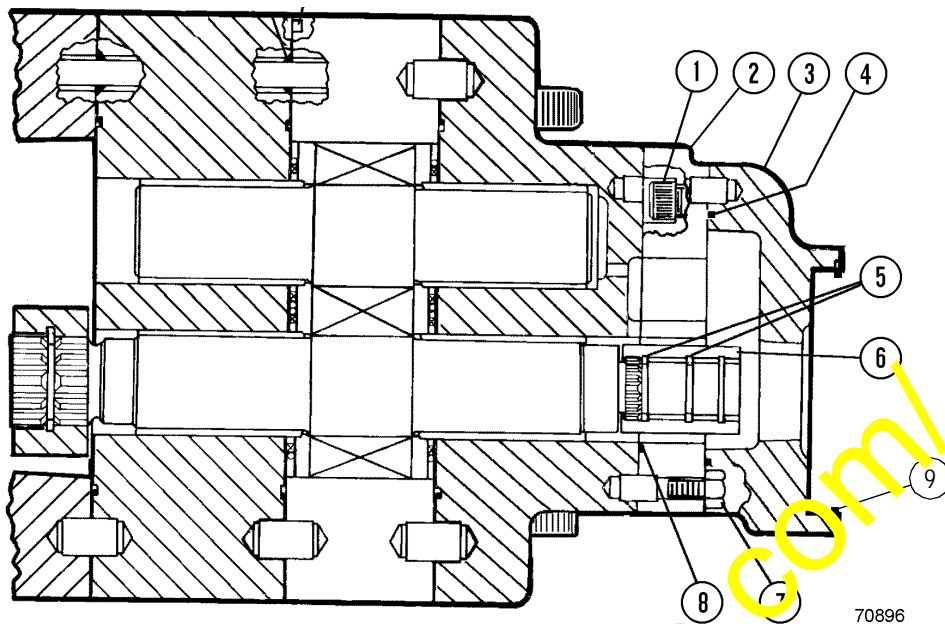

70896

- | | |
|------------------------------|----------------------|
| 1. Capscrew (VE3598) | 6. Coupling (VE3200) |
| 2. Bearing Plate (VE3575) | 7. Nut (VE3203) |
| 3. Transition Plate (VE3576) | 8. O-Ring (WA0158) |
| 4. O-Ring (WA0157) | 9. O-Ring (VL5418) |
| 5. Snap Ring (VE3600) | |

FIGURE 1. HOIST PUMP - B7943

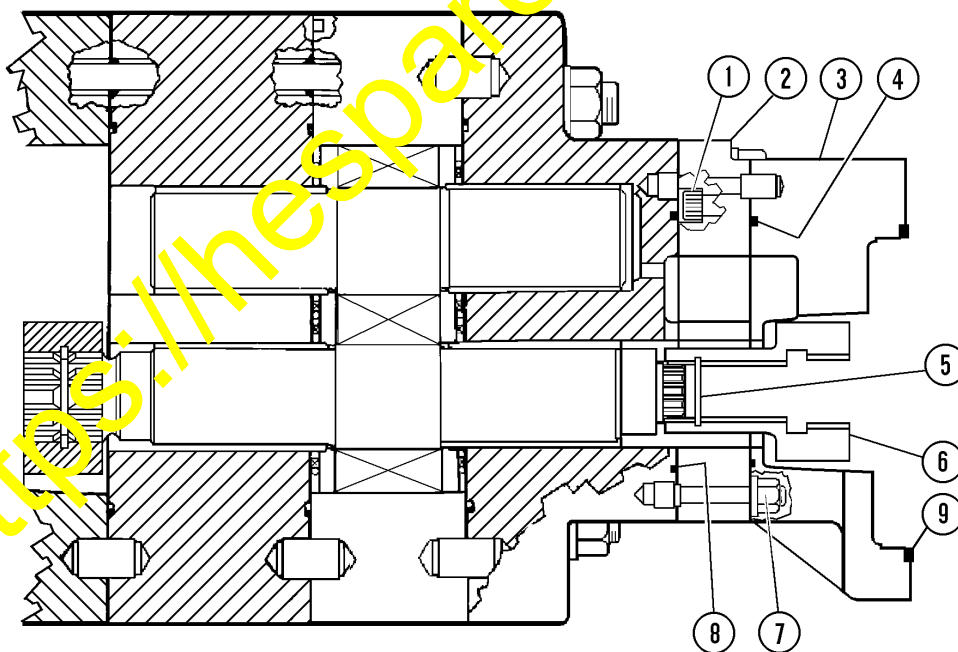

70894

- | | |
|------------------------------|----------------------|
| 1. Capscrew (BF0093) | 6. Coupling (VE8966) |
| 2. Bearing Plate (VE3575) | 7. Nut (LA0065) |
| 3. Transition Plate (VE8967) | 8. O-Ring (WA0158) |
| 4. O-Ring (WA0155) | 9. O-Ring (WA0098) |
| 5. Snap Ring (VE3600) | |

FIGURE 2. HOIST PUMP - PB8761

Converting PB8761 to PB7943

Refer to Table 2 for a listing of parts necessary for this conversion.

NOTE: O-Ring (9, Figure 1) is not part of the pump assembly. It is stocked separately. The O-Ring part number is VL5418.

Part Number	Description	Quantity
VE5200	Coupling	1
VE3600	Snap Ring	2
WA0157	O-Ring	1
WA0158	O-Ring	1
VE3576	Plate, Transition	1

1. Remove four nuts (7, Figure 2) and the washers from pump (PB8761).
2. Separate bearing plate (2) from the pump.
3. Remove and discard O-Ring (8).
4. Remove coupling (6). Discard snap ring (5), if present. The coupling must be cleaned, inspected, and if acceptable for reuse, placed in parts stock.
5. Remove eight capscrews (1), and separate bearing plate (2) from transition plate (3). The transition plate must be cleaned, inspected, and if acceptable for reuse, placed in parts stock.
6. Remove and discard O-Ring (4).
7. Ensure all parts are clean and free of dirt and debris.
8. Lubricate the WA0157 O-Ring (4, Figure 1) and install into VE3576 transition plate (3).
9. Place bearing plate (2) into position on VE3576 transition plate (3). (The bearing plates are identical on both pumps, and therefore, the previously removed bearing plate can be reused for the conversion.)
10. Install eight capscrews (1). Tighten the capscrews to standard torque.
11. Lubricate the WA0158 O-Ring (8), and install into the O-ring groove on the pump.
12. Place the bearing plate/transition plate assembly into position on the pump.
13. Install the washers and four nuts (7). Tighten the nuts to standard torque.
14. Install two snap rings (5) into the VE5200 coupling (6). Ensure the snap rings are in the proper snap ring grooves, as shown in Figure 1. Install the coupling onto the shaft.

The pump is now a PB7943 pump. The old part number should be scratched out and the new part number stamped in place of the old.