

PARTS & SERVICE NEWS

REF NO.	AA03100
DATE	June 26, 2003

SUBJECT: LOCKUP CLUTCH ECMV FAILURES

PURPOSE: To introduce a kit for improving service life of the lockup clutch ECMV.

APPLICATION: Komatsu Mechanical Drive Dump Trucks:
 530M: A30001 thru A30038, 32628;
 HD1500: A30039 thru A30071

FAILURE CODE: 159SZC

DESCRIPTION: Lockup Clutch Accumulator Kit (EK4620)

Some trucks in operation may experience failures of the lockup clutch ECMV (Electronic Control Modulation Valve). Some of these failures are caused by normal system pressure pulsations in the fill switch hydraulic circuit. Repeated pulsations acting on the switch can cause the switch to fail. A kit has been developed that consists of an accumulator and related parts for damping the pressure pulsations to preserve the life of the fill switch. Refer to Table 1 for a complete listing of kit contents. Drawing (EK7451) is included in the kit, and contains the necessary installation instructions. Refer to Figure 1 for a illustration of the kit installation.

TABLE 1. LOCKUP CLUTCH ACCUMULATOR KIT (EK4620)

Part Number	Description	Quantity
EK7451	Accumulator Kit Drawing	1
01010-81030	Bolt	2
01010-81035	Bolt	1
01010-81065	Bolt	1
01011-81005	Bolt	1
01580-01008	Nut	4
01597-01009	Nut	4
01620-31022	Washer	15
07280-37060	Pipe Clip	2
15K-911-3190	Nipple	1
562-13-46700	Accumulator	1
562-13-46930	Bracket	1
562-13-46941	Bracket	1
562-13-46951	Tube	1
562-13-46960	Plate	1
562-13-49540	Nipple	1
562-15-25842	Cover (rework from existing 562-15-25841)	0

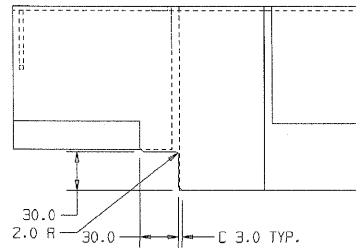
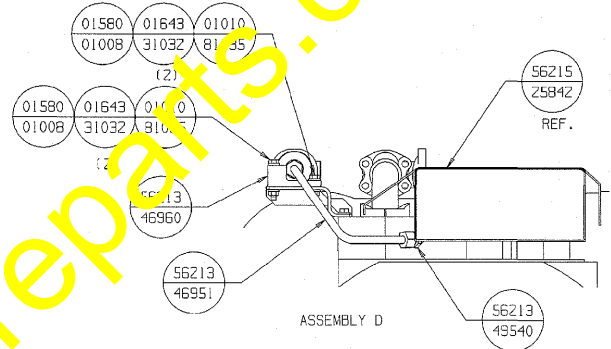
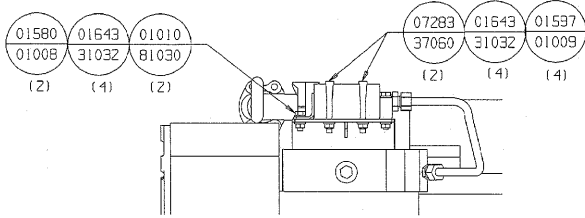
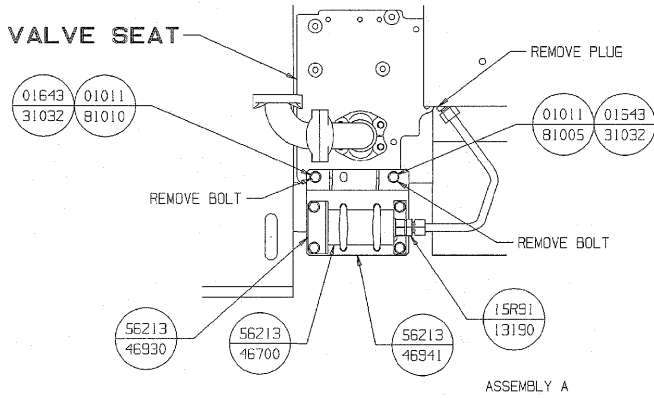

COVER REWORK

FIGURE 1. ACCUMULATOR KIT INSTALLATION