

PARTS & SERVICE NEWS

REF NO.	AA03139
DATE	October 8, 2003

(C) Page 1 of 6

SUBJECT: STRONGER FRONT COVER IN CENTER BUMPER FOR USE IN SEVERE APPLICATION.

PURPOSE: The front cover uses thicker steel and heavy wall pipe for increased strength from damage.

APPLICATION: HM350-1 Dump Truck Serial Number 1001 and UP
HM400-1 Dump Truck Serial Number 1001 and UP

FAILURE CODE: 5414Z9

DESCRIPTION: When installed the stronger front cover will offer more protection from damage in a severe application.

Remark

This stronger front cover was developed for customers who operate in severe application.

MACHINE PREPARATION

1. Park the machine on a flat level surface; lower the work equipment to the ground. Shut off the engine and cycle the controls to remove any residual hydraulic pressure from the work equipment circuits. Turn the parking brake switch on and block the tires.
2. Remove the key from the start switch until the repairs are complete. Place a tag on the steering controls advising: "This machine is being repaired. It should not be started or moved for any reason until the tag is removed by the person doing the repairs."



WARNING! Observe all safety and precautionary standards as dictated by the environment and work conditions under which the equipment will be inspected, reworked and repaired. Consult the "Shop Manual" and "Operator's and Maintenance Manual" and your "Komatsu district service manager" with any/all questions regarding safety.

Remark

These instructions are intended to supplement the service data contained in the appropriate "Shop Manual". Always refer to that manual for Removal, Installation, Disassembly and Reassembly instructions when not contained in this document.

Remove and discard the following parts:

Part Number	Part Name	Qty
56C46-11533	COVER	1
01010-81220	BOLT	4
56B-54-11470	BRACKET	2
09415-02512	CAP	4

Order and install the following parts:

Part Number	Part Name	Qty
56B-50-A0020	COVER	1
56B-50-A0030	BRACKET	2
01010-81230	BOLT	4

<https://hespareparts.com/>

PARTS BOOK INFORMATION

The following artwork and parts list should be used to supplement your parts book.

M3410-01A01

FRONT FRAME BUMPER STRONGER CENTER BUMPER

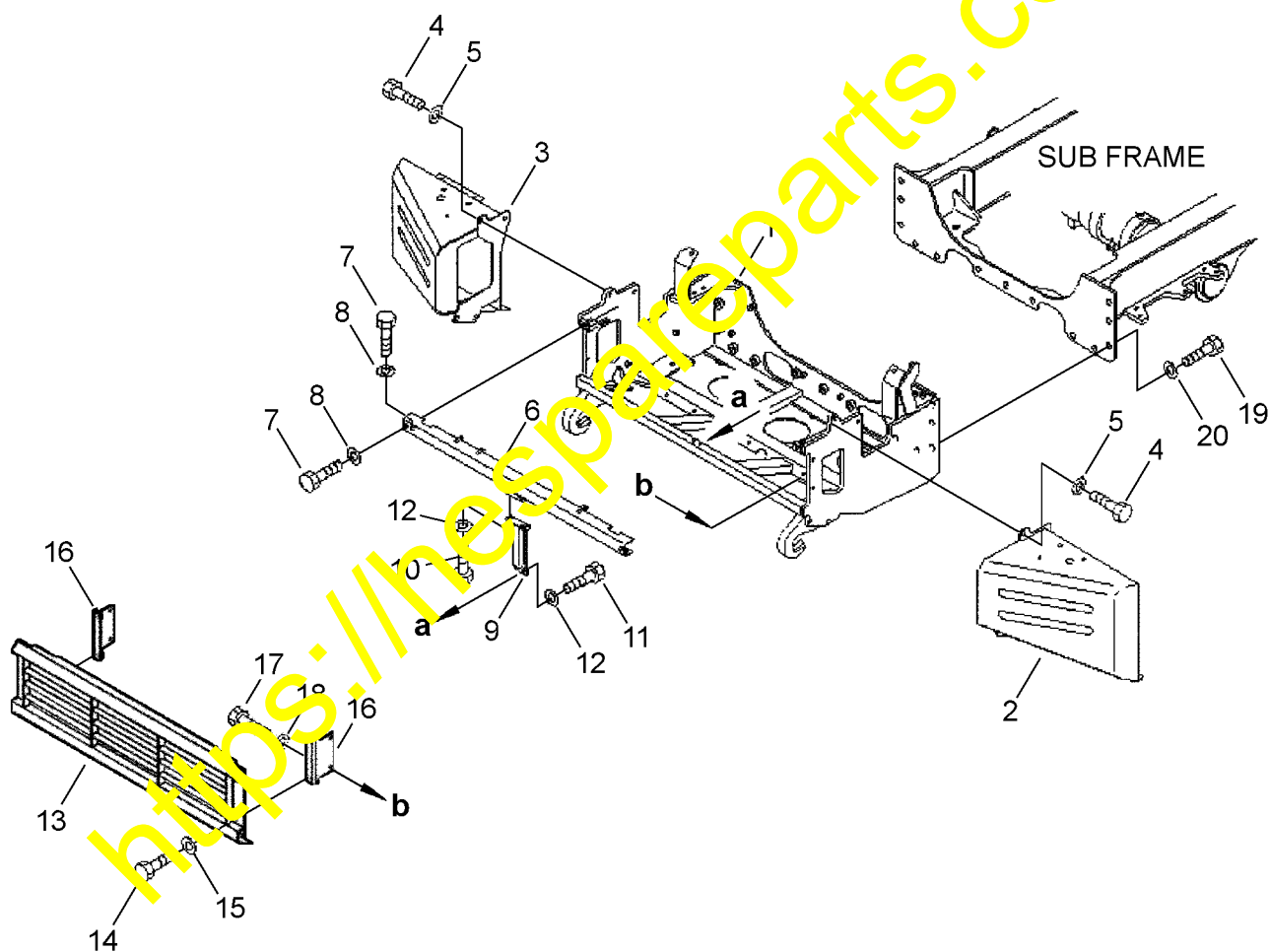

CM002759

AA03139

M3410-01A01

FRONT FRAME BUMPER STRONGER CENTER BUMPER

Item	Part Number	Description	Qty	Ref	Serial Number
1	56C-46-11410	BUMPER, CENTER.	1		1001 -
2	56C-46-11421	BUMPER, LH.	1		1001 -
3	56C-46-11431	BUMPER, RH.	1		1001 -
4	01010-81635	BOLT.	8		1001 -
5	01643-31645	WASHER.	8		1001 -
6	56C-46-11810	BRACKET	1		1001 -
7	01010-81630	BOLT.	4		1001 -
8	01643-31645	WASHER.	4		1001 -
9	56C-46-11820	BRACKET	1		1001 -
10	01010-81225	BOLT.	2		1001 -
11	01010-81230	BOLT.	2		1001 -
12	01643-31232	WASHER.	4		1001 -
13	56B-50-A0020	COVER	1		1001 -
14	01010-81225	BOLT.	4		1001 -
15	01643-31232	WASHER.	4		1001 -
16	56B-50-A0030	BRACKET	2		1001 -
17	01010-81230	BOLT.	4		1001 -
18	01643-31232	WASHER.	4		1001 -
19		NOT USED			1001 -
20	01010-82455	BOLT.	13		1001 -
21	01643-32460	WASHER.	13		1001 -

SHOP MANUAL DATA

1. Park the machine on a flat level surface; lower the work equipment to the ground. Shut off the engine and cycle the controls to remove any residual hydraulic pressure from the work equipment circuits. Turn the parking brake switch on and block the tires.
2. Remove the key from the start switch until the repairs are complete. Place a tag on the steering controls advising: "This machine is being repaired. It should not be started or moved for any reason until the tag is removed by the person doing the repairs."



WARNING! Observe all safety and precautionary standards as dictated by the environment and work conditions under which the equipment will be inspected, reworked and repaired. consult the "Shop Manual" and "Operator's and Maintenance Manual" and your "Komatsu district service manager" with any/all questions regarding safety.

3. Remove from front bumper cover (4) caps (09415-02512) to gain access to the mounting bolts. Remove the (4) M12 x 20 mounting bolts (01010-81220) and (4) washers (01643-31232) from the cover. Remove the cover (56C-46-11533). Remove from the left hand and right hand mounting bracket (56B-54-11470) the (4) M12 x 25 mounting bolts (01010-81225) and (4) washers (01643-31232). Save the (4) M12 x 25 mounting bolts (01010-81225) and (8) washers (01643-31232) as they will be used later.
4. Assemble the new right hand and left hand mounting brackets 56B-50-A0030 with (4) M12 x 30 mounting bolts 01010-81230 and (4) washers from step 1 (01643-31232). Torque the mounting bolts using standard torque.
5. Assemble the new bumper cover 56B-50-A0020 with the saved hardware from step 1 the (4) M12 x 25 mounting bolts (01010-81225) and (4) washers (01643-31232). Torque the mounting bolts using standard torque.

