

PARTS & SERVICE NEWS

REF NO.	AA03171
DATE	December 04, 2002

(C)

Page 1 of 3

SUBJECT: NEW, IMPROVED OPERATOR SEAT AND SUSPENSION ASSEMBLY

PURPOSE: To introduce a more durable operator seat and suspension for better support and stability.

APPLICATION: Komatsu Mechanical Drive Dump Trucks:
330M: A10205 - A10223, A10225 - A10227, A10231 - A10272,
HD785-5LC: A10224, A10228 & Up

FAILURE CODE: 5721ZC

DESCRIPTION:

Some operator seats have been found to have excessive free play and poor support and stability. The operator seat suspension has not proven to be durable, for heavy operators, especially. A new operator seat and a new suspension assembly are available as replacements for the current assemblies. The new, more durable components have been designed with a higher weight capacity for added reliability. Refer to Table 1 for the new component part numbers.

NOTE: If the previous seat upper (PC0619) is in good condition, the new suspension may be installed onto this seat.

Part Number	Description	Quantity
AK4946	Operator Seat Kit	1
427-57-A1260	Suspension Assembly	1

NOTE: Reuse all hardware and brackets that were previously removed from the old seat.

Replacing The Seat Assembly

1. Remove belts (1 & 2, Figure 1) from the operator seat.

⚠ IMPORTANT ⚠

Inspect the seatbelts for fraying or any other signs of wear. If any evidence of wear is found, replace the seatbelts with new equipment.

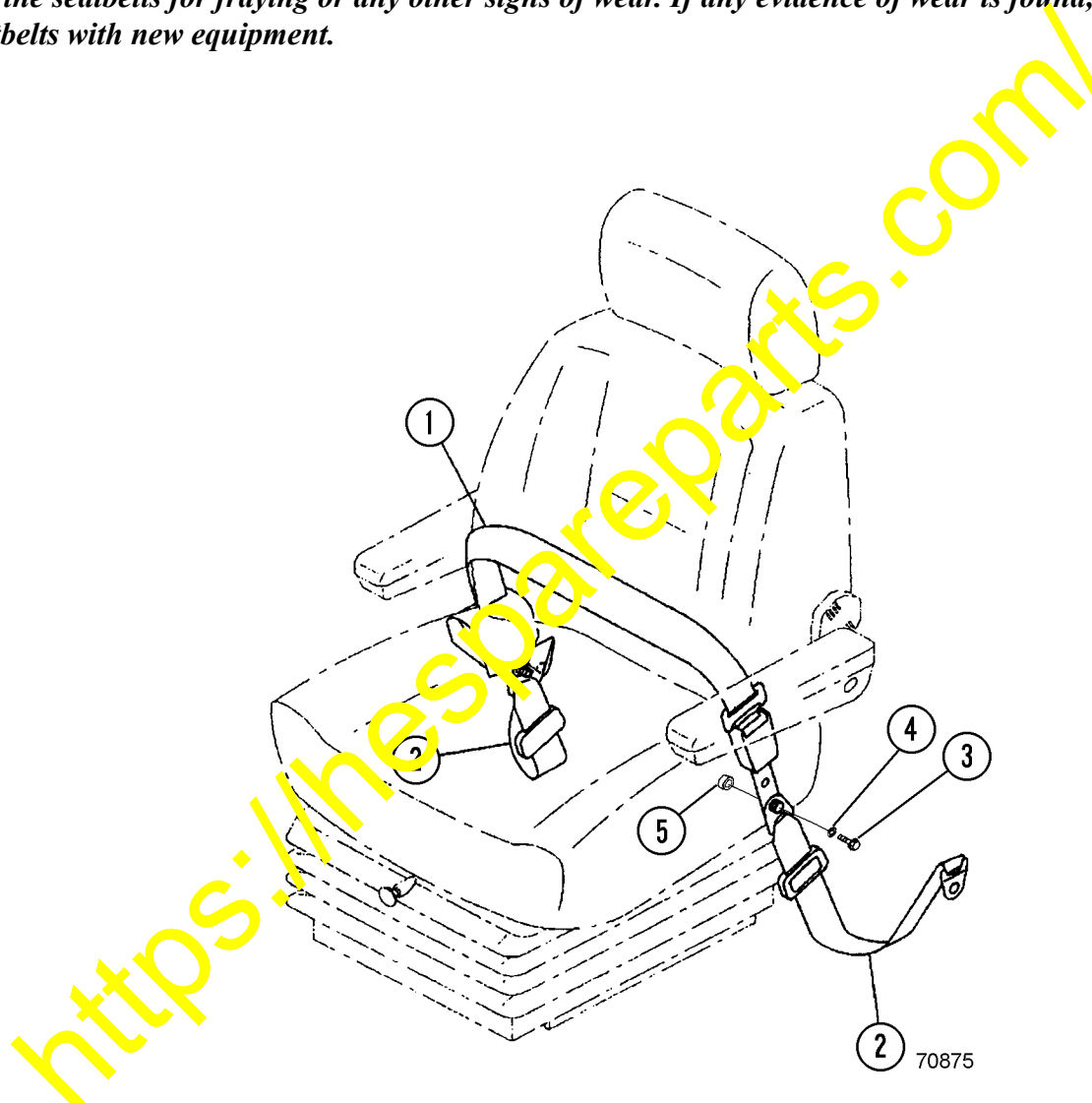
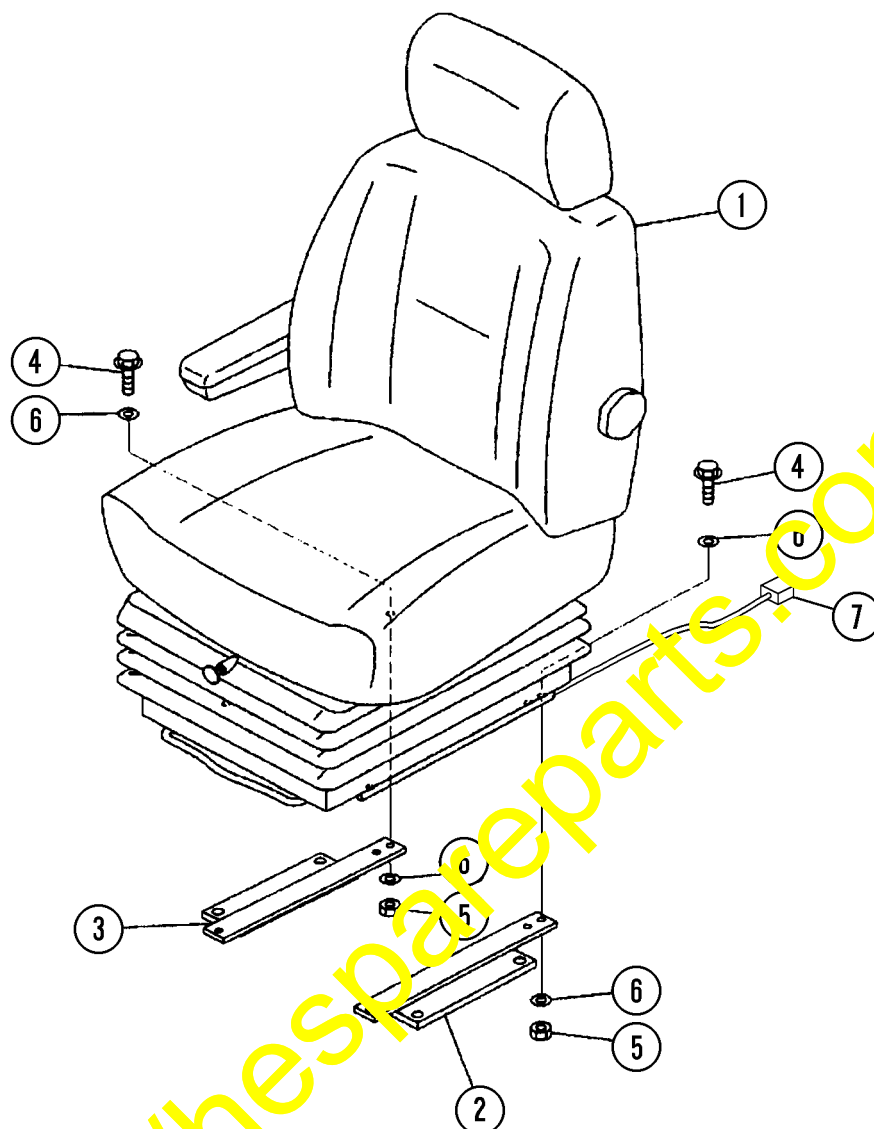

FIGURE 1. SEATBELT

- | | |
|-----------------|-----------|
| 1. Belt, Lap | 4. Washer |
| 2. Belt, Tether | 5. Spacer |
| 3. Bolt | |



70873

FIGURE 2. OPERATOR SEAT ASSEMBLY

- | | |
|------------------|-----------------|
| 1. Operator Seat | 5. Nut |
| 2. Left Bracket | 6. Washer |
| 3. Right Bracket | 7. Seat Harness |
| 4. Bolt | |

2. Disconnect seat harness (7, Figure 2), and remove operator seat (1) and the suspension assembly.
3. If the current seat upper (backrest and seat cushions) is in good condition and the suspension is the only component to be replaced, separate the suspension from the seat so the new suspension may be installed.
4. Install the new suspension on the seat.

NOTE: Tighten all seat and seatbelt hardware to standard torque.

5. Install belts (1 & 2, Figure 1) on the seat.
6. Place the seat assembly into position on the cab floor, and install the hardware.
7. Connect the seatbelt tethers to the cab floor.
8. Connect seat harness (7, Figure 2).