

PARTS & SERVICE NEWS

REF NO. AA04004

DATE January 16, 2004

(C)

Page 1 of 5

SUBJECT: INTRODUCTION OF STEEL COUNTERWEIGHT

PURPOSE: To provide optional replacement for cast counterweights damaged in the field

APPLICATION: Komatsu Wheel Loaders:
WA800-3LC: A50001 and Up;
WA900-3LC: A50001 and Up

FAILURE CODE: 4621FA

DESCRIPTION:

Some wheel loaders in operation have experienced damage to the cast counterweight. Damage has occurred when the rear of the machine had accidentally been backed into a corner object. A new steel counterweight (427-46-A5211) has been designed to withstand minor accidents.

A list of parts required to install the new steel counterweight can be found below in Table 1 (WA800-3LC) and Table 2 (WA900-3LC). Three separate replacement procedures are detailed in this Parts & Service News. The replacement procedures are located on pages 2, 4 and 5.

Table 1. Steel Counterweight for WA800-3LC Standard / High Lift

PART NUMBER	DESCRIPTION	PART STATUS	QTY.	REMARKS
427-46-A5211	Weight, 2900 Kg	New	1	Replace 427-46-A5130 or 427-46-25121 (Cast)
425-974-1160	Bolt	Reuse	6	
01643-33080	Washer	Reuse	6	
427-46-13120	Pin	Reuse	1	
427-46-25212	Cover	Reuse	1	
01010-82045	Bolt	Reuse	4	
01643-32060	Washer	Reuse	4	
417-06-11321	Plate	Reuse	4	
427-975-2110	Weight, Add 1600 Kg	Reuse	1	
427-975-1120	Spacer	Reuse	4	
419-09-11180	Bolt	Reuse	4	
426-09-11510	Washer	Reuse	4	
417-06-11321	Plate, Anti-Slip	New	4	

Table 2. Steel Counterweight for WA900-3LC Standard Lift / High Lift

PART NUMBER	DESCRIPTION	PART STATUS	QTY.	REMARKS
427-46-A5211	Weight, 2900 Kg	New	1	Replace 427-46-A5130 or 427-46-25121 (Cast) Common
01643-33080	Washer	Reuse	10	Common
427-46-13120	Pin	Reuse	1	Common
01010-82045	Bolt	Reuse	4	Common
01643-32060	Washer	Reuse	4	Common
417-06-11321	Plate, Anti-Slip	New	4	Common
427-46-25170	Weight, 1308 Kg	Reuse	1	High Lift
427-975-2110	Weight, 1600 Kg	Reuse	1	High Lift
427-975-1120	Spacer	Reuse	4	High Lift
419-09-11180	Bolt	Reuse	4	High Lift
427-T88-1131	Bolt	Reuse	4	High Lift
426-09-11510	Washer	Reuse	4	High Lift
427-46-25140	Weight, 2600 Kg	Reuse	1	Standard Lift
427-54-24680	Cover	Reuse	1	Standard Lift
01435-01235	Bolt	Reuse	4	Standard Lift
427-46-A5210	Bracket	Reuse	2	Standard Lift
01010-81235	Bolt	Reuse	4	Standard Lift
01643-51232	Washer	Reuse	4	Standard Lift

WA800-3LC COUNTERWEIGHT REPLACEMENT PROCEDURE (STANDARD / HIGH LIFT)

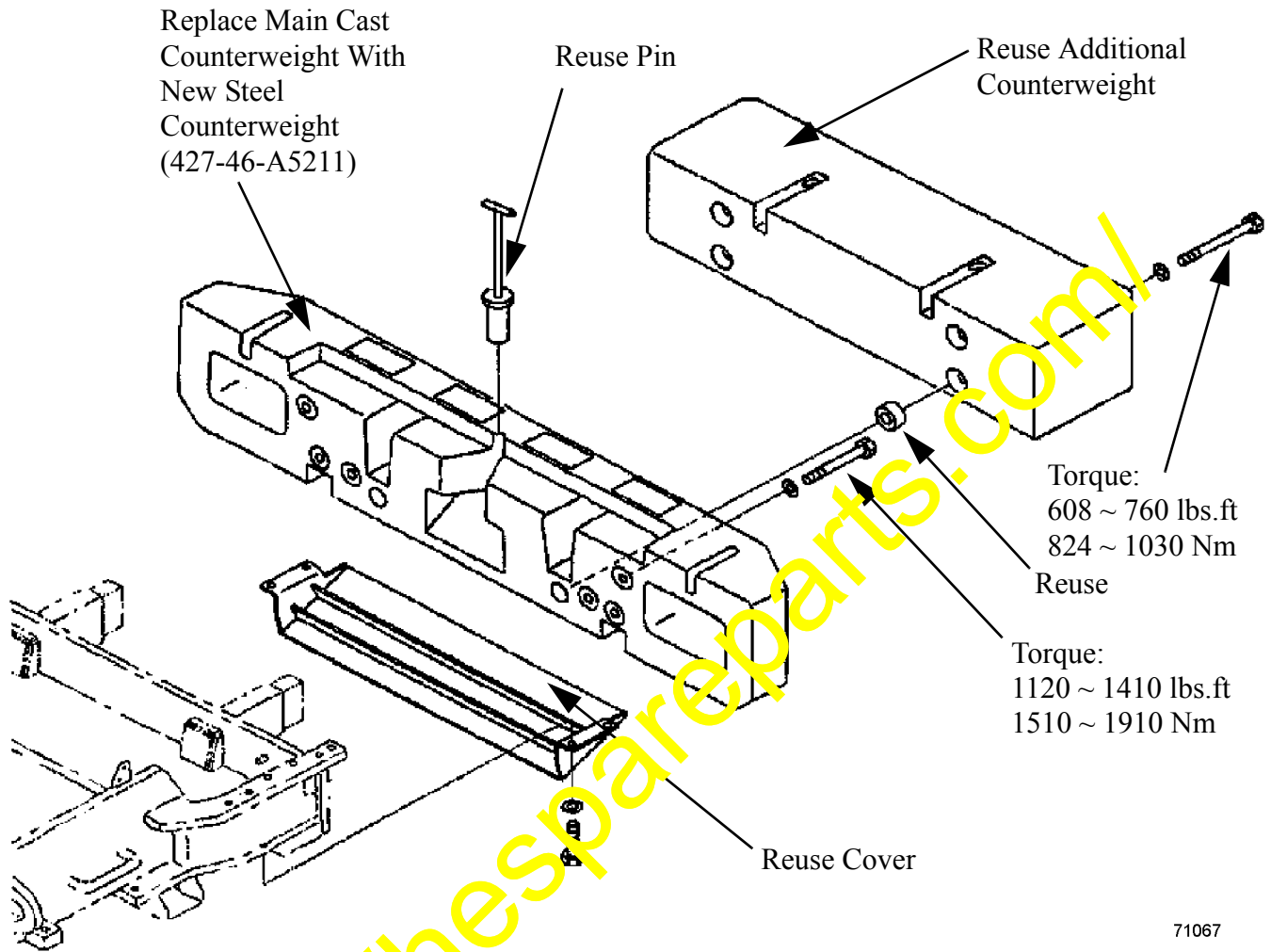

After removing hardware, keep in safe place to be reused for new main counterweight.

WA900-3LC COUNTERWEIGHT REPLACEMENT PROCEDURE (HIGH LIFT)

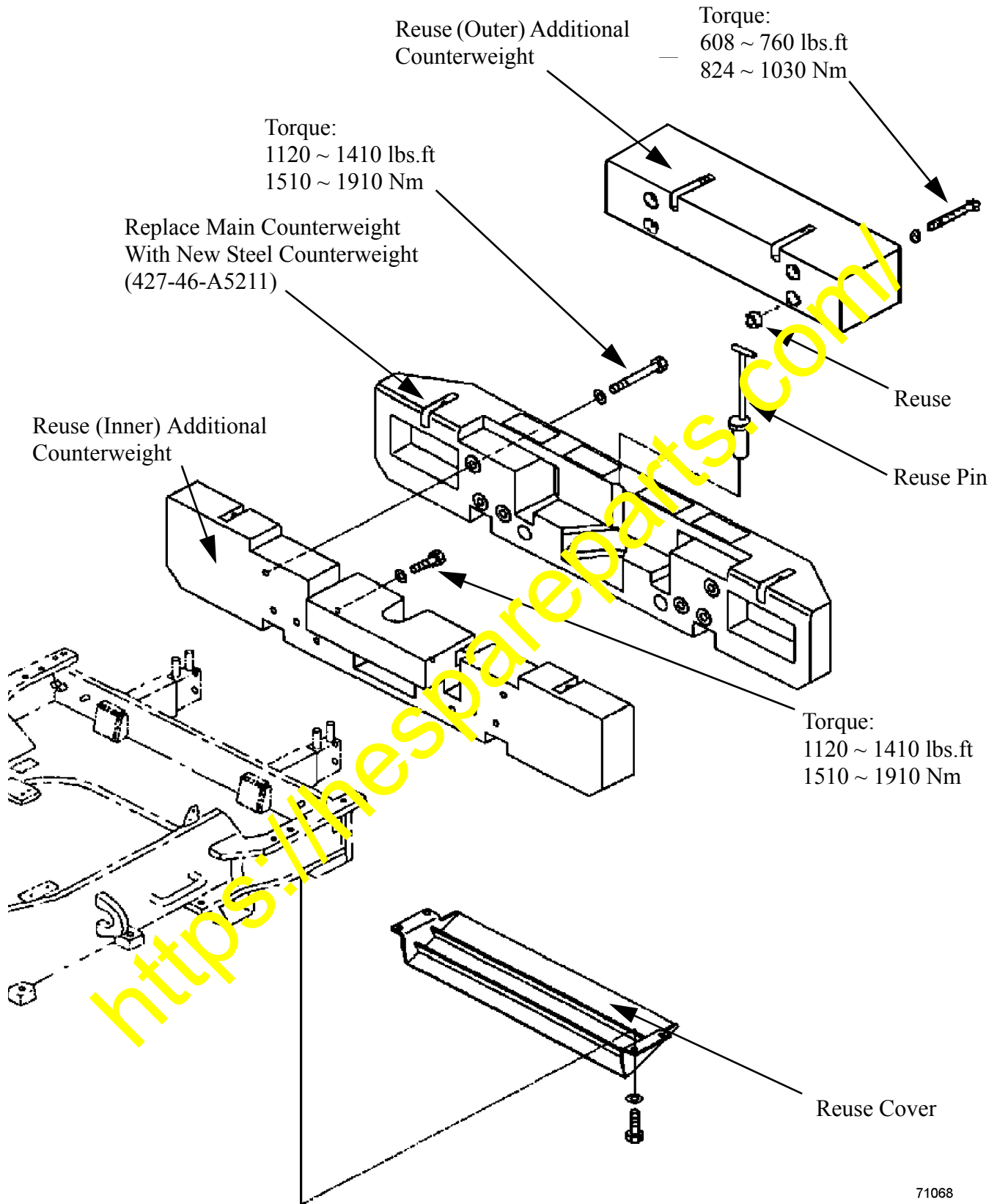

71068

After removing hardware, keep in safe place to be reused for new main counterweight.

WA900-3LC COUNTERWEIGHT REPLACEMENT PROCEDURE (STANDARD LIFT)

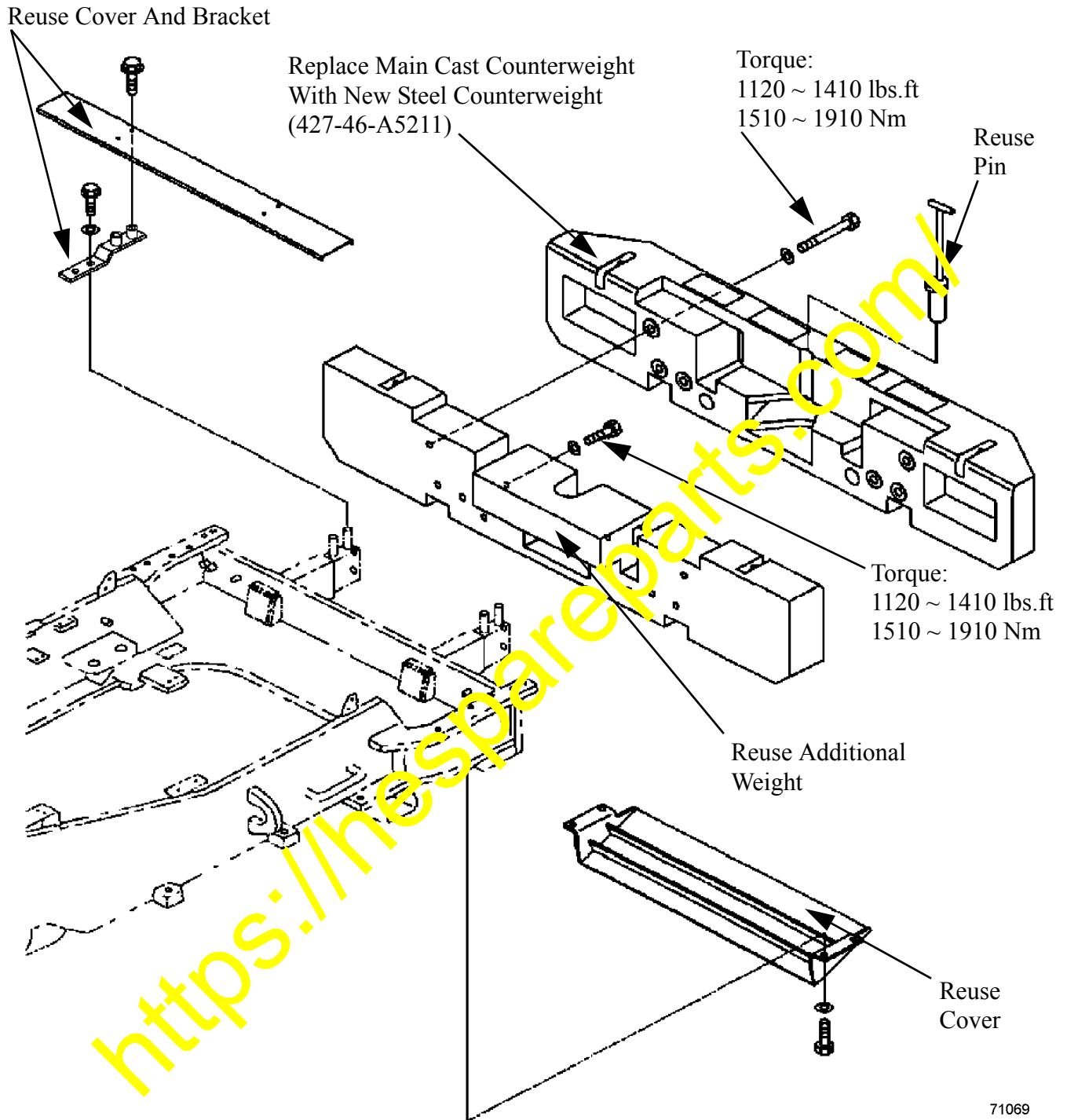

After removing hardware, keep in safe place to be reused for new main counterweight.