

# PARTS & SERVICE NEWS

REF NO. AA04042

DATE March 29, 2004

(C)

Page 1 of 6

- SUBJECT:** WIRING HARNESS UPDATE FOR NEW RADIO OPTION
- PURPOSE:** List the proper wiring harness for the optional radio being installed in the machine.
- APPLICATION:** WA320-3L Wheel Loader Serial Numbers A30356 and UP  
WA380-3L Wheel Loader Serial Numbers A50350 and UP  
WA420-3L Wheel Loader Serial Numbers A30116 and UP  
WA450-3L Wheel Loader Serial Numbers A30344 and UP
- FAILURE CODE:** D510Z9
- DESCRIPTION:** Two models of radios are offered with this machine. Depending upon the radio equipped with the machine will determine the correct wiring harness to be used.

## MACHINE PREPARATION

1. Park the machine on a flat level surface; lower the work equipment to the ground. Shut off the engine and cycle the controls to remove any residual hydraulic pressure from the work equipment circuits. Turn the parking brake switch on and block the tires.
2. Remove the key from the ignition switch until the repairs are complete. Place a tag on the steering controls advising: "This machine is being repaired. It should not be started or moved for any reason until the tag is removed by the person doing the repairs."



**WARNING!** Observe all safety and precautionary standards as dictated by the environment and work conditions under which the equipment will be inspected, reworked and repaired. Consult the "Shop Manual" and "Operator's and Maintenance Manual" and your Komatsu district service manager with any/all questions regarding safety.

## Remark

*These instructions are intended to supplement the service data contained in the appropriate "Shop Manual". Always refer to that manual for Removal, Installation, Disassembly and Reassembly instructions when not contained in this document.*

**PARTS VIEW**

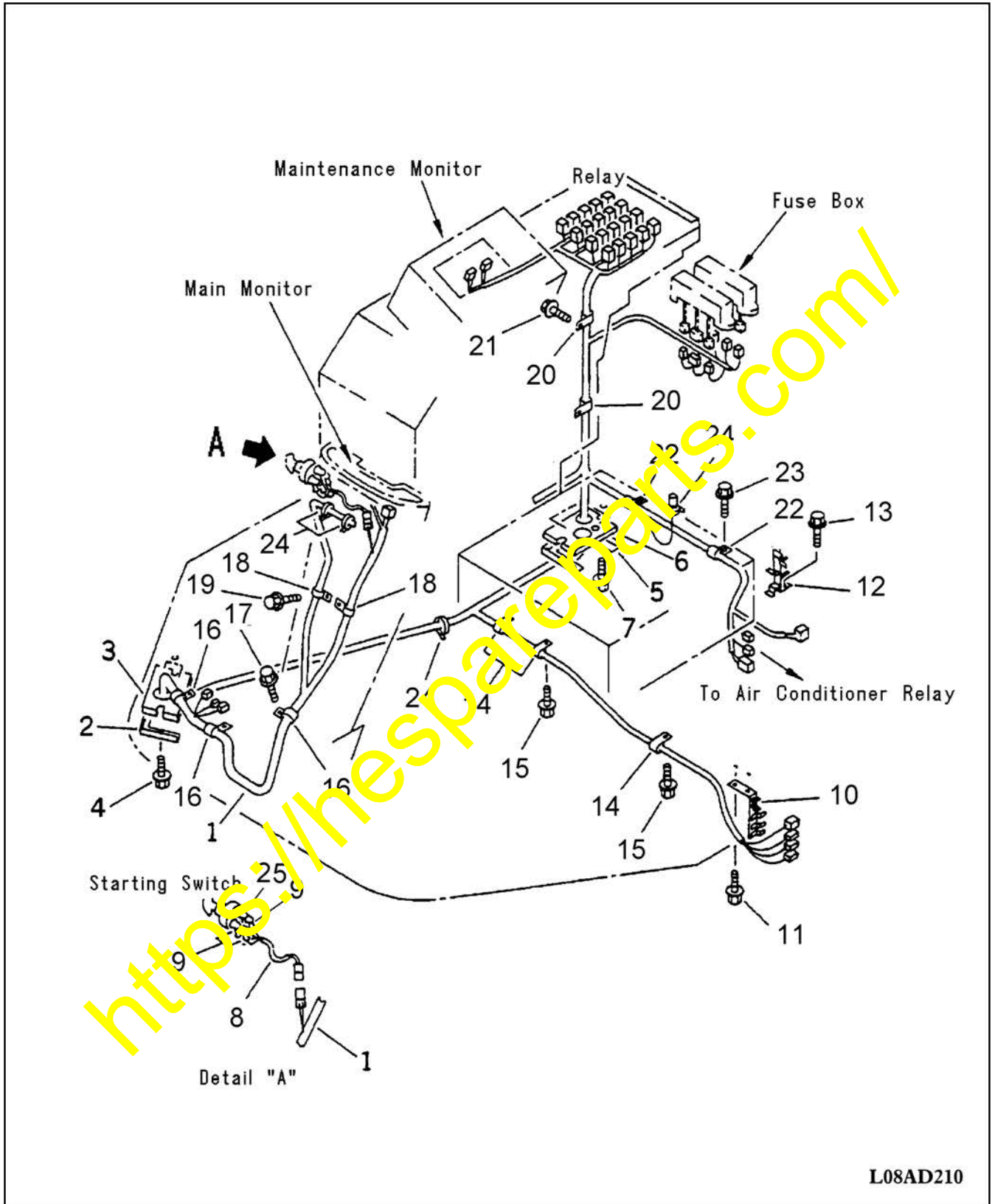

## WA 320-3L PARTS CHANGE UPDATE

## WA320-3L

## FLOOR HARNESS

Item	Part Number	Description	Qty.	Ref.	Serial No.
1	419-06-A1231	HARNESS, FLOOR LINE . . . . .	1		A30356 and UP
1	419-06-A1230	HARNESS, FLOOR LINE . . . . .	1		A30001 up to A30355
	08020-10000	.DIODE . . . . .	2		A30001 up to A30355
2	419-06-22530	PLATE . . . . .	1		A30001 and UP
3	421-06-22520	SHEET . . . . .	1		A30001 and UP
4	01435-00610	BOLT . . . . .	2		A30001 and UP
5	419-06-22530	PLATE . . . . .	1		A30001 and UP
6	421-06-22540	SHEET . . . . .	1		A30001 and UP
7	01435-00610	BOLT . . . . .	2		A30001 and UP
8	421-06-A1340	HARNESS, IGNITION SWITCH . . . . .	1		A30001 and UP
9	08038-00518	CAP . . . . .	4		A30001 and UP
10	421-06-22940	BRACKET . . . . .	1		A30001 and UP
11	01435-01016	BOLT . . . . .	2		A30001 and UP
12	421-06-22950	BRACKET . . . . .	1		A30001 and UP
13	01435-01016	BOLT . . . . .	2		A30001 and UP
14	08036-02514	CLIP . . . . .	4		A30001 and UP
15	01435-01016	BOLT . . . . .	4		A30001 and UP
16	281-01-13180	CLIP . . . . .	3		A30001 and UP
17	01435-01016	BOLT . . . . .	3		A30001 and UP
18	04434-52712	CLIP . . . . .	2		A30001 and UP
19	01435-01016	BOLT . . . . .	2		A30001 and UP
20	04434-52711	CLIP . . . . .	5		A30001 and UP
21	01435-01016	BOLT . . . . .	4		A30001 and UP
22	08036-03014	CLIP . . . . .	3		A30001 and UP
23	01435-01016	BOLT . . . . .	1		A30001 and UP
24	935-522-C1	STRAP, TIE . . . . .	4		A30001 and UP
25	08038-00519	CLIP . . . . .	1		A30001 and UP
N/I	04434-53412	CLIP . . . . .	1		A30001 and UP

061302

**WA 380-3L PARTS CHANGE UPDATE**

**WA380-3L**

**FLOOR HARNESS**

Item	Part Number	Description	Qty.	Ref.	Serial No.
1	423-06-A1141	HARNESS, FLOOR LINE . . . . .	1		A50350 and UP
1	423-06-A1140	HARNESS, FLOOR LINE . . . . .	1		A50001 up to A50349
	08020-10000	.DIODE . . . . .	6		A50001 up to A30349
2	419-06-22530	PLATE . . . . .	1		A50001 and UP
3	421-06-22520	SHEET . . . . .	1		A50001 and UP
4	01435-00610	BOLT . . . . .	2		A50001 and UP
5	419-06-22530	PLATE . . . . .	1		A50001 and UP
6	421-06-22540	SHEET . . . . .	1		A50001 and UP
7	01435-00610	BOLT . . . . .	2		A50001 and UP
8	421-06-22730	PLATE . . . . .	1		A50001 and UP
9	421-06-22740	SHEET . . . . .	1		A50001 and UP
10	01435-00608	BOLT . . . . .	2		A50001 and UP
11	421-06-22691	HARNESS, ITNITION SWITCH . . . . .	1		A50001 and UP
12	08038-00518	CAP . . . . .	4		A50001 and UP
13	421-06-22940	BRACKET . . . . .	1		A50001 and UP
14	01435-01016	BOLT . . . . .	2		A50001 and UP
15	421-06-22950	BRACKET . . . . .	1		A50001 and UP
16	01435-01016	BOLT . . . . .	1		A50001 and UP
17	08036-02514	CLIP . . . . .	4		A50001 and UP
18	01435-01016	BOLT . . . . .	4		A50001 and UP
19	281-01-13180	CLIP . . . . .	3		A50001 and UP
20	01435-01016	BOLT . . . . .	3		A50001 and UP
21	04434-52712	CLIP . . . . .	2		A50001 and UP
22	01435-01016	BOLT . . . . .	2		A50001 and UP
23	04434-53412	CLIP . . . . .	6		A50001 and UP
24	01435-01016	BOLT . . . . .	4		A50001 and UP
25	08036-03014	CLIP . . . . .	3		A50001 and UP
26	01435-01016	BOLT . . . . .	1		A50001 and UP
27	08034-20519	STRAP, TIE . . . . .	4		A50001 and UP

## WA 420-3L PARTS CHANGE UPDATE

## WA420-3L

## FLOOR HARNESS

Item	Part Number	Description	Qty.	Ref.	Serial No.
1	423-06-A1141	HARNESS, FLOOR LINE . . . . .	1		A30116 and UP
1	423-06-A1140	HARNESS, FLOOR LINE . . . . .	1		A30001 up to A30115
	421-06-11970	.DIODE . . . . .	6		A30001 up to A30115
2	419-06-22530	PLATE . . . . .	1		A30001 and UP
3	421-06-22520	SHEET . . . . .	1		A30001 and UP
4	01435-00610	BOLT . . . . .	2		A30001 and UP
5	419-06-22530	PLATE . . . . .	1		A30001 and UP
6	421-06-22540	SHEET . . . . .	1		A30001 and UP
7	01435-00610	BOLT . . . . .	2		A30001 and UP
8	421-06-22730	PLATE . . . . .	1		A30001 and UP
9	421-06-22740	SHEET . . . . .	1		A30001 and UP
10	01435-00608	BOLT . . . . .	2		A30001 and UP
11	421-06-22690	HARNESS, ITNITION SWITCH . . . . .	1		A30001 and UP
12	08038-00518	CAP . . . . .	4		A30001 and UP
13	421-06-22940	BRACKET . . . . .	1		A30001 and UP
14	01435-01016	BOLT . . . . .	2		A30001 and UP
15	421-06-22950	BRACKET . . . . .	1		A30001 and UP
16	01435-01016	BOLT . . . . .	1		A30001 and UP
17	08036-02514	CLIP . . . . .	3		A30001 and UP
18	01435-01016	BOLT . . . . .	3		A30001 and UP
19	281-01-13180	CLIP . . . . .	3		A30001 and UP
20	01435-01016	BOLT . . . . .	3		A30001 and UP
21	04434-52712	CLIP . . . . .	2		A30001 and UP
22	01435-01016	BOLT . . . . .	2		A30001 and UP
23	04434-53412	CLIP . . . . .	5		A30001 and UP
24	01435-01016	BOLT . . . . .	4		A30001 and UP
25	08036-03014	CLIP . . . . .	3		A30001 and UP
26	01435-01016	BOLT . . . . .	1		A30001 and UP
27	935-522-C1	STRAP, TIE . . . . .	1		A30001 and UP

**WA 450-3L PARTS CHANGE UPDATE**

**WA450-3L**

**FLOOR HARNESS**

Item	Part Number	Description	Qty.	Ref.	Serial No.
1	423-06-A1141	HARNESS, FLOOR LINE . . . . .	1		A30344 and UP
1	423-06-A1140	HARNESS, FLOOR LINE . . . . .	1		A30001 up to A30343
	421-06-11970	.DIODE . . . . .	6		A30001 up to A30343
2	419-06-22530	PLATE . . . . .	1		A30001 and UP
3	421-06-22520	SHEET . . . . .	1		A30001 and UP
4	01435-00610	BOLT . . . . .	2		A30001 and UP
5	419-06-22530	PLATE . . . . .	1		A30001 and UP
6	421-06-22540	SHEET . . . . .	1		A30001 and UP
7	01435-00610	BOLT . . . . .	2		A30001 and UP
8	421-06-22730	PLATE . . . . .	1		A30001 and UP
9	421-06-22740	SHEET . . . . .	1		A30001 and UP
10	01435-00608	BOLT . . . . .	2		A30001 and UP
11	421-06-22690	HARNESS, ITNITION SWITCH . . . . .	1		A30001 and UP
12	08038-00518	CAP . . . . .	4		A30001 and UP
13	421-06-22940	BRACKET . . . . .	1		A30001 and UP
14	01435-01016	BOLT . . . . .	2		A30001 and UP
15	421-06-22950	BRACKET . . . . .	1		A30001 and UP
16	01435-01016	BOLT . . . . .	1		A30001 and UP
17	08036-02514	CLIP . . . . .	3		A30001 and UP
18	01435-01016	BOLT . . . . .	3		A30001 and UP
19	281-01-13180	CLIP . . . . .	3		A30001 and UP
20	01435-01016	BOLT . . . . .	3		A30001 and UP
21	04434-52712	CLIP . . . . .	2		A30001 and UP
22	01435-01016	BOLT . . . . .	2		A30001 and UP
23	04434-53412	CLIP . . . . .	5		A30001 and UP
24	01435-01016	BOLT . . . . .	4		A30001 and UP
25	08036-03014	CLIP . . . . .	3		A30001 and UP
26	01435-01016	BOLT . . . . .	1		A30001 and UP
27	935-522-C1	STRAP, TIE . . . . .	1		A30001 and UP