

PARTS & SERVICE NEWS

REF NO. AA04071

DATE June 2, 2004

(C)

Page 1 of 4

SUBJECT: MODIFICATION PROCEDURE FOR ENGINE FRONT COVER GASKET

PURPOSE: To introduce modification procedure to repair the front cover gasket of the 140 Series Engines

APPLICATION: WA500-3LK S/N A71001 thru A71224
Balance of models affected see Page 4

FAILURE CODE: A239AA

DESCRIPTION:

1. Introduction: Since there is a possibility of an oil leak from the front cover gasket of the engine, make the modification introduced in this **PARTS & SERVICE NEWS**.

2. List of Parts:

Part No.	Part Name	Purpose of Part	Qty.	Remarks
6217-21-3251 (6217-21-3250)	Gasket (Gasket)	Replacement	1 (1)	Tier 2 engines
6217-21-3251 (6210-21-3251)	Gasket (Gasket)		1 (1)	Tier 0 and Tier 1 engines
671-29-3521 (6711-29-3521)	Seal (Seal)		1 (!)	Consumable Parts

3. Details of the modification

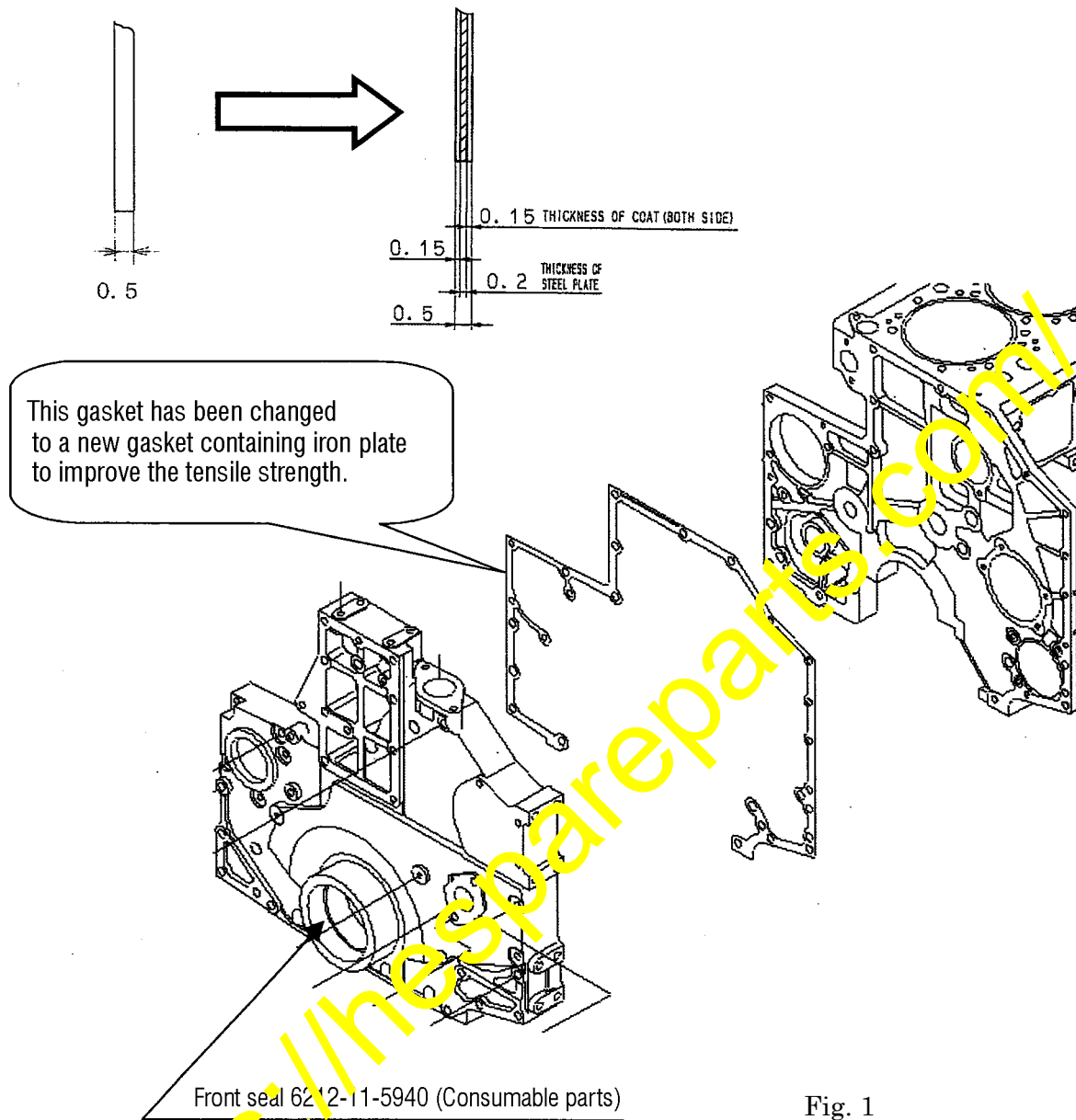

Although two types of gaskets had been registered for use with the ϕ 140 Series engines, this time, they have been unified into 1 type.

4. Modification procedure

Carry out this modification work referring to the Shop Manual.

Check table for the serial numbers of the applicable machines of the main machine models

The serial number starts from the first shipment machine on all the machine models

No.	Applicable machine model	Serial No. of the engine		Serial No. of the machine	
		Engines in the field	Engines shipped with the modification completed	Machines in the field	Machines shipped with the modification completed
1	BR1000JG-1	~ #112098	From the next shipment	~ #1002	#1003 ~
2	D155A-2A	~ #31338	#31339 ~	~ #57719	#57720 ~
3	D155AX-3	~ #26619	From the next shipment	~ #70079	#70080 ~
4	D155AX-5A	~ #112589	#112590 ~	~ #76032	#76033 ~
5	D155C-1A	~ #31331	#31332 ~	~ #31617	#31618 ~
6	D275AX-5	~ #112580	#112581 ~	~ #20093	#20094 ~
7	D355C-DA	~ #31329	#31330 ~	~ #14531	#14532 ~
8	GC380F-2	~ #31383	#31384 ~	~ #12087	#12088 ~
9	GD825A-2	~ #31432	#31445 ~	~ #12126	#12127 ~
10	CS360-2E	~ #112536	From the next shipment	~ #11523	#11524 ~
11	GS360-2	~ #28966	From the next shipment	~ #12080	#12081 ~
12	GS500-1	~ #111770	From the next shipment	~ #1002	#1003 ~
13	HD325-6	~ #31397	#31398 ~	~ #5960	#5961 ~
14	HD405-6	~ #31397	#31398 ~	~ #1186	#1187 ~
15	HD325-6E	~ #112110	#112573 ~	~ #6262	#6263 ~
16	HD405-6E	~ #112110	#112573 ~	~ #2116	#2117 ~
17	HM350-1	~ #112609	#112610 ~	~ #1061	#1062 ~
18	HM400-1	~ #112574	#112575 ~	~ #1127	#1128 ~
19	HV3000-1	~ #31398	#31399 ~	~ #1013	#1014 ~
20	HV6000-1	~ #31351	From the next shipment	~ #1017	#1018 ~
21	LW500-1	~ #31075	From the next shipment	~ #11035	#11036 ~
22	PC1800SP-1F	~ #31010	From the next shipment	~ #10142	#10143 ~
23	PC1800SP-1R	~ #31011	From the next shipment	~ #10142	#10143 ~
24	PC1800-6F	~ #30637	From the next shipment	~ #10017	#10018 ~
25	PC1800-6R	~ #30252	From the next shipment	~ #10017	#10018 ~
26	PC1800E-6F	~ #112231	#112718 ~	~ #11016	#11017 ~
27	PC1800E-6R	~ #112232	#112719 ~	~ #11016	#11017 ~
28	PC600-6	~ #112276	From the next shipment	~ #11129	#11130 ~
29	PC650-6	~ #112276	From the next shipment	~ #31050	#31051 ~
30	PC600-7	~ #112565	#112566 ~	~ #20021	#20022 ~
31	PC650-7	~ #112565	#112566 ~	~ #40010	#40011 ~
32	PC600-KU-6	~ #112622	#112623 ~	-	-

No.	Applicable machine model	Serial No. of the engine		Serial No. of the machine	
		Engines in the field	Engines shipped with the modification completed	Machines in the field	Machines shipped with the modification completed
33	PC750-6E	~ #112577	#112578 ~	~ #11068	#11069 ~
34	PC800-6E	~ #112577	#112578 ~	~ #31092	#31093 ~
35	PC750-7E	~ #112582	#112583 ~	~ #20017	#20018 ~
36	PC800-7E	~ #112582	#112583 ~	~ #40020	#40021 ~
37	PC750-KU-6E	~ #112414	From the next shipment	-	-
38	WA500-3	~ #29362	From the next shipment	~ #51008	#51009 ~
39	WA500-3E	~ #112564	#112565 ~	~ #54044	#54045 ~
40	WA500-AC-3	~ #111096	#112724 ~	-	-
41	WA500-AD-3	~ #112583	#112584 ~	-	-
42	WA500-DZ-3	~ #30743	From the next shipment	-	-
43	WA500-HH	~ #112559	#112560 ~	-	-
44	WF550-3	~ #31132	From the next shipment	~ #50010	#50011 ~
45	WZ4000-1	~ #111400	From the next shipment	~ #1006	#1007 ~
46	6M137A-1	~ #10157	#10158 ~	-	-
47	6M140A-2	~ #22320	From the next shipment	-	-
48	6M137A-1Y	~ #100149	From the next shipment	-	-
49	6M137B-1	~ #10045	From the next shipment	-	-
50	6M140A-3	~ #10220	#10221 ~	-	-
51	6M140A-5	~ #10079	#10080 ~	-	-
52	J6D140E-G1	~ #70146	#70150 ~	-	-
53	J6D140E-KC-2	~ #30618	From the next shipment	-	-
54	SA6D140A-G2	~ #31351	#31352 ~	-	-
55	SA6D140A-GI	~ #31353	#31354 ~	-	-
56	SA6D140A-GN	~ #31090	From the next shipment	-	-
57	SA6D140A-GP	~ #31270	#31431 ~	-	-
58	SA6D140H-R	~ #30875	From the next shipment	-	-
59	SAA6D140-G1	~ #30786	From the next shipment	-	-
60	SAA6D140-G3	~ #31327	#31328 ~	-	-
61	NTT-SU-B	~ #31407	#31408 ~	-	-
62	TAT-SA140A	~ #30207	From the next shipment	-	-
63	ASK-MARINE	~ #31401	#31402 ~	-	-
64	DCA400SPK	~ #31359	#31360 ~	-	-
65	DCA400SSK	~ #112217	#112731 ~	-	-
66	Nissha SA140	~ #30895	From the next shipment	-	-