

# PARTS & SERVICE NEWS

REF NO. AA04115

DATE July 29,2004

(C)

Page 1 of 14

**SUBJECT:** HM300-1 IMPROVEMENTS

**PURPOSE:** To provide enhancements to the standard machine.

**APPLICATION:** HM300-1 Serial Number 1159  
HM300-1 Serial Number 1160  
HM300-1 Serial Number 1161

**FAILURE CODE:** 5510Z9

**DESCRIPTION:** This Parts & Service News will provide service parts and rework drawings for the locations of the enhancements.

<https://hespareparts.com/>

MIRRORS - SIDE

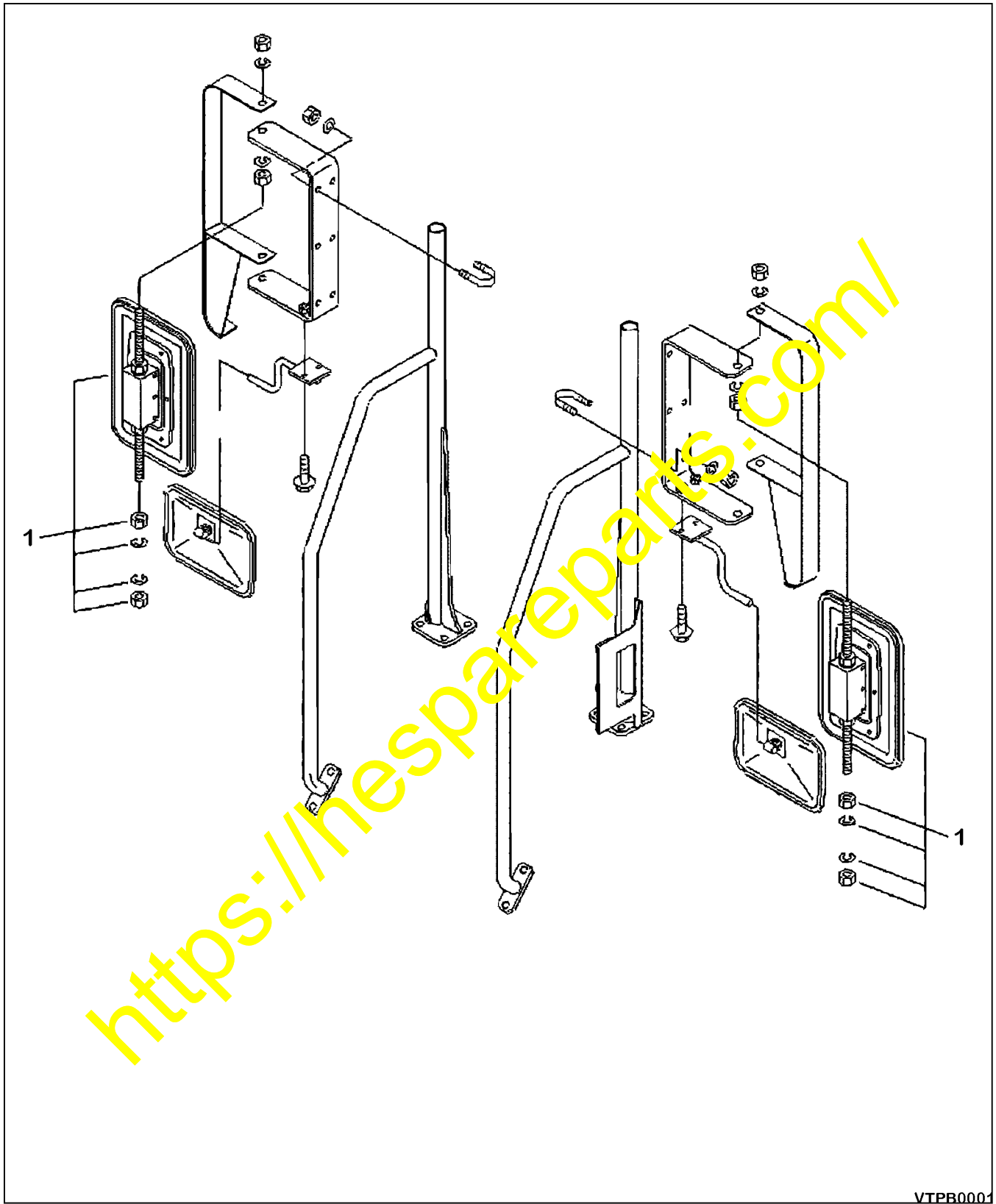

**MIRRORS - SIDE - PARTS LIST**

<b>Item</b>	<b>Part Number</b>	<b>Description</b>	<b>Qty.</b>	<b>Ref.</b>	<b>Serial No.</b>
1	DCB 04033	MIRROR, FLAT	0	2	1159-1161

<https://hespareparts.com/>

TUBE, FILLER - REWORK

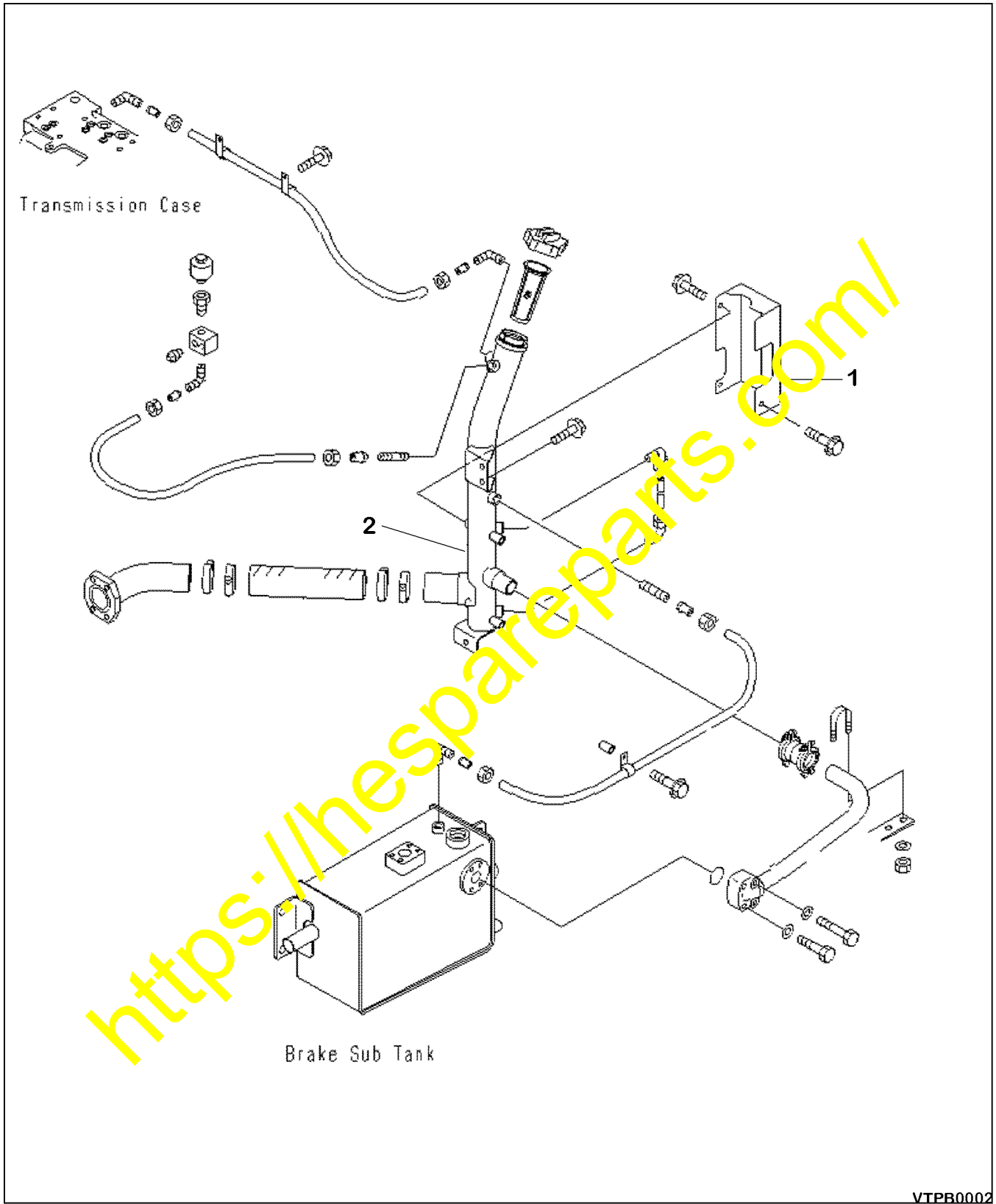

VTPB0002

**TUBE, FILLER - PARTS LIST**

<b>Item</b>	<b>Part Number</b>	<b>Description</b>	<b>Qty.</b>	<b>Ref.</b>	<b>Serial No.</b>
1	56B-54-A0040	GUARD, REWORK	1		1159-1161
2	56B-54-A0050	TUBE, REWORK	1		1159-1161

<https://hespareparts.com/>

CONSOLE BOX

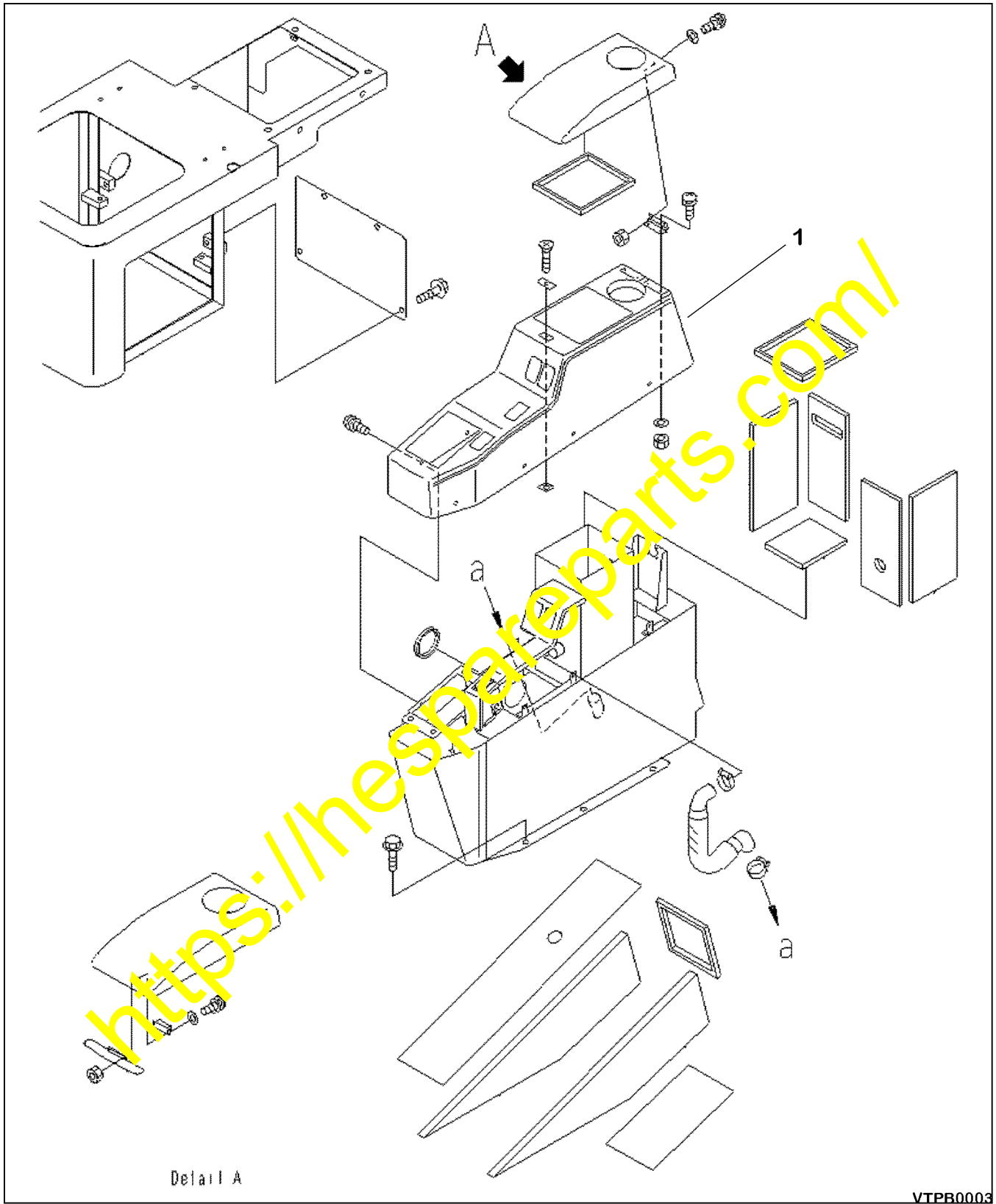

**CONSOLE BOX - PARTS LIST**

<b>Item</b>	<b>Part Number</b>	<b>Description</b>	<b>Qty.</b>	<b>Ref.</b>	<b>Serial No.</b>
1	56B-54-A0060	BOX, CONSOLE	1		1159-1161

<https://hespareparts.com/>

**CONSOLE BOX - ELECTRICAL SYSTEM**

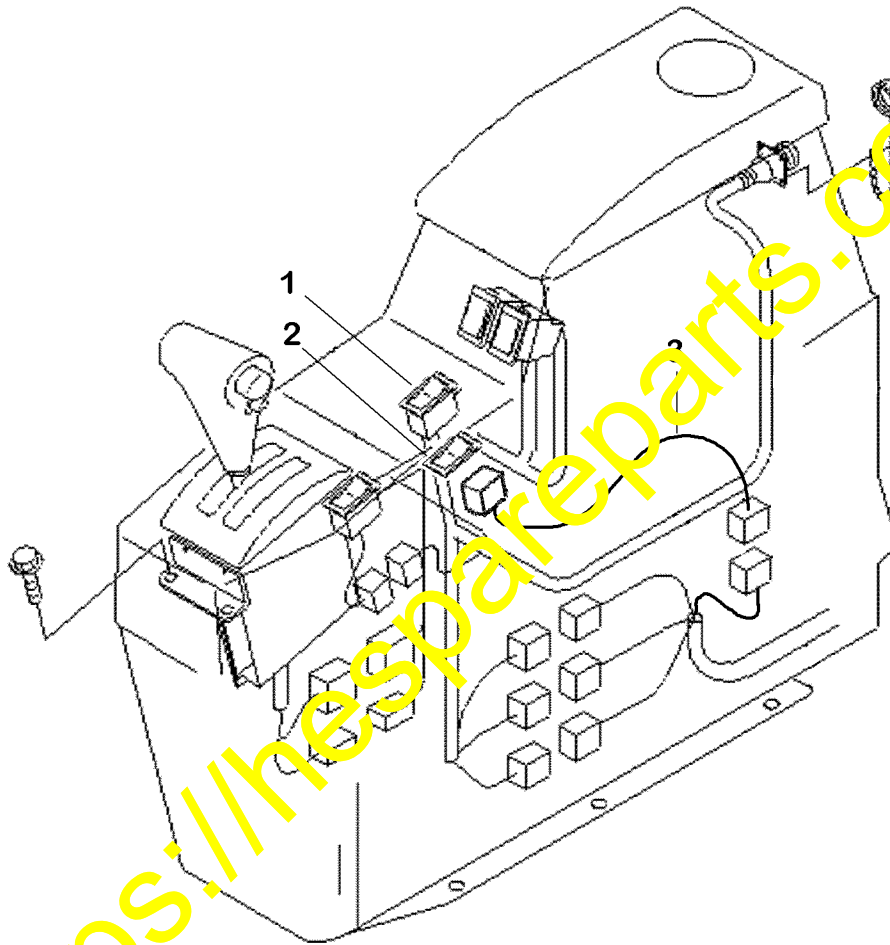

**CONSOLE BOX**

VTPB0004



**CONSOLE BOX - PARTS LIST**

<b>Item</b>	<b>Part Number</b>	<b>Description</b>	<b>Qty.</b>	<b>Ref.</b>	<b>Serial No.</b>
1	56B-54-16761	SWITCH, DIFF LOCK	1		1159-1161
2	56B-54-A0070	PLATE, LOCKING	1		1159-1161
3	56B-54-A0010	HARNESS, WIRING	1		1159-1161

<https://hespareparts.com/>

Following are drawings of parts for rework that may be unavailable:

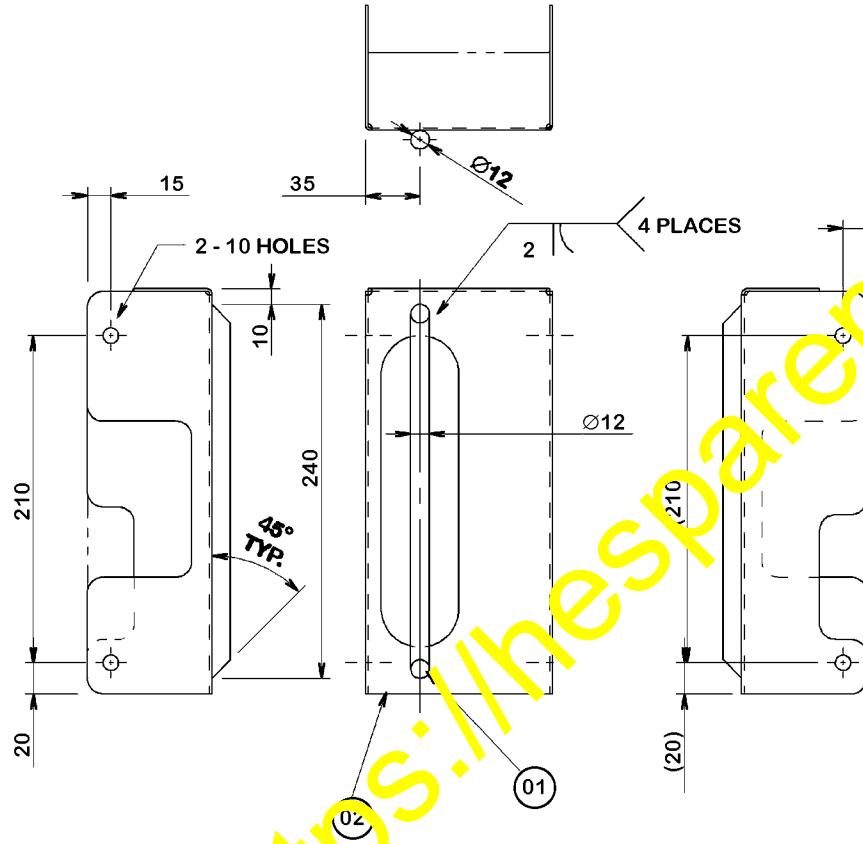

- 1. US CO<sub>2</sub> -GAS ARC WELDING.
- 2. COAT WITH PZ.
- 3. PRESSURE TEST.
- 4. HANDLING OF THIS PART SHALL CONFORM TO KES 56.300.01.
- 5. PAINT COLOR TO BE BLACK GRAY CONFORMING TO KES 57.041.895.

GUARD REWORK  
56B-54-A0040

<https://thespareparts.com/>

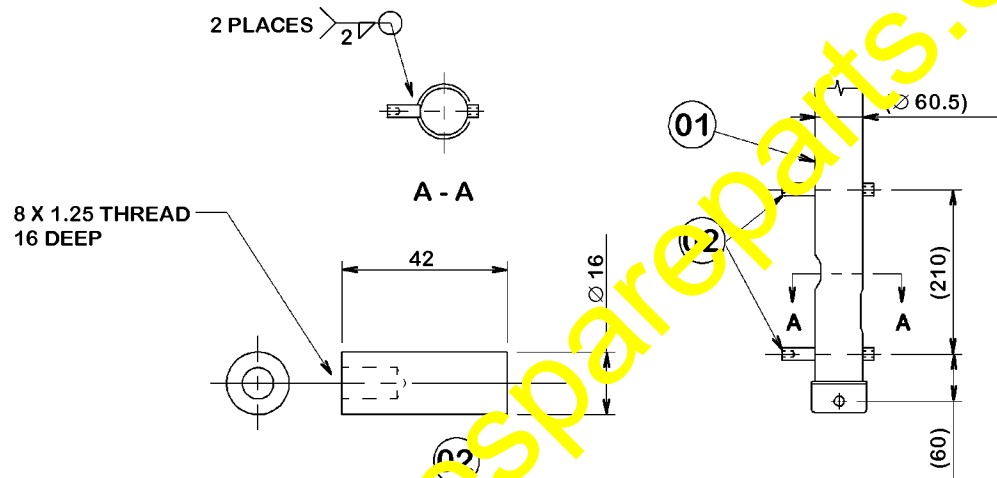

1. US CO<sub>2</sub> -GAS ARC WELDING.
2. COAT WITH PZ.
3. PRESSURE TEST.
4. HANDLING OF THIS PART SHALL CONFORM TO KES 56.300.01.
5. PAINT COLOR TO BE BLACK GRAY CONFORMING TO KES 57.041.895.

02	BOSS	SS400	2	16 X 42
01	TUBE	SS400	1	60.5 X 2.3
SYM	PART NAME	MTL.	QTY.	REMARKS

TUBE REWI  
56B-54-A00

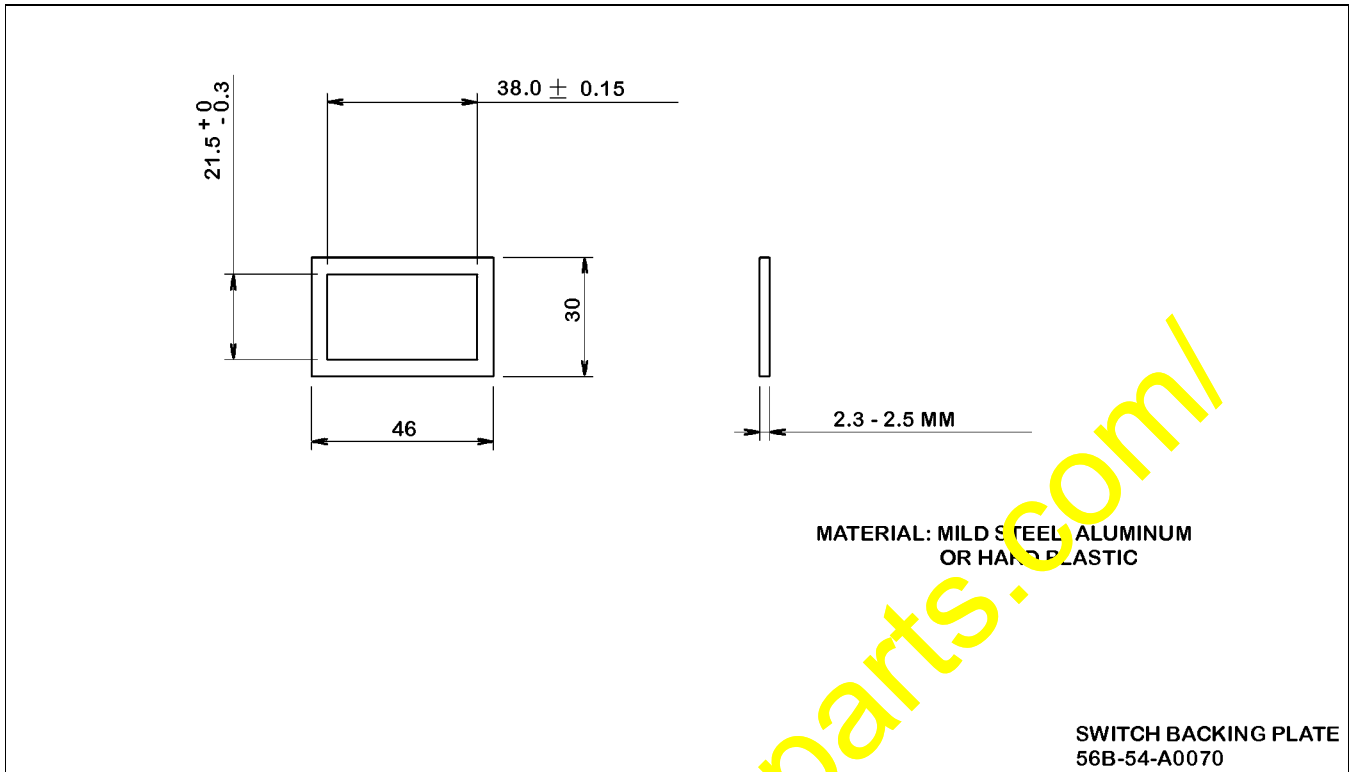

Following are installation drawings for the various parts

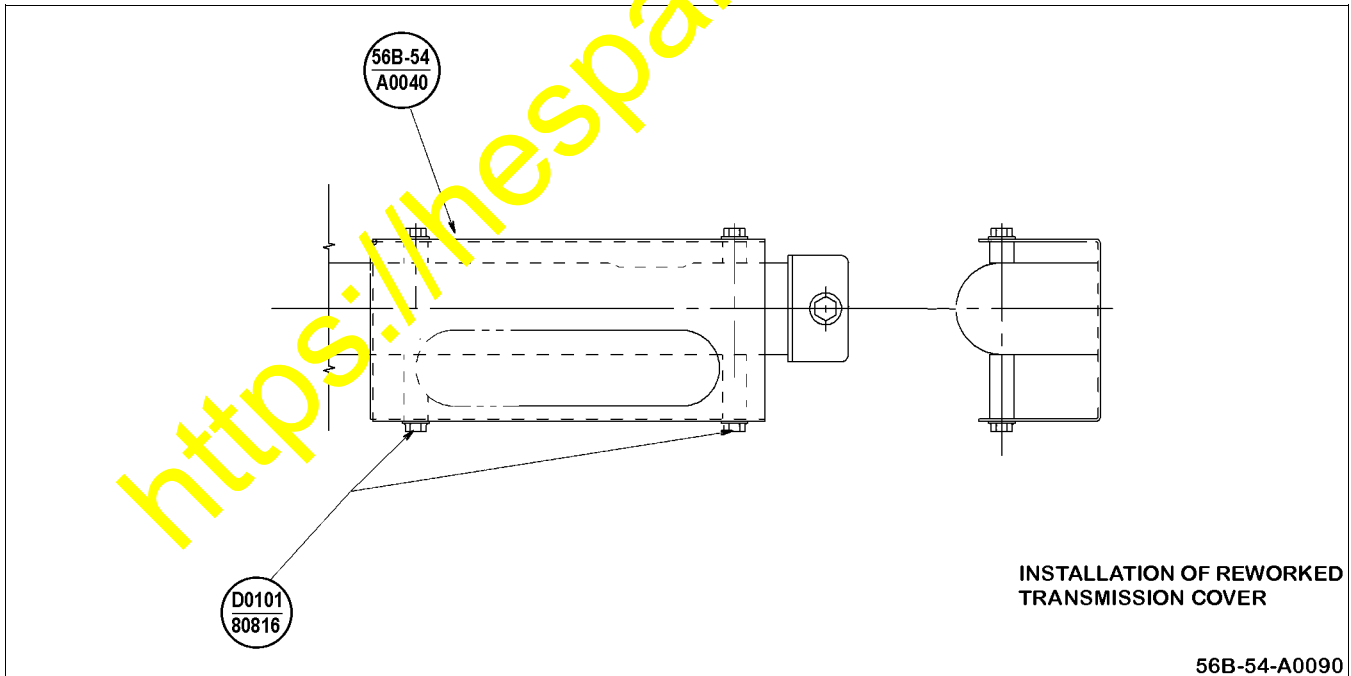

DASH TOP VIEW WIRE HARNESS

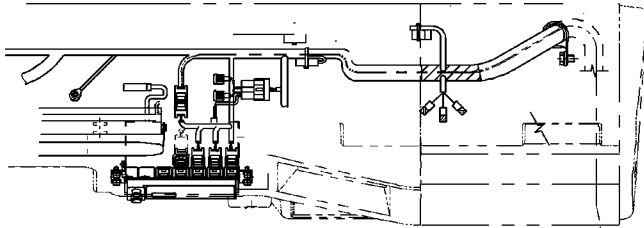

INSTALL SWITCH (56B-06-16761  
DIFF LOCK) THAT WAS REMOVED  
FROM DASH

(56B-54-A0010) WIRE  
HARNESS ROUTE  
THROUGH CONSOLE TO  
JOIN MAIN HARNESS

REMOVE DIFF LOCK  
SWITCH (56B-06-16780)  
RELOCATE ON CONSOLE

DASH FRONT VIEW WIRE HARNESS

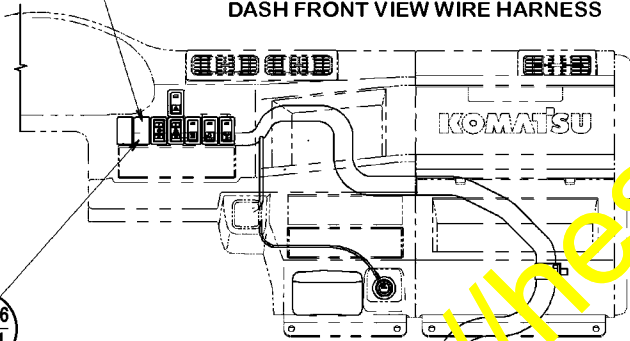

THIS PLATE IS REQUIRED TO  
SECURE SWITCH

SEE 56B-54-A0060  
REWORK ARMREST

56B-06  
16761

REPLACE SWITCH WITH CAP

A

RUN ADDITIONAL HARNESS WITH  
MAIN HARNESS AS SHOWN IN TOP  
AND BOTTOM VIEWS

HARNESS INSTALLAT  
PAGE 1 OF 2  
56B-54-A0080

<https://thespareparts.com/>

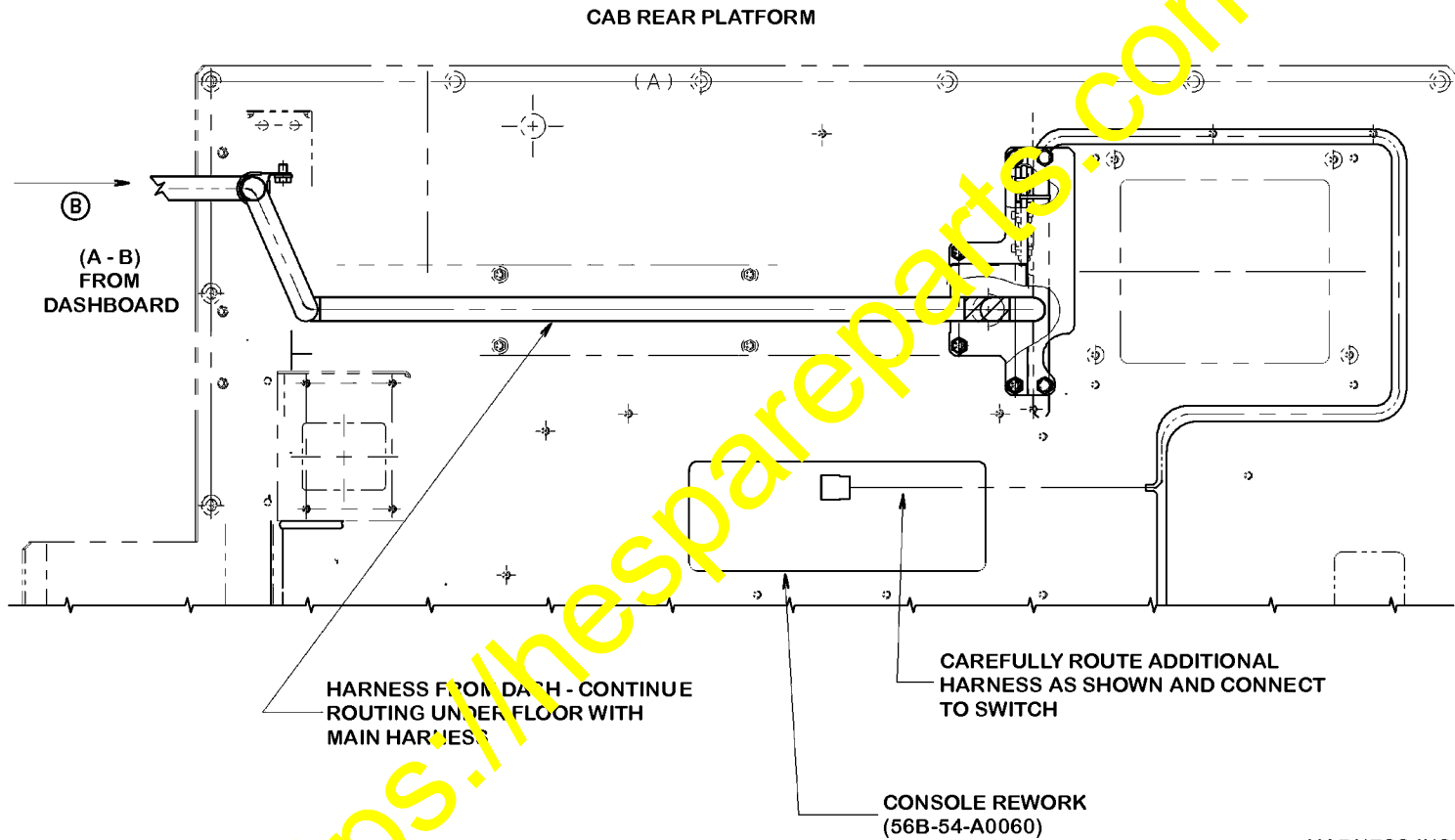

HARNESS INSTALLATION  
PAGE 2 OF 2  
56B-54-A0080