

# PARTS & SERVICE NEWS

REF NO. AA04145

DATE September 2, 2004

Page 1 of 4

**SUBJECT:** REPAIR PROCEDURE FOR ABNORMAL NOISE DURING ABRUPT BRAKE APPLICATION

**PURPOSE:** To introduce a modification procedure to repair abnormal noise when abrupt braking is applied on listed wheel loaders.

**APPLICATION:** WA450-5L Wheel Loader Serial Number A36001 through A36280  
WA470-5 Wheel Loader Serial Number 70001 through 80076  
WA480-5 Wheel Loader Serial Number 70001 through 80089  
WA480-5L Wheel Loader Serial Number A37001 through A37093

**FAILURE CODE:** 2C00MC

**DESCRIPTION:** When an abrupt braking application on the listed wheel loaders, the brake pedal may vibrate or cause abnormal noise (gear knocking noise) from the axle section because of dispersions of the brake valve. In this failure occurs, make the modification introduced in this Service News.

## MACHINE PREPARATION

1. Park the machine on a flat level surface; lower the work equipment to the ground. Shut off the engine and cycle the controls to remove any residual hydraulic pressure from the work equipment circuits. Turn the parking brake switch on and block the tires or tracks.
2. Remove the key from the ignition switch until the repairs are complete. Place a tag on the steering controls advising: "This machine is being repaired. It should not be started or moved for any reason until the tag is removed by the person doing the repairs."



**WARNING!** Observe all safety and precautionary standards as dictated by the environment and work conditions under which the equipment will be inspected, reworked and repaired. Consult the "Shop Manual" and "Operator's and Maintenance Manual" and your "Komatsu district service manager" with any/all questions regarding safety.

## Remark

*These instructions are intended to supplement the service data contained in the appropriate "Shop Manual". Always refer to that manual for Removal, Installation, Disassembly and Reassembly instructions when not contained in this document.*

**PART LISTING**

No.	Part Number	Description	Qty.	Remark
1	421-43-37254 (421-43-37253)	TUBE . . . . . (TUBE) . . . . .	1 (1)	
2	421-43-38163 (421-43-38162)	TUBE . . . . . (TUBE) . . . . .	1 (1)	
3	421-U44-3582 (421-U44-3581)	TUBE . . . . . (TUBE) . . . . .	1 (1)	For optional brake cooling
4	421-43-38810 (416-85-52430)	PLATE . . . . . (SPACER) . . . . .	1 (1)	
5	421-43-38820	CHECK VALVE . . . . .	2	
6	02781-00422	UNION . . . . .	2	
7	02896-11012	O-RING . . . . .	4	
8	07002-12034	O-RING . . . . .	2	O-rings listed are to be used when reinstalling the parts. (do not reuse the old O-rings)
9	01010-81025	BOLT . . . . .	1	
10	01643-31032	WASHER . . . . .	1	
11	07002-11423	O-RING . . . . .	2	

**DETAIL OF MODIFICATION**

★ **Before Modification.**

Replace the tubes (A,B and C) with the new improved parts and add the slow return valve.

- a. 421-54-37253
- b. 421-43-38162
- c. 421-43-38820

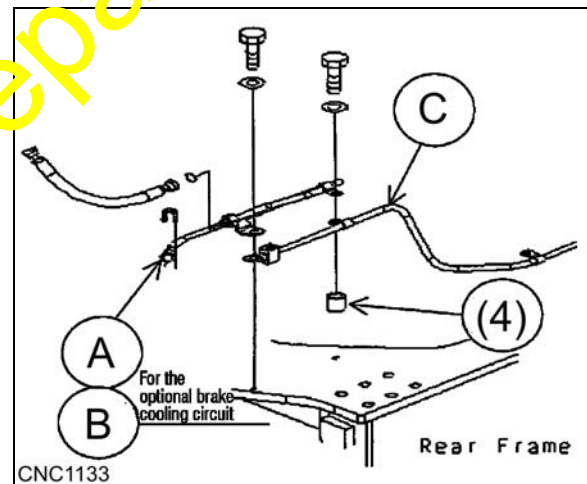

★ **After Modification.**

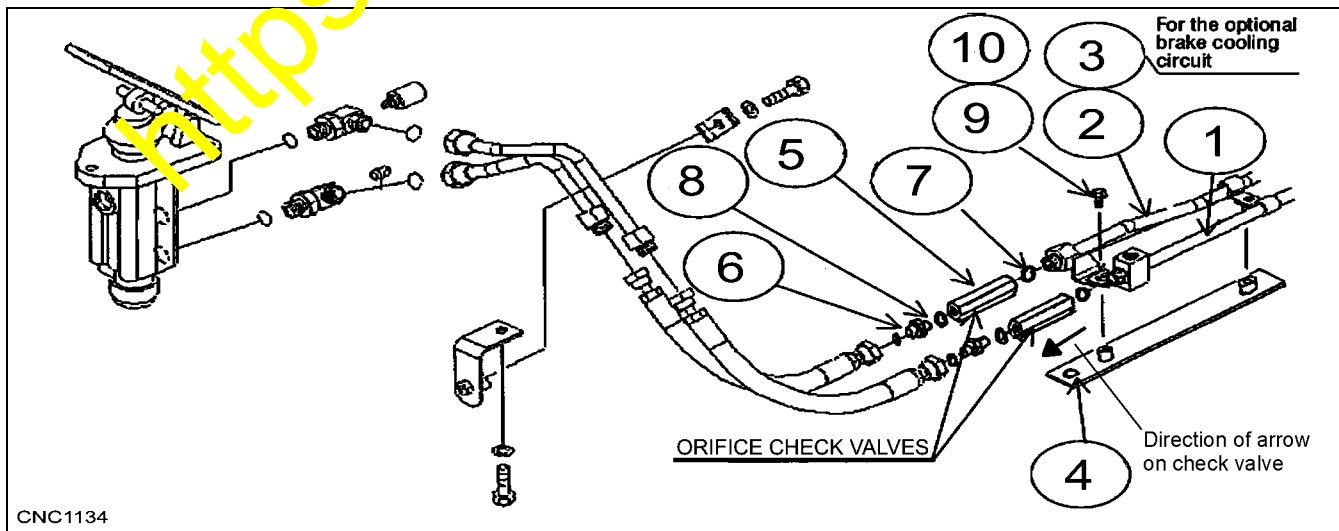

• The parts marked \* will be reused after their removal.

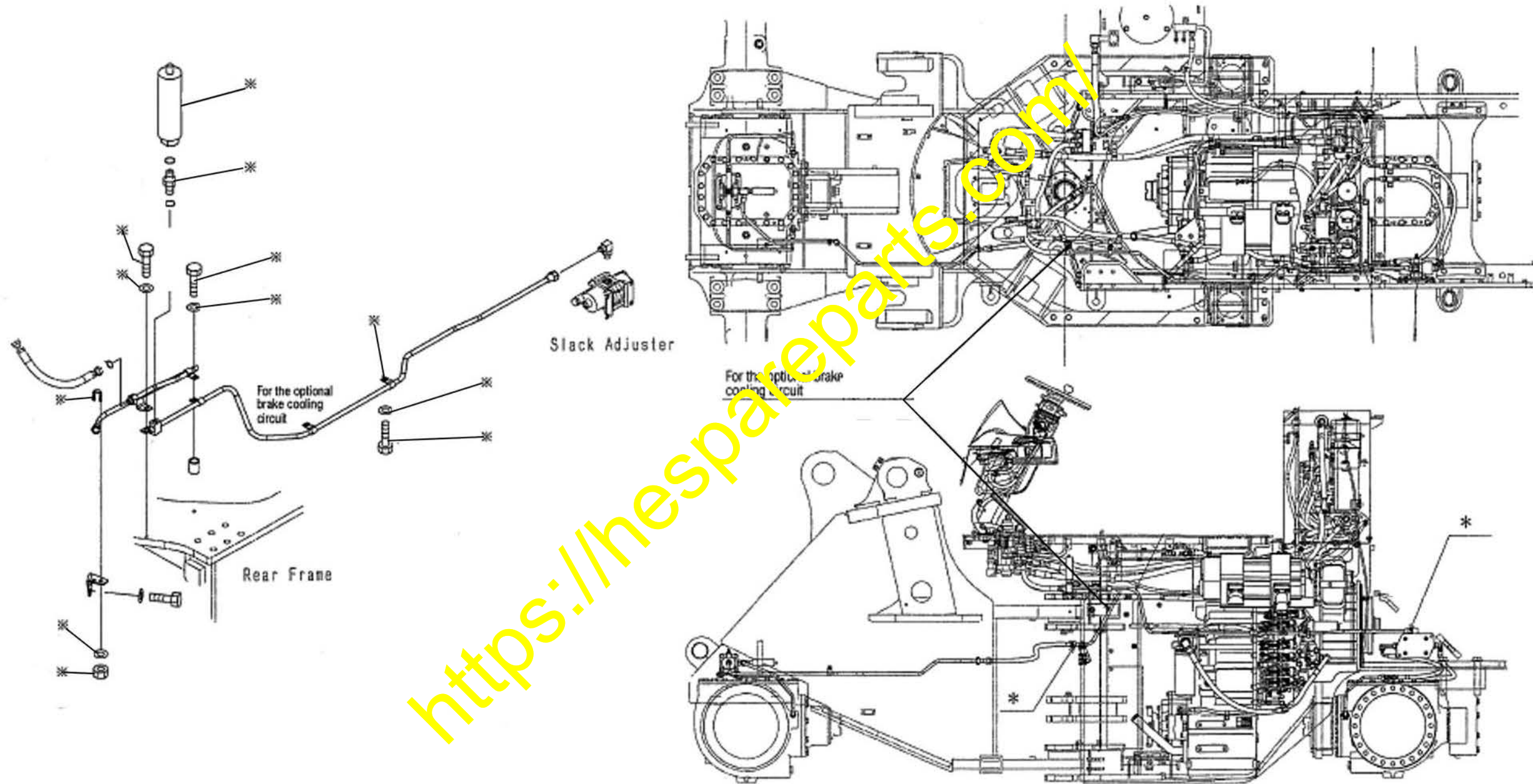

CNC1135

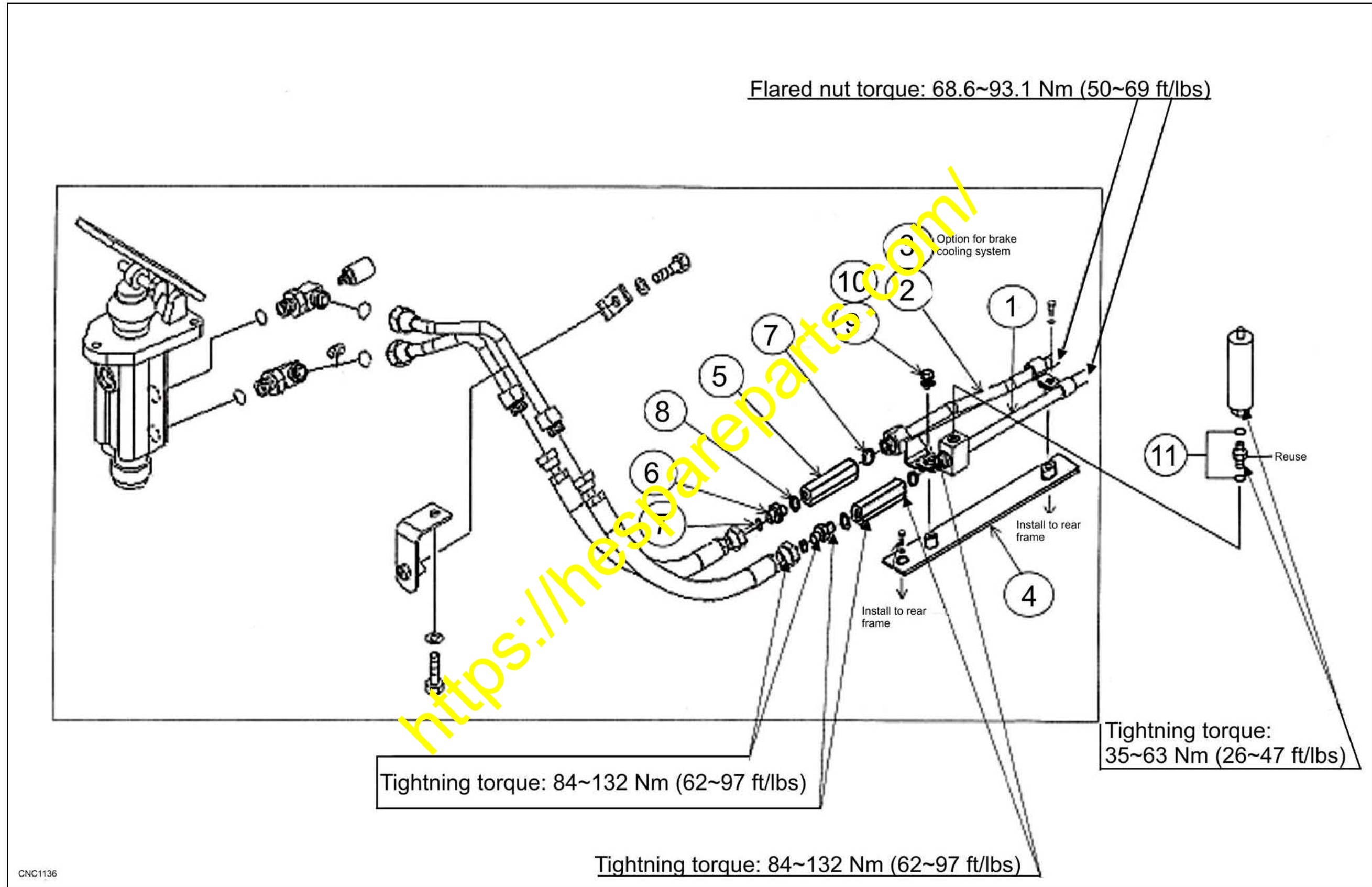

CNC1136