

PARTS & SERVICE NEWS

REF NO.	AA97065
DATE	April 16, 1997

SUBJECT: Grader Drawbar Ballstud Parts Identification

PURPOSE: To identify the parts used in 5 different Drawbar Ballstud Configurations

APPLICATION: All Serial Numbers pertaining to the following Motor Graders
GD530A, GD530AW, GD650A, GD650AW, GD670A, GD670AW, A400E,
T400A, A450E, S450E, A500, A500E, S500E, T500, T500A, T500C,
T500L, T500M, A525, A550, A556, A560E, S560E, A566E, A600,
T600, T600B, T600C, A606, 830, 850 and 870

Graders below #200346

Graders below #200346 used a one piece drawbar ballstud end weldment #140 186. The pin and ball are serviced as a single part. (Fig. 1)

A service kit #1433 770 H91, containing end weldment **#1433 769 H91** was made available to allow conversion of the one piece drawbar ballstud to the two piece design with a single ball retaining nut. (Fig. 2)

Service kit #1433-770-H91 was upgraded to incorporate end weldment **#1437 151 H91**, which allows conversion of the one piece drawbar ballstud to the two piece design with double ball retaining nuts. (Fig. 3)

Graders from #200346 - #202988

Graders from #200346 - #202988 used a two piece ball stud, containing end weldment **#1430 109 H91** with one retaining nut. (Fig. 2)

A service kit #1437 847 H91, containing end weldment **#1436 884 H91**, is now available to allow conversion to the two piece design with double ball retaining nuts. (Fig. 3)

Graders above #202988

Graders above #202988 use a two piece ballstud, containing end weldment **#1436 884 H91**, with double ball retaining nuts. Parts are serviced separately or as kit #1437 847 H91. (Fig. 3)

Fig. 1**Original Configuration - Graders below #200346**

<u>Part Number</u>	<u>Description</u>	<u>Qty.</u>
140 186	END WELDMENT, DRAWBAR	1
140 188	CAP, BALL	1
140 480	SHIM	16

Fig. 2**Interim Configuration Conversion Kit - Graders below #200346 - Kit #1433 770 H91**

<u>Part Number</u>	<u>Description</u>	<u>Qty.</u>
1433 769 H91	END WELDMENT, DRAWBAR	1
140 188	CAP, BALL	1
140 480	SHIM	16
1430 119 H91	BALL	1
25 558 R1	HARDENED WASHER, 1.25	1
27 137 R1	NUT - HEX, 1.25-12UNF	1

Fig. 2**Interim Configuration - Graders #200346 - #202988**

<u>Part Number</u>	<u>Description</u>	<u>Qty.</u>
1430 109 H91	END WELDMENT, DRAWBAR	1
140 188	CAP, BALL	1
140 480	SHIM	16
1430 119 H91	BALL	1
25 558 R1	HARDENED WASHER, 1.25	1
27 137 R1	NUT - HEX, 1.25-12UNF	1

Fig. 3**Current Conversion Kit Configuration - Graders Below #200346 Kit #1433 770 H91**

<u>Part Number</u>	<u>Description</u>	<u>Qty.</u>
1437 151 H91	END WELDMENT, DRAWBAR	1
140 188	CAP, BALL	1
140 480	SHIM	16
1430 119 H91	BALL	1
25 558 R1	HARDENED WASHER, 1.25	2
26 009 R1	NUT - HEX, 1.25-12UNF	1
25 862 R1	WASHER, FLAT - 1 1/8	1
140 255	NUT, HEX - 1 1/8-12	1

Fig. 3**Current Configuration - Graders Above#202988 -****Current Conversion Kit Configuration - Graders #200346 - #202988 - Kit #1437 847 H91**

<u>Part Number</u>	<u>Description</u>	<u>Qty.</u>
1436 884 H91	END WELDMENT, DRAWBAR	1
140 188	CAP, BALL	1
140 480	SHIM	16
1430 119 H91	BALL	1
25 558 R1	HARDENED WASHER, 1.25	2
26 009 R1	NUT - HEX, 1.25-12UNF	1
25 862 R1	WASHER, FLAT - 1 1/8	1
140 255	NUT, HEX - 1 1/8-12	1

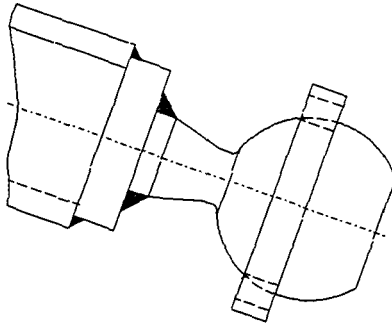

DRAWBAR & ORIGINAL DESIGN BALL STUD
FIG 1

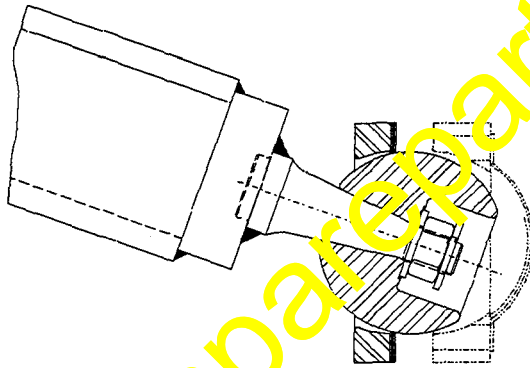

DRAWBAR & INTERNAL PIN WELDMENT AND BALL STUD
FIG 2

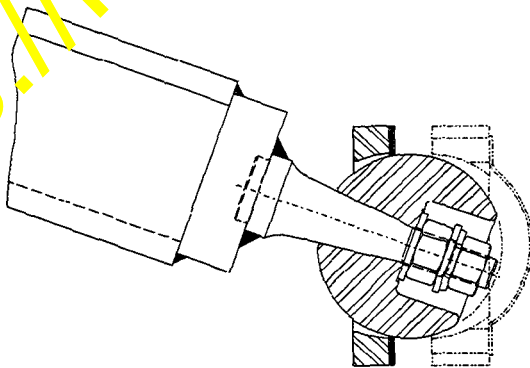

DRAWBAR & LATEST DESIGN PIN WELDMENT AND BALL STUD
FIG 3