

PARTS & SERVICE NEWS

REF NO.	AA97092
DATE	June 13, 1997

Page 1 of 2

SUBJECT: DUAL HORSEPOWER FUEL INJECTION PUMP SHUT-OFF SOLENOID RELOCATION

PURPOSE: To release updated parts for service

APPLICATION: GD650A-1 Motor Grader S/N 200840 thru 201491
 GD650AW-1 Motor Grader S/N 200840 thru 201491
 GD650A-2A Motor Grader S/N 202389 thru 202486
 GD650AW-2A Motor Grader S/N 202389 thru 202486
 GD650A-2B Motor Grader S/N 202487 and up
 GD650AW-2B Motor Grader S/N 202487 and up
 GD650A-2E Motor Grader S/N 202004 and up
 GD650AW-2E Motor Grader S/N 202004 and up
 850 Motor Grader S/N 100477 thru 201502
 850B Motor Grader S/N 202018 and up

DESCRIPTION:

Introduction:

Graders with the "non-emissionized" (S6L114 engine incorporating the "dual horsepower" feature only: the fuel shut-off solenoid has been relocated for service. The revised mounting should alleviate injection pump shut-off shaft oil seal leakage. Please refer to the accompanying illustration and parts list for the revised solenoid mounting.

IMPORTANT: The injection pump should be serviced by an authorized Bosch distributor prior to remounting the fuel shut-off solenoid, to insure the shut-off shaft and seals integrity.

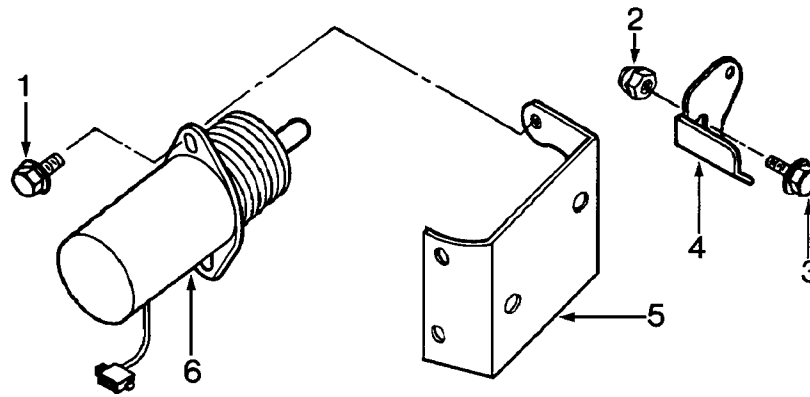

FV920GC

REF NO	PART NUMBER	NAME	REQ
1	6736215310	Screw, Hex Flange Head Cap	2
2	1246372H1	Nut, Lock	2
3	6732214180	Screw, Hex Flange Head Cap	2
4	1310723H1	Lever, Shutoff Valve	1
5	1310724H1	Bracket, Solenoid	1
6	Reference	Solenoid	

Mount the solenoid (6) in the bracket (5). Attach the assembly to the accessory drive outside capscrews.

NOTE: Remove Bosch fuel injection pump. Take it to an authorized Bosch distributor to have RQV Governor reworked per Bosch instruction.