

PARTS & SERVICE NEWS

REF NO. AA98050A

DATE July 24, 2000

Page 1 of 2

"This **PARTS & SERVICE NEWS** supercedes AA98050 dated April 20, 1998 and should be discarded.

SUBJECT: DISCONTINUED FRONT AXLE SPINDLES

PURPOSE: To provide service parts for front axle spindles

APPLICATION: A550 Motor Graders, S/N 01065 and up
 A556 Motor Graders, S/N 03082 and up
 GD530A Motor Graders, S/N 200840 thru 203645
 GD650A Motor Graders, S/N 200840 thru 203645
 GD670A Motor Graders, S/N 200840 thru 203645
 830 Motor Graders, S/N 100496 thru 203645
 850 Motor Graders, S/N 100477 thru 203645
 870 Motor Graders, S/N 100481 thru 203645

FAILURE CODE: 2AA099

DESCRIPTION:

The joint connection between the ball socket on the steering cylinder rods and the steering arms on the spindle have been upgraded. The old ball socket's vertical tapered stud may come loose in the steering arm. This is usually noticed by the castle nut loosening after repeated tightening. This can be upgraded per *PARTS & SERVICE NEWS* AA98043. If the spindle has to be replaced, following the parts called out in this **PARTS & SERVICE NEWS**.

***NOTE:** The information in this **PARTS & SERVICE NEWS** does not authorize or imply any obligation on the part of Komatsu America International Company to provide reimbursement for any expenses. Machines requiring part repair or part replacement during the machine warranty are covered under normal warranty. Out-of-warranty machines are the responsibility of the distributor/customer.*

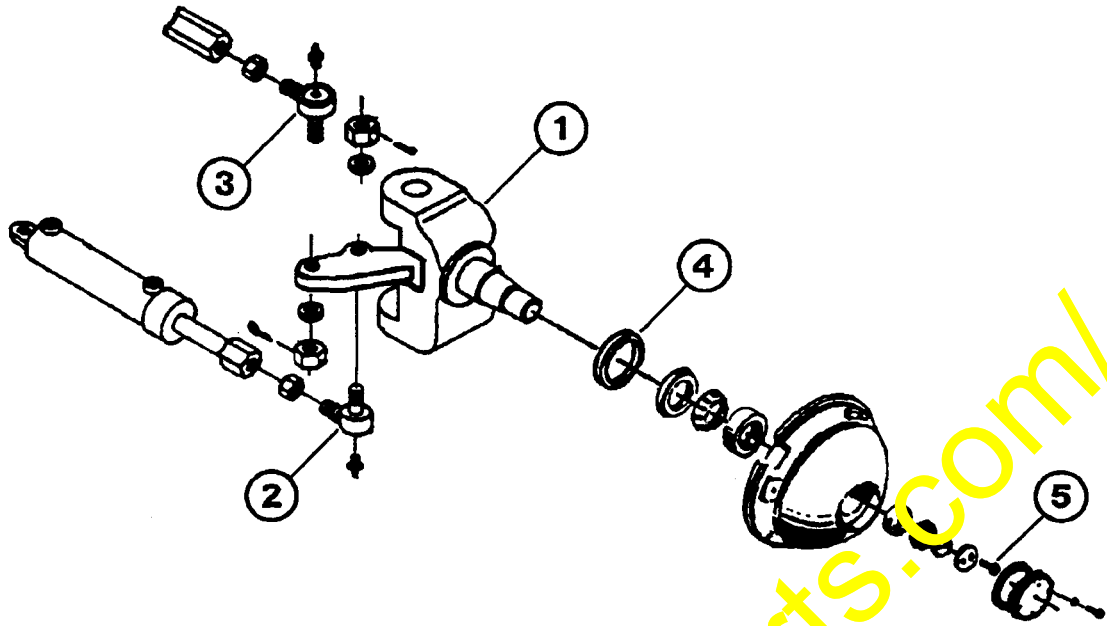

Fig. 1 Front Axle Spindle - R. H. Shown

Old Spindle Part Number	Fig. 1 Item No.	Replaced by Part Number	Description	Qty.
1283 396 H91	1	1438 766 H91	Spindle Weldment R.H	1
	2 & 3	1435 357 H1	Ball Socket R.H	2
	4	1439 237 H1	Retaining Collar	1
	5	10262 H45	Capscrews	2
	1283 397 H91	1	1438 765 H91	Spindle Weldment L.H
2		1435 357 H1	Ball Socket R.H	1
3		1435 356 H1	Ball Socket L.H	1
4		1439 237 H1	Retaining Collar	1
5		10262 H45	Capscrews	2
1433 736 H91	1	1439 302 H91	Spindle Weldment R. H w/fenders	1
	2 & 3	1435 357 H1	Ball Socket R H	2
	4	1439 237 H1	Retaining Collar	1
	5	10262 H45	Capscrews	2
	1433 737 H91	1	1439 301 H91	Spindle Weldment L.H w/fenders
2		1435 357 H1	Ball Socket R.H	1
3		1435-356 H1	Ball Socket L.H	1
4		1439 237 H1	Retaining Collar	1
5		10262 H45	Capscrews	2

NOTE: Do not mix old and new spindle weldments, replace both right and left spindles.