

PARTS & SERVICE NEWS

REF NO. AA99096

DATE May 18, 1999

Page 1 of 5

SUBJECT: HYDRAULIC TUBE BRACKET MODIFICATION OR REPLACEMENT

PURPOSE: TO INFORM THE FIELD OF CHANGES

APPLICATION: WA800-2L WHEEL LOADER WITH S/N A20001 THRU A20019
WA800-2LC WHEEL LOADER WITH S/N A20020 THRU A20023
WA900-1L WHEEL LOADER WITH S/N A20001 THRU A20007
WA900-1LC WHEEL LOADER WITH S/N A20008 THRU A20014

FAILURE CODE: 6A4099

DESCRIPTION: Misaligned hydraulic oil piping may cause cracks in the oil piping tubes.

INTRODUCTION

To prevent the hydraulic oil tubes from cracking, perform the modification in this letter.

PARTS LIST

P/N	PART NAME	QTY.	REMARKS
427-62-12534	BRACKET	1	No need to order this bracket if existing bracket will be reworked.

NOTE

When high-pressure filters are installed in the work hydraulic circuit, the machine will have a different bracket.

MODIFICATION OR NEW BRACKET

You will have a choice of using the new bracket or modifying the existing bracket.

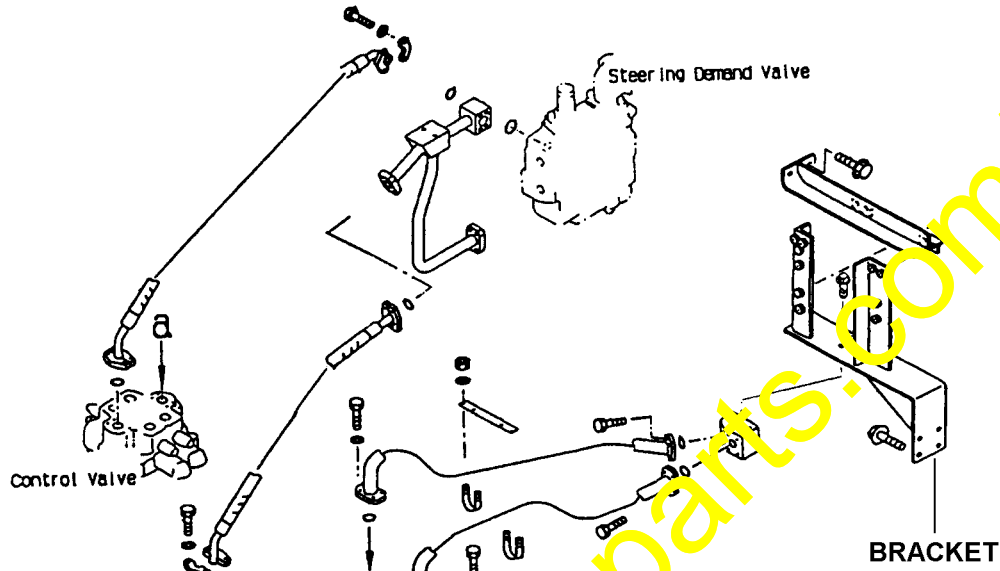

TOP VIEW

OLD BRACKET

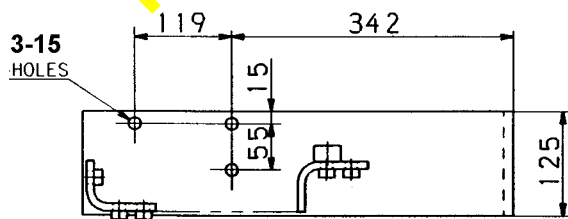

NEW BRACKET

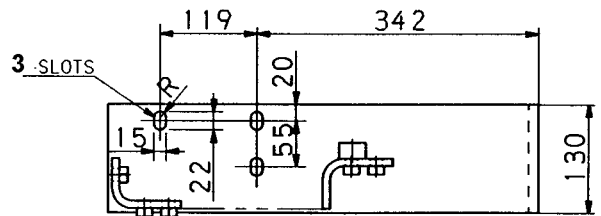

L10AD154

MODIFICATION PROCEDURE

Before attempting the modification, release the hydraulic oil pressure.

1. Remove the bracket from the front frame.

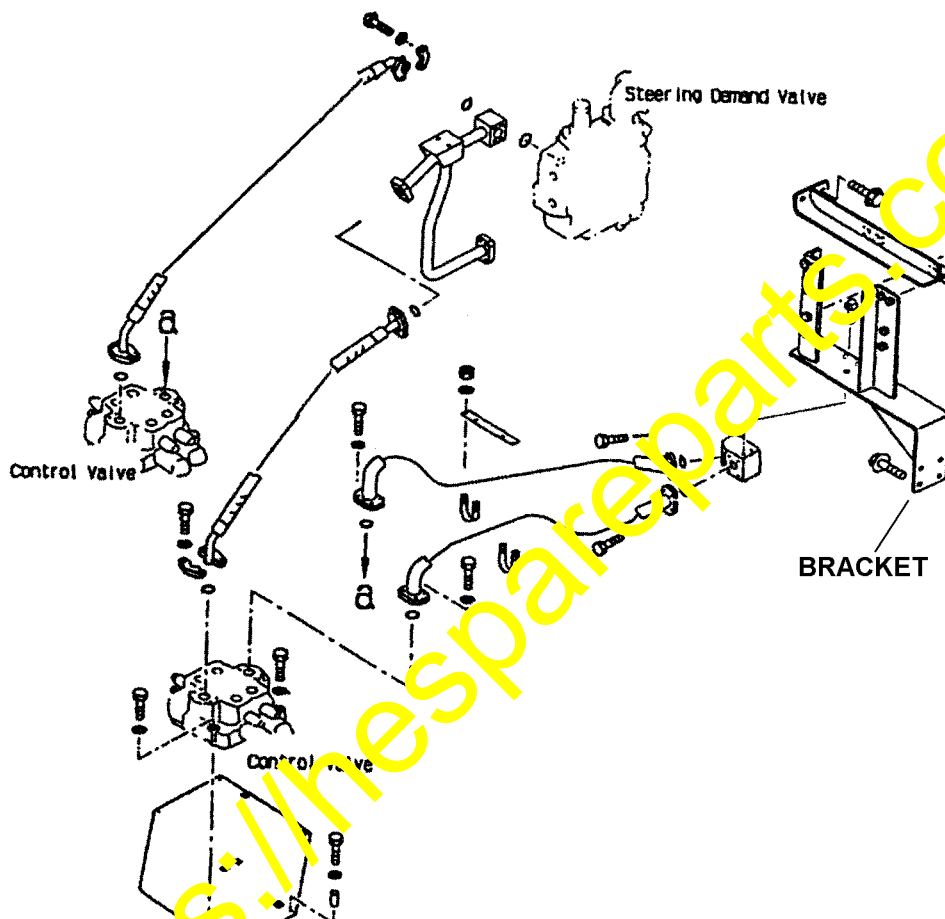

L10AD155

- To modify the existing bracket, make slots in the 3-15 holes in the bracket.

TOP VIEW OF BRACKET

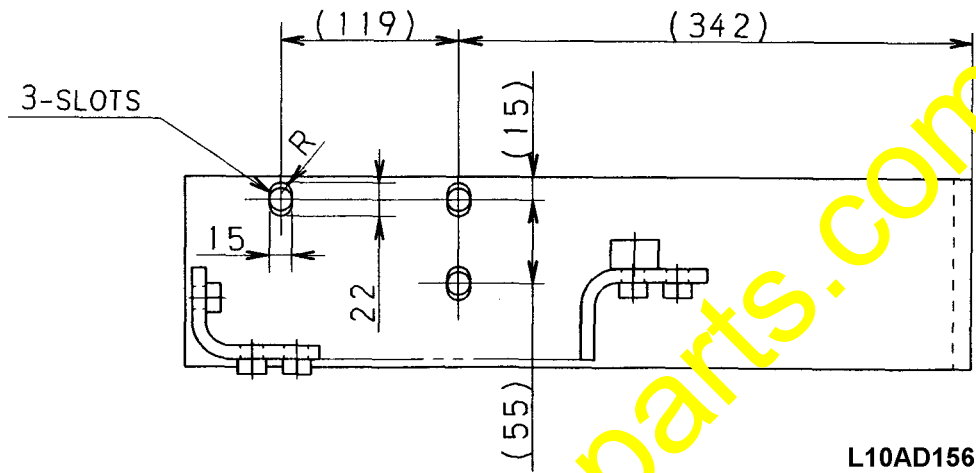

3. Install the new or modified bracket to the frame.
4. Install the tubes, A and B, to the junction, C. Make sure the tubes, A and B, are not stressed after installation.
5. Install the plate, D.
6. Bleed the air from the hydraulic circuit. If needed, refer to the O & M manual, section 24.2.16.

