

# PARTS & SERVICE NEWS

REF NO. AA99123

DATE July 1, 1999

Page 1 of 17

**SUBJECT:** VARIOUS WIRE HARNESSSES**PURPOSE:** ISSUE REVISED PARTS BOOK PAGES**APPLICATION:** WA320-3L Wheel Loaders - See table below  
WA380-3L Wheel Loaders - See table below  
WA420-3L Wheel Loaders - See table below  
WA450-3L Wheel Loaders - See table below**FAILURE CODE:** D51099**DESCRIPTION:**

The following parts book pages were issued incorrectly or have been partially revised.

Refer to the following table for the appropriate serial number break:

MODEL	PART NUMBER	SERIAL NUMBER
WA320-3L	419-06-A1280	A30001 and up
	419-06-A1331	A30416 and up
	419-06-A1340	A30446 and up
	419-06-A1231	A30001 and up
	419-06-A1270	A30001 and up
	423-06-22310	A50001 and up
WA380-3L	423-06-A1141	A50001 and up
	421-06-A1340	A50428 and up
	416-06-A1331	A50001 and up
	421-06-22940	A30001 and up
WA420-3L	421-06-A1340	A30164 and up
	421-06-22940	A30001 and up
WA450-3L	421-06-22940	A30001 and up
	421-06-A1340	A30362 and up

**ELECTRICAL SYSTEM**  
FRONT FRAME LINE

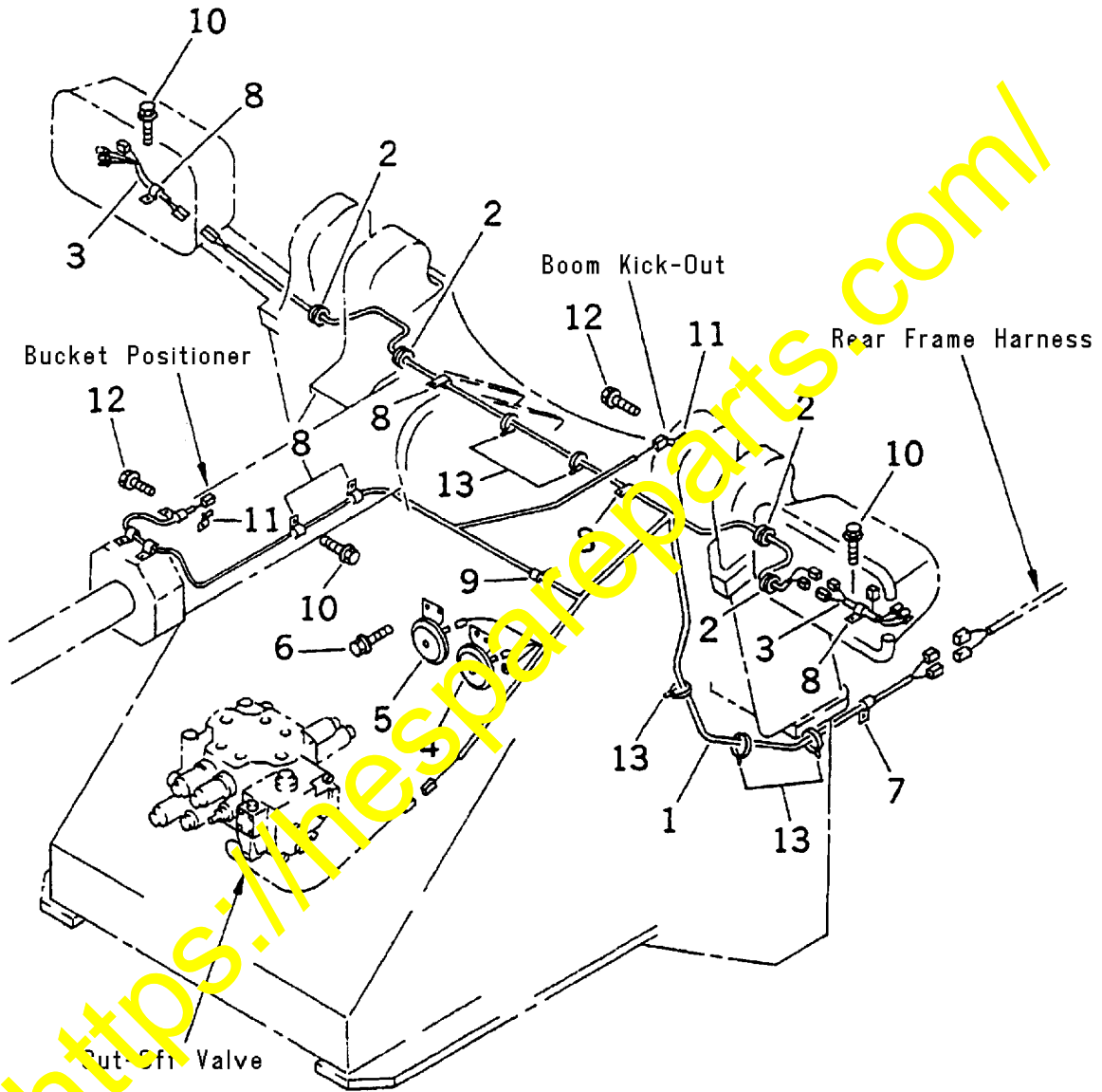

L08AD209

**ELECTRICAL SYSTEM**  
**FRONT FRAME LINE**

Item	Part Number	Description	Qty.	Ref.
1	419-06-A1280	HARNESS, FRONT FRAME .....	1	
	08020-10000	.DIODE .....	1	
2	424-06-12910	GROMMET .....	4	
3	421-06-22360	HARNESS, HEAD LAMP .....	2	
	08020-10000	.DIODE .....	2	
4	08160-62430	HORN .....	1	
5	08160-62420	HORN .....	1	
6	01435-00812	BOLT .....	4	
7	08036-01414	CLIP .....	1	
8	08036-01414	CLIP .....	7	
9	04434-51710	CLIP .....	1	
10	01435-01016	BOLT .....	10	
11	08053-01512	CLIP .....	2	
12	01435-01020	BOLT .....	2	
13	306 132 C1	STRAP, TIE .....	7	

<https://hespareparts.com/>

**ELECTRICAL SYSTEM  
FLOOR LINE**

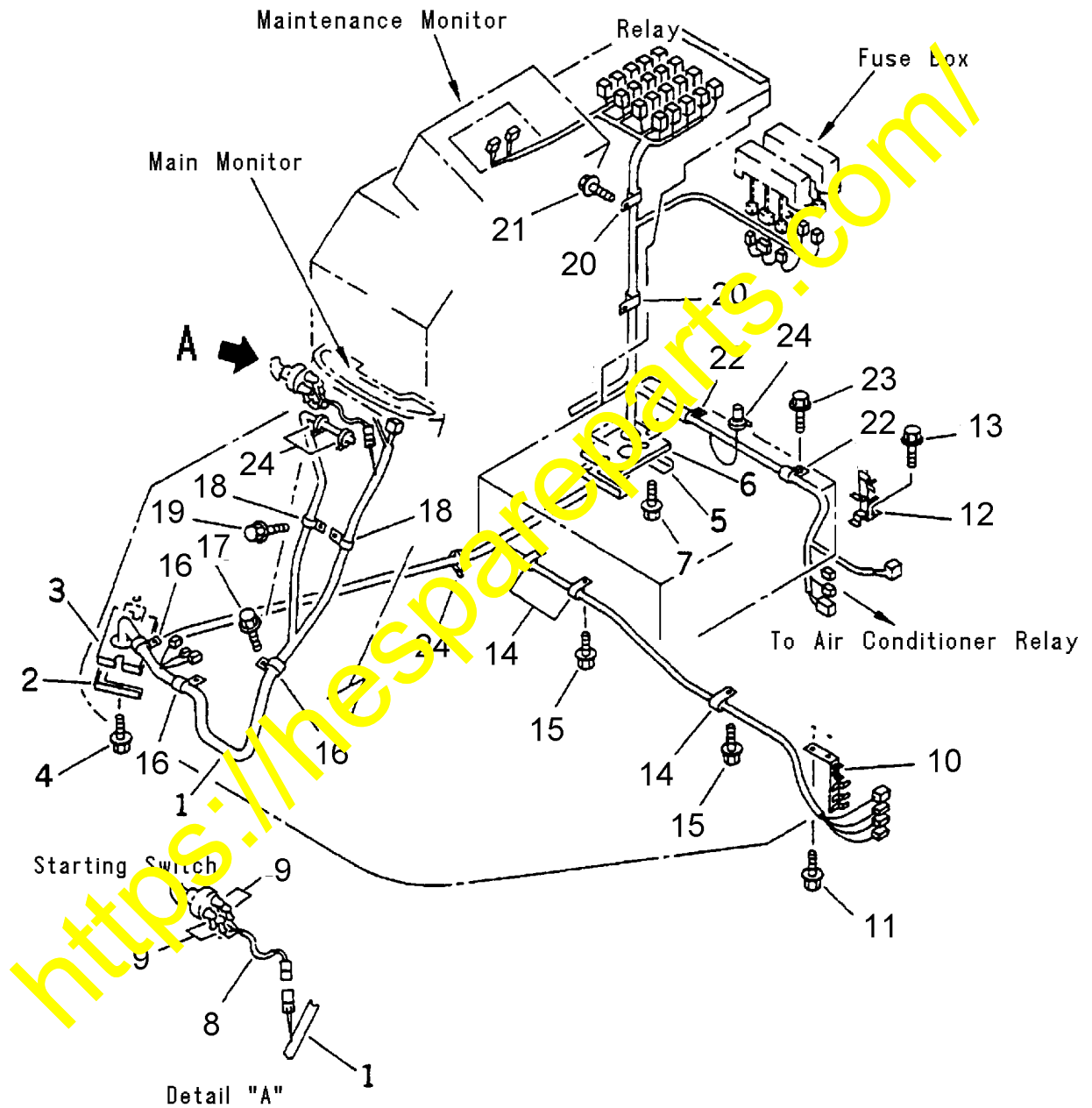

**L08AD210A**

**ELECTRICAL SYSTEM**  
**FLOOR LINE**

Item	Part Number	Description	Qty.	Ref.
1	419-06-A1231	HARNESS, FLOOR LINE .....	1	
	08020-10000	.DIODE .....	2	
2	419-06-22530	PLATE .....	1	
3	421-06-22520	SHEET .....	1	
4	01435-00610	BOLT .....	2	
5	419-06-22530	PLATE .....	1	
6	421-06-22540	SHEET .....	1	
7	01435-00610	BOLT .....	2	
8	421-06-22691	HARNESS, STARTING SWITCH .....	1	
9	08038-00518	CAP .....	4	
10	421-06-22940	BRACKET .....	1	
11	01435-01016	BOLT .....	2	
12	421-06-22950	BRACKET .....	1	
13	01435-01016	BOLT .....	1	
14	08036-02514	CLIP .....	3	
15	01435-01016	BOLT .....	3	
16	281-01-13180	CLIP .....	3	
17	01435-01016	BOLT .....	3	
18	04434-52712	CLIP .....	2	
19	01435-01016	BOLT .....	2	
20	04434-53412	CLIP .....	5	
21	01435-01016	BOLT .....	4	
22	08036-03014	CLIP .....	3	
23	01435-01016	BOLT .....	1	
24	935 522 C1	STRAP, TIE .....	4	

**ELECTRICAL SYSTEM**  
**REAR FRAME LINE**

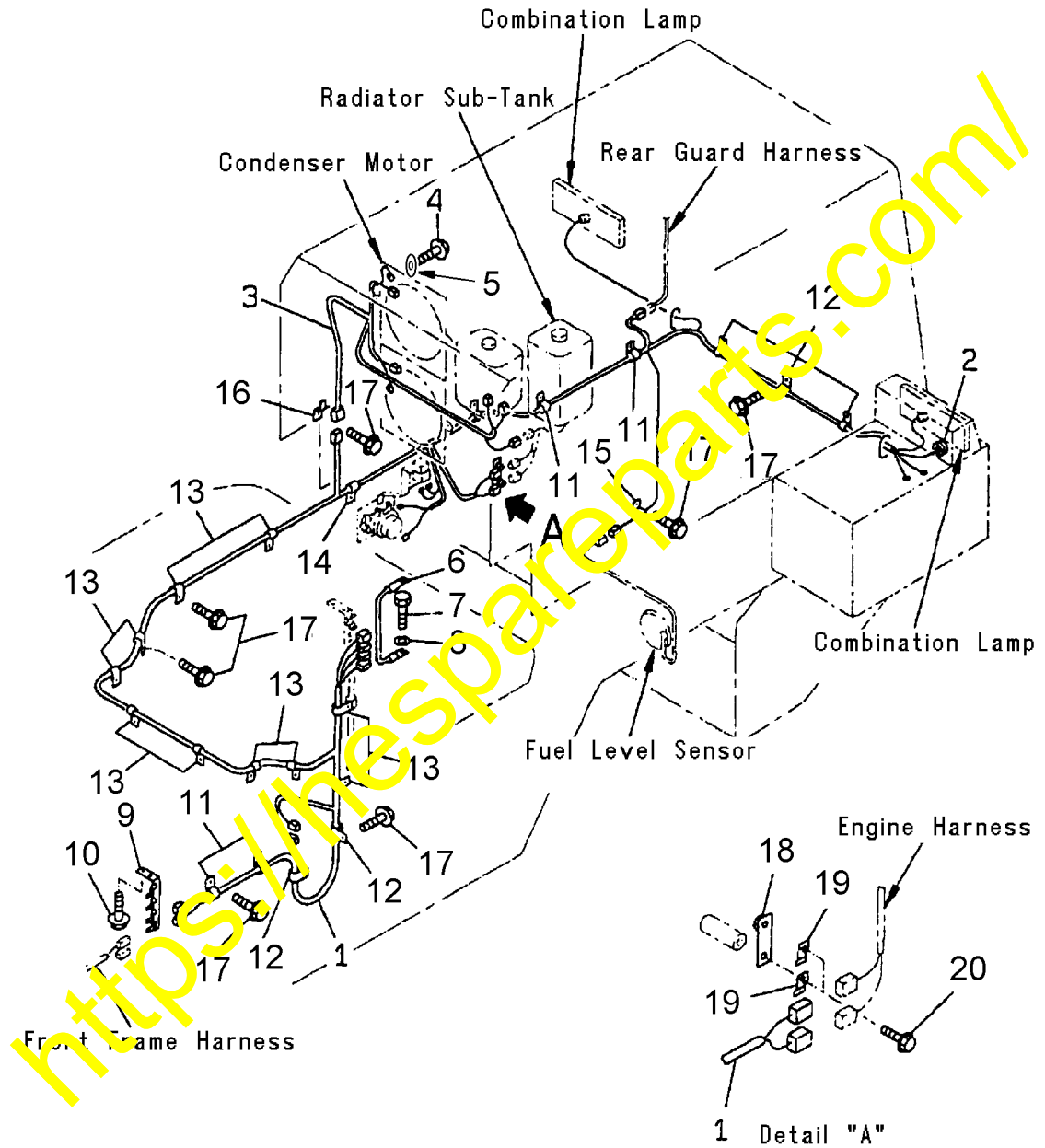

L08AD211A

**ELECTRICAL SYSTEM**  
**REAR FRAME LINE**

Item	Part Number	Description	Qty.	Ref.
1	419-06-22350	HARNESS, REAR FRAME .....	1	
	421-06-11970	.DIODE .....	4	
2	08037-02512	GROMMET .....	1	
3	421-06-22740	HARNESS, BULK HEAD .....	1	
	421-06-11970	.DIODE .....	2	
4	01010-51012	BOLT .....	2	
5	01643-31032	WASHER .....	2	
6	08028-12045	WIRE .....	1	
7	01010-51016	BOLT .....	2	
8	01643-31032	WASHER .....	2	
9	419-06-22320	BRACKET .....	1	
10	01435-01220	BOLT .....	2	
11	08036-02514	CLIP .....	5	
12	04434-51710	CLIP .....	5	
13	04434-53411	CLIP .....	10	
14	04434-52110	CLIP .....	1	
15	08036-01014	CLIP .....	1	
16	08053-01510	CLIP .....	1	
17	01435-01016	BOLT .....	22	
18	419-06-12760	PLATE .....	1	
19	08053-00912	CLIP .....	2	
20	01435-01020	BOLT .....	2	

<https://hespareparts.com/>

**ELECTRICAL SYSTEM**  
**ENGINE AND TRANSMISSION LINE**

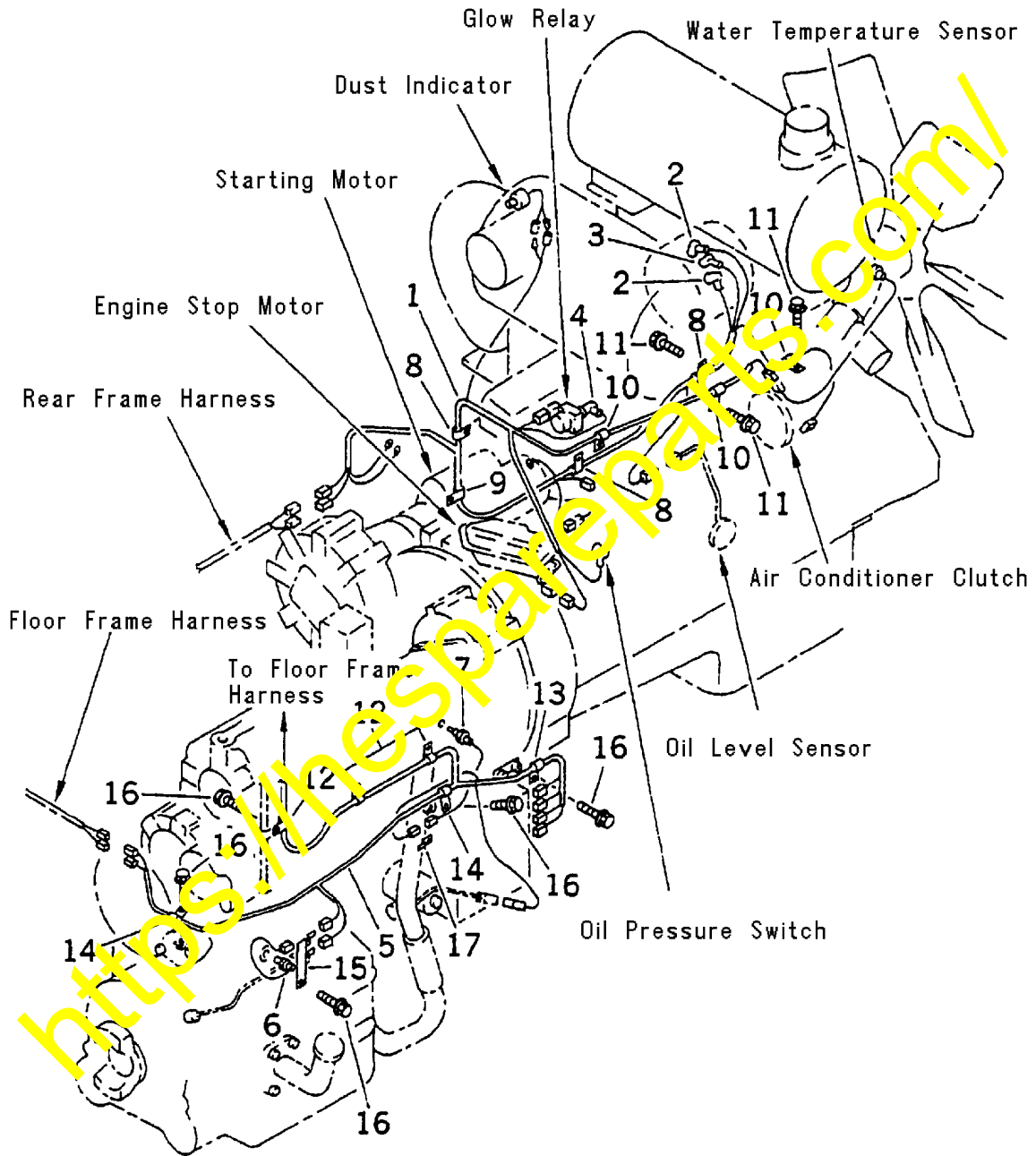

L08AD212



**ELECTRICAL SYSTEM**  
ENGINE AND TRANSMISSION LINE

Item	Part Number	Description	Qty.	Ref.
1	419-06-A1331	HARNESS, ENGINE .....	1	
	0802-10000	.DIODE .....	1	
	428-S20-1120	.CONNECTOR .....	1	
2	08038-00519	CAP .....	2	
3	08038-02027	CAP .....	1	
4	08038-00519	CAP .....	1	
5	423-06-22150	HARNESS, TRANSMISSION .....	1	
	421-06-11970	.DIODE .....	5	
	421-06-22750	.CONNECTOR .....	2	
6	7861-92-2330	SENSOR, SPEED .....	1	
7	7861-92-3320	SENSOR, TORQUE CONVERTER OIL TEMPERATURE	1	
8	08036-02514	CLIP .....	5	
9	04434-52210	CLIP .....	1	
10	08036-01014	CLIP .....	3	
11	01435-01016	BOLT .....	7	
12	04434-52210	CLIP .....	3	
13	08036-01414	CLIP .....	1	
14	08036-01014	CLIP .....	2	
15	419-06-22610	PLATE .....	1	
16	01435-01016	BOLT .....	6	
17	08053-01510	CLIP .....	1	

<https://hespareparts.com/>

**ELECTRICAL SYSTEM  
FRONT FRAME LINE**

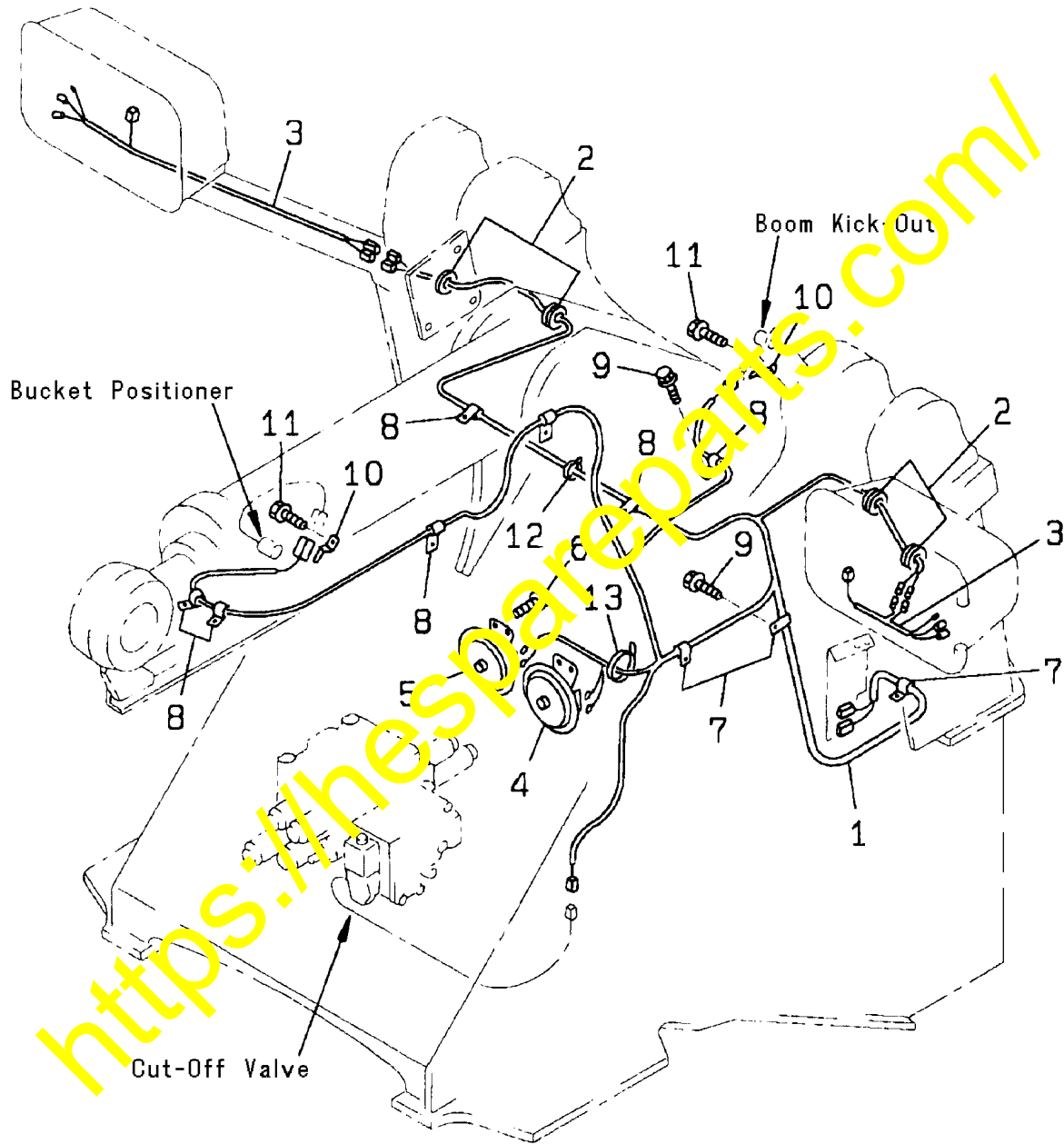

L08AD222

**ELECTRICAL SYSTEM**  
**FRONT FRAME LINE**

Item	Part Number	Description	Qty.	Ref.
1	423-06-22310	HARNESS, FRONT FRAME .....	1	
	08020-10000	.DIODE .....	1	
2	424-06-12910	GROMMET .....	4	
3	421-06-22360	HARNESS, FRONT LAMP .....	2	
	08020-10000	.DIODE .....	2	
4	421-06-29210	HORN, LOW .....	1	
5	421-06-29220	HORN, HIGH .....	1	
6	01435-00825	BOLT .....	4	
7	08036-01414	CLIP .....	3	
8	08036-01014	CLIP .....	7	
9	01435-01016	BOLT .....	10	
10	08053-01512	CLIP .....	2	
11	01435-01016	BOLT .....	2	
12	08034-00823	STRAP, TIE .....	2	
13	08034-20519	STRAP, TIE .....	1	

<https://hespareparts.com/>

**ELECTRICAL SYSTEM  
FLOOR LINE**

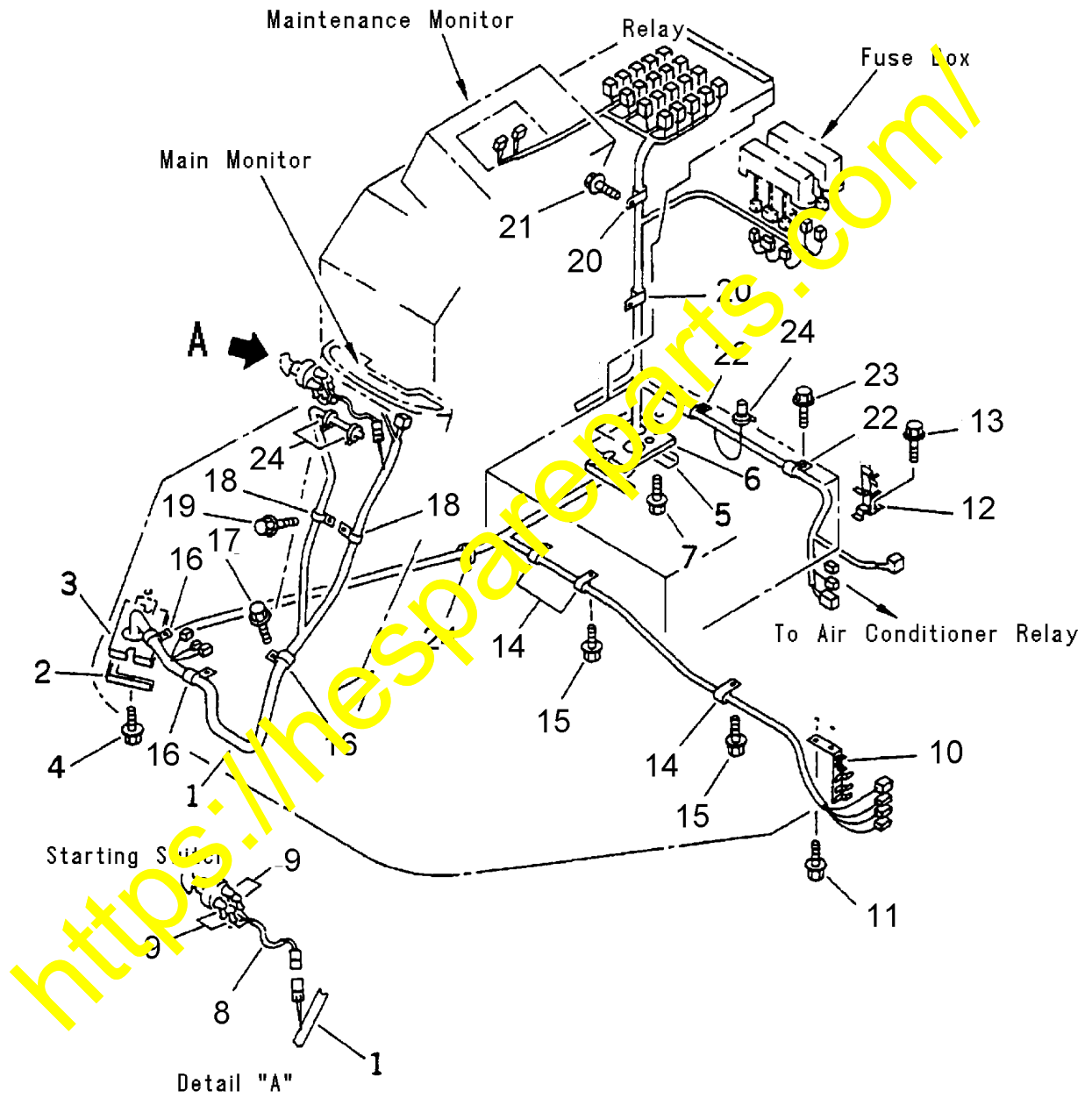

**L08AD210A**

**ELECTRICAL SYSTEM**  
**FLOOR LINE**

Item	Part Number	Description	Qty.	Ref.
1	423-06-A1141	HARNESS, FLOOR LINE .....	1	
	08020-10000	.DIODE .....	6	
2	419-06-22530	PLATE .....	1	
3	421-06-22520	SHEET .....	1	
4	01435-00610	BOLT .....	2	
5	419-06-22530	PLATE .....	1	
6	421-06-22540	SHEET .....	1	
7	01435-00610	BOLT .....	2	
8	421-06-22730	PLATE .....	1	
9	421-06-22740	SHEET .....	1	
10	01435-00608	BOLT .....	2	
11	421-06-22691	HARNESS, STARTING SWITCH .....	1	
12	08038-00518	CAP .....	4	
13	421-06-22940	BRACKET .....	1	
14	01435-01016	BOLT .....	2	
15	421-06-22950	BRACKET .....	1	
16	01435-01016	BOLT .....	1	
17	08036-02514	CLIP .....	4	
18	01435-01016	BOLT .....	4	
19	281-01-13180	CLIP .....	3	
20	01435-01016	BOLT .....	3	
21	04434-52712	CLIP .....	2	
22	01435-01016	BOLT .....	2	
23	04434-53412	CLIP .....	6	
24	01435-01016	BOLT .....	4	
25	08036-03014	CLIP .....	3	
26	01435-01016	BOLT .....	1	
27	08034-20519	STRAP, TIE .....	4	

### ELECTRICAL SYSTEM ENGINE AND TRANSMISSION LINE

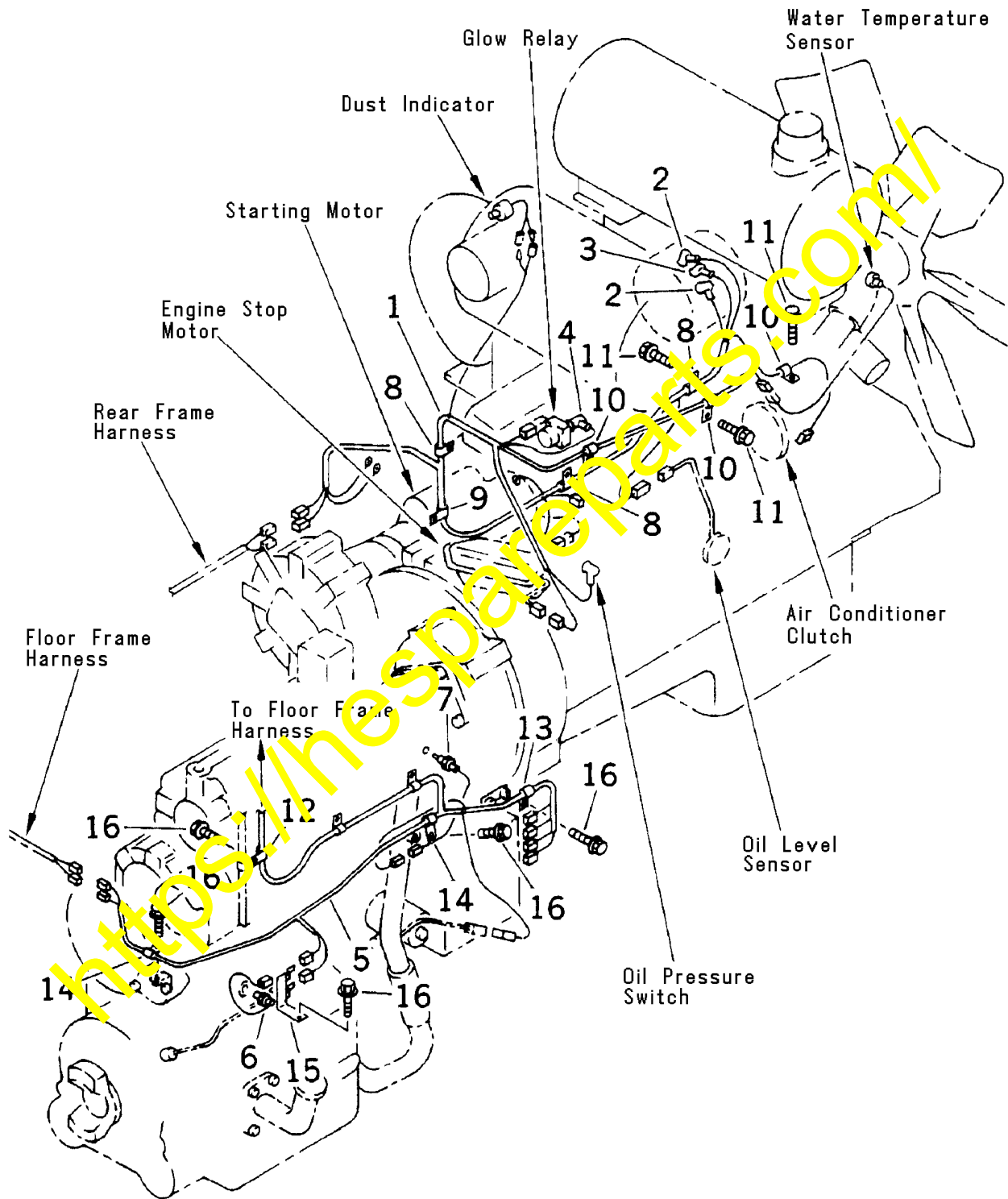

L08AD224

**ELECTRICAL SYSTEM**  
ENGINE AND TRANSMISSION LINE

Item	Part Number	Description	Qty.	Ref.
1	419-06-A1331	HARNESS, ENGINE .....	1	
	08020-10000	.DIODE .....	1	
	428-S20-1120	.CONNECTOR, SHORT .....	1	
2	08038-00519	CAP .....	2	
3	08038-02027	CAP .....	1	
4	08038-00519	CAP .....	1	
5	423-06-22160	HARNESS, TRANSMISSION .....	1	
	08020-10000	.DIODE .....	5	
	421-06-22750	.CONNECTOR, SHORT .....	2	
6	7861-92-2330	SENSOR, SPEED .....	1	
7	7861-92-3320	SENSOR, TORQUE CONVERTER OIL TEMPERATURE	1	
8	08036-02514	CLIP .....	2	
9	04434-52212	CLIP .....	1	
10	08036-01014	CLIP .....	3	
11	01435-01016	BOLT .....	7	
12	04434-52212	CLIP .....	2	
13	08036-01414	CLIP .....	1	
14	08036-01014	CLIP .....	2	
15	423-06-22440	PLATE .....	1	
16	01435-01016	BOLT .....	4	

https://hespareparts.com/

**ELECTRICAL SYSTEM  
FLOOR LINE**

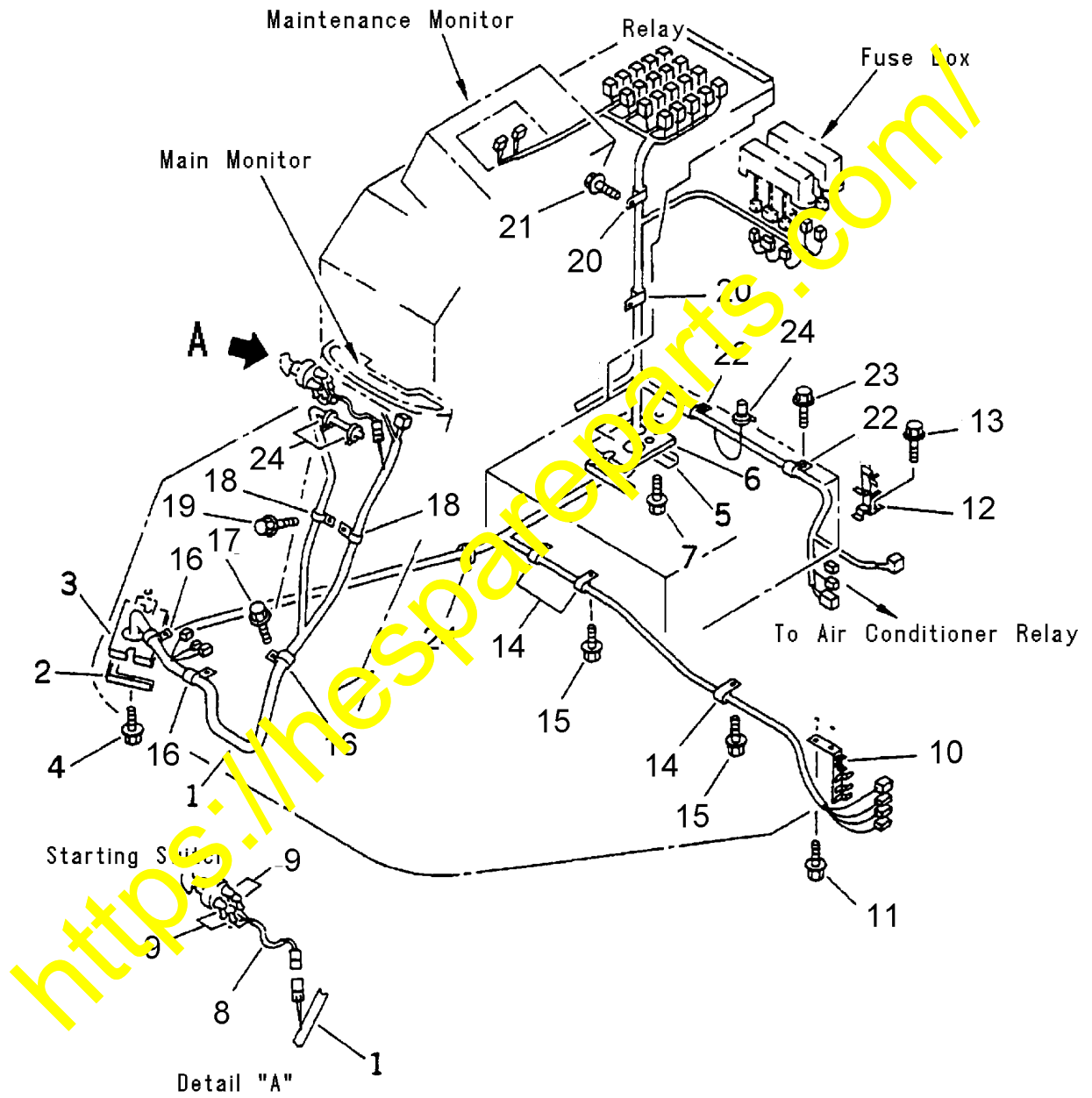

**L08AD210A**



**ELECTRICAL SYSTEM**  
**FLOOR LINE**

Item	Part Number	Description	Qty.	Ref.
1	423-06-A1140	HARNESS, FLOOR LINE .....	1	
	421-06-11970	.DIODE .....	6	
2	419-06-22530	PLATE .....	1	
3	421-06-22520	SHEET .....	1	
4	01435-00610	BOLT .....	2	
5	419-06-22530	PLATE .....	1	
6	421-06-22540	SHEET .....	1	
7	01435-00610	BOLT .....	2	
8	421-06-22730	PLATE .....	1	
9	421-06-22740	SHEET .....	1	
10	01435-00608	BOLT .....	2	
11	421-06-22690	HARNESS, STARTING SWITCH .....	1	
12	08038-00518	CAP .....	4	
13	421-06-22940	BRACKET .....	1	
14	01435-01016	BOLT .....	2	
15	421-06-22950	BRACKET .....	1	
16	01435-01016	BOLT .....	1	
17	08036-02514	CLIP .....	3	
18	01435-01016	BOLT .....	3	
19	281-01-13180	CLIP .....	3	
20	01435-01016	BOLT .....	3	
21	04434-52712	CLIP .....	2	
22	01435-01016	BOLT .....	2	
23	04434-53412	CLIP .....	5	
24	01435-01016	BOLT .....	4	
25	08036-03014	CLIP .....	3	
26	01435-01016	BOLT .....	1	
27	935 522C1	STRAP, TIE .....	1	