

# PARTS & SERVICE NEWS

|         |                 |
|---------|-----------------|
| REF NO. | AA99152         |
| DATE    | October 20,1999 |

(C)

**SUBJECT:** WORKLAMP RELOCATION

**PURPOSE:** Relocate worklamps outside of cab to prevent windshield cracking

**APPLICATION:** WA500-3L Wheel Loader Serial Number A70001 thru A70621

**FAILURE CODE:** DU2099

**DESCRIPTION:** Heat generated from the worklamps located in the cab has been determined as a cause for windshield failures. This Parts and Service News describes the procedure to relocate the worklamps to the outside of the cab.

**Introduction:**

The worklamps will be removed from the inside of the cab and mounted on the stays of the left and right side mirrors. The following parts and procedure will be required to perform this task.

**Required Parts:**

Parts to be Removed:

| Index | Part No.     | Description                   | Qty. | Remarks      |
|-------|--------------|-------------------------------|------|--------------|
| 1     | 421-06-23360 | Lamp Assembly, Working- Front | 2    | To Be Reused |
| 2     | 01435-01220  | Bolt                          | 2    | To Be Reused |
| 3     | 421-56-21680 | Fastener                      | 4    |              |
| 4     | 421-56-21330 | Cover, L.H.                   | 1    |              |
| 5     | 421-56-21340 | Cover, R.H.                   | 1    |              |
| 6     | 421-56-21350 | Seal                          | 2    |              |
| 7     | 01023-70512  | Screw                         | 8    | To Be Reused |
| 8     | 01642-40608  | Washer                        | 8    | To Be Reused |
| 9     | 09415-01008  | Cap                           | 2    |              |

**Required Parts (continued):**

Parts to be Purchased:

| <b>Index</b> | <b>Part No.</b> | <b>Description</b> | <b>Qty.</b> | <b>Remarks</b> |
|--------------|-----------------|--------------------|-------------|----------------|
| 10           | 423-975-1140    | Grommet            | 2           |                |
| 11           | 425-56-21130    | Wiring Harness     | 2           |                |
| 12           | 425-56-21140    | Plate, L.H.        | 1           |                |
| 13           | 425-56-21150    | Plate, R.H.        | 1           |                |
| 14           | 425-56-21110    | Bracket, L.H.      | 1           |                |
| 15           | 425-56-21120    | Bracket, R.H.      | 1           |                |
| 16           | 07283-32746     | U-bolt             | 2           |                |
| 17           | 07283-52737     | Seat               | 2           |                |
| 18           | 01643-31032     | Washer             | 2           |                |
| 19           | 01580-11008     | Nut                | 2           |                |
| 20           | 08053-01510     | Clip               | 2           |                |
| 21           | 01435-01020     | Bolt               | 2           |                |
| 22           | 421-54-15520    | Clip               | 2           |                |
| 23           | 423-56-21110    | Windshield         | 1           |                |
| 24           | 423-56-21140    | Seal, Windshield   | 1           |                |

**Procedure:**

The following instructions detail the relocation of the working lamps on the left hand side of the cab. The same instructions should be followed for the right hand side of the cab.

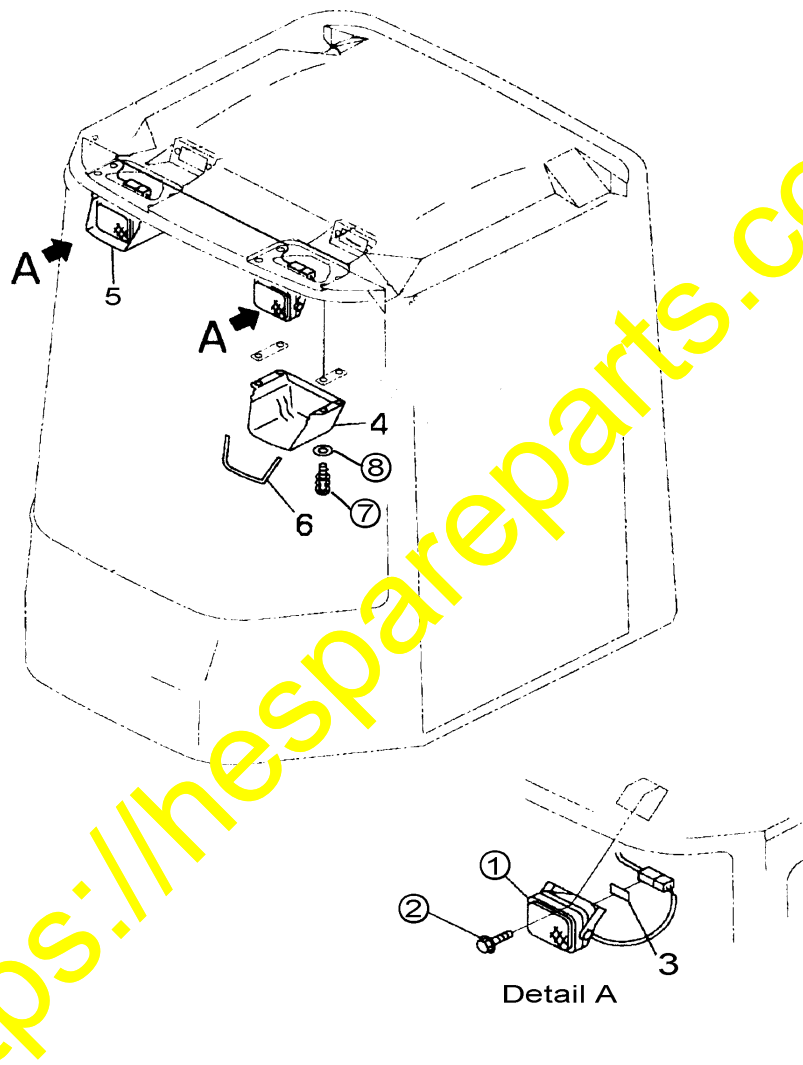
**Figure 1 Existing Worklamp Removal**

**Note:** Index numbers that are circled shall be saved and used for lamp relocation.

1. Remove screws (7), washers (8), covers (4,5) and seals (6) from worklamps.
2. Disconnect wire harness.
3. Remove bolt (2), fastener (3) and lamp assembly (1) from cab.

**Procedure (continued):**

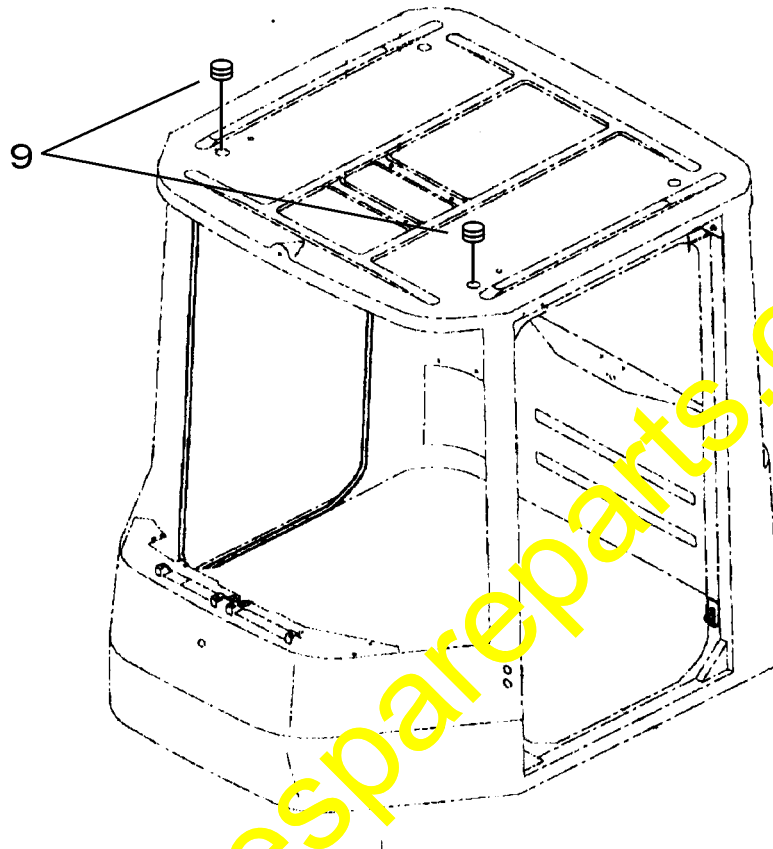

**Figure 2 Relocation Preparation**

4. Remove and discard the front two plug caps (9) from cab roof.

## Procedure (continued):

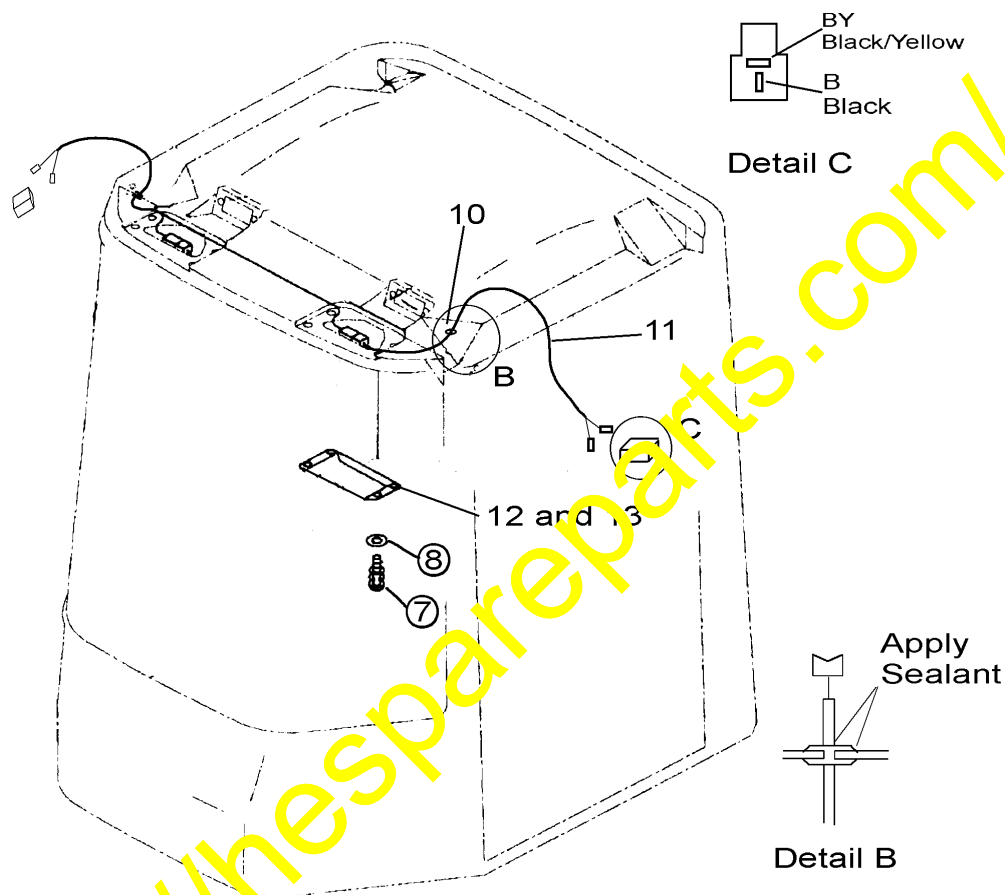

**Figure 3 Wire Harness Installation**

**Note:** Connector in detail C is shipped loosely and must be installed **AFTER** harness (11) is installed in the cab.

5. Install wire harness (11) through hole in cab and connect to existing harness.
6. As shown in detail B, place grommet (10) over harness and in hole in cab. Using threebond 5211E or equivalent, apply sealant between grommet and cab and where harness comes through grommet.
7. Using screws (7) and washers (8), install new plates (12,13) in cab.
8. As shown in detail C, install loose connector on wire harness (11).

Procedure (continued):

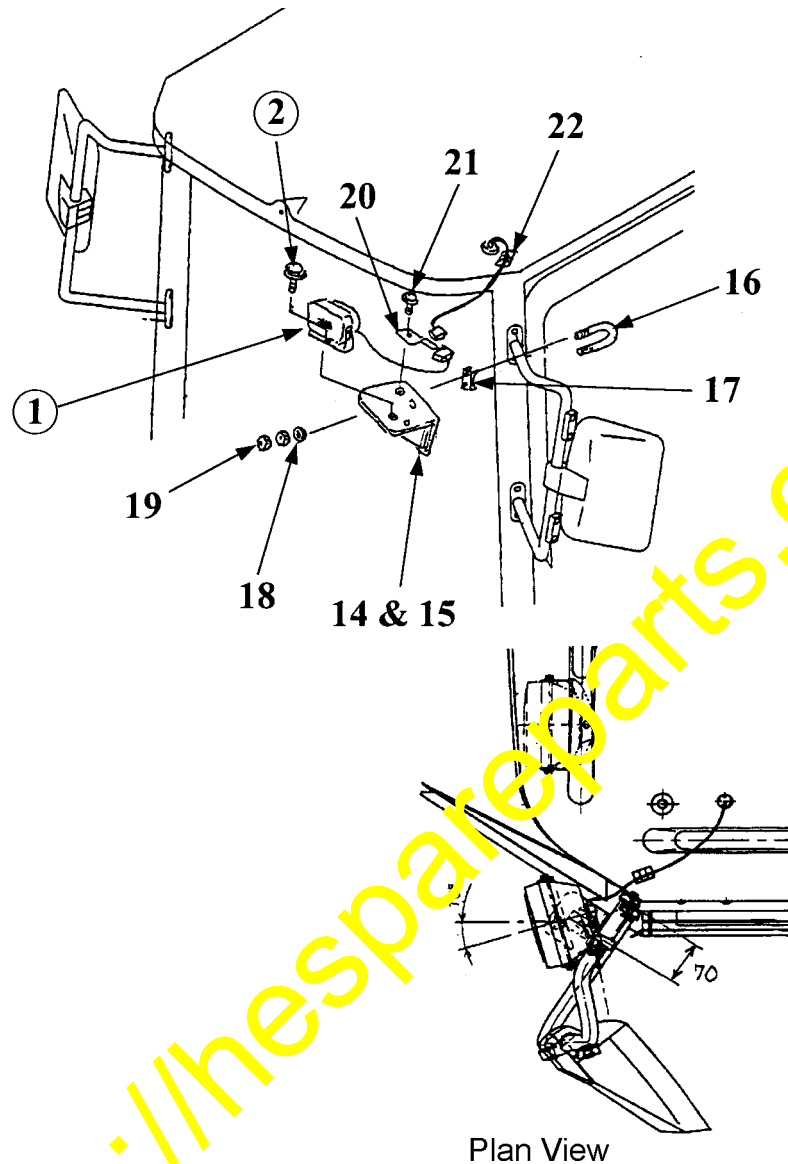

Figure 4 Worklamp Relocation

9. Using bolt (15) and seat (17), attach brackets (14,15) to the upper arm of the mirror stay with washers (18) and nuts (19).
10. Using bolt (2), install worklamp (1) on bracket and tighten to KES standards.
11. Using bolt (21) install clip (20) on bracket.
12. Connect wire harnesses and attach to clip (20).
13. Using clip (22), secure wire harness to cab.
14. As shown in the plan view, adjust worklamp away from windshield to avoid glare on the inside of the windshield.