

PARTS & SERVICE NEWS

REF NO.

AH03511

DATE

14th April 2003

Page 1 of 2

SUBJECT: Pilot Pressure Pump Part No. 907 209 40**PURPOSE:** Good flange connection between main pump and gear pump**APPLICATION:** PC5500**FAILURE CODE:** J100Z9**DESCRIPTION:**

1. Control all new pumps before installing.
2. If necessary remachine chamfer that the face of the gear pump fit very well to the main pump.
3. Install this new pump with surface sealing agent "Loctite 510" (Part No. 461 543 40).

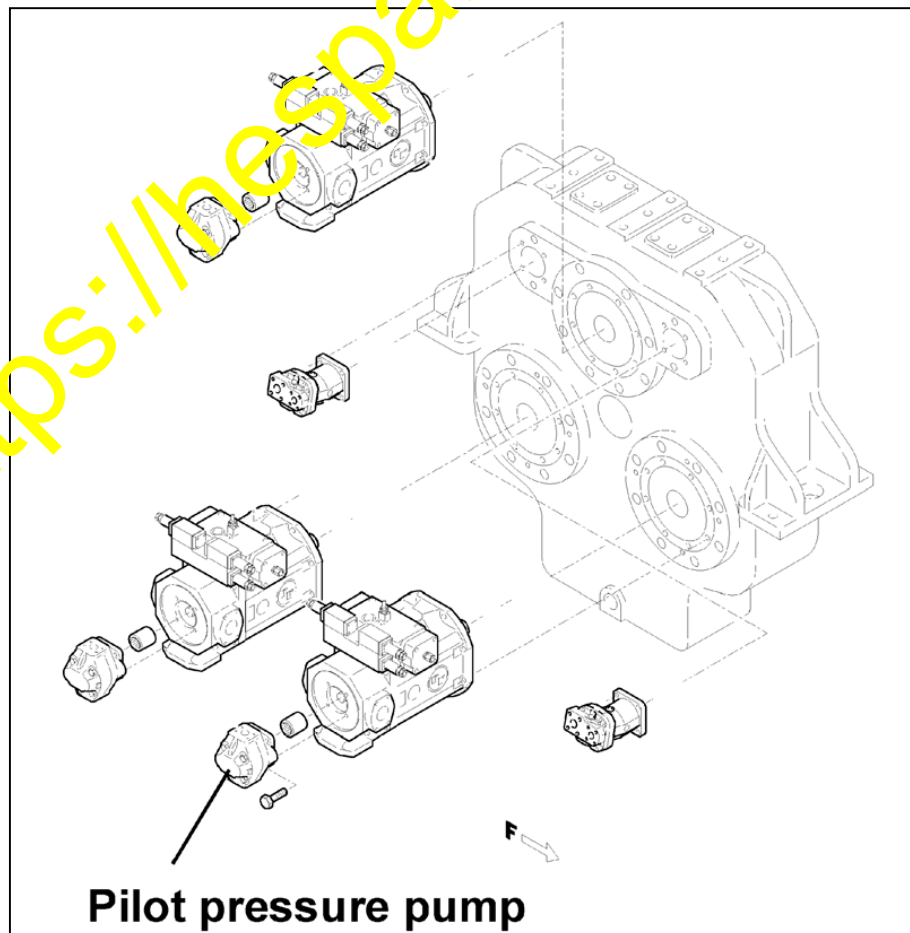

1.

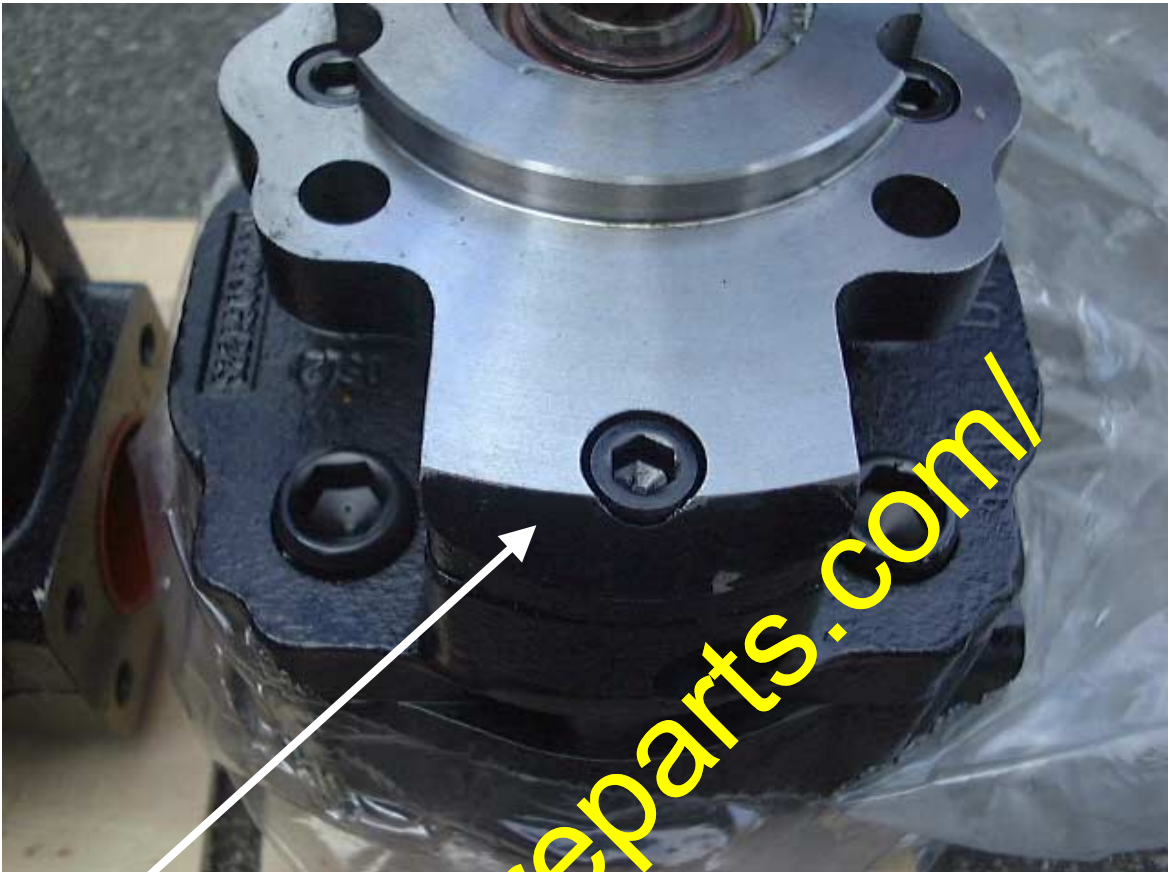

Remachine this chamfer

2.

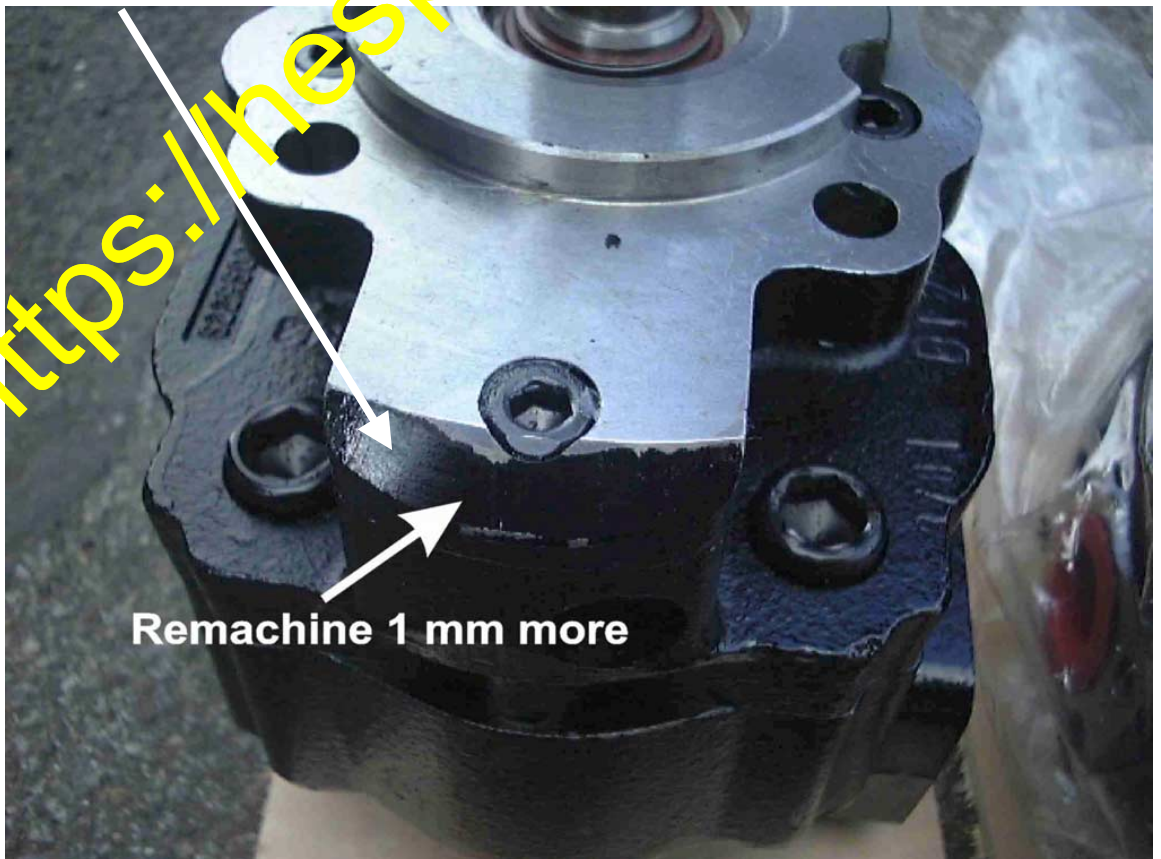

Remachine 1 mm more