

PARTS & SERVICE NEWS

REF NO.

AH04501

DATE

March 9, 2004

(C)

Page 1 of 23

This PARTS & SERVICE NEWS supersedes the previous issues 21-605; AH01536; AH02514; AH02542; AH03525a which should be discarded.

SUBJECT: Replacement of the swing gear
 (604 493 40; 655 205 40; 655 332 40; 768 670 73; 898 100 40;
 904 739 40; 917 915 40; 924 325 40)

PURPOSE: Old designs are not longer available

APPLICATION: H 255/PC3000 (06150 -); PC4000 (08151)
 H 455/PC5500 (15002 -); H 655SX (12030)
 PC8000 (12037 -)

FAILURE CODE: 261CFA

DESCRIPTION:

The following gearbox will be delivered as replacement for the gearboxes of the above mentioned excavators:

PN 926 795 40 - Type GFB 174 E 9021.

For initial replacement a special modification kit for the various models has to be added.

No	Model	Serial Number	Gear box (old) (Part Number)	Modification kit (Part Number)
1	H 255S	06150 - 06163; 06165	655 205 40	794 226 73
2	H 255 A	06166	655 205 40	794 227 73
3	H 255/PC3000	06174; 06167 - 06191	898 100 40	794 228 73
	H 255A/S	06176; 06183	768 670 73	794 228 73
4	PC3000	06192 - 06193	898 100 40	794 229 73
	PC3000	06194	917 915 40	794 236 73
	PC3000	06195 -	926 795 40	Latest version
	PC3000A	06196	924 325 40	794 236 73
5	PC4000	08151	898 100 40	794 231 73 r.h.
6	PC4000	08151	898 100 40	794 232 73 l.h.
	H 455	15002 + 15005	604 493 40	
7	H 455	15003	904 739 40	794 233 73 front
8	H 455	15004	655 205 40	794 234 73 rear
	H 455	15006	655 332 40	
9	H 455/PC5500	15007 - 15011	898 100 40	794 235 73
	PC5500	15012 - 15017	917 915 40	794 236 73
	PC5500	15018 -	926 795 40	Latest version
10	H 655SX	12030	898 100 40	794 237 73 rear
11	H 655SX	12030	898 100 40	794 230 73 front
12	PC8000	12037 - 12039	917 915 40	794 236 73
13	PC8000	12040	924 325 40	794 236 73
14	PC8000	12041 -	926 795 40	Latest version

Description

1. Remove the 8 bolts(7) M16x50mm at the hydraulic motor.
2. Remove the motor with connected hoses and place it beside or if this it not possible, disconnect the hydraulic lines and block the ports.
3. Disconnect the lubrication lines below the gearbox.
4. Remove all fastening bolts(8) M24 x 560mm from the gearbox.
5. Install 2 eye bolts M16 to lift the gearbox assy.
6. Remove the gearbox from the superstructure frame (weight about 2000kg).
7. Clean the flange area at the superstructure free of grease, oil, dust and paint.
8. Insert the new gearbox and mount it with the new bolts(8) M24 (1020 Nm) and the washers to the superstructure (PC3000 #06192/93 the ring item 33 of modification kit has to be fitted before).
9. Cover the bolt heads with plugs.
10. Swap the drain valves and the breather filters from the old to the new gearbox.
11. Remove the cover (9) below the gearbox and connect the lubrication lines (10). Reinstall the cover(9) with 7 bolts(11).
12. Make the oil inlet(2) for the gearbox (only at H 455, PC5500, PC8000). Parts included in the Modification Kit.
13. Install the motor with the 8 bolts(7) M16x50 (265 Nm).
14. Reconnect all hydraulic lines.
15. Fill in oil to the max. oil level markings:
Gearbox (2) – about 40 l
Motor chamber (5) – about 0.6 l
Oil specification according to Lubrication Manual of the excavator.
Correct the oil quantity values in the Lubrication Manual.
16. Install the cover plates(12) (H 255; PC3000; PC4000).

- **H 255/PC3000:**

At some types of excavators the hydraulic lines have to be removed (refer to Illustration 1).

At some types the hydraulic lines have to be relocated (refer to Illustration 10).

- **The new gear box PN 926 795 40 - Type GFB 174 E 9021 will be delivered without Dipstick.**

The respective modification kit includes the new dipstick including the necessary accessories (refer to Illustration 9).

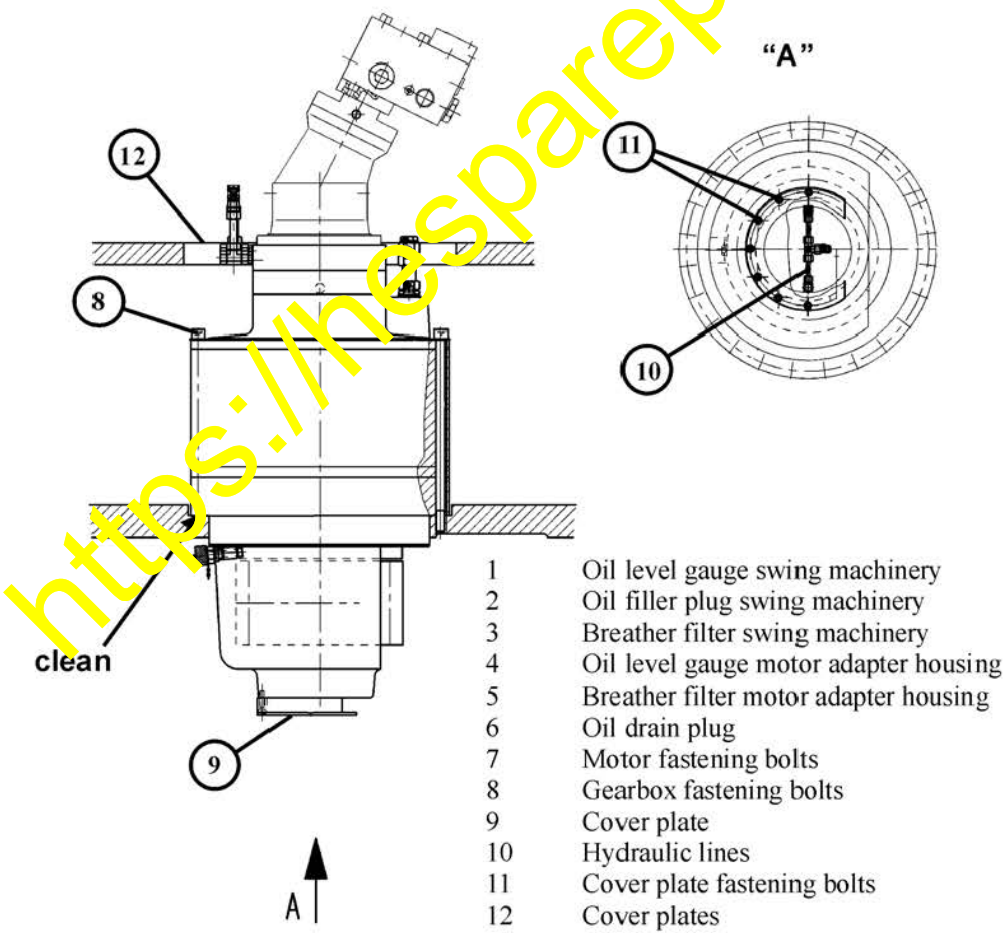
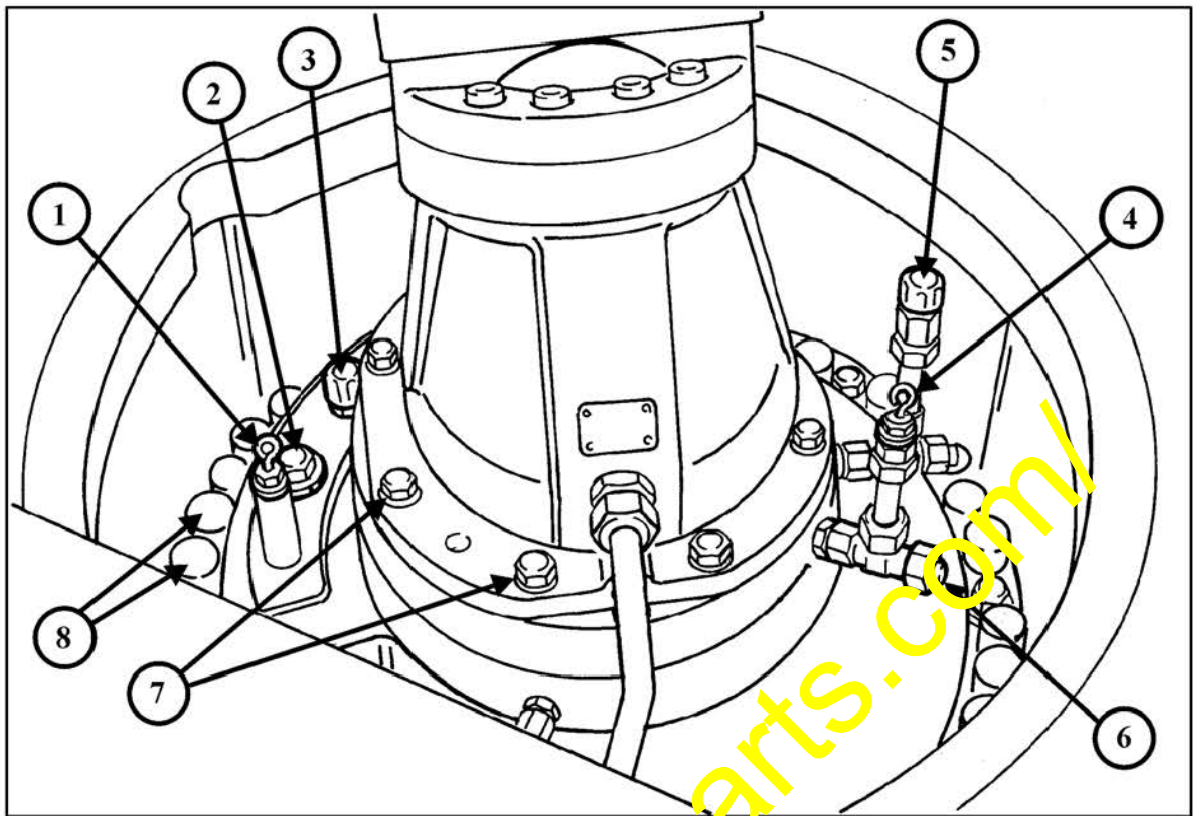

1. H 255S (06150 – 06163; 06165)

Old gear box: PN 655 205 40

Replacement: new gear box PN 926 795 40 and modification kit 794 226 73

Modification kit PN 794 226 73

Illustration	Figure	Description	Part – No.	Quantity
1 (Page 8)	2	Pipe	768 513 73	1
	3	Pipe	768 514 73	1
	4	Hose	515 484 98	1
2 (Page 8)	22	Union	372 956 99	1
	23	Union	372 399 99	1
	24	Pipe socket	635 586 40	2
	25	Collet	635 588 40	2
	26	Cover	921 815 99	1
	27	Bolt	319 159 99	7
	28	Washer	504 149 98	7
	30	Hose	635 584 40	300 mm
	33	Bolt (12.9)	517 013 98	24
	34	Washer	516 920 98	24
	35	Union	517 073 98	2
	36	Union nut	371 273 99	2
	37	Olive	906 346 40	4
	38	Pipe 10x2	215 627 99	400 mm
	39	Union nut	371 258 99	2
40	Union	517 074 98	1	
60	Plug	907 142 40	24	
9 (Page 22)	50	Socket	517 489 98	1
	51	Union	517 490 98	1
	52	Olive	906 868 40	1
	53	Union nut	371 264 99	1
	54	Pipe	925 833 40	1
	55	Dipstick	907 568 40	1
10 (Pages 9; 10)	1	Weld on plate	921 281 40	2
	2	Plate	534 009 99	4
	3	Half clamp	502 371 98	4
	4	Grommet	502 626 98	4
	5	Bolt	308 599 99	8

2. H 255A (06166)

Old gear box: PN 655 205 40

Replacement: new gear box PN 926 795 40 and modification kit 794 227 73

Modification kit PN 794 227 73

Illustration	Figure	Description	Part – No.	Quantity
1 (Page 8)	2	Pipe	768 630 73	1
	3	Pipe	768 631 73	1
	4	Hose	515 484 98	1
2 (Page 8)	22	Union	372 956 99	1
	23	Union	372 399 99	1
	24	Pipe socket	635 586 40	2
	25	Collet	635 588 40	2
	26	Cover	921 815 99	1
	27	Bolt	319 159 99	7
	28	Washer	504 149 98	7
	30	Hose	635 584 40	300 mm
	33	Bolt (12.9)	517 013 98	24
	34	Washer	516 920 98	24
	35	Union	517 073 98	2
	36	Union nut	371 273 99	2
	37	Olive	906 346 40	4
	38	Pipe 10x2	215 627 99	400 mm
	39	Union nut	371 258 99	2
40	Union	517 074 98	1	
60	Plug	907 142 40	24	
9 (Page 22)	50	Socket	517 489 98	1
	51	Union	517 490 98	1
	52	Olive	906 868 40	1
	53	Union nut	371 264 99	1
	54	Pipe	925 833 40	1
	55	Dipstick	907 568 40	1
10 (Pages 9; 10)	1	Weld on plate	921 281 40	2
	2	Plate	534 009 99	4
	3	Half clamp	502 371 98	4
	4	Grommet	502 626 98	4
	5	Bolt	308 599 99	8

3. H 255S/PC3000 (06164; 06167 – 06191)

Old gear box: PN 898 100 40

Replacement: new gear box PN 926 795 40 and modification kit 794 228 73

Modification kit PN 794 228 73

Illustration	Figure	Description	Part – No.	Quantity
2 (Page 8)	22	Union	372 956 99	1
	23	Union	372 399 99	1
	24	Pipe socket	635 586 40	2
	25	Collet	635 588 40	2
	26	Cover	921 815 99	1
	27	Bolt	319 159 99	7
	28	Washer	504 149 98	7
	30	Hose	635 584 40	300 mm
	33	Bolt (12.9)	517 013 98	24
	34	Washer	516 920 98	24
	35	Union	517 073 98	2
	36	Union nut	371 273 99	2
	37	Olive	906 346 40	4
	38	Pipe 10x2	215 627 99	400 mm
	39	Union nut	371 258 99	2
	40	Union	517 074 98	1
60	Plug	907 142 40	24	
9 (Page 22)	50	Socket	517 489 98	1
	51	Union	517 490 98	1
	52	Olive	906 868 40	1
	53	Union nut	371 264 99	1
	54	Pipe	925 833 40	1
	55	Dipstick	907 568 40	1
10 (Pages 9; 10)	1	Weld on plate	921 281 40	2
	2	Plate	534 009 99	4
	3	Half clamp	502 371 98	4
	4	Grommet	502 626 98	4
	5	Bolt	308 599 99	8

4. PC3000 (06192 – 06193)

Old gear box: PN 898 100 40

Replacement: new gear box PN 926 795 40 and modification kit 794 229 73

Modification kit PN 794 229 73

Illustration	Figure	Description	Part – No.	Quantity
2 (Page 8)	22	Union	372 956 99	1
	23	Union	372 399 99	1
	24	Pipe socket	635 586 40	2
	25	Collet	635 588 40	2
	26	Cover	921 815 40	1
	27	Bolt	319 159 99	7
	28	Washer	504 149 98	7
	30	Hose	635 584 40	300 mm
	33	Bolt (12.9; 1030Nm)	517 011 98	24
	34	Washer	516 921 98	24
	35	Union	517 073 98	2
	36	Union nut	371 273 99	2
	37	Olive	906 346 40	4
	38	Pipe 10x2	215 627 99	400 mm
	39	Union nut	371 258 99	2
	40	Union	517 074 98	1
	60	Plug	907 142 40	24
9 (Page 22)	50	Socket	517 489 98	1
	51	Union	517 490 98	1
	52	Olive	906 868 40	1
	53	Union nut	371 264 99	1
	54	Pipe	925 833 40	1
	55	Dipstick	907 568 40	1
10 (Pages 9; 10)	1	Weld on plate	921 281 40	2
	2	Plate	534 009 99	4
	3	Half clamp	502 371 98	4
	4	Grommet	502 626 98	4
	5	Bolt	308 599 99	8

Illustration 1

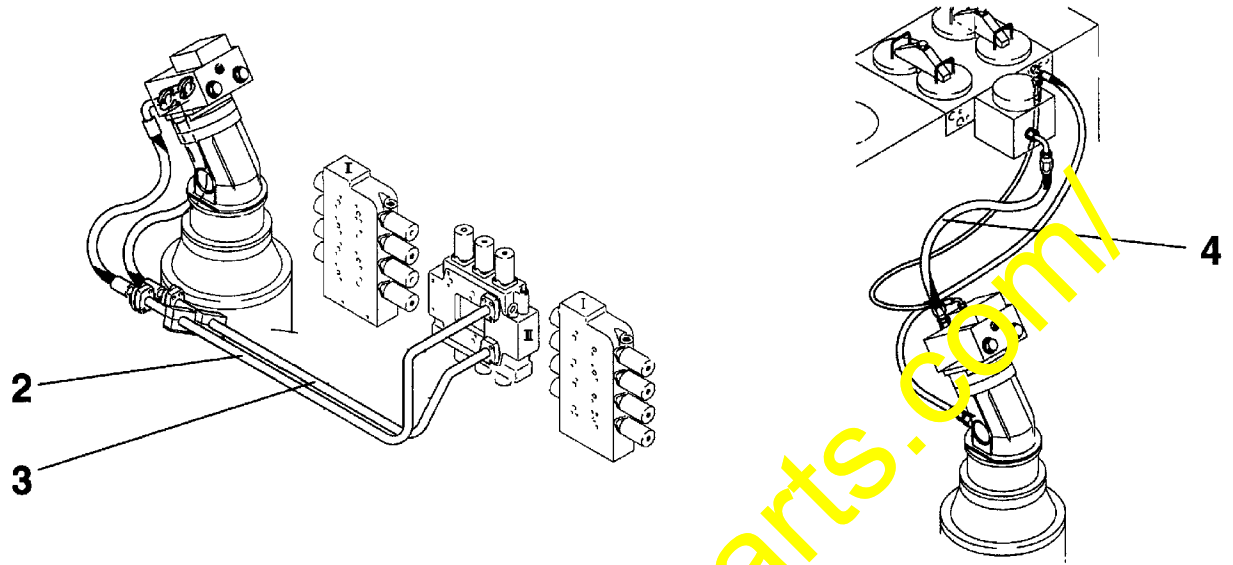

Illustration 2

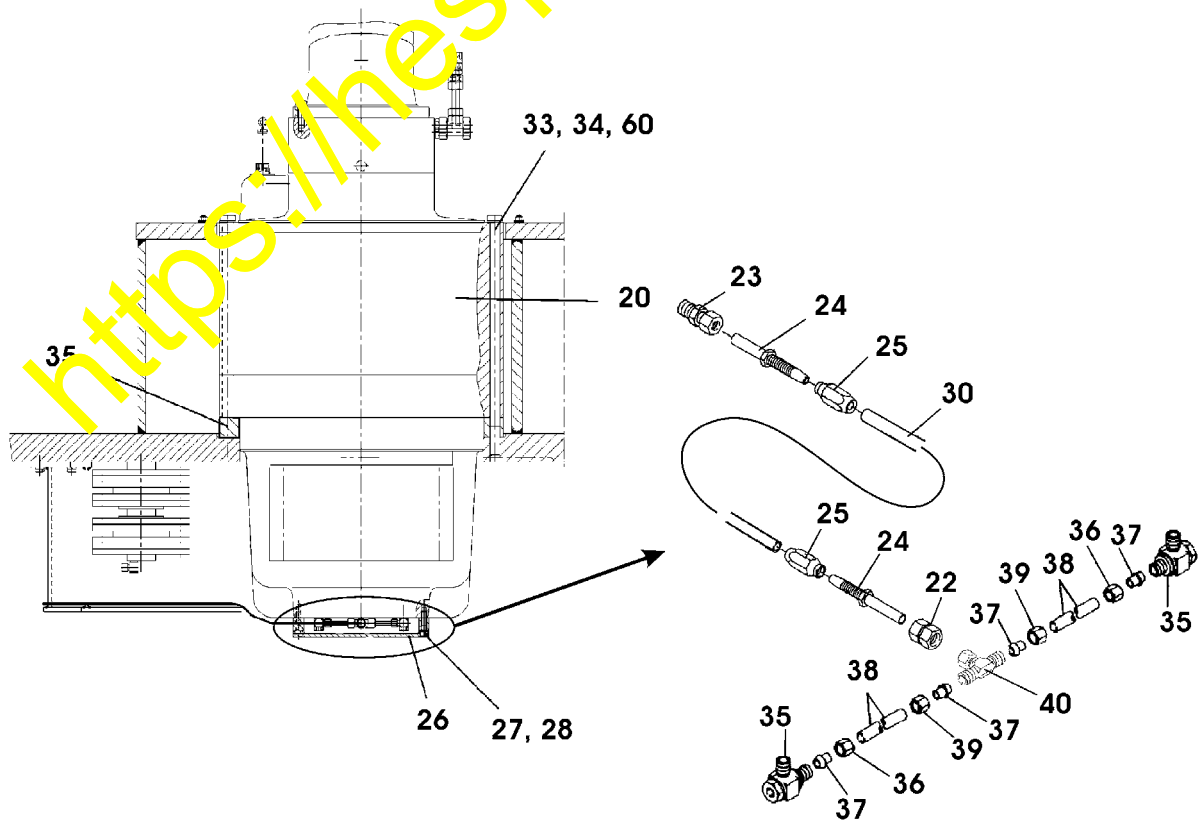

Illustration 10

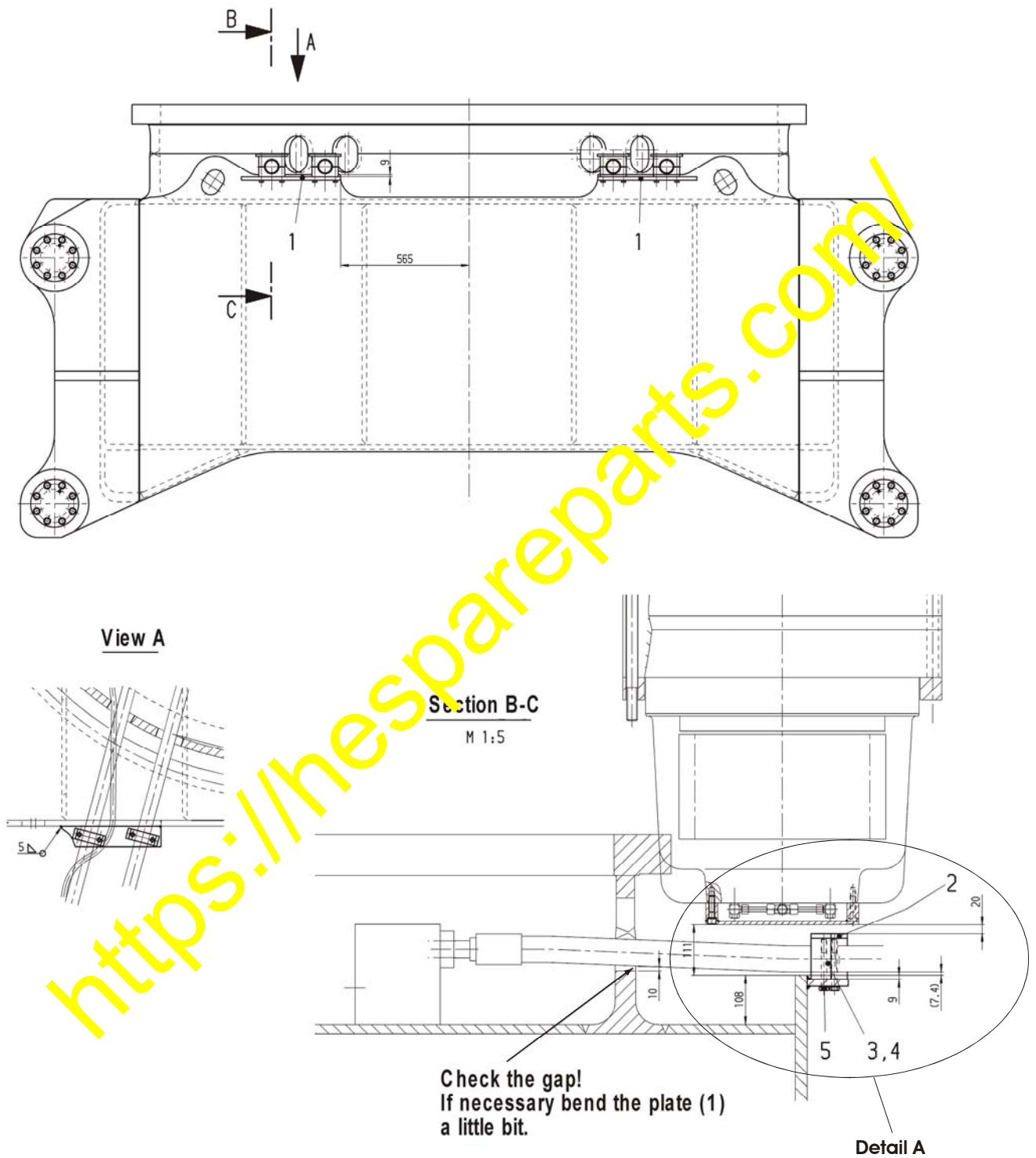
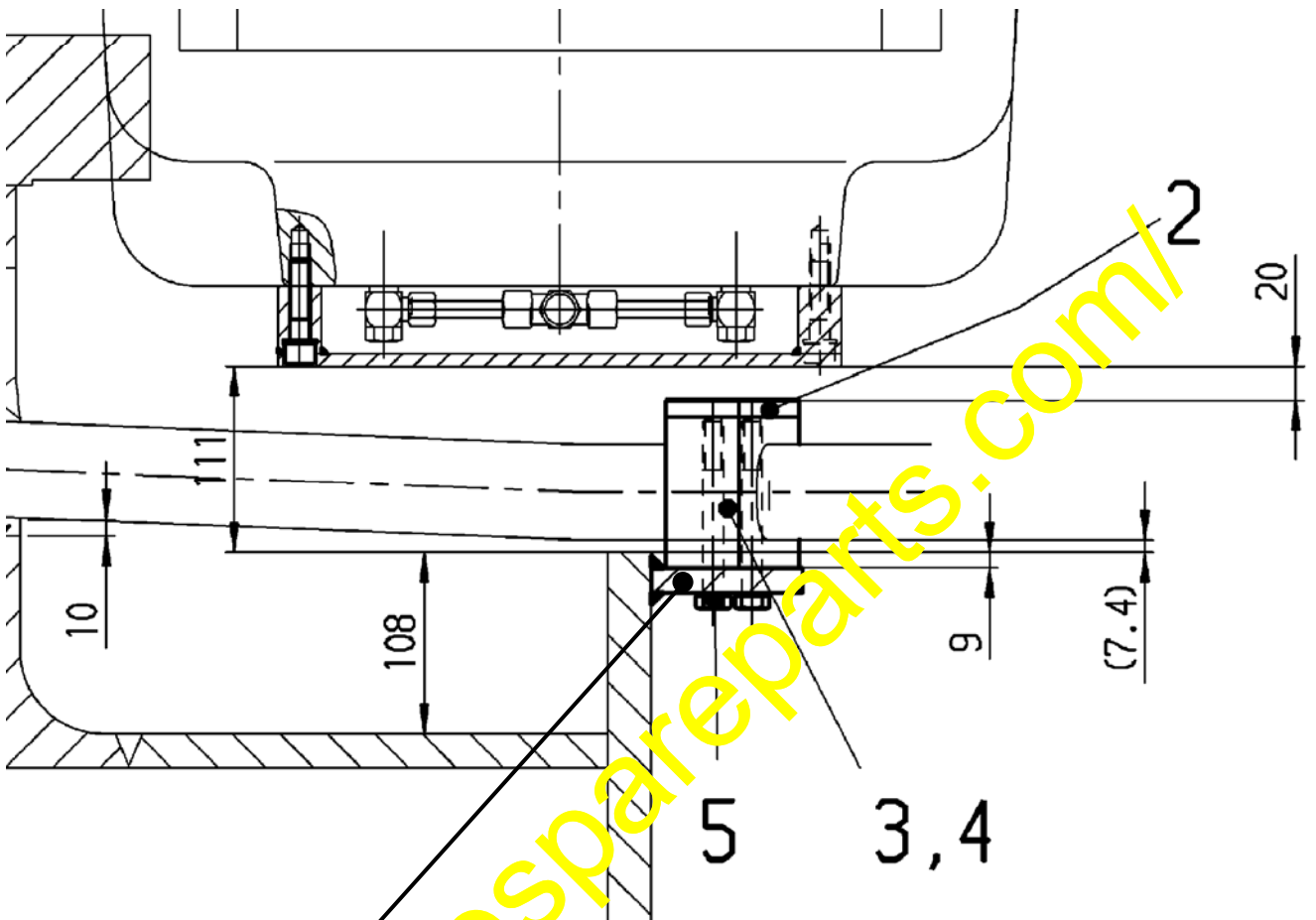

Illustration 10 - Detail A



5. PC4000 (08151) right hand gear box

Old gear box: PN 898 100 40

Replacement: new gear box PN 926 795 40 and modification kit 794 231 73

Modification kit PN 794 231 73

Illustration	Figure	Description	Part – No.	Quantity
3 (Page 13)	4	Nut	507 037 98	10
	5	Washer	340 465 99	10
	6	Washer	506 129 98	10
	8	Plate front	922 586 40	1
	9	Plate rear	922 587 40	1
	10	Bolt	516 919 98	24
	11	Washer	316 213 99	24
	12	Plug	907 142 40	24
	13	Cover	921 815 40	1
	14	Bolt	319 159 99	7
	15	Union	517 073 98	2
	16	Union nut	371 273 99	2
	17	Olive	906 346 40	2
	18	Pipe	215 627 99	0.4 m
	19	Union	517 074 98	1
	20	Union nut	371 258 99	2
	21	Olive	906 346 40	2
	22	Union	907 228 40	1
	23	Union nut	371 257 99	1
	24	Olive	907 080 40	1
	26	Pinion cover	922 578 40	1
	27	Socket	517 489 98	1
	28	Union	517 490 98	1
	29	Olive	906 868 40	1
	30	Union nut	371 264 99	1
	31	Pipe	925 833 40	1
	32	Dipstick	907 568 40	1

6. PC4000 (08151) left hand gear box

Old gear box: PN 898 100 40

Replacement: new gear box PN 926 795 40 and modification kit 794 232 73

Modification kit PN 794 232 73

Illustration	Figure	Description	Part – No.	Quantity
3 (Page 13)	2	Plate rear	92258440	1
	3	Plate front	92258340	1
	4	Nut	50703798	10
	5	Washer	34046599	10
	6	Washer	50612998	10
	7	Bolt	507 488 98	10
	10	Bolt	51691998	24
	11	Washer	31621399	24
	12	Plug	907142 40	24
	13	Cover	921615 40	1
	14	Bolt	519 5999	7
	15	Union	51707398	2
	16	Union nut	37127399	2
	17	Olive	90634640	2
	18	Pipe	21562799	0.4 m
	19	Union	51707498	1
	20	Union nut	37125899	2
	21	Olive	90722740	2
	22	Union	90722840	1
	23	Union nut	37125799	1
	24	Olive	90708040	1
	25	Pinion cover	92258040	1
	27	Socket	517 489 98	1
	28	Union	517 490 98	1
	29	Olive	906 868 40	1
	30	Union nut	371 264 99	1
	31	Pipe	925 833 40	1
	32	Dipstick	907 568 40	1

Illustration 3

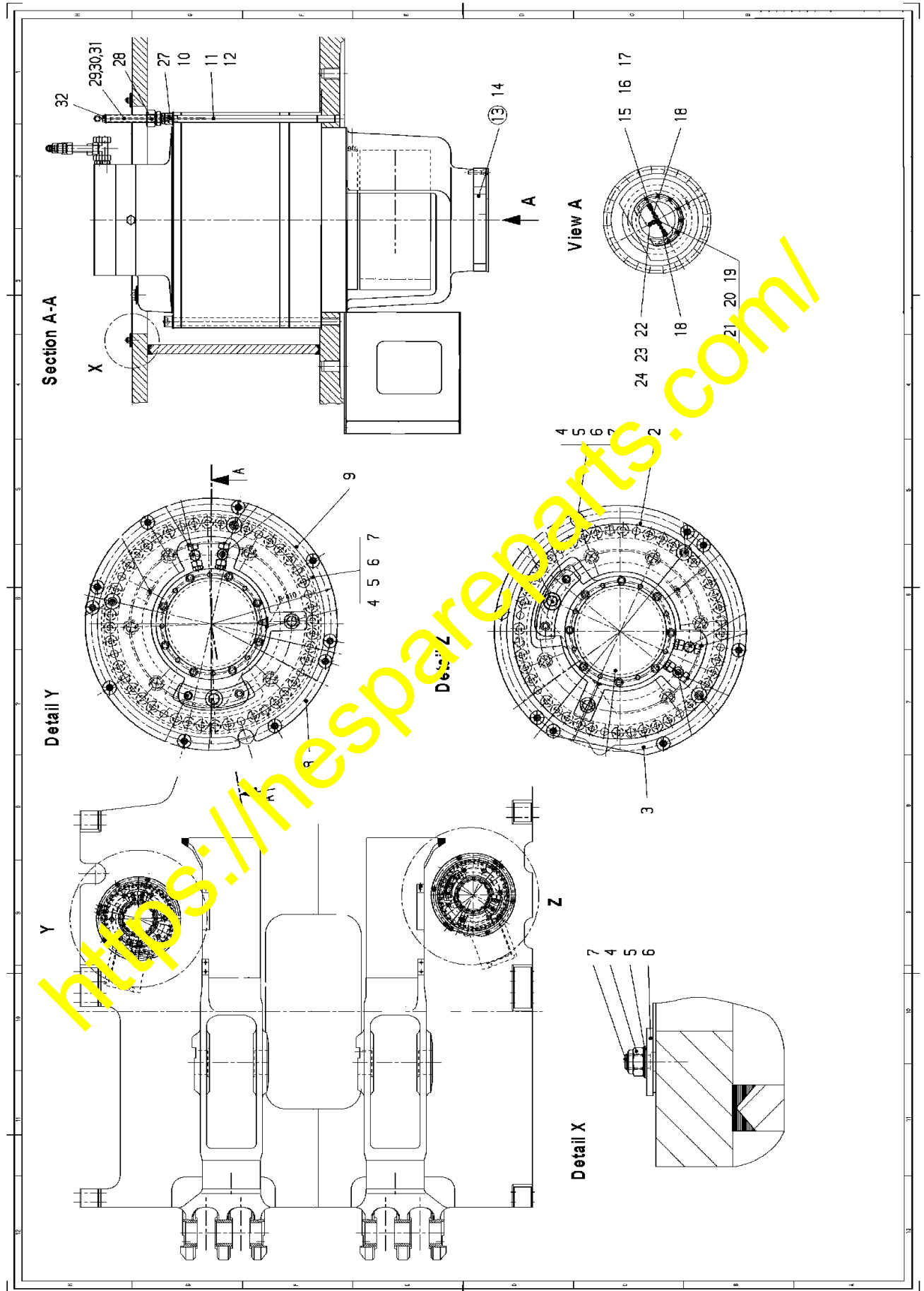

7. H 455 (15002 – 15006) front gear

Old gear boxes: PN 604 493 40; 655 205 40; 655 332 40; 904 739 40

Replacement: new gear box PN 926 795 40 and modification kit 794 233 73

Modification kit PN 794 233 73

Illustration	Figure	Description	Part – No.	Quantity
5 (Page 15)	1	Hose 40x1200	331 513 40	2
	2	Hose 40x850	515 718 98	1
	3	Socket	374 415 99	1
	4	Union	371 959 99	1
	5	Quadring	356 209 40	4
	6	Screw	319 288 99	16
	9	Plug	173 495 40	1
6 (Page 16)	2	Bleeder valve	323 460 99	2
	4	Cover	921 815 40	1
	5	Union	907 131 40	1
	6	Pipe 85 mm	914 755 40	1
	7	Socket	374 460 99	1
	9	Union Nut	371 279 99	2
	10	Olive	906 979 40	2
	11	Washer	516 920 98	24
	12	Bolt	516 919 98	24
	13	Plug	907 142 40	24
	14	Union	907 228 40	1
	15	Union	517 074 98	1
	16	Union Nut	371 258 99	2
	17	Olive	906 346 40	2
	18	Union	517 073 98	2
	19	Union Nut	371 273 99	2
	20	Union Nut	906 346 40	2
	21	Pipe	215 627 99	0.2 m
	22	Bolt	319 159 99	7
	23	Washer	504 149 98	7
	24	Socket	517 489 98	1
	25	Union	517 490 98	1
	26	Olive	906 868 40	1
	27	Union Nut	371 264 99	1
	28	Pipe	925 830 40	1
	29	Dipstick	907 569 40	1

Illustration 5

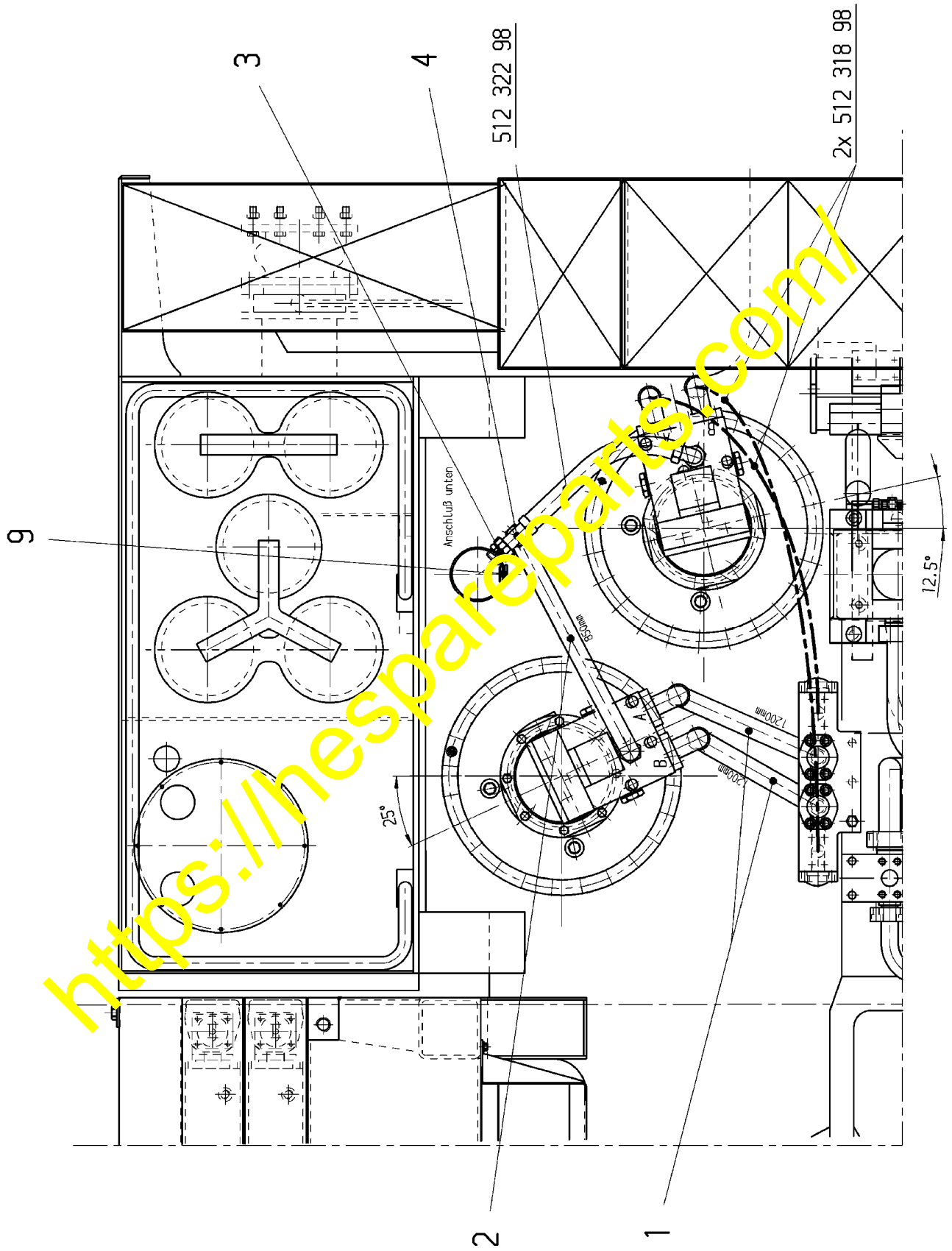
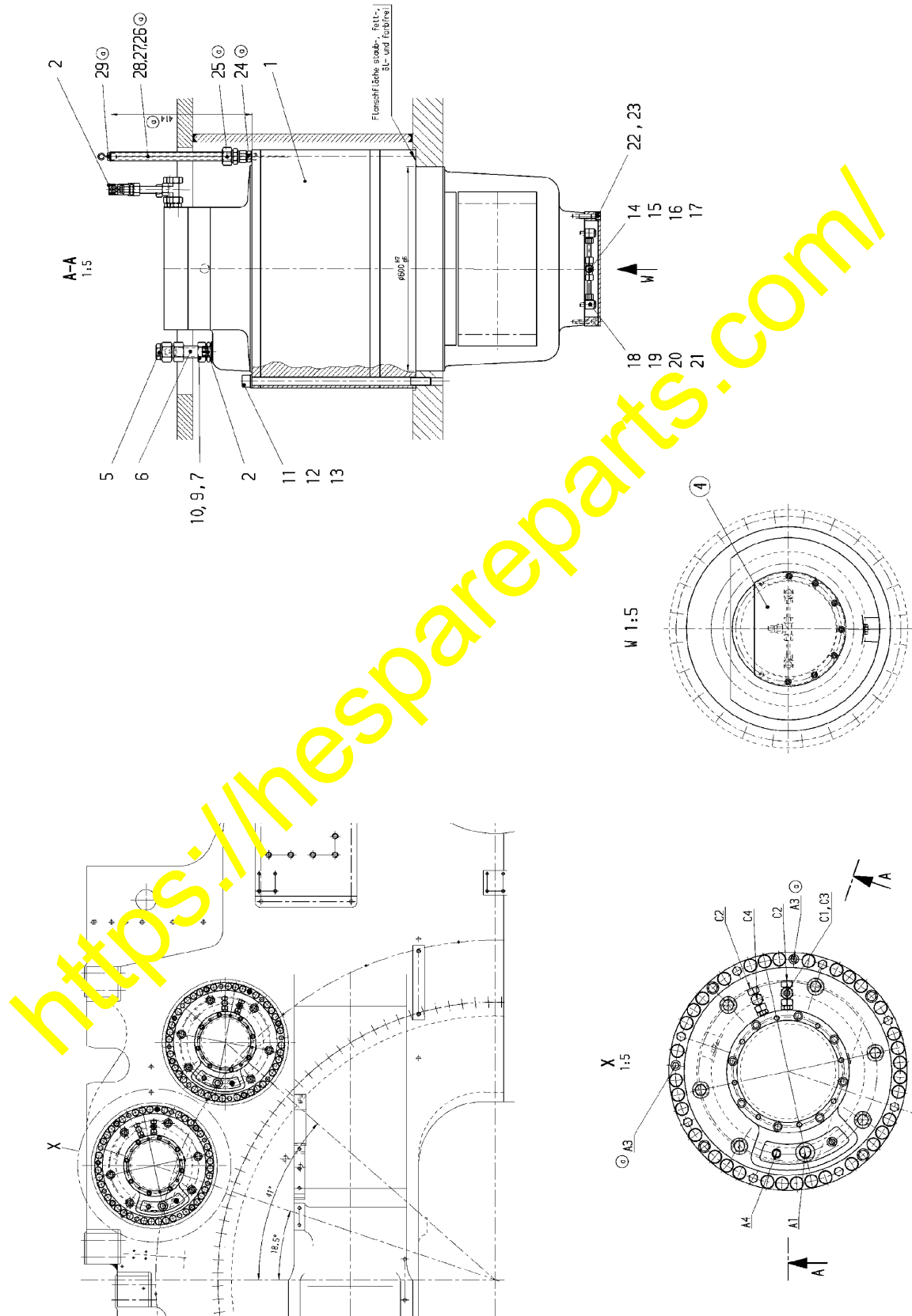

Illustration 6



8. H 455 (15002 - 15006) rear gear

Old gear box: PN 604 493 40; 655 205 40; 655 332 40; 904 739 40

Replacement: new gear box PN 926 795 40 and modification kit 794 234 73

Modification kit PN 794 234 73

Illustration	Figure	Description	Part – No.	Quantity
7 (Page 18)	1	Hose 40x1700	368 297 40	1
	2	Hose 40x2100	512 318 98	1
	3	Hose 40x760	512 312 98	1
	4	Socket	374 415 99	1
	5	Union	371 959 99	1
	6	Union	372 178 99	1
	7	Quadring	356 209 40	4
	8	Screw	319 288 99	16
	11	Plug	173 495 40	1
6 (Page 16)	2	Bleeder valve	323 460 40	2
	4	Cover	921 513 40	1
	5	Union	907 197 40	1
	6	Pipe 85 mm	914 736 40	1
	7	Socket	374 460 99	1
	9	Union Nut	371 279 99	2
	10	Olive	906 979 40	2
	11	Washer	516 920 98	24
	12	Bolt	516 919 98	24
	13	Plug	907 142 40	24
	14	Union	907 228 40	1
	15	Union	517 074 98	1
	16	Union Nut	371 258 99	2
	17	Olive	906 346 40	2
	18	Union	517 073 98	2
	19	Union Nut	371 273 99	2
	20	Union Nut	906 346 40	2
	21	Pipe	215 627 99	0.2 m
	22	Bolt	319 159 99	7
	23	Washer	504 149 98	7
	24	Socket	517 489 98	1
	25	Union	517 490 98	1
	26	Olive	906 868 40	1
	27	Union Nut	371 264 99	1
	28	Pipe	925 830 40	1
	29	Dipstick	907 569 40	1

Illustration 7

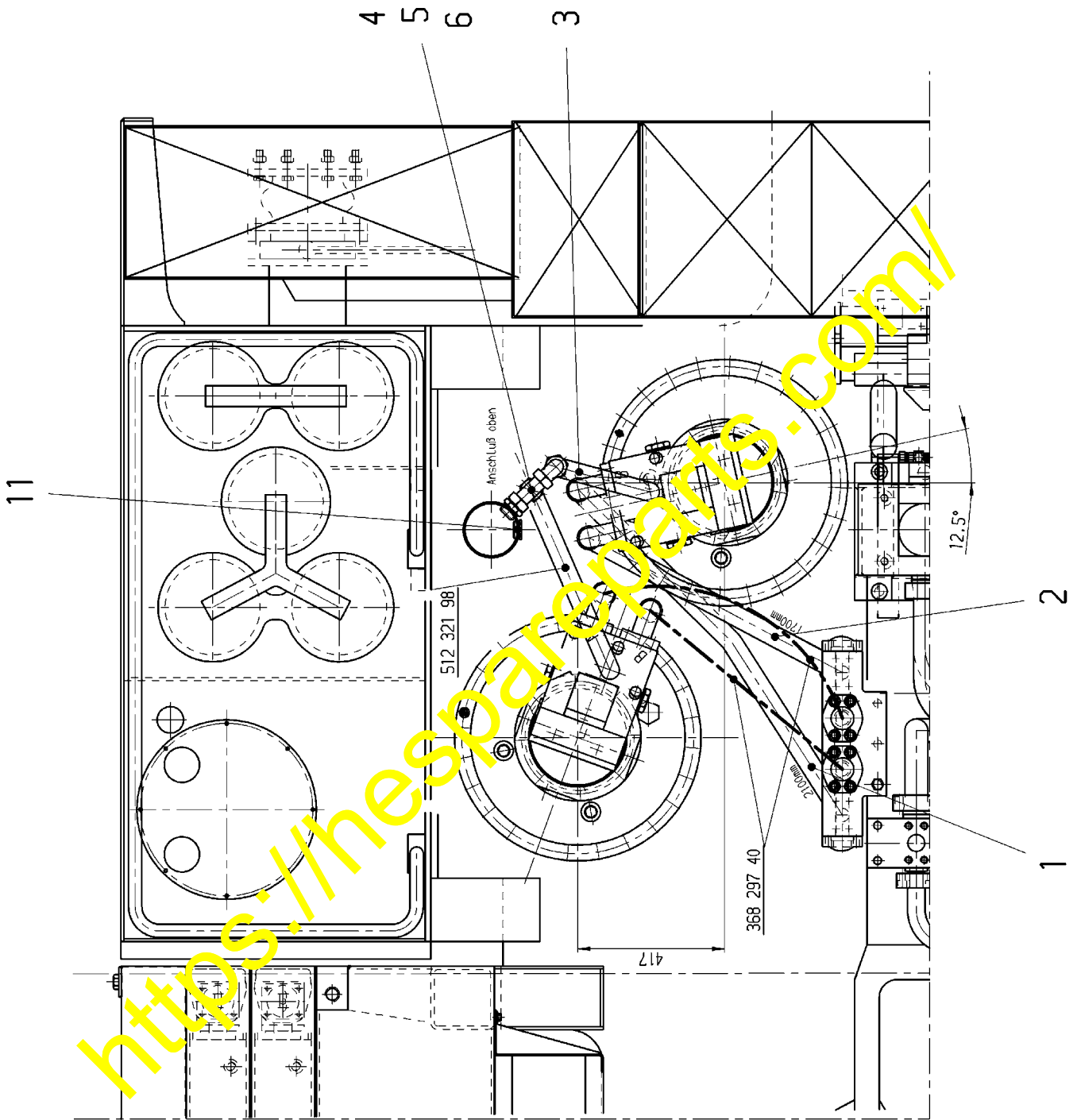

9. H 455 / PC5000 (15007 - 15011)

Old gear box: PN 898 100 40

Replacement: new gear box PN 926 795 40 and modification kit 794 235 73

Modification kit PN 794 235 73

Illustration	Figure	Description	Part – No.	Quantity
6 (Page 16)	2	Bleeder valve	323 460 40	2
	4	Cover	921 815 40	1
	5	Union	907 131 40	1
	6	Pipe 85 mm	914 736 40	1
	7	Socket	374 460 99	1
	9	Union Nut	371 279 99	2
	10	Olive	906 979 40	2
	11	Washer	516 920 98	24
	12	Bolt	516 919 98	24
	13	Plug	907 142 40	24
	14	Union	907 221 40	1
	15	Union	517 077 98	1
	16	Union Nut	371 258 99	2
	17	Olive	906 346 40	2
	18	Union	517 073 98	2
	19	Union Nut	371 273 99	2
	20	Union Nut	906 346 40	2
	21	Pipe	215 627 99	0.2 m
	22	Bolt	319 159 99	7
	23	Washer	504 149 98	7
	24	Socket	517 489 98	1
	25	Union	517 490 98	1
	26	Olive	906 868 40	1
	27	Union Nut	371 264 99	1
	28	Pipe	925 830 40	1
	29	Dipstick	907 569 40	1

10. H 655SX (12030) rear

Old gear box: PN 898 100 40

Replacement: new gear box PN 926 795 40 and modification kit 794 237 73

Modification kit PN 794 237 73 (rear)

Illustration	Figure	Description	Part – No.	Quantity
8 (Page 21)	2	Bolt	516 919 98	24
	3	Washer	516 920 98	24
	4	Cover	921 815 40	1
	5	Bolt	319 159 99	7
	6	Socket	374 460 99	1
	7	Union nut	371 279 99	2
	8	Olive	906 979 40	2
	9	Pipe 85 mm	914 736 40	1
	10	Union	907 131 40	1
	11	Union	517 073 98	2
	12	Union nut	371 273 99	2
	13	Union nut	906 346 40	2
	14	Pipe	215 627 99	0.6 m
	15	Union	374 471 99	1
	16	Union nut	371 273 99	2
	17	Olive	906 346 40	2
	9 (Page 22)	21	Plug	907 142 40
		Socket	516 156 98	2
50		Socket	517 489 98	1
51		Union	517 490 98	1
52		Olive	906 868 40	1
53		Union nut	371 264 99	1
	54	Pipe	925 830 40	1
	55	Dipstick	907 569 40	1

11. H655SX (12030) front

Modification kit PN 794 230 73 (front):

Modification kit PN 794 237 73 + cover plate PN 914 737 40

Illustration 8

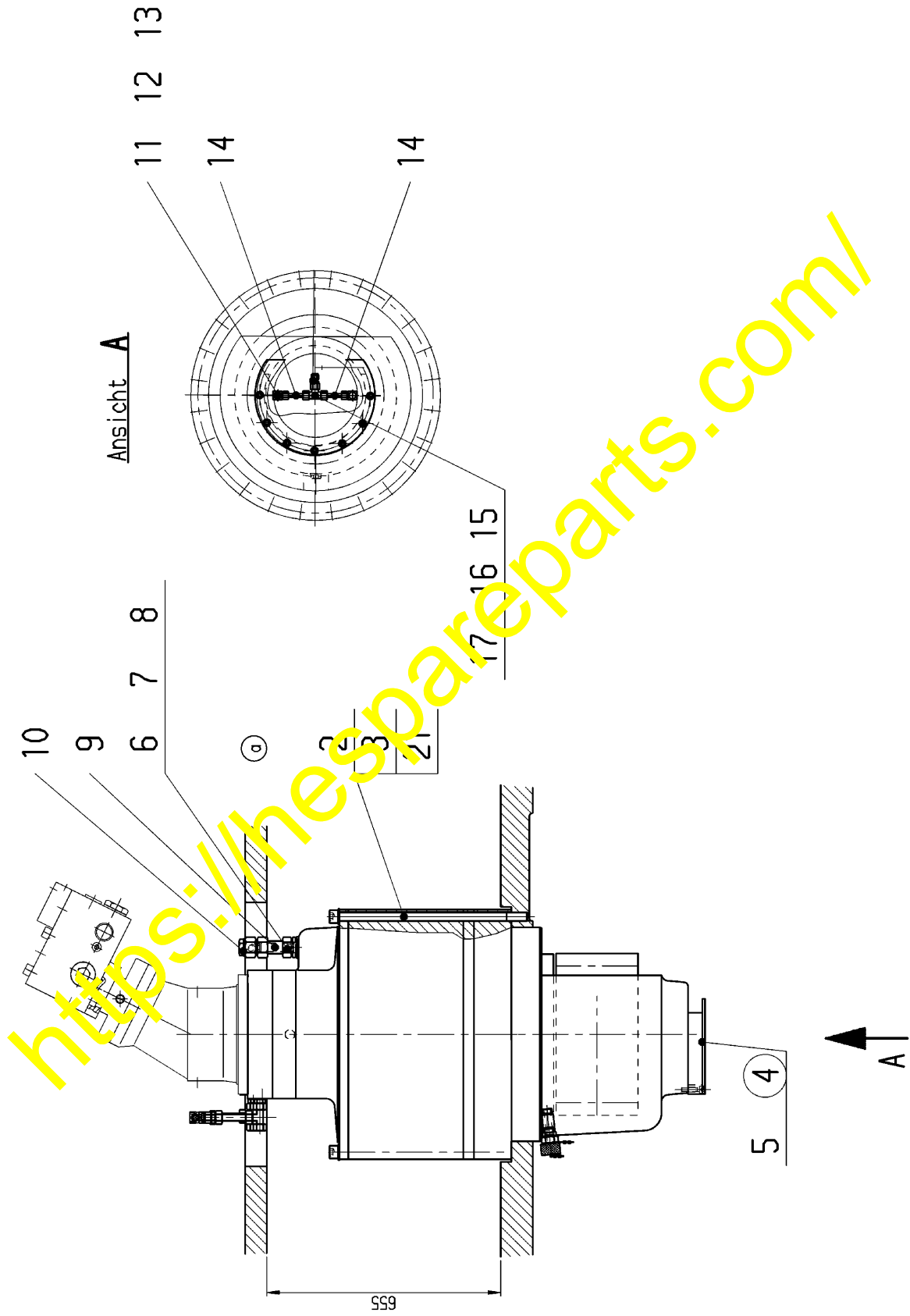
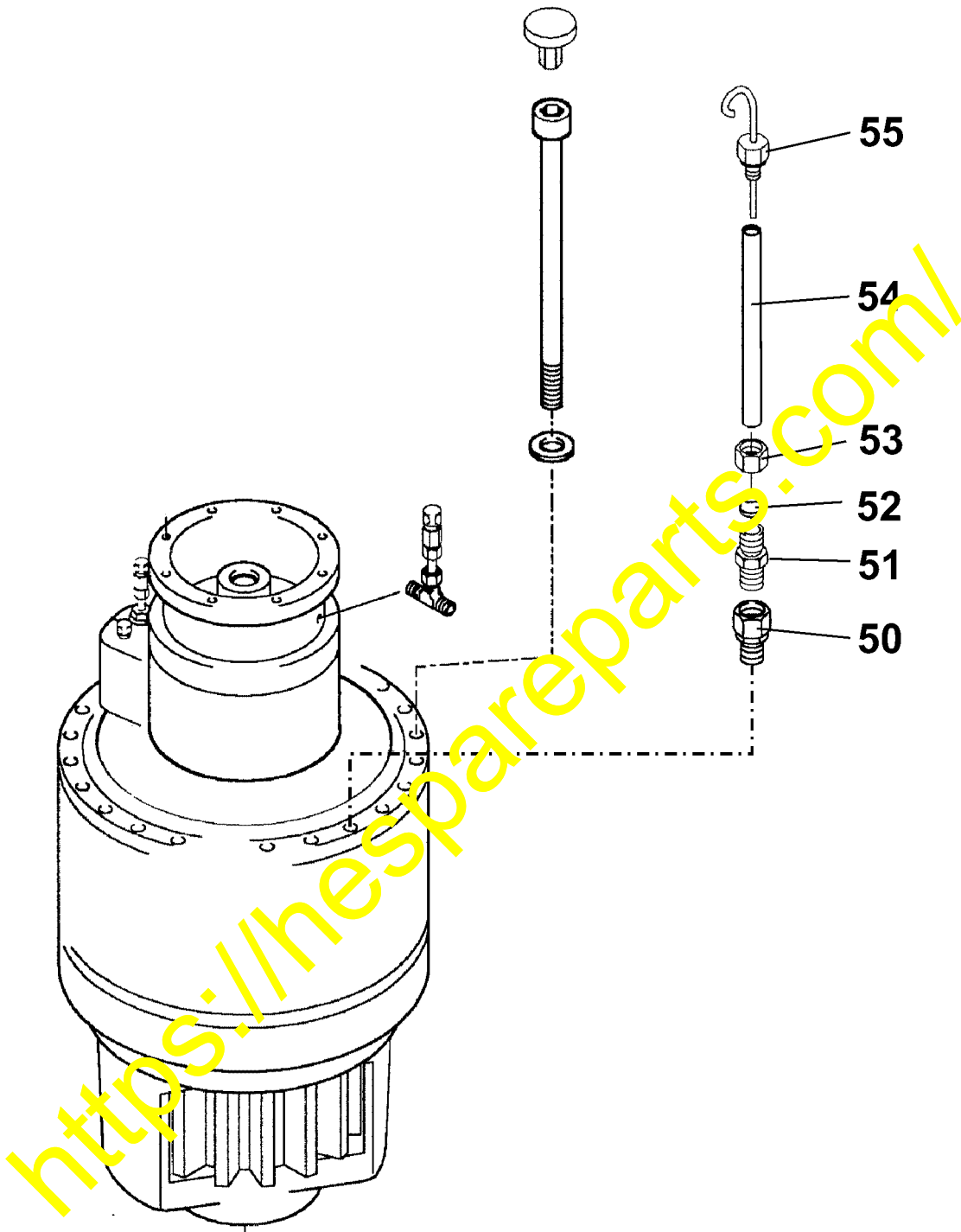

Illustration 9



Modification kit 794 236 73

9 (Page 22)	50	Socket	517 489 98	1
	51	Union	517 490 98	1
	52	Olive	906 868 40	1
	53	Union nut	371 264 99	1
	54	Pipe	925 830 40	1
	55	Dipstick	907 569 40	1

<https://hespareparts.com/>