

**PARTS & SERVICE
NEWS**

REF NO.	AT00080
DATE	Jun. 13, 2000
(C)	Page 1 of 6

SUBJECT: INTRODUCTION OF DUST-PROOF BODY SEAT SWITCH FOR HD325/405-6, 465/605/785/985-5

PURPOSE: To introduce a new body seating switch (body seating detecting switch) with increased dust-proofing capacity for use on HD325-6 and other dump trucks

APPLICATION: HD325-6 Dump Trucks, Serial Nos. 5680 thru 5941
 HD405-6 Dump Trucks, Serial Nos. 1055 thru 1156
 HD465-5 Dump Trucks, Serial Nos. 4626 thru 4831
 HD605-5 Dump Trucks, Serial Nos. 1013 thru 1116
 HD785-5 Dump Trucks, Serial Nos. 4001 thru 4151
 HD985-5 Dump Trucks, Serial Nos. 1021 thru 1049

FAILURE CODE: DDY450

DESCRIPTION:

1. Introduction

This Service News will introduce a new dump body seating switch with increased dust-proofing capacity for use on HD325-6, HD405-6, HD465-5, HD605-5, HD785-5 and HD985-5 dump trucks.

2. List of parts

Part No.	Part Name	Q'ty	Remarks
566-06-6A420 (566-06-6A410)	Switch (Switch)	1 (1)	

3. Contents of the modification

3-1. Difference between the standard switch and dust-proof switch

With the dust-proof type, a rubber boot is being installed to the plunger section of the switch body to prevent entry of sand and dust. (Refer to Fig. 1.)

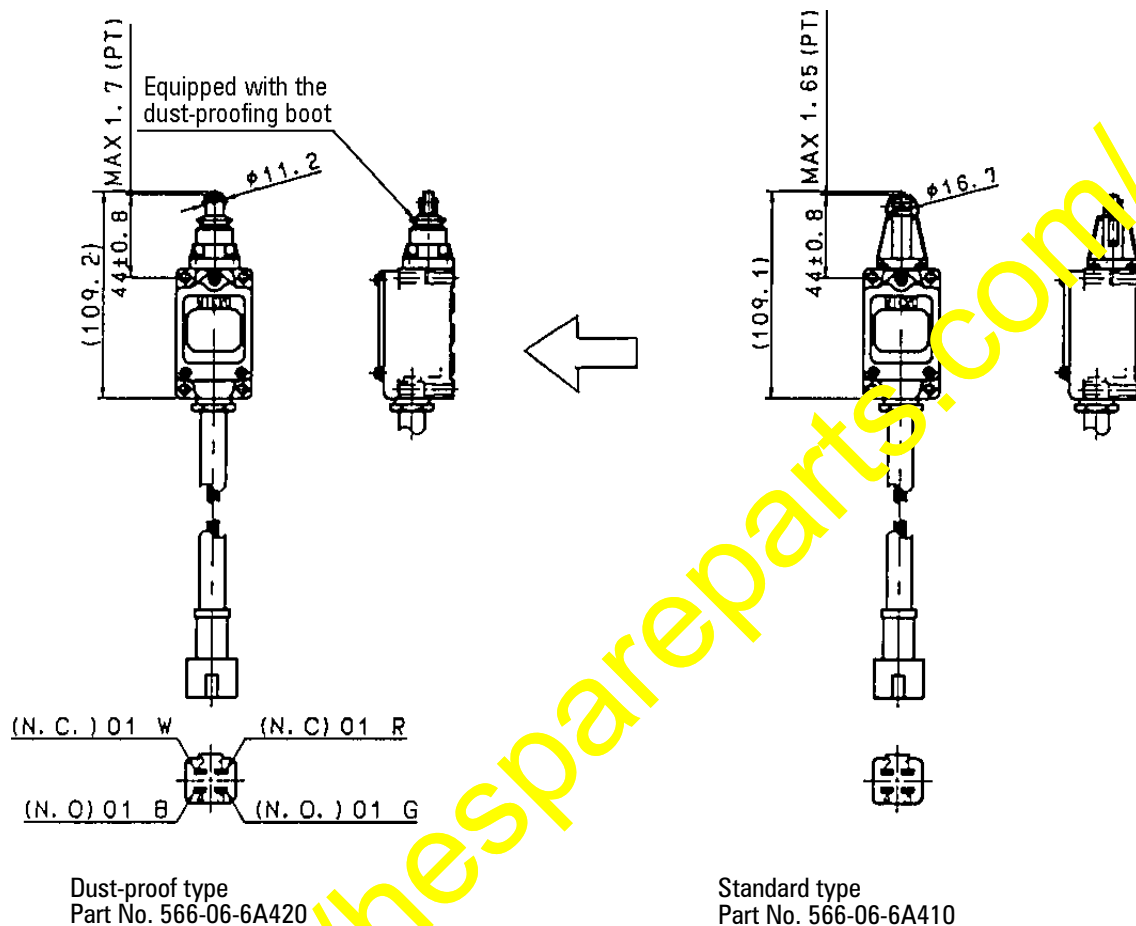
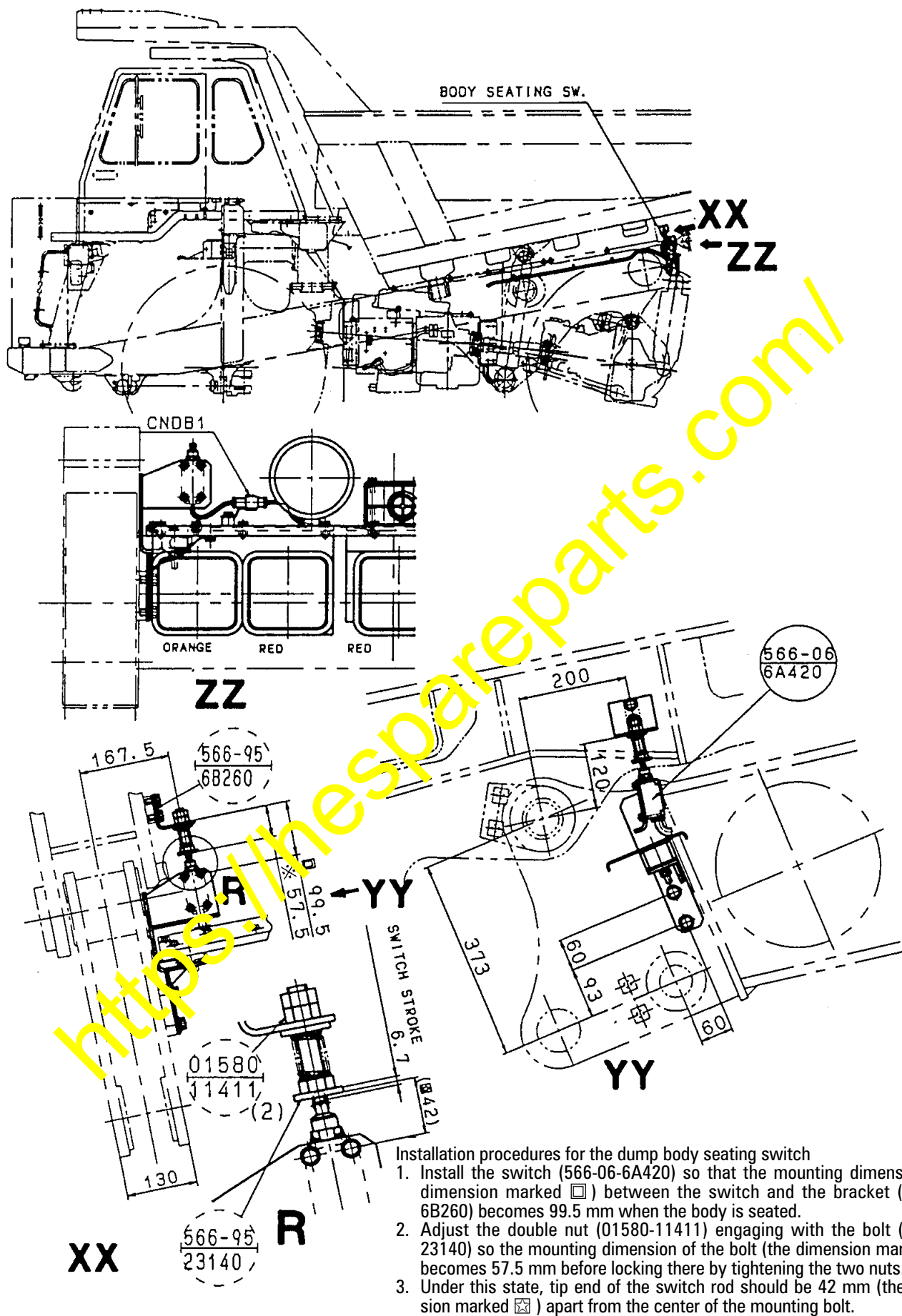

Fig. 1 Difference between the standard switch and dust-proof switch

3-2. Preparations before replacing the parts

(Refer to the Operation and Maintenance Manual.)

- 1) Park the vehicle on a level and solid surface and insert wedges underneath the tires.
- 2) Raise the body, lock the dump lever at the "HOLD" position and, furthermore, use the safety pin.
- 3) Stop the engine.



- Installation procedures for the dump body seating switch
1. Install the switch (566-06-6A420) so that the mounting dimension (the dimension marked \square) between the switch and the bracket (566-95-6B260) becomes 99.5 mm when the body is seated.
 2. Adjust the double nut (01580-11411) engaging with the bolt (566-95-23140) so the mounting dimension of the bolt (the dimension marked \ast) becomes 57.5 mm before locking there by tightening the two nuts.
 3. Under this state, tip end of the switch rod should be 42 mm (the dimension marked \boxtimes) apart from the center of the mounting bolt.

Fig. 2-(1) Installation and adjustment procedures for the switch
(in case of the HD326-6 and HD405-6)

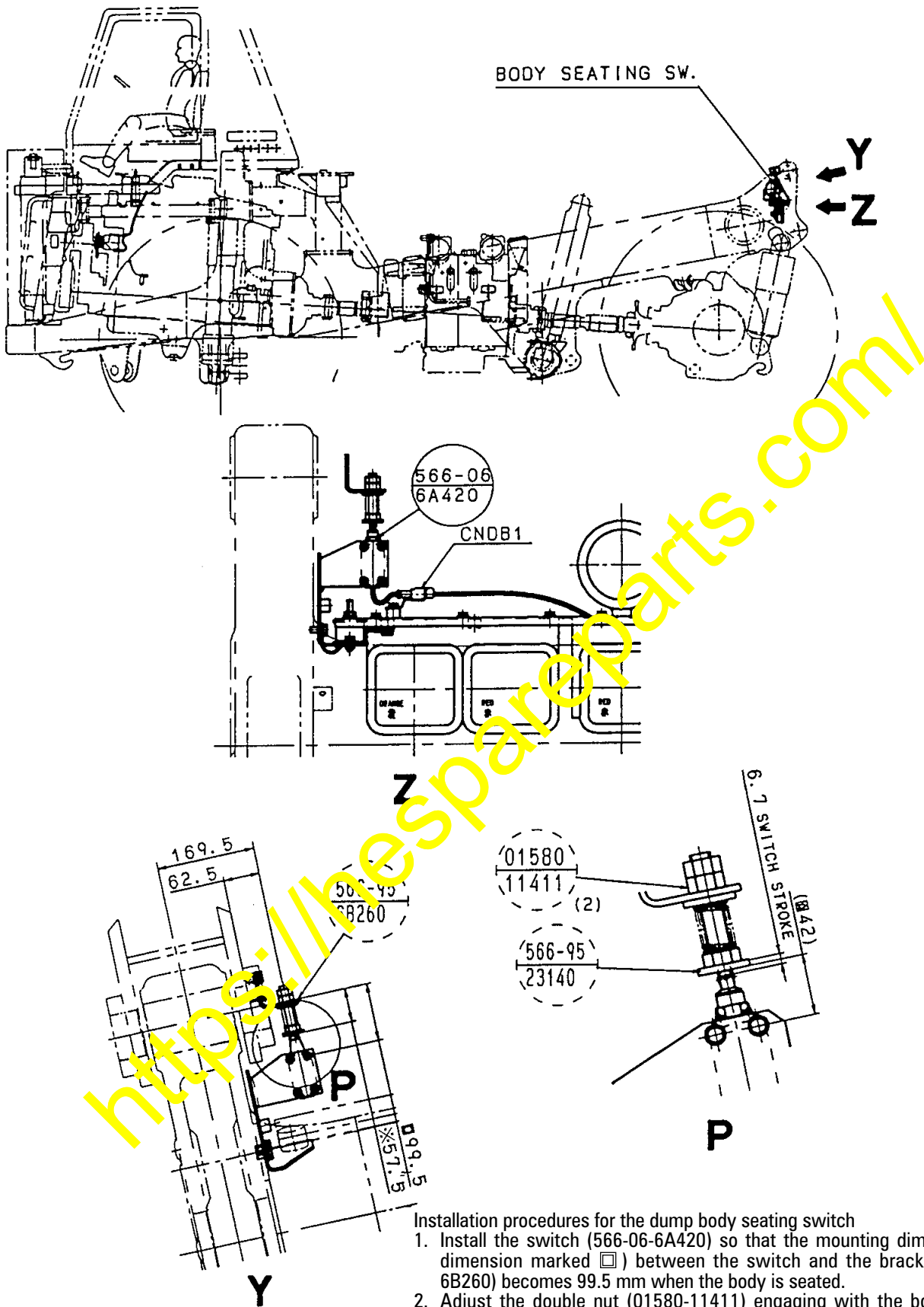

- Installation procedures for the dump body seating switch
1. Install the switch (566-06-6A420) so that the mounting dimension (the dimension marked \square) between the switch and the bracket (566-95-6B260) becomes 99.5 mm when the body is seated.
 2. Adjust the double nut (01580-11411) engaging with the bolt (566-95-23140) so the mounting dimension of the bolt (the dimension marked \ast) becomes 57.5 mm before locking there by tightening the two nuts.
 3. Under this state, tip end of the switch rod should be 42 mm (the dimension marked \boxtimes) apart from the center of the mounting bolt.

Fig. 2-(2) Installation and adjustment procedures for the switch
(in case of the HD465-5 and HD605-5)

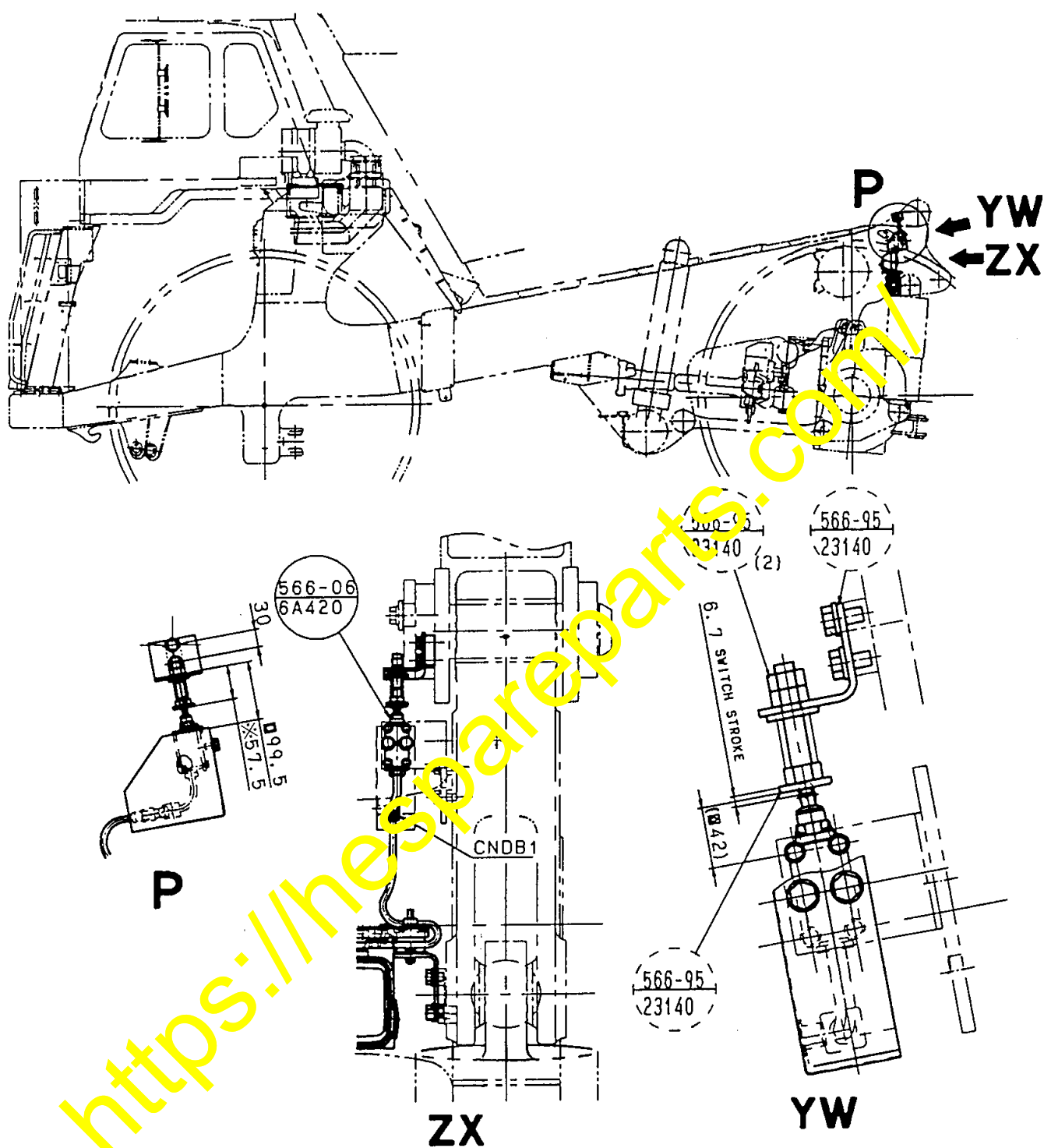

Installation procedures for the dump body seating switch

1. Install the switch (566-06-6A420) so that the mounting dimension (the dimension marked \square) between the switch and the bracket (566-95-6B260) becomes 99.5 mm when the body is seated.
2. Adjust the double nut (01580-11411) engaging with the bolt (566-95-23140) so the mounting dimension of the bolt (the dimension marked \ast) becomes 57.5 mm before locking there by tightening the two nuts.
3. Under this state, tip end of the switch rod should be 42 mm (the dimension marked \boxtimes) apart from the center of the mounting bolt.

Fig. 2-(3) Installation and adjustment procedures for the switch
(in case of the HD785-5 and HD985-5)

3-3. Replacement and adjustment procedures

- 1) The Switch is being installed to the position according to Fig. 2. (Refer to Fig. 2-(1) for the HD325-6 and HD405-6, Fig. 2-(2) for the HD465-5 and HD605-5 and Fig. 2-(3) for the HD785-5 and HD985-5.)
- 2) Disconnect the harness connection separating the connector (CN DB1 in Fig. 2).
- 3) Remove the four mounting bolts to separate the switch from the bracket.
- 4) Install the new switch (566-06-6A420).
- 5) Connect the harness connection re-connecting the connector.
- 6) Loosen the double nut (01580-11411) fastening the adjusting bolt (565-95-23140) and leave them in tentatively tightened state.
- 7) Start the engine, pull out the safety pin and release the "HOLD" state for the dump lever to lower the body. When the body is seated, set the lever to the "FLOAT" position.
- 8) Check and make sure that the body has physically seated on the chassis side guide.
- 9) Check and make sure that the mounting dimension (the dimension marked □ in Fig. 2) between the switch and the bracket is 99.5 mm.
- 10) Adjust the double nut so the mounting dimension (the dimension marked ※ in Fig. 2) becomes 57.5 mm before locking there by tightening the two nuts against each other.
- 11) Under this state, check and make sure that the tip end of the switch rod is being positioned at a point which is 42 mm (the dimension marked ☆) away from the center of the mounting bolt.
- 12) Watching the monitor panel, make the following inspections.
 - (1) While the body is in a raised position, the body float caution lamp should turn on no matter where the dump lever position may be at.
 - (2) While the body is seated after having been lowered, the lamp should turn off when the dump lever is set to the "FLOAT" position.

When anything has been found abnormal during the above inspections, check for any anomalies in the installation of the switch and re-adjust it.

