

PARTS & SERVICE NEWS

REF NO.	AT01054
DATE	May 23, 2001

Page 1 of 8

SUBJECT: REPAIR OF WIRING HARNESS DAMAGE IN RIGHT WRIST REST ON WA1200-3

PURPOSE: To provide protections to the wire harness inside the right hand side wrist rest against potential damage.

APPLICATION: WA1200-3 Wheel Loaders, Serial Nos. 50001 thru 50007

FAILURE CODE: D540FL

DESCRIPTION:

1. Introduction

Should you try to pull out the RH wrist rest beyond its adjustable range on the WA1200-3 dump trucks, a wire harness installed inside the wrist rest may be damaged. The wire harness may also be damaged, interfering with the components inside the console, depending on the way you route it.

This Parts and Service News describes procedures (modifications) for installing an wrist rest stopper as well as helps you route the wire harness in the optimum way.

2. List of parts

Part No.	Part Name	Purpose of part	Q'ty	Remarks
42C-54-12173 (42C-54-12171)	Bracket (Bracket)	Reworked	1 (1)	
08051-00801	Clip	} Addition	2	
42C-54-12180	Plate		1	
04205-10030	Pin		1	
42703-15070	Plate		2	
04050-11612	Pin		1	
42C-54-19930	Harness		1	

3. Contents of Modifications

Install a stopper on the right side wrist rest bracket, which serves to protect the wire harness against possible damage, even when the wrist rest is pulled out beyond the adjustment limit. Also reroute the harness inside the right side console to protect it against another damage due to interference with the components inside the console.

4. Procedures for Modifications

(1) Reworking of right side wrist rest

- ① Detach the wrist rest bracket (42C-54-12171) on the right side console in the cab. Then remove the wire harness from within the bracket pipe so that it will not be damaged when reworking the wrist rest.
- ② Detach Plate A from the bracket as illustrated below.

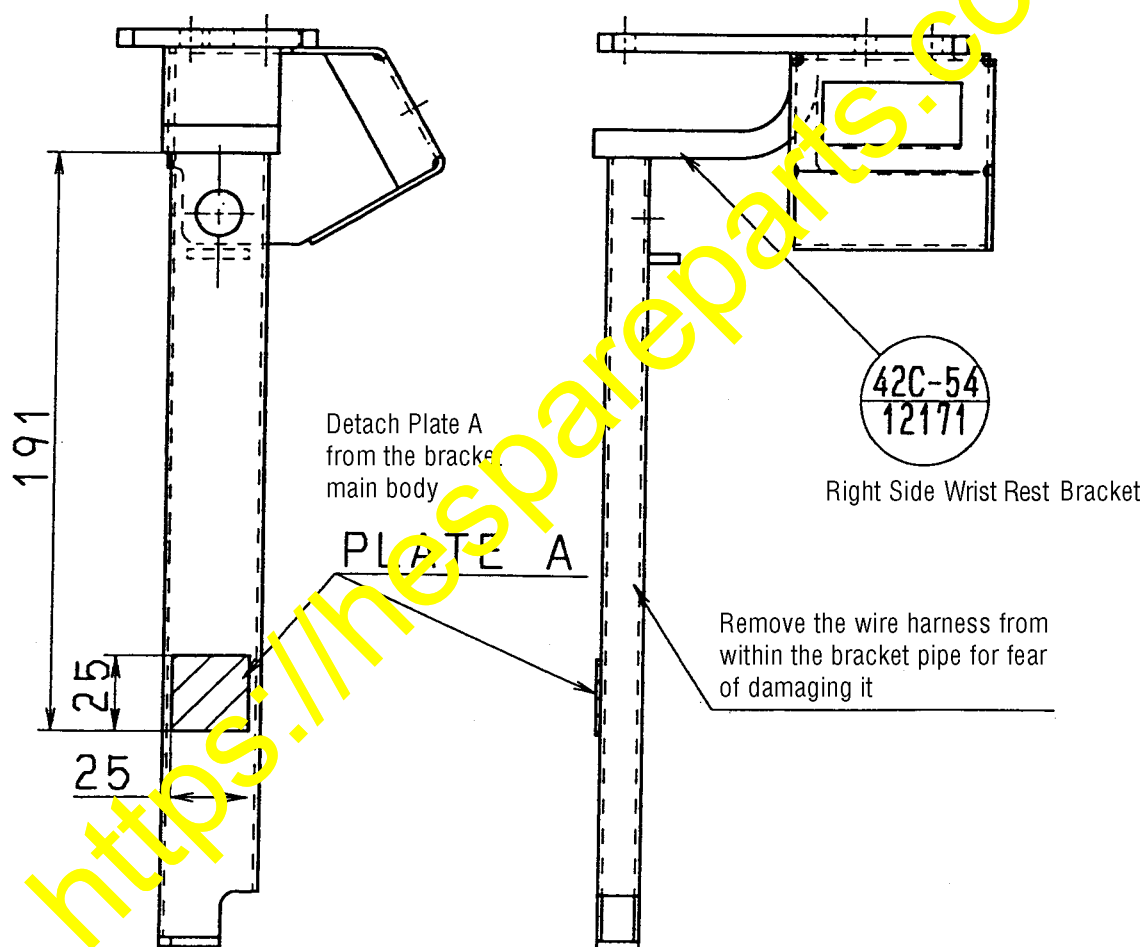

- ③ Drill an additional hole through the bracket.
6.3 Drill (See the illustration below)

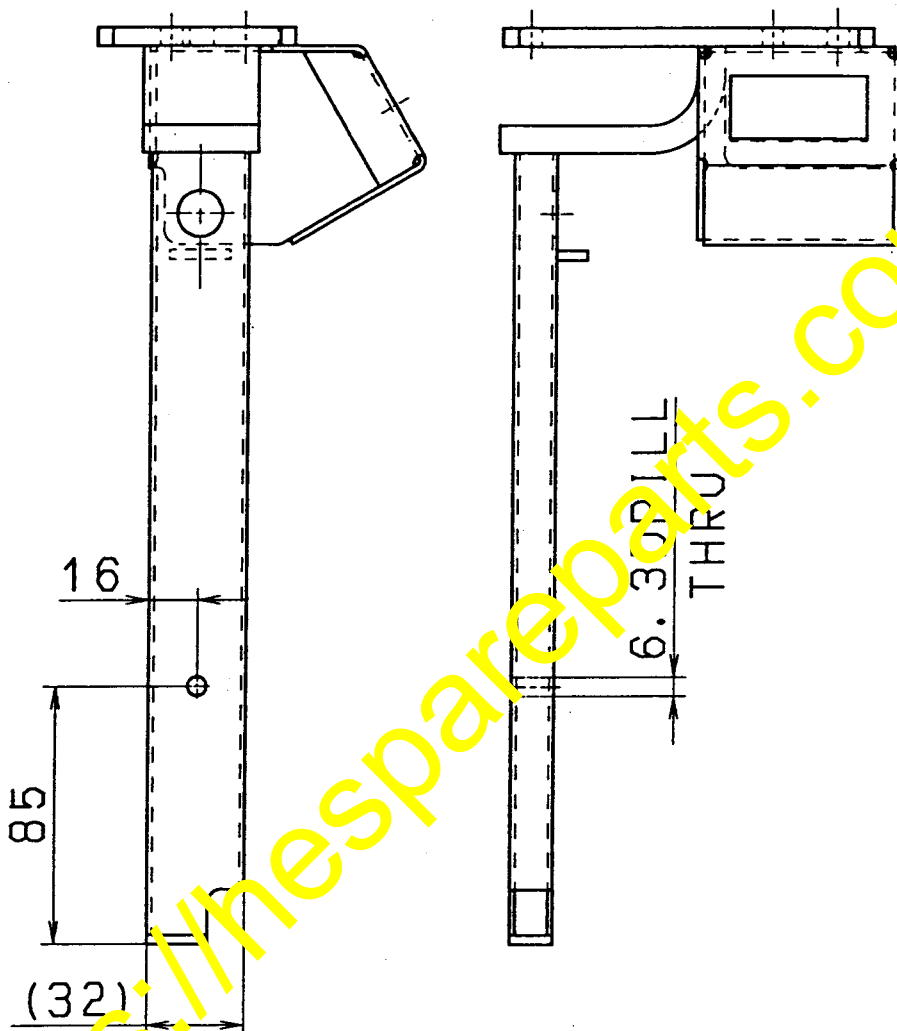

(2) Fixing an additional clip on the right side console box

Fix an additional clip (08051-00801) on the surface of the right side console as indicated in the figure below. Thoroughly wipe dust, oil, grease, etc. off the fixing surface beforehand.

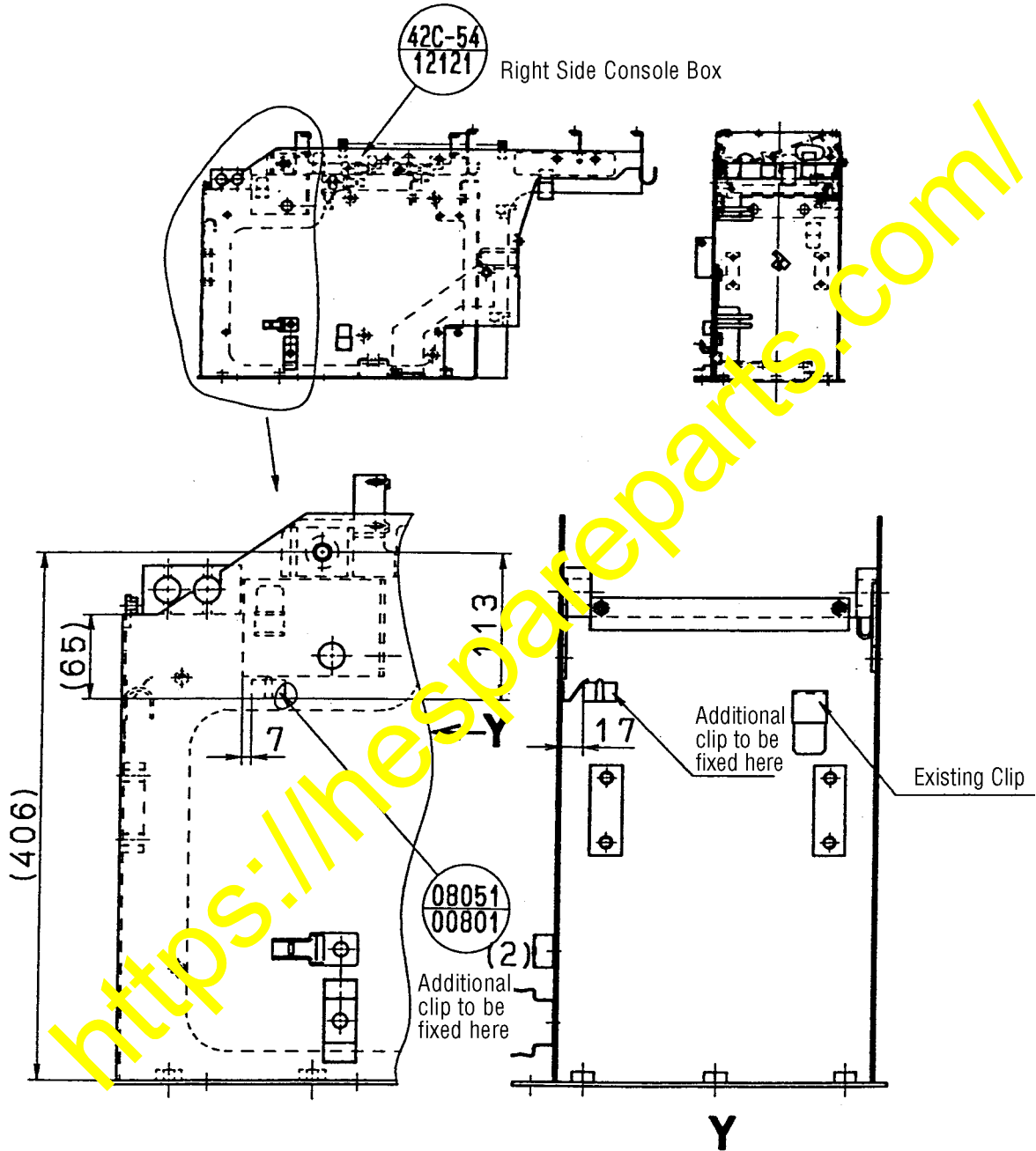

(3) Assembling the bracket and wire harness

- ① Reinstall the reworked wrist rest bracket (42C-54-12171) in the right side console box. Then install a stopper pin and plate in the wrist rest bracket.
- ② Add an extension wire harness (42C-54-19930) between the existing wire harness and the wire harness for the turn signal. Then clamp it with a clip installed in Item (2) above.

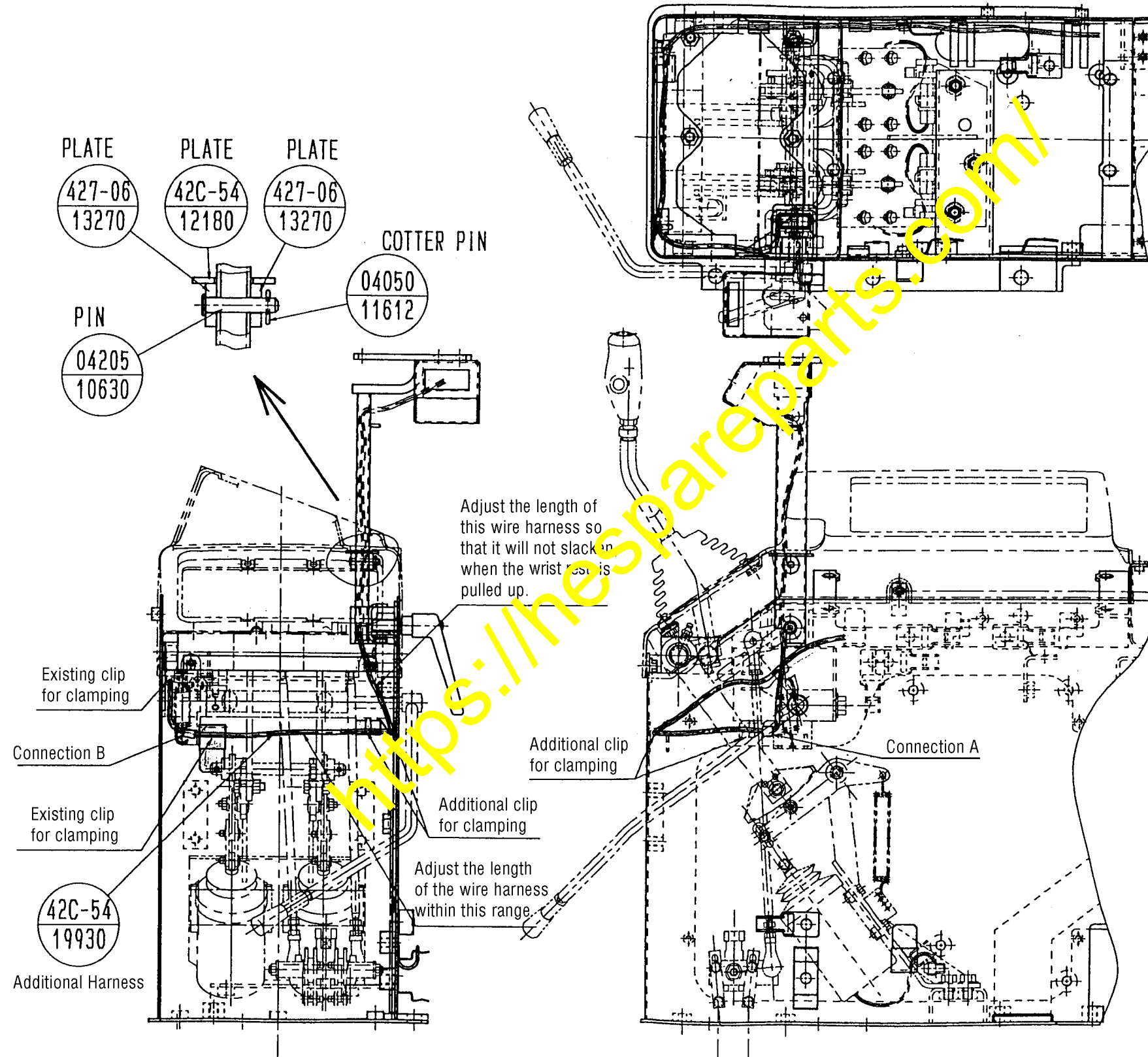

③ Make connections of the wire harness, referring to the circuits shown below.

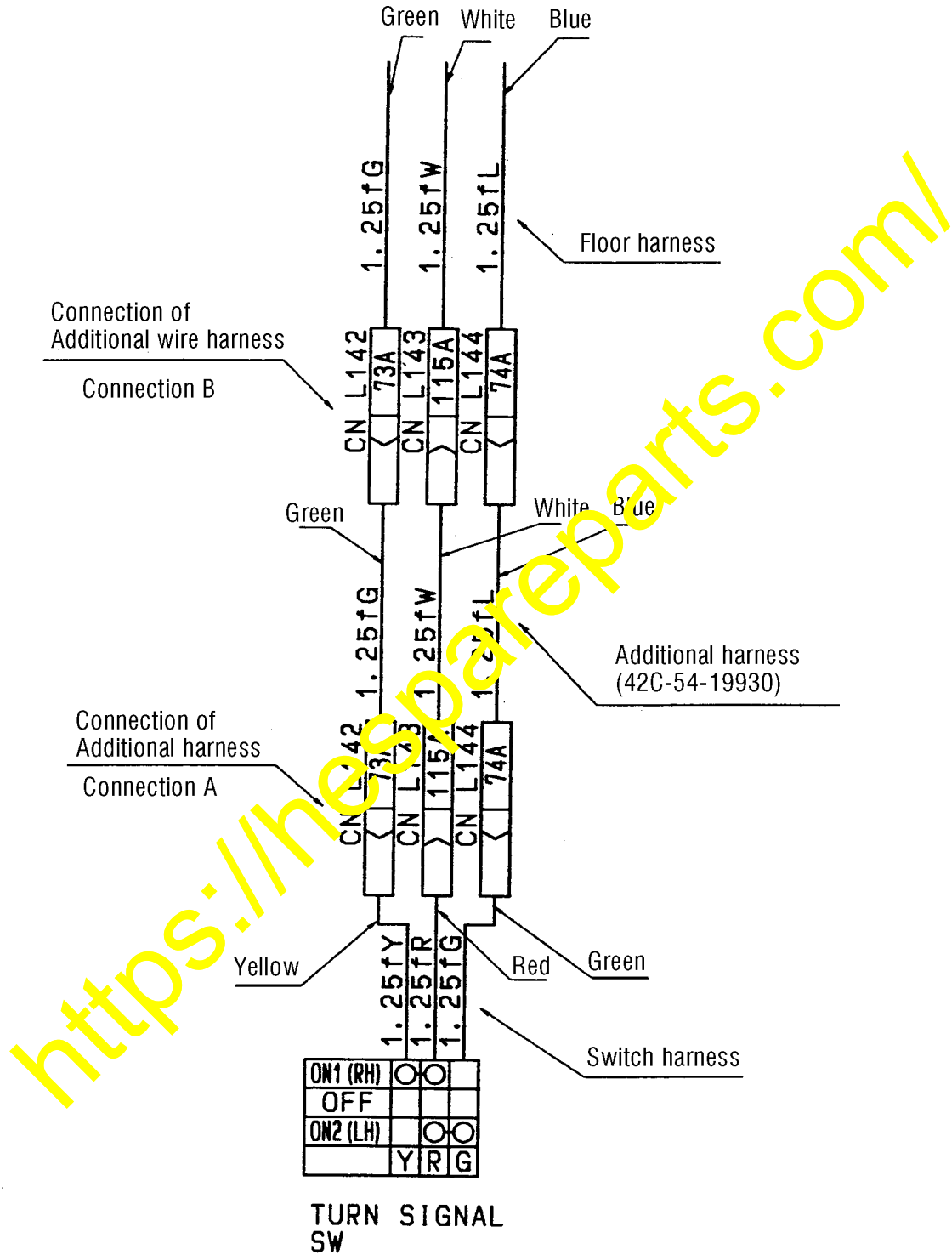

Connection of Additional harness

5. Drawings for Local Manufacture of Parts

42C-54-12180 plate (one piece)

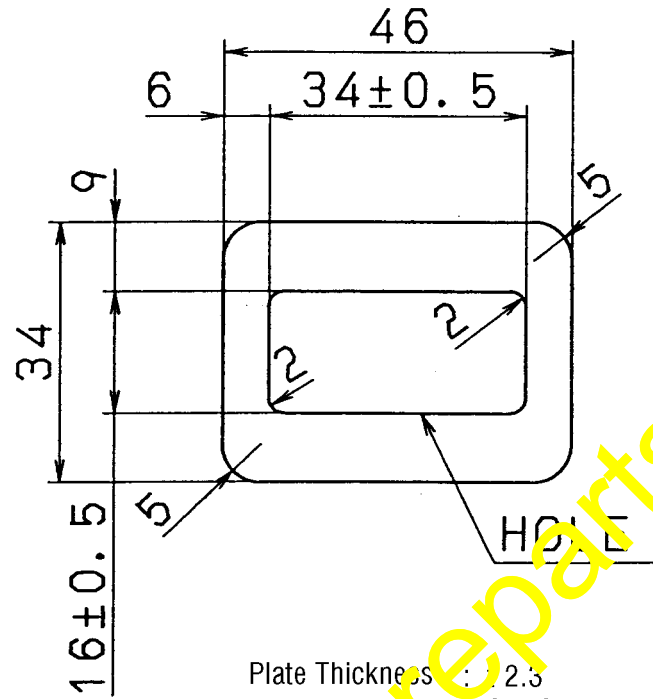

Plate Thickness : 2.5
 Plate Material : SPHC
 Painting Mode : PU-4

427-06-13270 plate (two pieces)

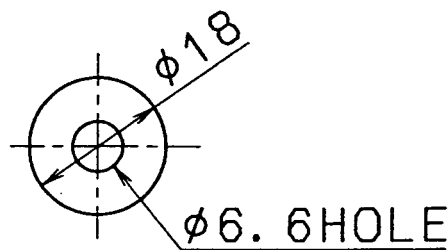

Plate Thickness : t 4.5
 Plate Material : SS400P
 Painting Mode : PU-4

42C-54-19930 WIRING HARNESS

