

**PARTS & SERVICE
NEWS**

REF NO.	AT02081
DATE	Jul. 18, 2002

Page 1 of 2

SUBJECT: INTRODUCTION OF INJECTION PUMP MOUNTING BRACKET**PURPOSE:** To introduce a reinforced fuel injection pump mounting bracket for use with S, SA, SAA6D125 engines

APPLICATION: S6D125 Engines, Serial Nos. up to 88548
 SA6D125 Engines, Serial Nos. up to 88505
 SAA6D125 Engines, Serial Nos. up to 88530
 J6D125E-G1 Engines, Serial Nos. up to 150034

FAILURE CODE: A7A3GJ**DESCRIPTION:**

1. Introduction

To improve the reliability and durability of the fuel injection system parts, the fuel injection pump mounting bracket for use with the S, SA, SAA6D125 engines has been changed to the reinforced type which is currently being used for marine engines to reduce the vibrations of the pump. This Service News will introduce the improved fuel injection pump mounting bracket.

Be sure to replace the fuel injection pump mounting bracket with this improved type when overhauling.

2. List of parts

Part No.	Part Name	Q'ty	Remarks
6152-25-6111 (6151-21-6111)	Bracket (Bracket)	1 (1)	
01010-81060 (01010-81045)	Bolt (Bolt)	2 (2)	

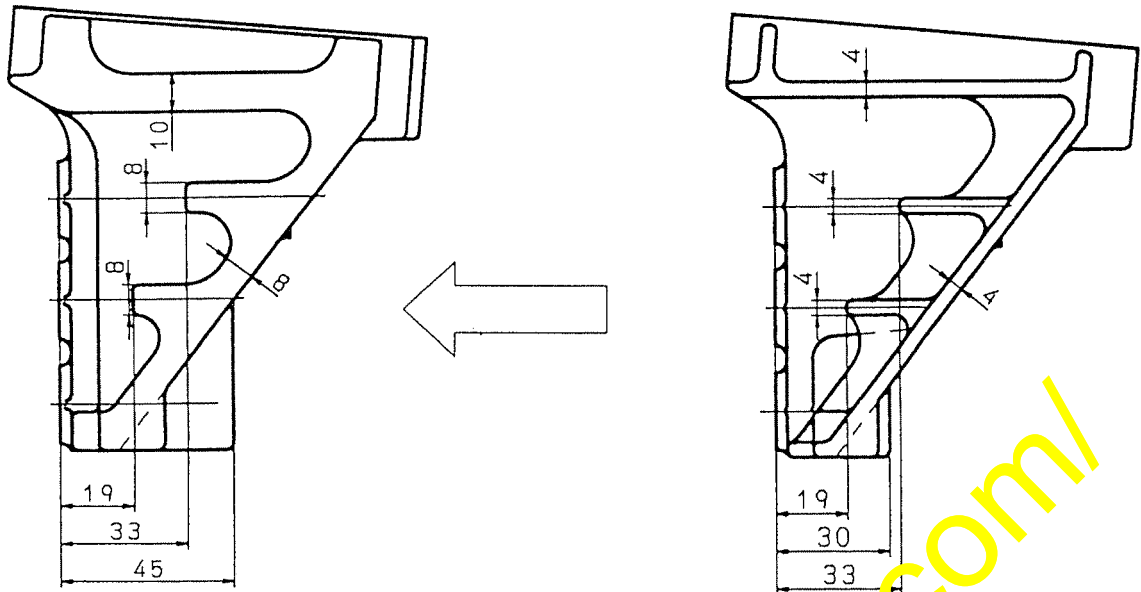

Reinforced bracket
6152-25-6111

Current bracket
6151-21-6111

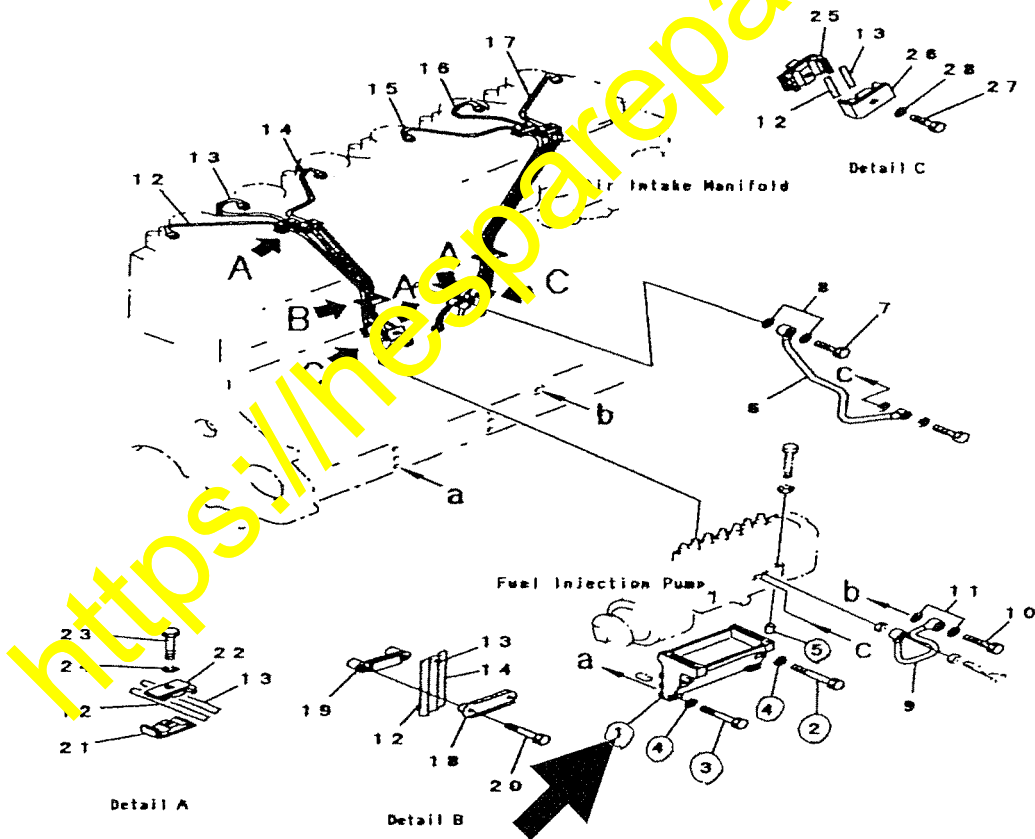

	Reinforced bracket	Current bracket
No. 1	6152-25-6111 (Bracket)	6151-21-6111 (Bracket)
No. 2	01010-81075 (Bolt)	01010-81075 (Bolt)
No. 3	01010-81060 (Bolt)	01010-81045 (Bolt)
No. 4	01643-31032 (Washer)	01643-31032 (Washer)
No. 5	6150-41-2430 (Pin)	6150-41-2430 (Pin)

※ The bolt length is different.