

# PARTS & SERVICE NEWS

REF NO.	AT03193
DATE	Oct. 2, 2003

(C)

Page 1 of 3

**SUBJECT:** INSTALLATION OF TRANSFER COOLER GUARD ON WA320-5

**PURPOSE:** To introduce modification procedure to install a guard for the transfer cooler on WA320-5 wheel loaders

**APPLICATION:** WA320-5 Wheel Loaders, Serial Nos. 60004 thru 60038

**FAILURE CODE:** 1600FA

## DESCRIPTION:

### 1. Introduction

When the WA320-5 wheel loaders are used for snow removal work or scraping work frequently, lumps of snow and small stones being blown up by the tires may damage the transfer cooler.

Therefore, to prevent occurrence of the above mentioned failure, make the modification to install a guard for the transfer cooler following the enforcement method being introduced in this Service News.

### 2. List of parts

Part No.	Part Name	Purpose of part	Q'ty	Remarks
(419-46-32101)	(Frame)	Reworked	(1)	Reworked parts
01573-22313	Seat	} Addition	1	Component parts to weld when carrying out reworking of the frame.
419-14-31230	Plate		1	
01024-81230	Bolt		2	
				} Additional parts

3. Content of the malfunction

When the WA320-5 is used for snow removal work or scraping work frequently, lumps of snow and small stones being breakage by the tires may damage the transfer cooler.

4. Content of the measures

A guard is to be added to the lower section of the transfer cooler.

5. Modification procedure

**⚠ Start the modification work after lowering the work equipment to touch the ground completely and after stopping the engine.**

(1) Reworking of the rear frame

Add the seat referring to the reworking procedure for the rear frame being described on page 3.

(2) Install the guard to the seat having been installed per the above mentioned reworking procedure.

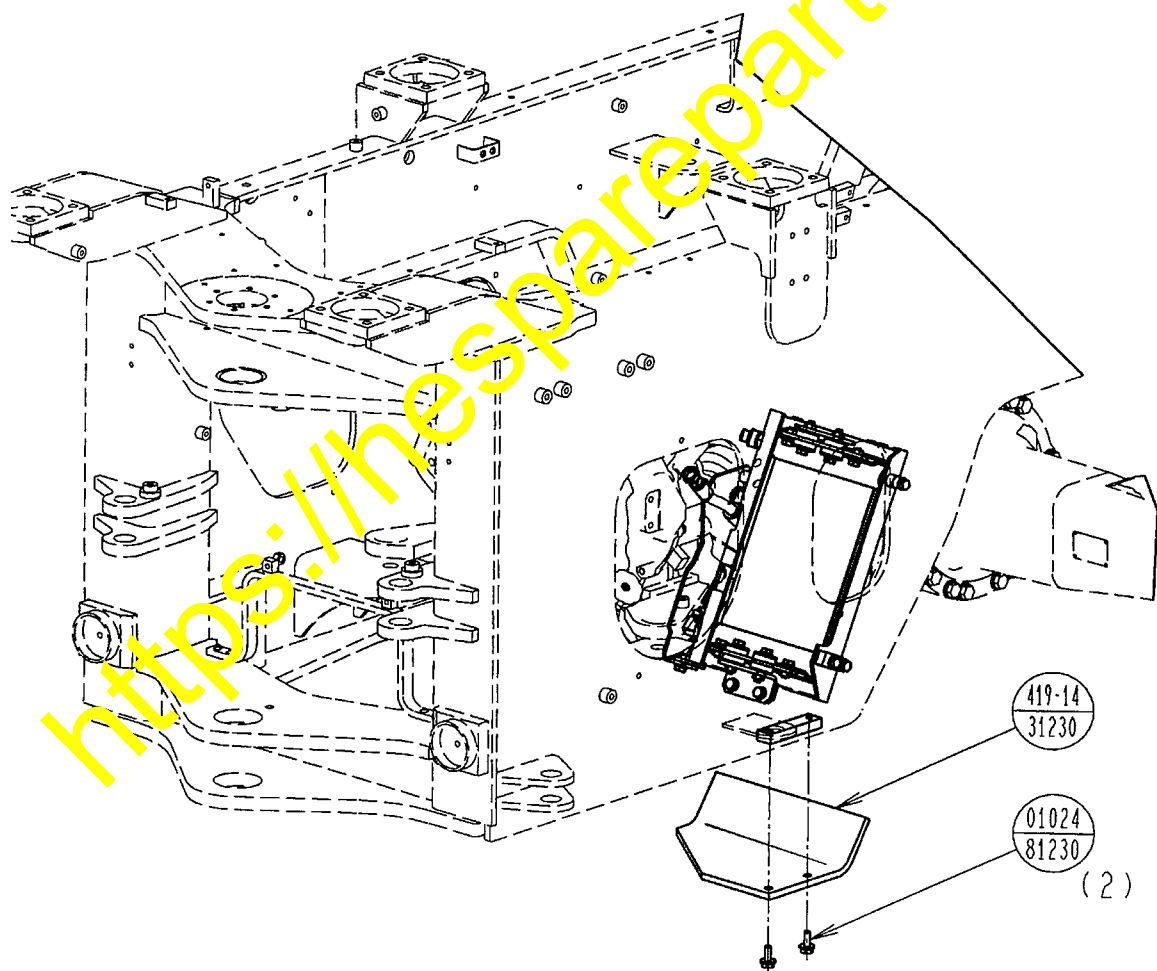

(3) The tightening torque for the bolts should be as follows:

As per KES 04.123.1 and an impact wrench should be used.

- Reworking procedure for the rear frame  
Weld the transfer guard mounting seat to the lower section on the LH side of the rear frame.

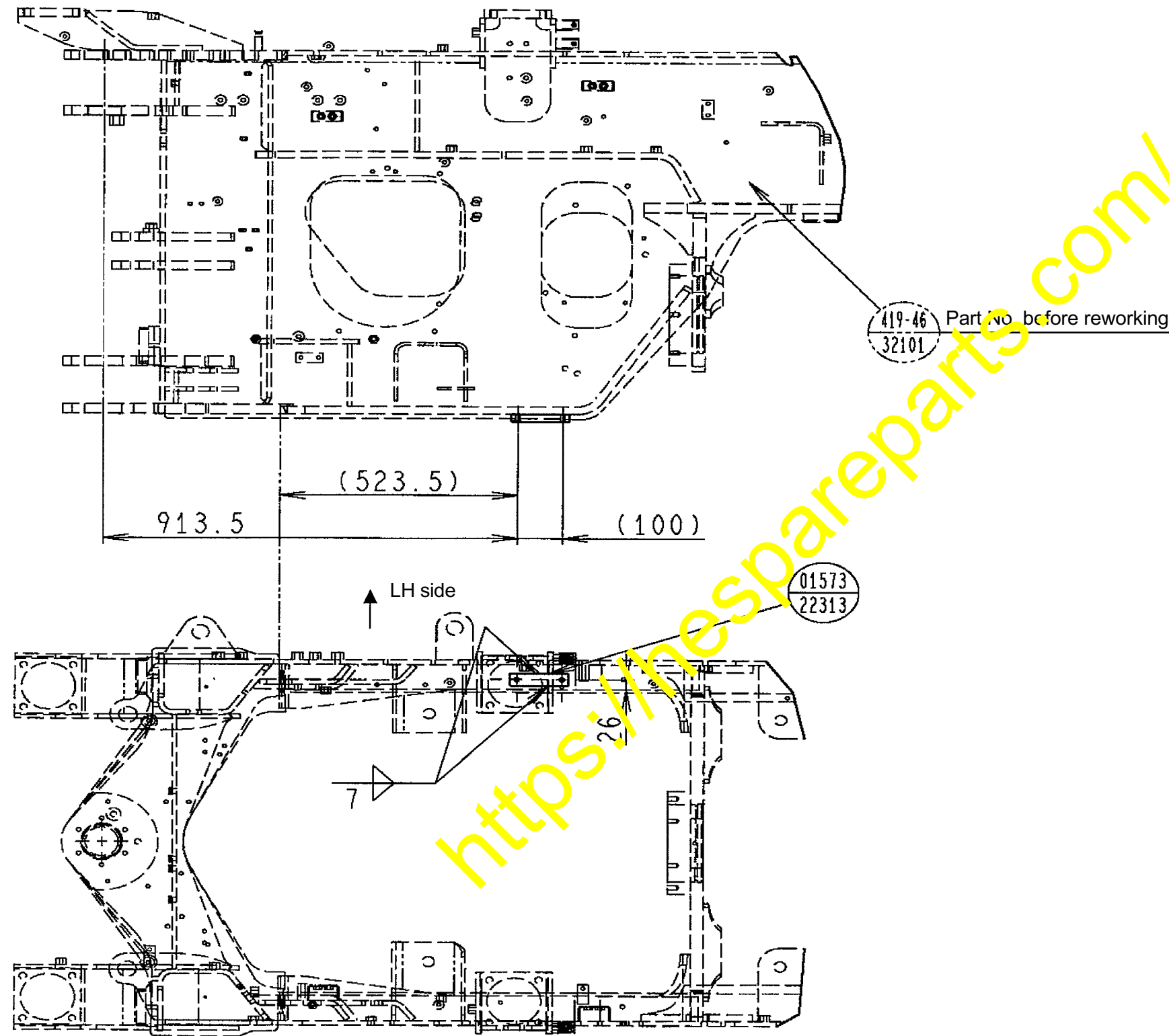

When viewed from the bottom side