

PARTS & SERVICE NEWS

REF NO.	AT04027
DATE	Mar. 4, 2004

(C)

Page 1 of 5

SUBJECT: REPAIR PROCEDURE FOR BROKEN AIR COMPRESSOR TUBE FOR SA12V140 ENGINES

PURPOSE: To introduce modification procedure to repair broken air compressor tube for the SA12V140 engines

APPLICATION: Refer to page 5

FAILURE CODE: AJ31FF

DESCRIPTION:

1. Introduction

Since there is a possibility of occurrence of breakage failure with the air compressor tube for the SA12V140 engines by vibrations of the engine, make the modification to repair the broken tube following the modification procedure described in this Service News.

Regarding the modification procedure for the rear side air compressor oil feeding tube, refer to the Service News No. AT02192.

<https://hespareparts.com/>

2. List of parts

Part No.	Part Name	Purpose of part	Q'ty	Remarks
6215-81-5130 (6215-81-5221)	Tube (Tube)	Replacement	1 (1)	} Front side oil feeding tube
6166-13-3440	Tube	} Addition	1	
6215-81-5140	Joint		2	
6215-81-5460 (6150-51-9470)	Joint (Joint)	Replacement	1 (1)	} Consumable parts
07005-01012	Gasket		7	
6215-81-5331 (6215-81-5330)	Tube (Tube)	Replacement	1 (1)	Tube
07005-01412	Gasket		4	Consumable parts

<https://hespareparts.com/>

3. Details of the modification

Teflon flexible tube has been employed.

The front side oil feeding tube has been divided to two.

4. Modification procedure

Refer to the Shop Manual for the 12V140 Series engines.

Joint bolt tightening torque:

M10: 9.8 – 12.7 Nm (1.0 – 1.3 kgm)

M14: 24.5 – 34.3 Nm (2.5 – 3.5 kgm)

<https://hespareparts.com/>

FIG. A7010-C7A1 AIR COMPRESSOR PIPING (2/2)(#11755-)

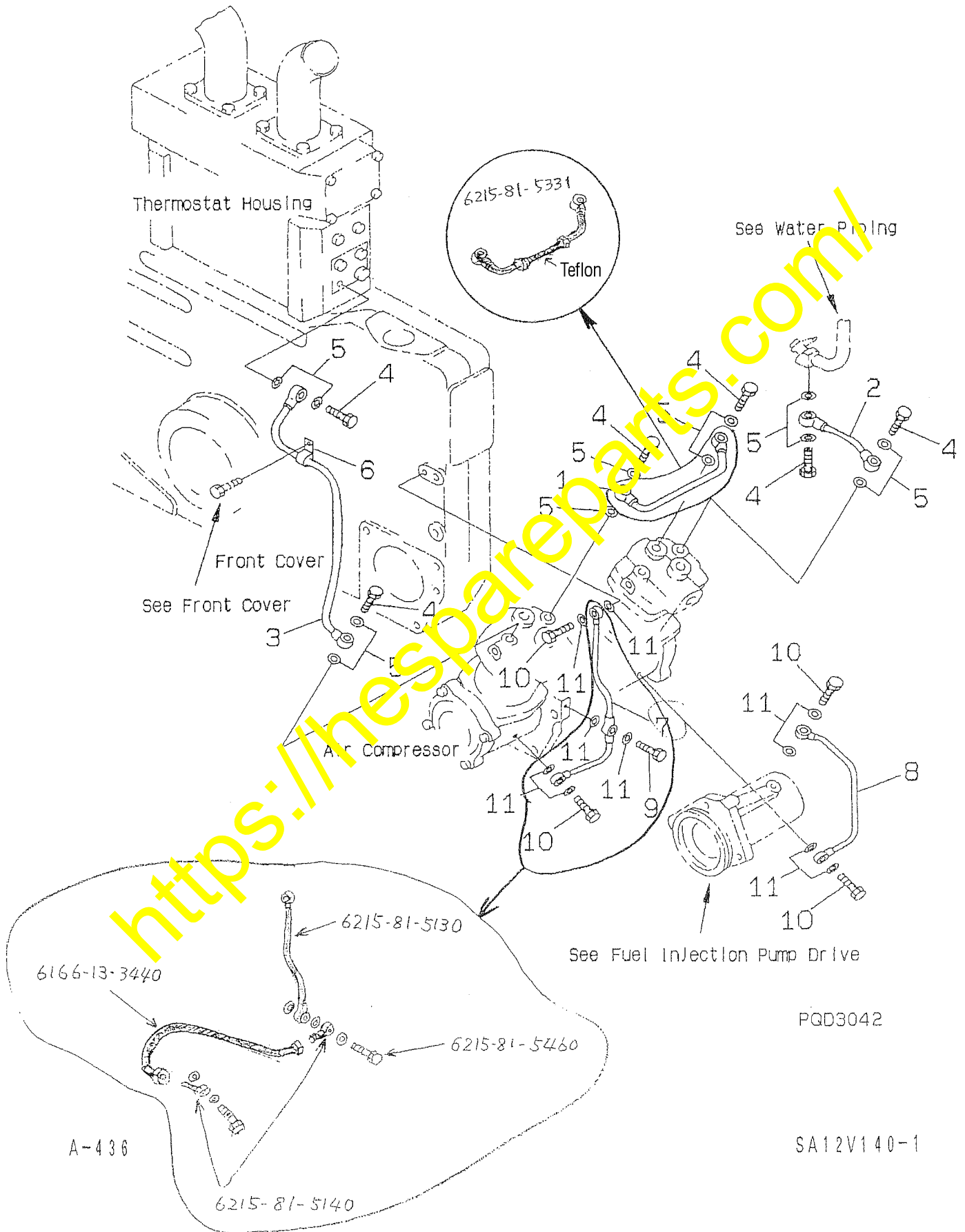

Modification of the oil feeding tube for the air compressor

(Service News: Check table for the serial numbers of the machines with which immediate design change is applied)

No.	Applicable machine model	Engine Serial No. of the applicable machines		Modifi- cation being made from	Machine Serial No. of the applicable machines	
		Machines in the field	Factory shipment of new machines with improved tubes		Machines in the field	Factory shipment of new machines with improved tubes
1	J12V140-WJK-1					
2	J12V140-GCK-1					
3	SA12V140-W1-1					
4	HD785-2*					
5	HD785-3	Up to 13257			#2001 thru 2574	
6	HD785-5	Up to 13487	From the next shipment		#4691 thru 4743	
7	HD785-DZ-5					
8	HD785-JK-5	Up to 13466				
9	HV700-2				#1005 thru 1010	
10	HD985-3	Up to 13257			#1001 thru 1020	
11	HD985-5	Up to 13497	13498 and up	10/21	#1021 thru 1064, #1067	#1065 and up
12	WA800-1					
13	WA800-2	Up to 12732			#10503 thru 10737	
14	WA800-3	Up to 13492	From the next shipment		#50001 thru 51002	
15	WA900-1	Up to 13310				#10001 thru 10009, 50001
16	WA900-3	Up to 13496	13506 and up	10/23	#50002 thru 50035, 51001	