

PARTS & SERVICE NEWS

REF NO.	AT04061
DATE	Apr. 16, 2004

(C)

Page 1 of 2

SUBJECT: IMPROVED TRANSMISSION LUBRICATION TUBE

PURPOSE: To introduce improved transmission lubrication tube with increased reliability for use on motor graders

APPLICATION: GD705A-4A Motor Graders, }
GH320-2 Motor Graders, } Refer to below.

FAILURE CODE: 155JHB

DESCRIPTION:

1. Introduction

As KOMATSU has developed an improved transmission lubrication tube with increased reliability by changing the welding method and the shape for use on the GD705 Series motor graders, which are introduced in this Service News.

Applicable machine model	Applicable machine model			
	Machines in the field		Machines installed improved tube at factory	
	Serial No. of the machine	Serial No. of the transmission	Serial No. of the machine	Serial No. of the transmission
GD705A-4	- #21516	- 2512	#21517 -	2513 -
GD705A-4A, -4Y	- #13027	- 2512	#13028 -	2513 -
GD705A-4C	- #21071	- 2512	(Production stopped)	2513 -
GD705A-4D	No production record	- 2512	No production record	2513 -
GD705A-4S	No production record	- 2512	No production record	2513 -
GD705AEM-4	No production record	- 2512	No production record	2513 -
GD725A-1	- #50014	- 2512	(Production stopped)	2513 -
GH320-1	- #10019	- 2512	(Production stopped)	2513 -
GH320-2	- #12039	- 2512	#12040 -	2513 -

2. List of parts

Part No.	Part Name	Q'ty	Remarks
234-15-21362 (234-15-21361)	Tube (Tube)	1 (1)	
01010-81040 (01010-81030)	Bolt (Bolt)	2 (2)	

3. Details of the modification

(1) The shape of the lubrication tube ① has been changed to prevent entry of spatters caused at welding work.

Also, the connection method has been changed from welding to brazing to avoid the mounting stress caused by the welding strain and the resultant cracking which leads to oil leakage.

(2) Pursuant to the change of the thickness of the tube flange, the mounting bolt ② has been changed.

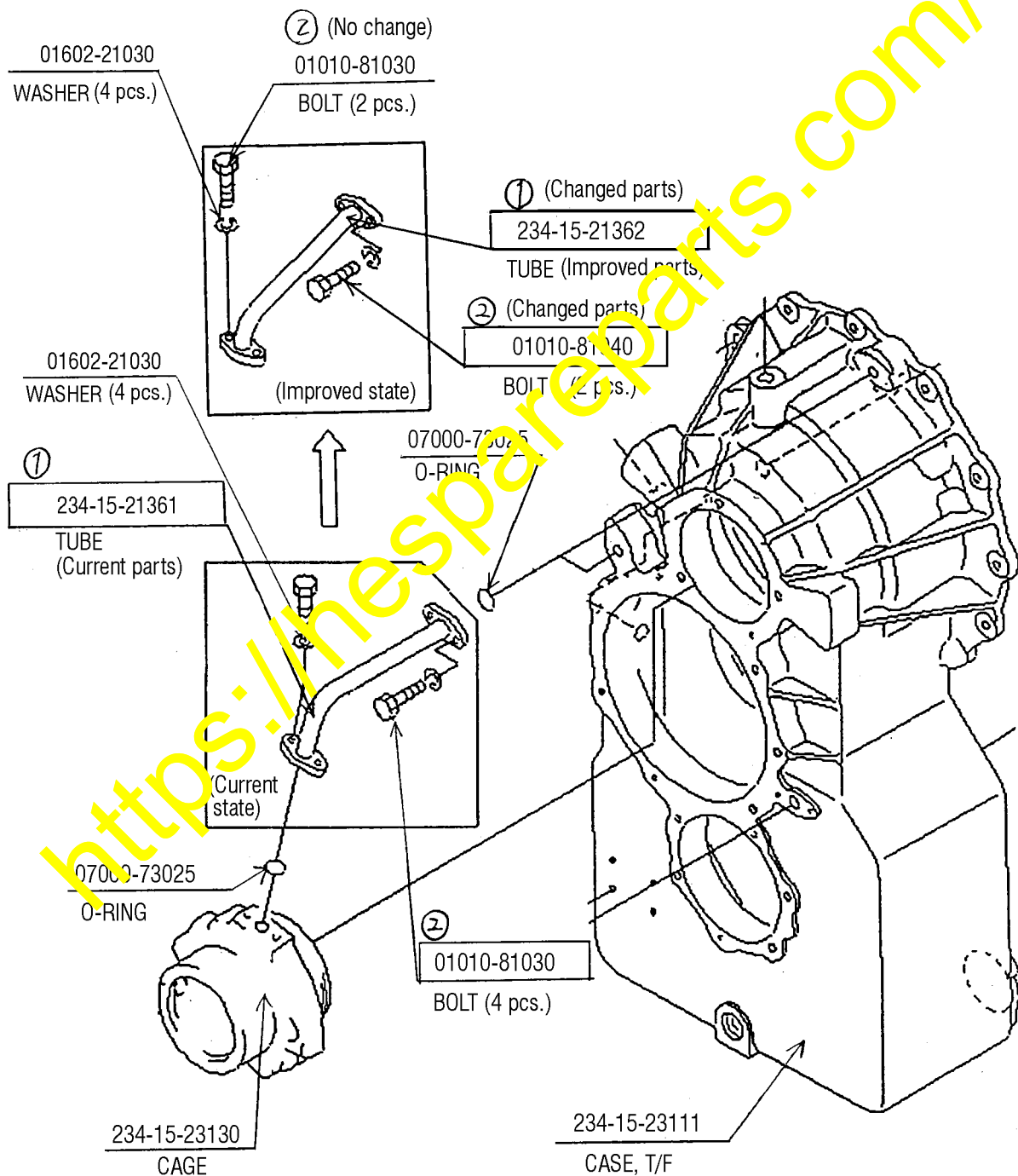

Fig. 1