

**PARTS & SERVICE
NEWS**

REF NO.	AT04077
DATE	Apr. 20, 2004

(C) Page 1 of 6

SUBJECT: MODIFICATION PROCEDURE FOR ENGINE MUFFLER ON WA100-5/
WA150-5 (WITH CABIN)

PURPOSE: To introduce modification procedure for the muffler of the SAA4D102E-2 engines on WA100-5 and WA150-5 wheel loaders (operator's cab spec. machines)
(Regardless of machines which must receive a compulsory machine inspection or not.)

APPLICATION: WA100-5 Wheel Loaders, Serial Nos. up to 70251
WA150-5 Wheel Loaders, Serial Nos. up to 65066

FAILURE CODE: A1T0HA

DESCRIPTION:

1. Introduction

Since there is a possibility that the outlet port section of the muffler for the SAA4D102E-2 engines on the WA100-5 and WA150-5 wheel loaders (operator's cab spec. machines) breaks, make the modification introduced in this Service News to prevent the breakage failure.

2. List of parts

Part No.	Part Name	Purpose of part	Q'ty	Remarks
416-02-31210 (416-02-31122)	Pipe (Pipe)	Replacement	1 (1)	Parts necessary for modification of the pipe
(416-02-31160)	(Clamp)	Not used	(1)	
(01010-81070)	(Bolt)		(1)	
(01643-31032)	(Washer)		(2)	
(01580-11008)	(Nut)		(2)	
416-02-31152	Bracket		1	
01010-81230	Bolt	Addition	2	
01010-81225	Bolt		4	
175-54-34170	Washer		4	
01643-31232	Washer		5	
6737-11-5310 (6737-11-5310)	Muffler (Muffler)		Replacement	1 (1)
6510-11-5710 (6510-11-5710)	Gasket (Gasket)	1 (1)		Replace the muffler when the outlet port section is being damaged or cracked.

3. Modification procedure

Since there is a possibility that the outlet port section of the muffler on the WA100-5 and WA150-5 breaks, make the modification as per the modification procedure described below.

3.1 Details of the modification

The exhaust pipe installation structure has been changed to the structure to install the exhaust pipe to the engine hood from the structure to install it to the muffler directly.

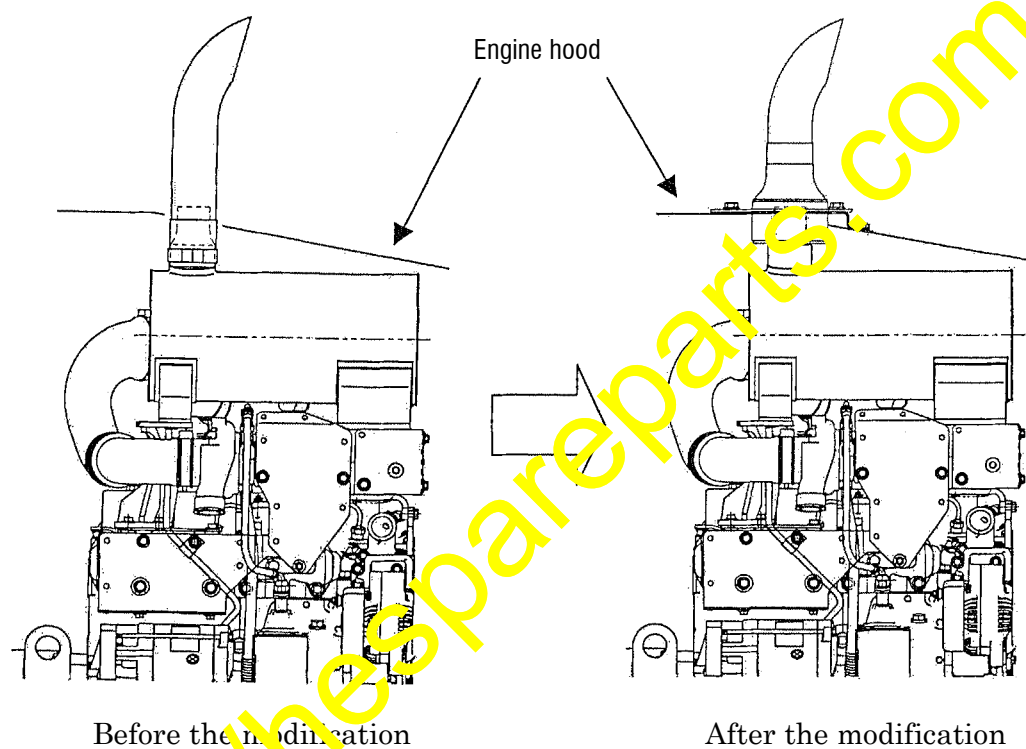
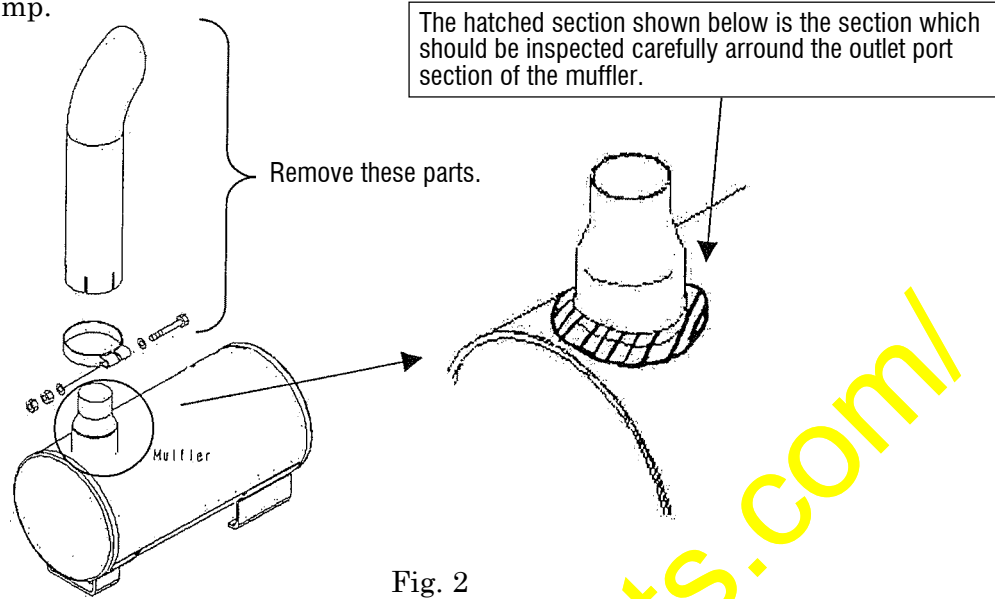

Fig. 1

3.2 Modification procedure

- (1) Loosen the exhaust pipe clamp fastening bolt and nut, and remove the exhaust pipe and the clamp.



- (2) Inspect the outlet port section of the muffler for breakage or crack by visual check or the Dye Penetrant Test (color check).

- (2)-1 In case a breakage or crack is found:

Replace the muffler as per Section (3) "Replacement of the muffler", and after that, install the exhaust pipe as per Section (4) "Installation of the exhaust pipe".

- (2)-2 In case a breakage or crack is not found:

It is not necessary to replace the muffler, but install the exhaust pipe as per Section (4) "Installation of the exhaust pipe".

- (3) Replacement of the muffler

- (3)-1 Remove the bolts ① (01435-01025) and bolts ② (01435-01016), and replace the muffler ③ (6737-11-5310) and the gasket ④ (6150-11-5710).

- (3)-2 Tighten the bolts ① and bolts ②. (Tightening torque: 59 – 74 Nm)

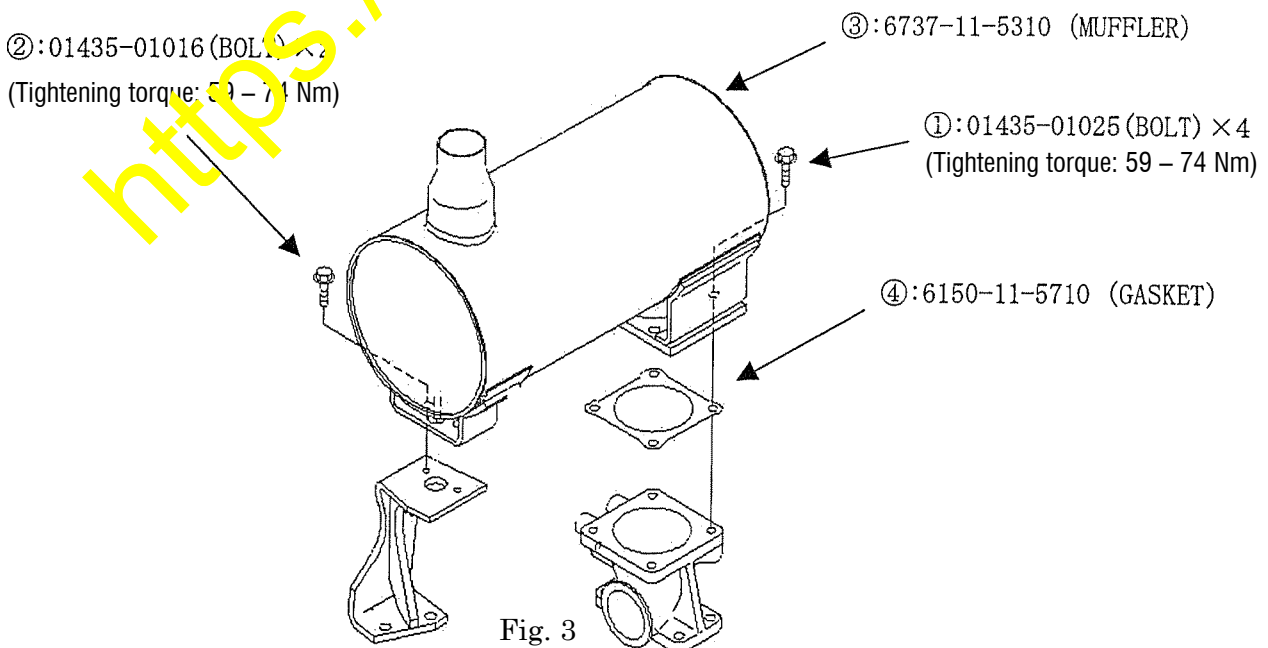

(4) Installation of the exhaust pipe

(4)-1 Install the exhaust pipe ① (416-02-31210) and the bracket ② (416-02-31152) to the engine hood. (Observe the <Precautions for the installation work> indicated below.)

(4)-2 Tighten the bolts ③ (01010-81230) and bolts ④ (01010-81225). (Tightening torque: 98 – 123 Nm)

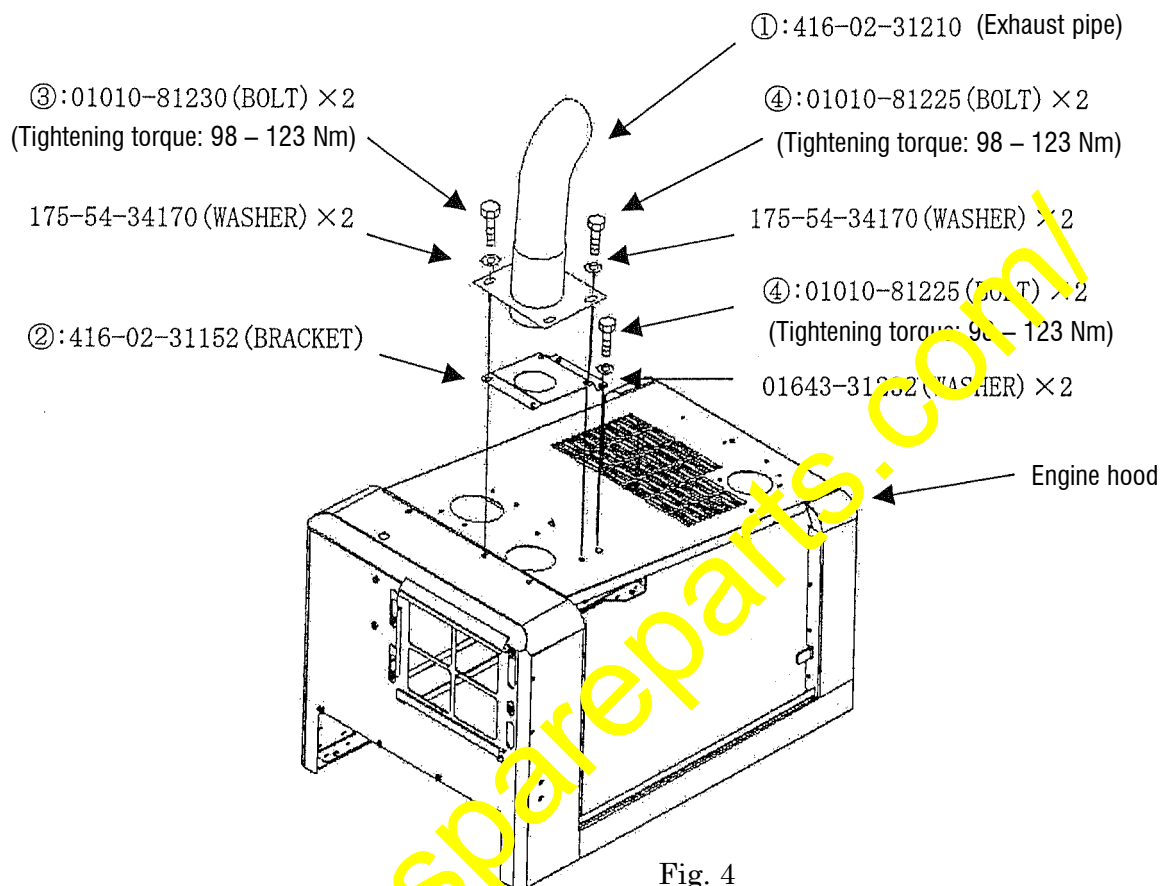

<Precautions for the installation work>

Install the above parts ① and ② securing a circumferential clearance (※) of 20 mm or more around the outlet port pipe of the muffler.

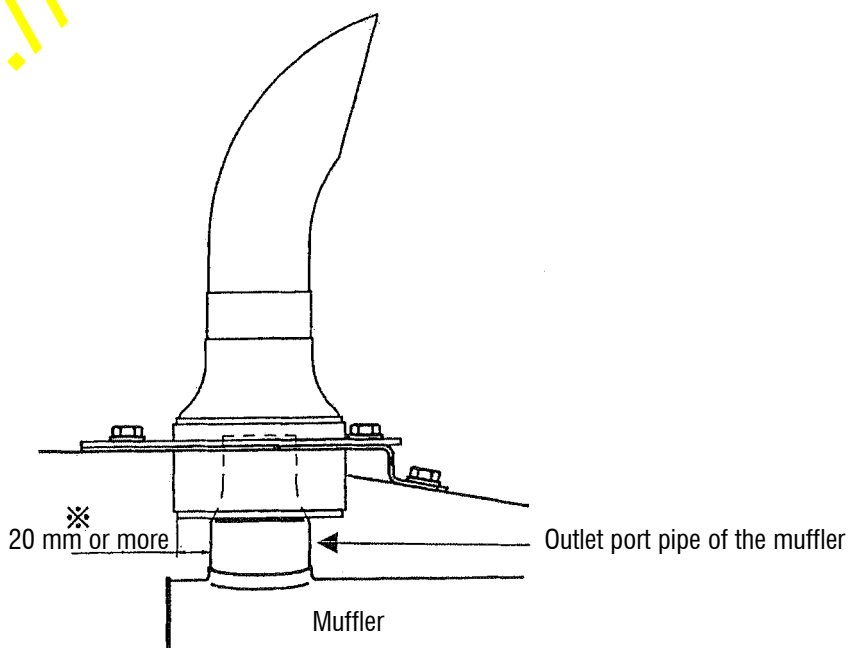

Table of shipments of the WA150-5 (as of '04. 3. 10)

Applicable machines in overseas markets: 9 machines in total (Operator's cab spec. machines)

No.			Destination
1	WA150-5	65059	Australia
2	WA150-5	65060	Miami
3	WA150-5	65061	Miami
4	WA150-5	65062	Hannover (Germany)
5	WA150L-5	65063	U.S.A.
6	WA150-5	65064	Australia
7	WA150-5	65064	Australia
8	WA150-5	65065	Australia
9	WA150-5	65066	Australia

<https://hespareparts.com/>