

PARTS & SERVICE NEWS

REF NO.	AT04089
DATE	Apr. 21, 2004

(C) Page 1 of 4

SUBJECT: MODIFICATION PROCEDURE FOR HOIST CONTROL VALVE ON HM300-1

PURPOSE: To introduce modification procedure to correct the mounting direction of the solenoid of the hoist control valve on HM300-1 articulated dump trucks

APPLICATION: HM300-1 Articulated Dump Trucks, Serial Nos. 1001 thru 1023

FAILURE CODE: DW73MV

DESCRIPTION:

1. Introduction

Regarding the mounting direction of the solenoid of the hoist control valve on the HM300-1 articulated dump trucks, when the cable is directed upward, interference may occur between the cable and the heater hose.

Therefore, change the mounting direction of the solenoid following the modification procedure described in this Service News to prevent the occurrence of the above mentioned interference.

2. List of parts

Part No.	Part Name	Purpose of part	Q'ty	Remarks
<p>Since this modification is only to change the mounting direction of the solenoid the current solenoid can be reused. New parts are not necessary at all.</p>				
56B-43-12401 (56B-43-12403)	Valve Ass'y (Valve Ass'y)	Rework	1 (1)	

3. Details of the modification

To avoid the interference between the cable of the solenoid of the hoist control valve and the heater hose, change the mounting direction of the solenoid turning it by 90° as seen in the pictures below.

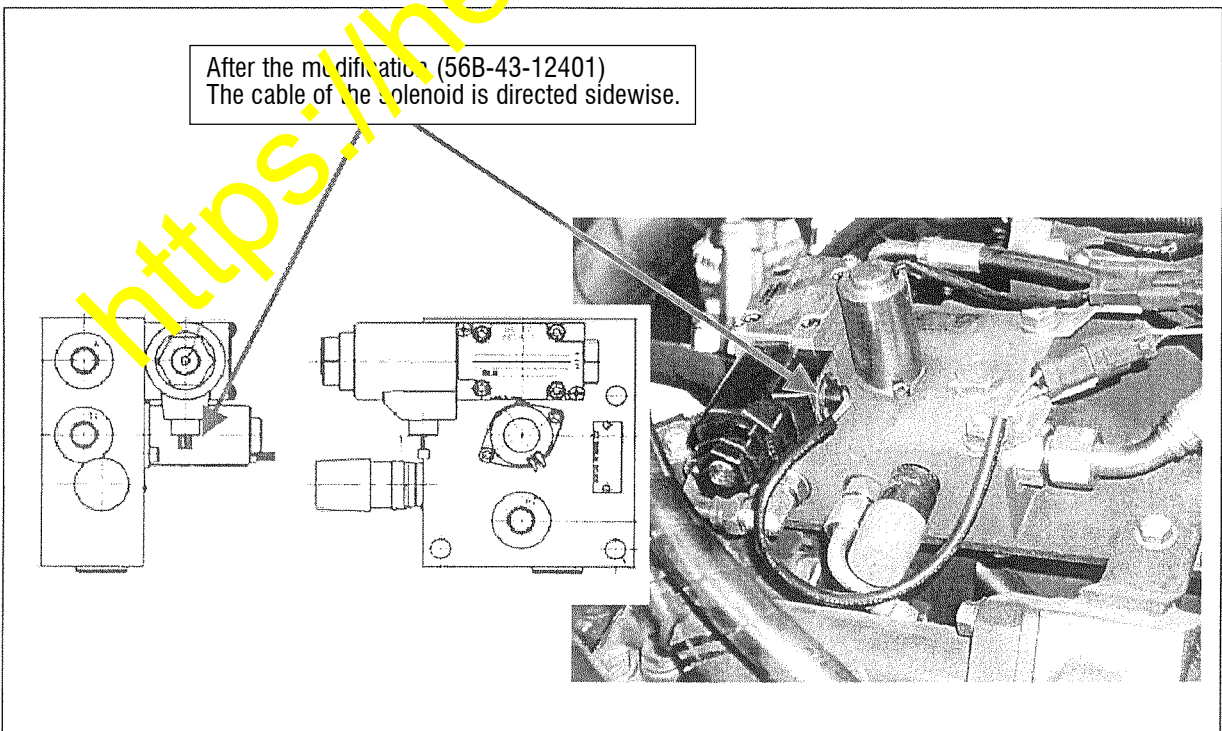
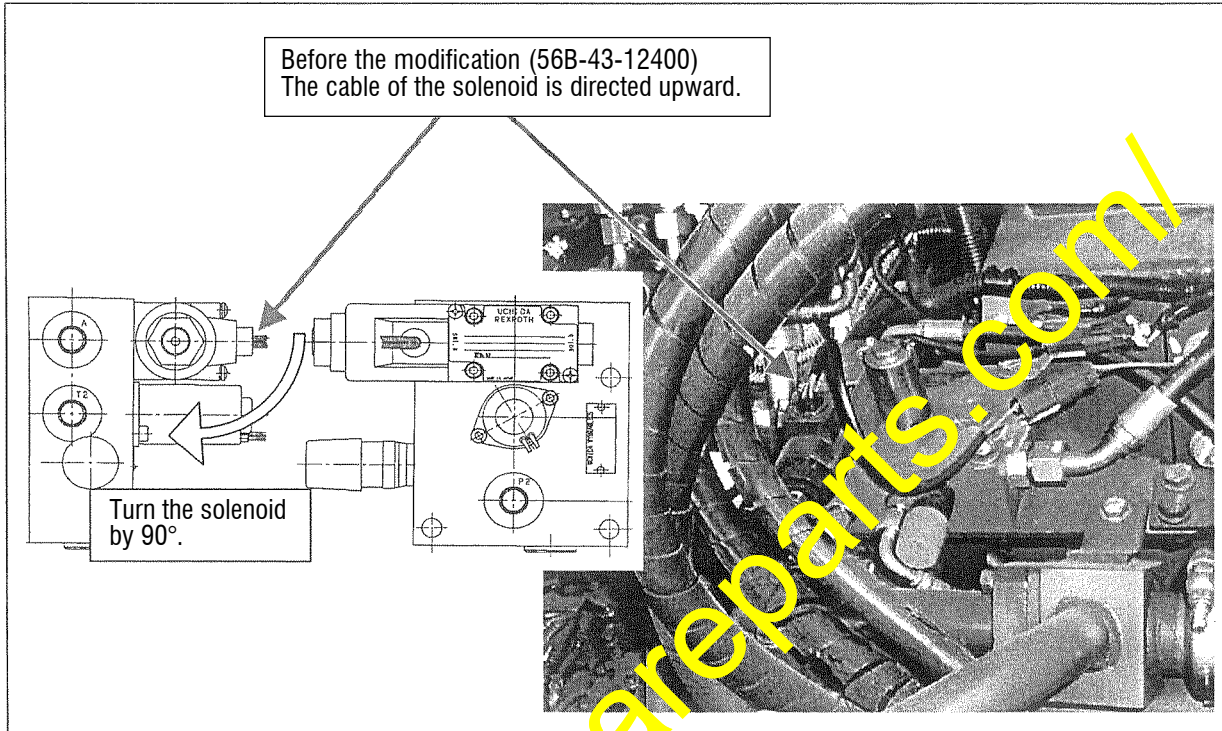

Fig. 1

4. Modification procedure

- 4-1. Park the vehicle on a flat place, turn ON the parking brake switch, and after that, apply chocks to each tire.
- 4-2. Tilt up the operator's cab and lock it to the position with the lock bar.
For safety, keep the operator's cab hoisted up by the crane.

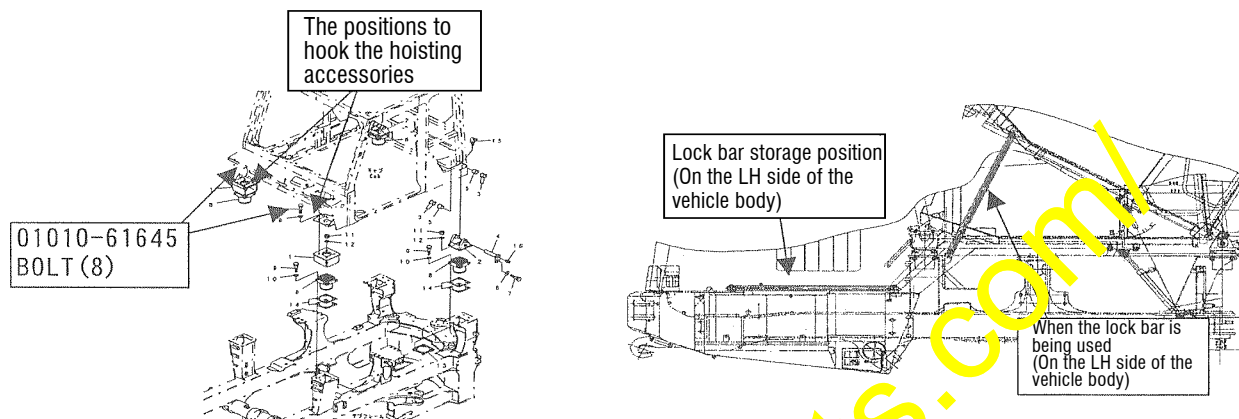

Fig. 2

4-3. Change the mounting direction of the solenoid as follows:

- (1) Remove the nut ①.
- (2) Turn the solenoid ② by 90° to change its mounting direction from upward to side-wise.

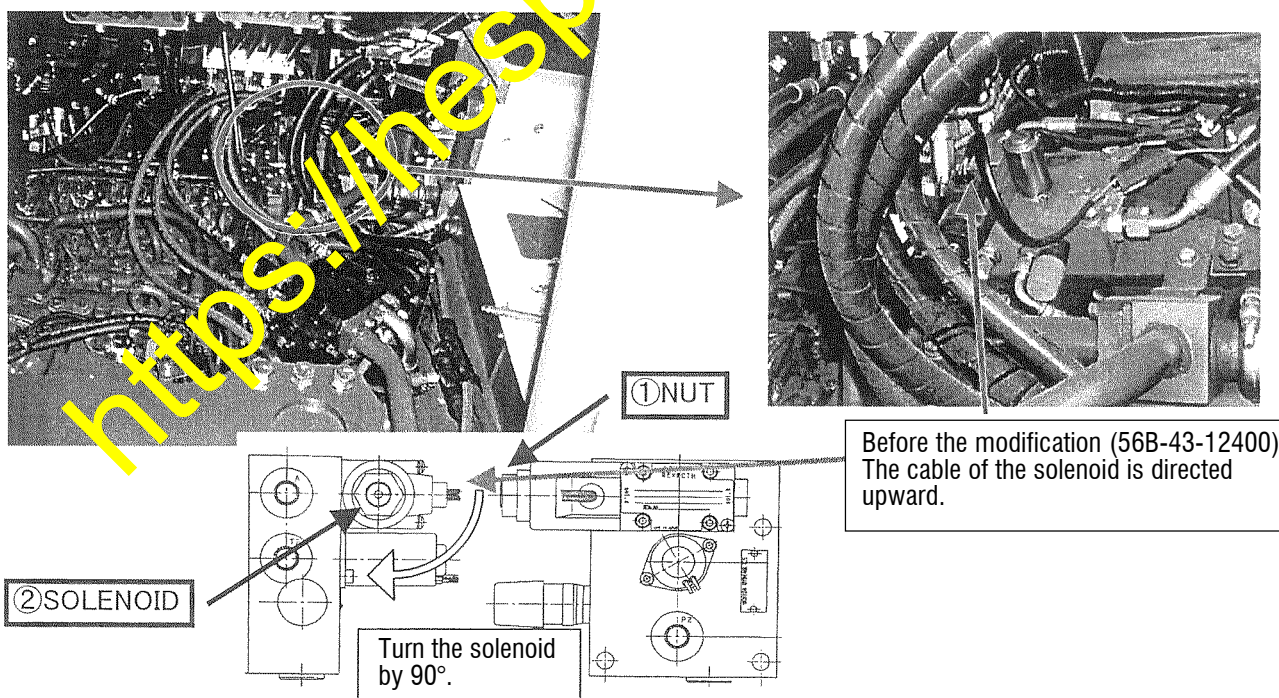

Fig. 3

Before turning the solenoid ②, pull it out by 20 mm or more. After that, turn the solenoid by 90°.

Be careful not to lose the O-rings ③ and ⑤, and the washer ④.

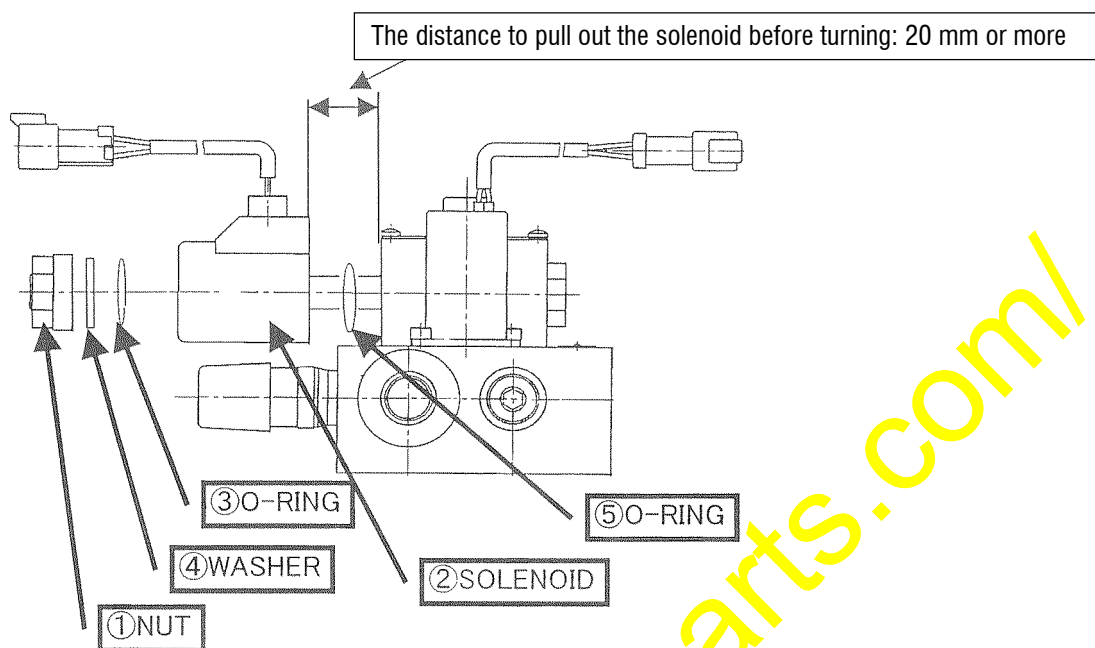

Fig. 4

(3) Install the solenoid ②, O-rings ③ and ⑤ and washer ④. Tighten them using the nut ①.

(Tightening torque for the nut: 3.42 - 4.91 Nm {0.4 - 0.5 kgm})

Carry out the above installation work carefully with the O-rings ③ and ⑤ not dislocated nor pinched.

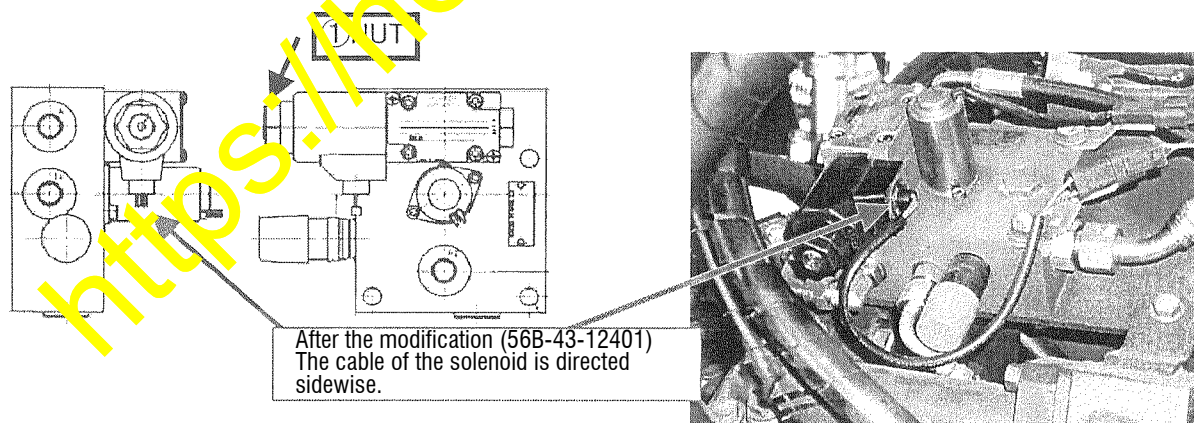

Fig. 5

5. Lower the operator's cab and fix it to the lowered position.
6. After finishing the modification work, carry out hoisting operations to check the function of each operation of "UP", "DOWN", "HOLD" and "FLOAT".