

# PARTS & SERVICE NEWS

REF NO.	AT04822
DATE	Jun. 14, 2004
(C) Page 1 of 18	

**SUBJECT:** IMPROVED LOW PRESSURE HYDRAULIC HOSE FOR WA500-3

**PURPOSE:** To introduce improved low pressure hydraulic hoses with increased pressure resistance for use on WA500-3 wheel loaders

**APPLICATION:** WA500-3 Wheel Loaders, Serial Nos. 50001 and up  
(Tier1)  
Serial Nos. 52001 and up  
(Tier2)

**FAILURE CODE:** 601LDA

## DESCRIPTION:

### 1. Introduction

KOMATSU has modified the 30 kg/cm<sup>2</sup> low pressure hose to 70 kg/cm<sup>2</sup> hose or to 140 kg/cm<sup>2</sup> hose to improve the reliability and is introducing the improved low pressure hydraulic hoses for use on WA500-3 wheel loaders in this Service News.

After this, when locally replacing the low pressure hydraulic hoses for periodical changes, for deterioration or for breakage, follow the modification procedure described in this Service News to replace them with the new hoses.

## CONTENTS

2. Lists of parts .....	Pages 2 thru 4
3. Steering pilot line .....	Pages 5 thru 7
4. Parking brake line .....	Pages 8 thru 9
5. Brake control line .....	Pages 10 thru 11
6. Torque converter & transmission oil cooler line .....	Pages 12 thru 13
7. Steering oil cooler line .....	Page 14
8. PPC line .....	Pages 15 thru 18

## 2. List of parts

Part No.	Part Name	Q'ty	Remarks
07108-20325 (07102-20325)	Hose (Hose)	1 (1)	} Parts being replaced on page 5.
07108-203A4 (07102-203A4)	Hose (Hose)	1 (1)	
07108-20314 (07102-20314)	Hose (Hose)	1 (1)	
07108-20317 (07102-20317)	Hose (Hose)	1 (1)	
07108-20330 (07102-20330)	Hose (Hose)	1 (1)	} Parts being replaced on page 6.
07108-20304 (07102-20304)	Hose (Hose)	1 (1)	
07108-20314 (07102-20314)	Hose (Hose)	1 (1)	
07108-20317 (07102-20317)	Hose (Hose)	1 (1)	
07624-00306 (07621-00306)	Hose (Hose)	2 (2)	} Parts being replaced on page 7.
07108-20304 (07102-20304)	Hose (Hose)	1 (1)	
07624-00319 (07621-00319)	Hose (Hose)	1 (1)	
07108-20303 (07102-20303)	Hose (Hose)	1 (1)	
07624-003A6 (07621-003A6)	Hose (Hose)	1 (1)	} Parts being replaced on page 8.
07624-00318 (07621-00318)	Hose (Hose)	1 (1)	
07626-00221 (07623-00221)	Hose (Hose)	1 (1)	
07624-00320 (07621-00320)	Hose (Hose)	1 (1)	
04434-51310 (04434-51610)	Clip (Clip)	2 (2)	} Parts being replaced on page 9.
04434-51510 (04434-52110)	Clip (Clip)	4 (4)	
04434-51510 (04434-51910)	Clip (Clip)	1 (1)	
07624-00319 (07102-20319)	Hose (Hose)	1 (1)	

Part No.	Part Name	Q'ty	Remarks
07624-00223 (07102-20223)	Hose (Hose)	1 (1)	} Parts being replaced on page 9.
07624-00321 (07102-20321)	Hose (Hose)	1 (1)	
04434-51310 (04434-51610)	Clip (Clip)	2 (2)	
04434-51510 (04434-51910)	Clip (Clip)	1 (1)	
04434-51510 (04434-52110)	Clip (Clip)	2 (2)	
04434-51510 (04434-52212)	Clip (Clip)	1 (1)	
01435-01040 (01435-01016)	Bolt (Bolt)	1 (1)	} Parts being replaced on page 10.
423-54-11340	Spacer	1	
425-43-27510 (421-35-14110)	Hose (Hose)	1 (1)	} Parts being replaced on page 11.
07108-210A4 (07621-210A4)	Hose (Hose)	2 (2)	} Parts being replaced on page 12.
07108-21021 (07102-21021)	Hose (Hose)	1 (1)	
07108-21022 (07102-21022)	Hose (Hose)	1 (1)	
07108-21022 (07102-21022)	Hose (Hose)	1 (1)	} Parts being replaced on page 13.
07108-21026 (07102-21026)	Hose (Hose)	1 (1)	
07108-21027 (07102-21027)	Hose (Hose)	2 (2)	} Parts being replaced on page 14.
07108-21028 (07102-21028)	Hose (Hose)	2 (2)	
425-S31-2161 (425-S31-2160)	Hose (Hose)	1 (1)	} Parts being replaced on page 15.
425-62-23381 (425-62-23380)	Hose (Hose)	1 (1)	
425-877-2221 (425-877-2220)	Hose (Hose)	1 (1)	
425-62-23481 (425-62-23480)	Hose (Hose)	1 (1)	
425-877-2331 (425-877-2330)	Hose (Hose)	1 (1)	} Parts being replaced on page 16.

Part No.	Part Name	Q'ty	Remarks
425-877-2341 (425-877-2340)	Hose (Hose)	1 (1)	} Parts being replaced on page 16.
425-877-2221 (425-877-2220)	Hose (Hose)	1 (1)	
425-877-2351 (425-877-2350)	Hose (Hose)	1 (1)	
425-877-2221 (425-877-2220)	Hose (Hose)	1 (1)	
425-62-23381 (425-62-23380)	Hose (Hose)	1 (1)	
425-62-23381 (425-62-23380)	Hose (Hose)	2 (2)	} Parts being replaced on page 17.
425-S31-2161 (425-S31-2160)	Hose (Hose)	1 (1)	
425-877-2221 (425-877-2220)	Hose (Hose)	2 (2)	
425-62-23481 (425-62-23480)	Hose (Hose)	1 (1)	
425-S31-2161 (425-S31-2160)	Hose (Hose)	2 (2)	
07108-20312 (07102-20312)	Hose (Hose)	1 (1)	} Parts being replaced on page 18.
07108-20314 (07102-20314)	Hose (Hose)	1 (1)	

<https://thespareparts.com/>

3. Steering pilot line (1/3)

Replace the hoses as per the instructions given in Fig. 1.

Serial numbers of the applicable machines: #52001 and after (Tier-2 Engine spec.)

Standard spec. machines

Tightening torque  
#03 hose: 59 – 98 Nm (6.0 – 10.0 kgf)

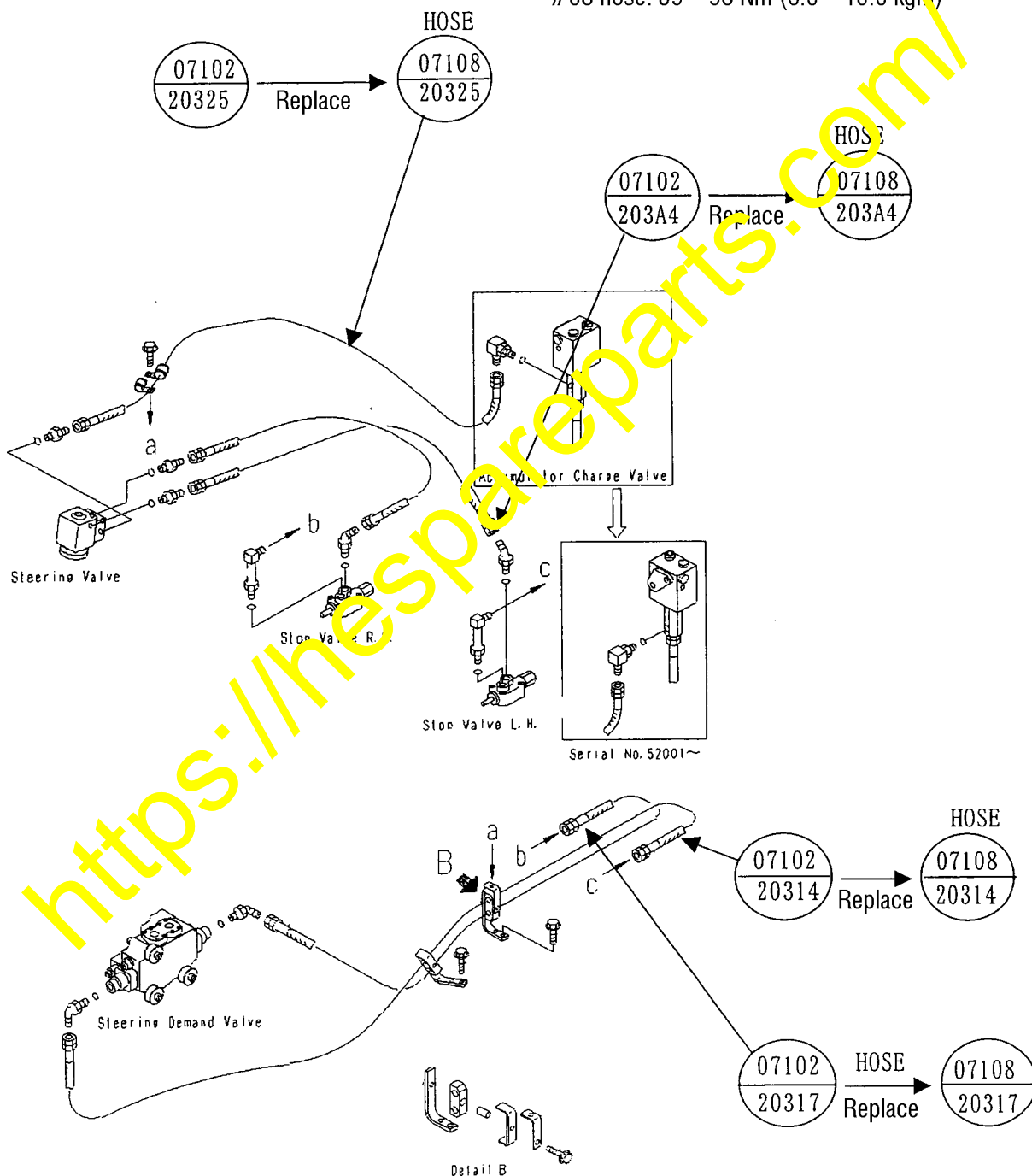

Fig. 1

3. Steering pilot line (2/3)

Replace the hoses as per the instructions given in Fig. 2.

Serial numbers of the applicable machines: #50001 – 51999 (Tier-1 Engine spec.)

Standard spec. machines

Tightening torque  
#03 hose: 59 – 98 Nm (6.0 – 10.0 kg.m)

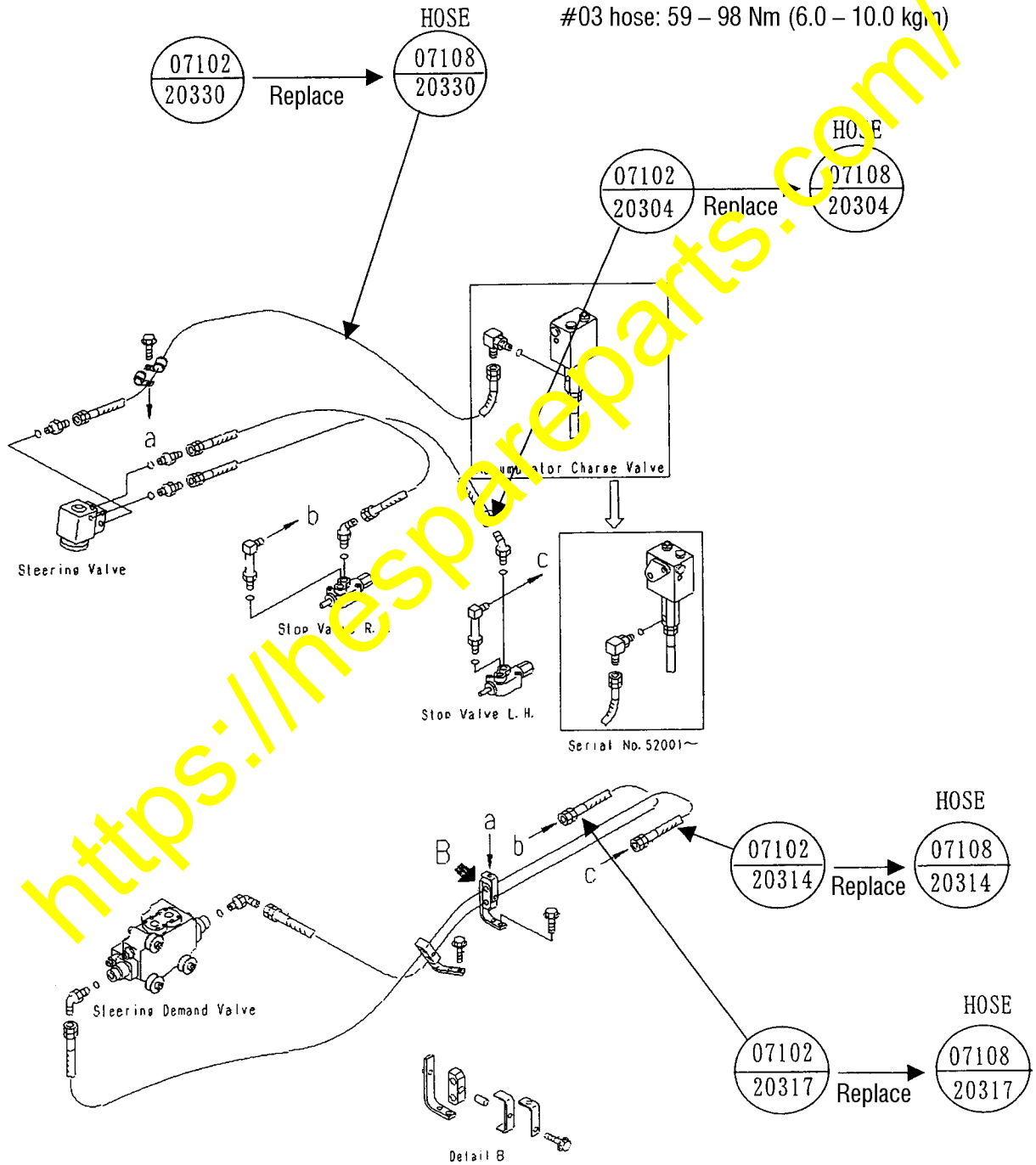

Fig. 2

3. Steering pilot line (3/3)

Replace the hoses as per the instructions given in Fig. 3.

Serial numbers of the applicable machines: #52001 and after (Tier-2 Engine spec.)

Machines equipped with the optional joystick steering control lever

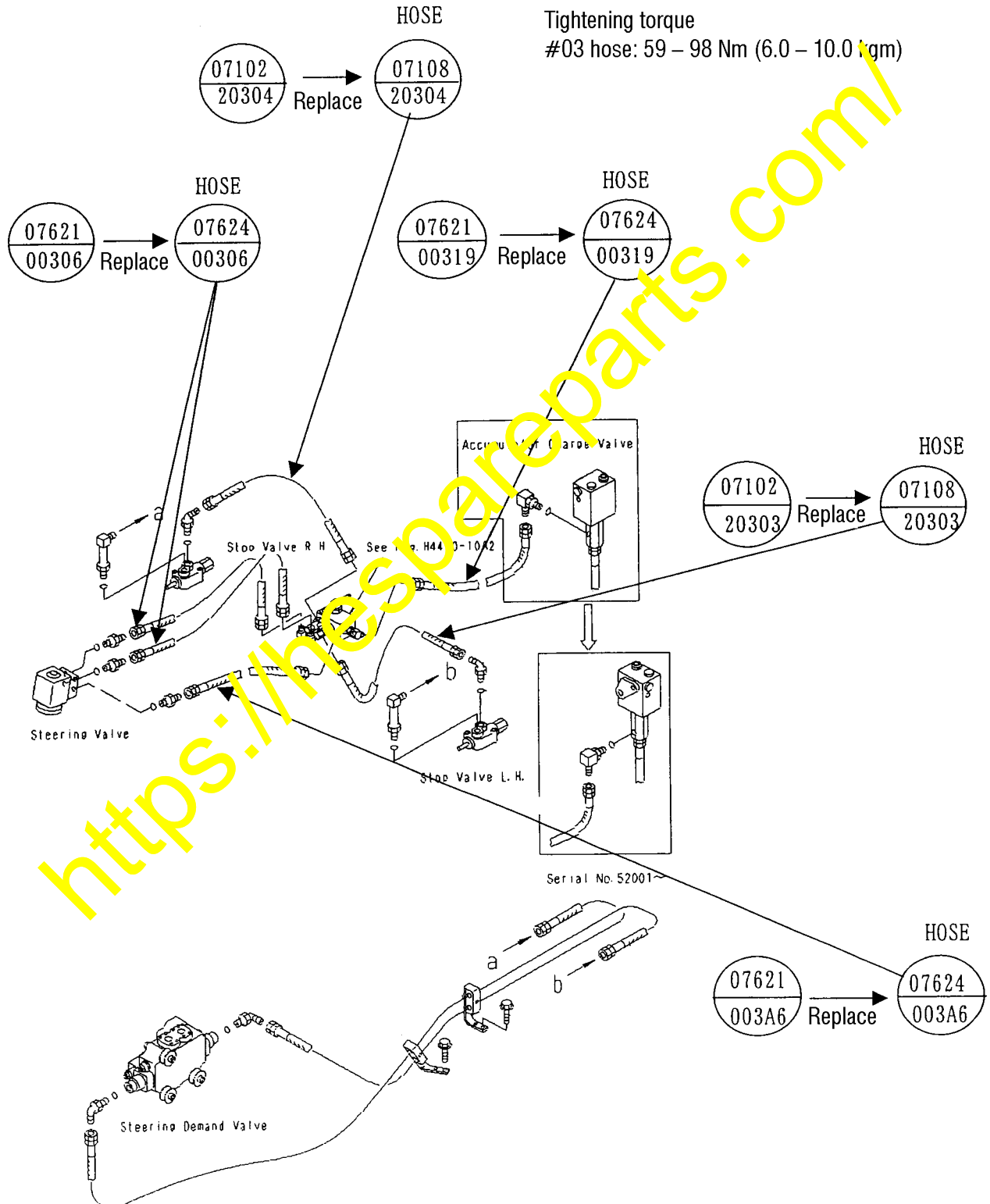

Fig. 3

4. Parking brake line (1/2)

Replace the hoses and clips as per the instructions given in Fig. 4.

Serial numbers of the applicable machines: #52001 and after (Tier-2 Engine spec.)

Standard spec. machines

Tightening torque

#02 hose: 35 – 63 Nm (3.5 – 6.5 kgm)

#03 hose: 59 – 98 Nm (6.0 – 10.0 kgm)

M10 bolts:  $66 \pm 7$  Nm ( $6.7 \pm 0.7$  kgm)

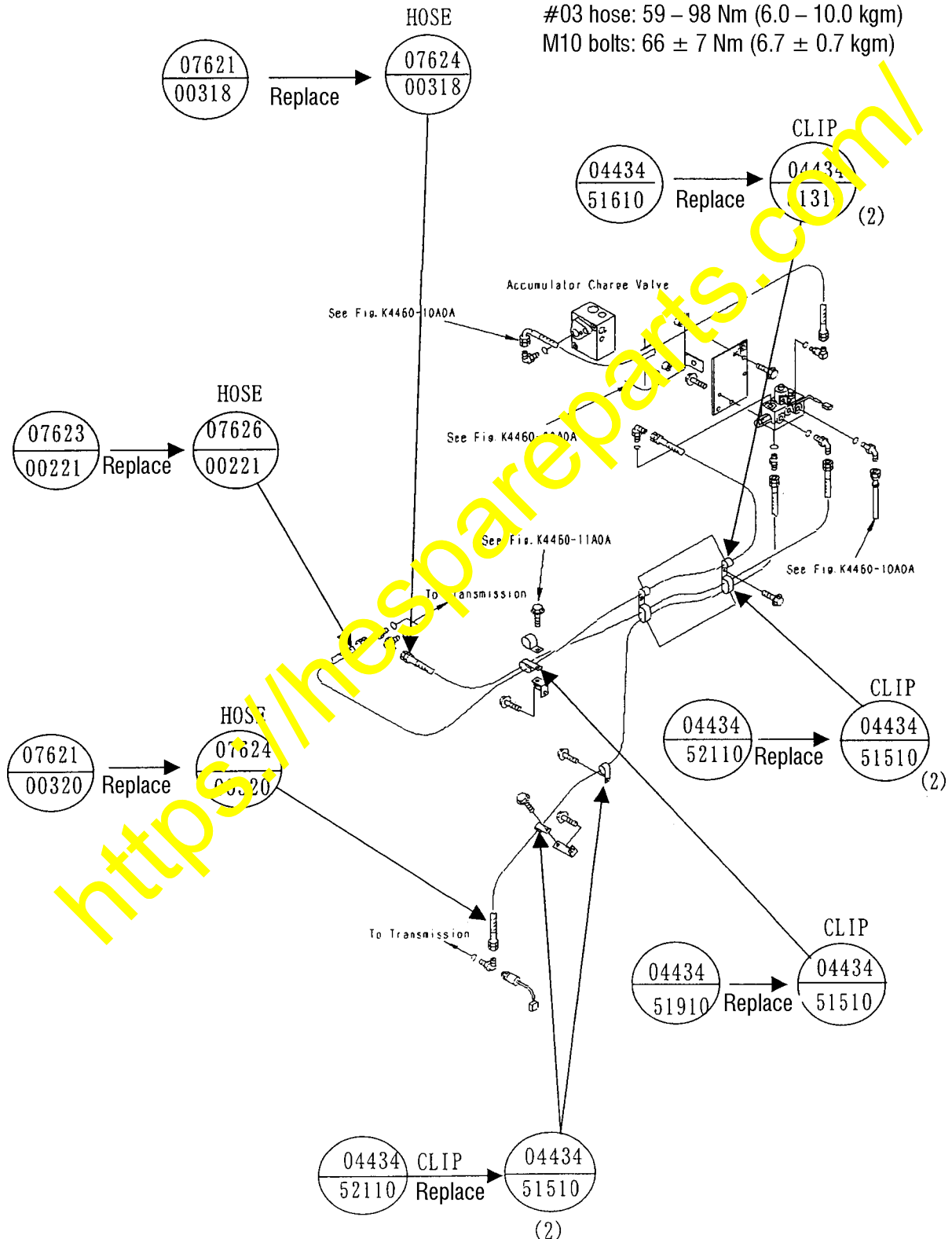

Fig. 4



4. Parking brake line (2/2)

Replace the hoses and clips as per the instructions given in Fig. 5.

Serial numbers of the applicable machines: #50001 – #51999 (Tier-1 Engine spec.)

Standard spec. machines

Tightening torque

#02 hose: 35 – 63 Nm (3.5 – 6.5 kgm)

#03 hose: 59 – 98 Nm (6.0 – 10.0 kgm)

M10 bolts: 66 ± 7 Nm (6.7 ± 0.7 kgm)

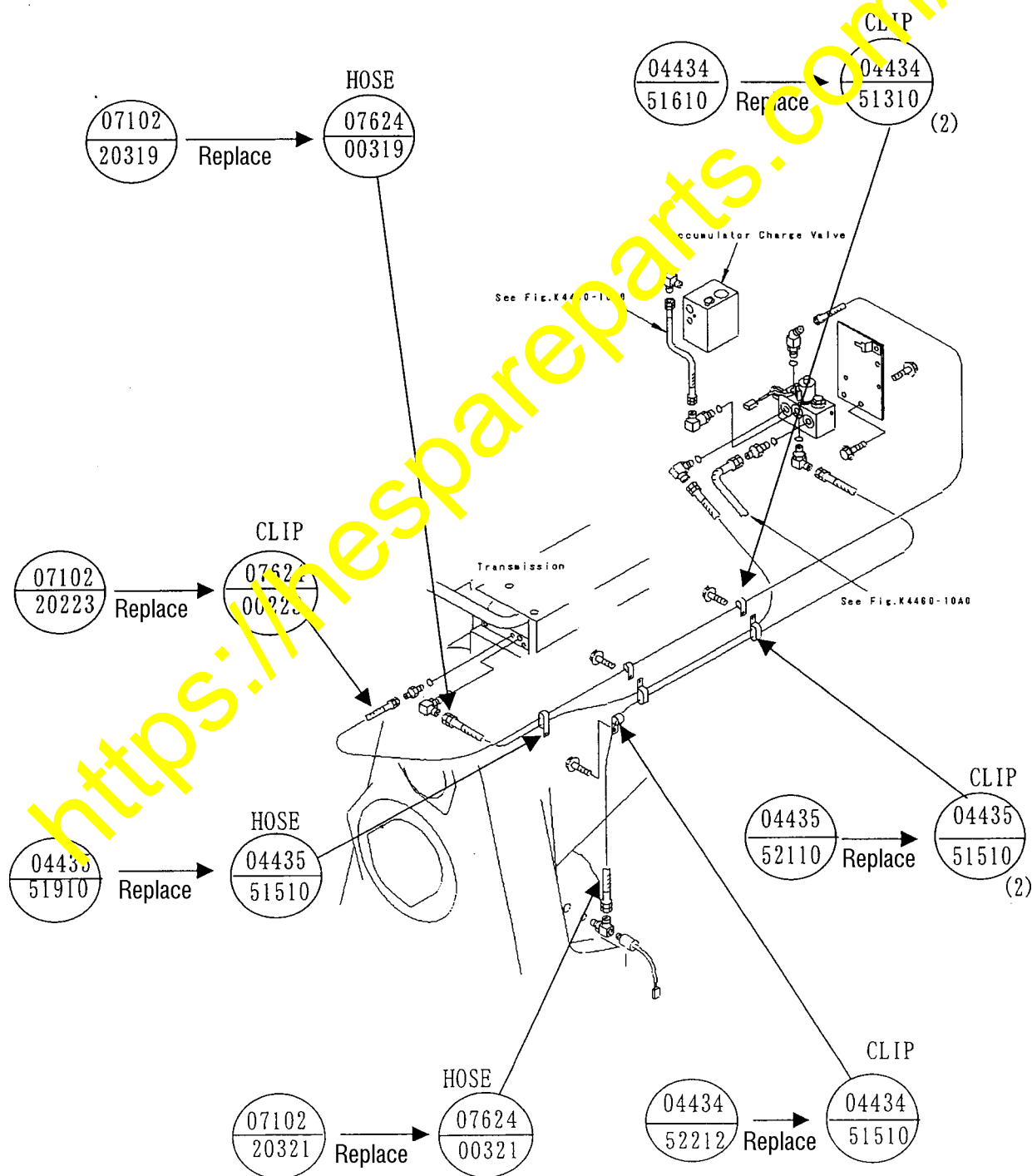

Fig. 5

5. Brake control line (1/2)

Add the spacer as per the instructions given in Fig. 6.

Serial numbers of the applicable machines: #50001 and after (Tier-1 & 2 Engine spec.)

Standard spec. machines

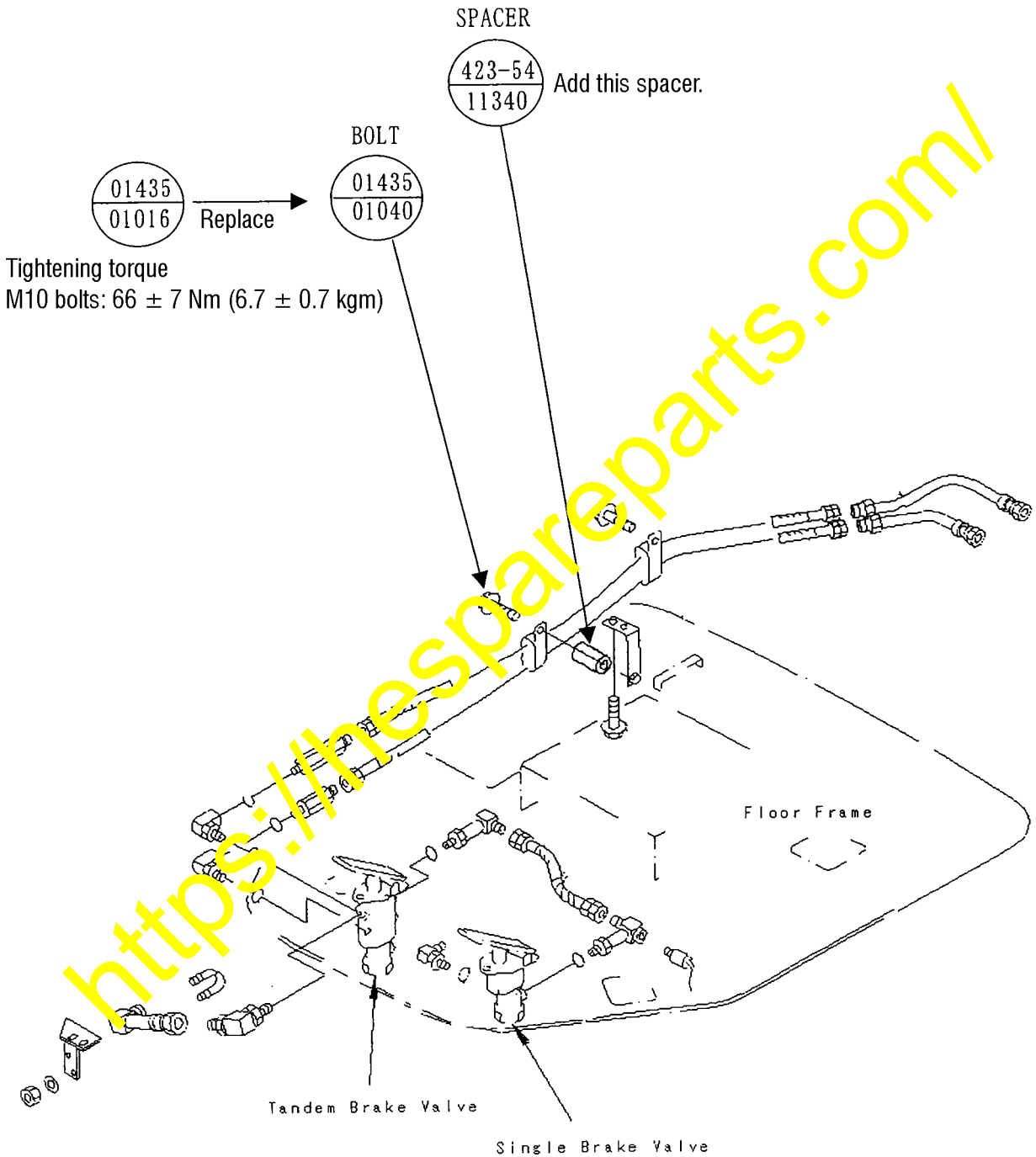

Fig. 6

PJE38238

5. Brake control line (2/2)

Replace the hose as per the instructions given in Fig. 7.

Serial numbers of the applicable machines: #50001 and after (Tier-1 & 2 Engine spec.)

Standard spec. machines

Tightening torque  
#04 hose: 84 – 132 Nm (8.5 – 13.5 kgm)

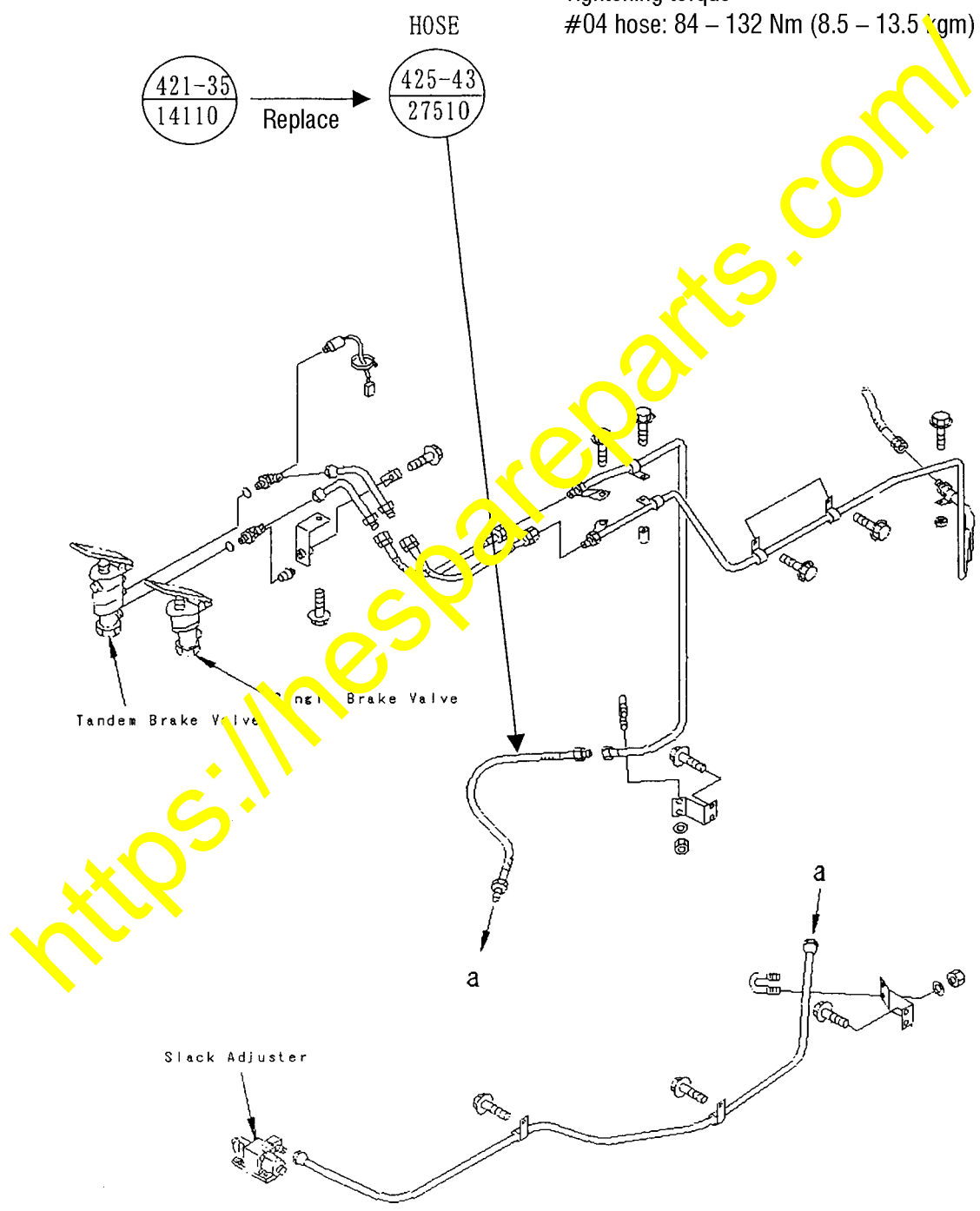

PNE3827

Fig. 7

6. Torque converter & transmission oil cooler line (1/2)

Replace the hoses as per the instructions given in Fig. 8.

Serial numbers of the applicable machines: #52001 and after (Tier-2 Engine spec.)

Standard spec. machines

Tightening torque  
#10 hose: 177 – 245 Nm (18 – 25 kgm)

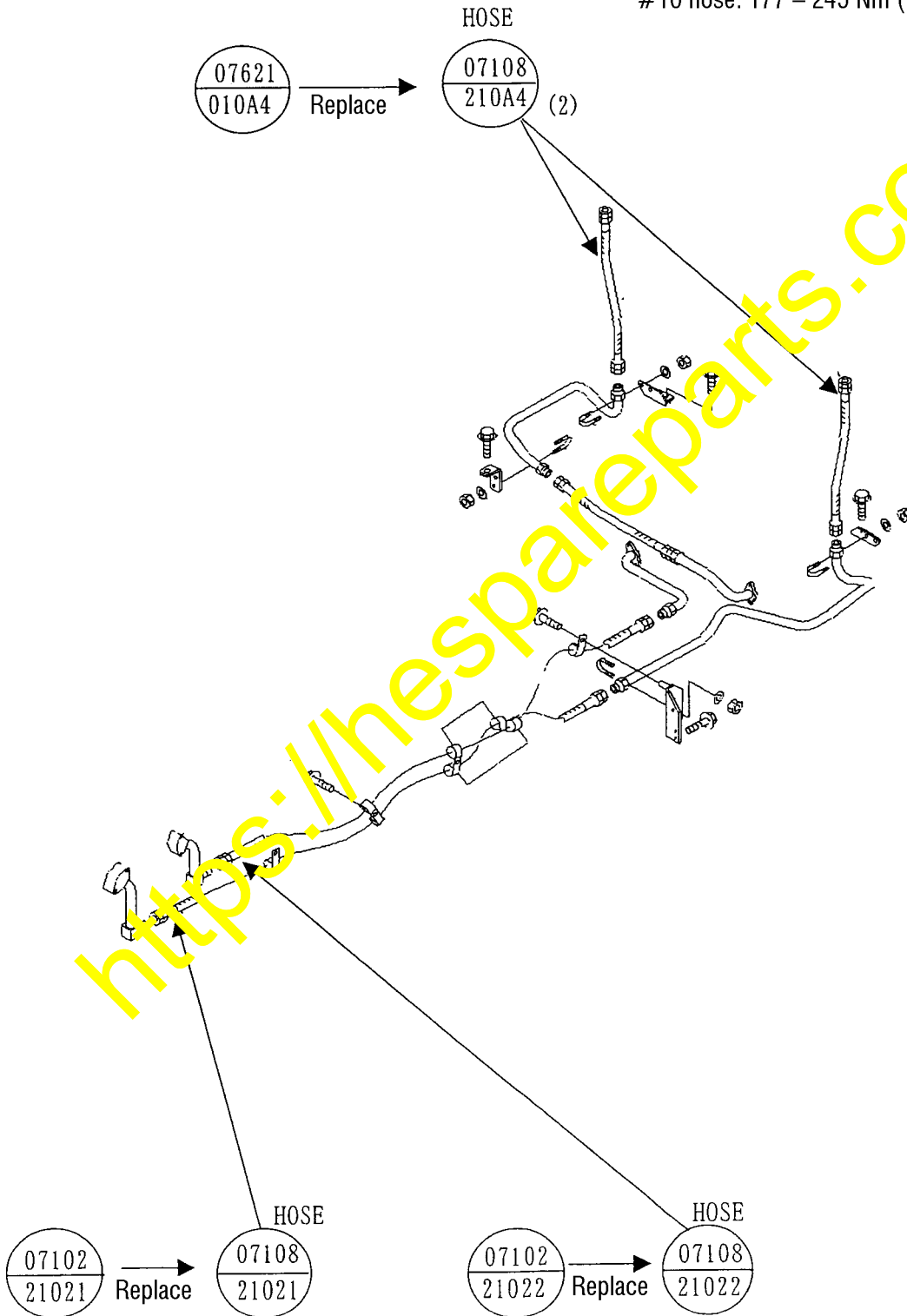

Fig. 8

6. Torque converter & transmission oil cooler line (2/2)

Replace the hoses as per the instructions given in Fig. 9.

Serial numbers of the applicable machines: #50001 – #51999 (Tier-1 Engine spec.)

Standard spec. machines

Tightening torque  
#10 hose: 177 – 245 Nm (18 – 25 kgm)

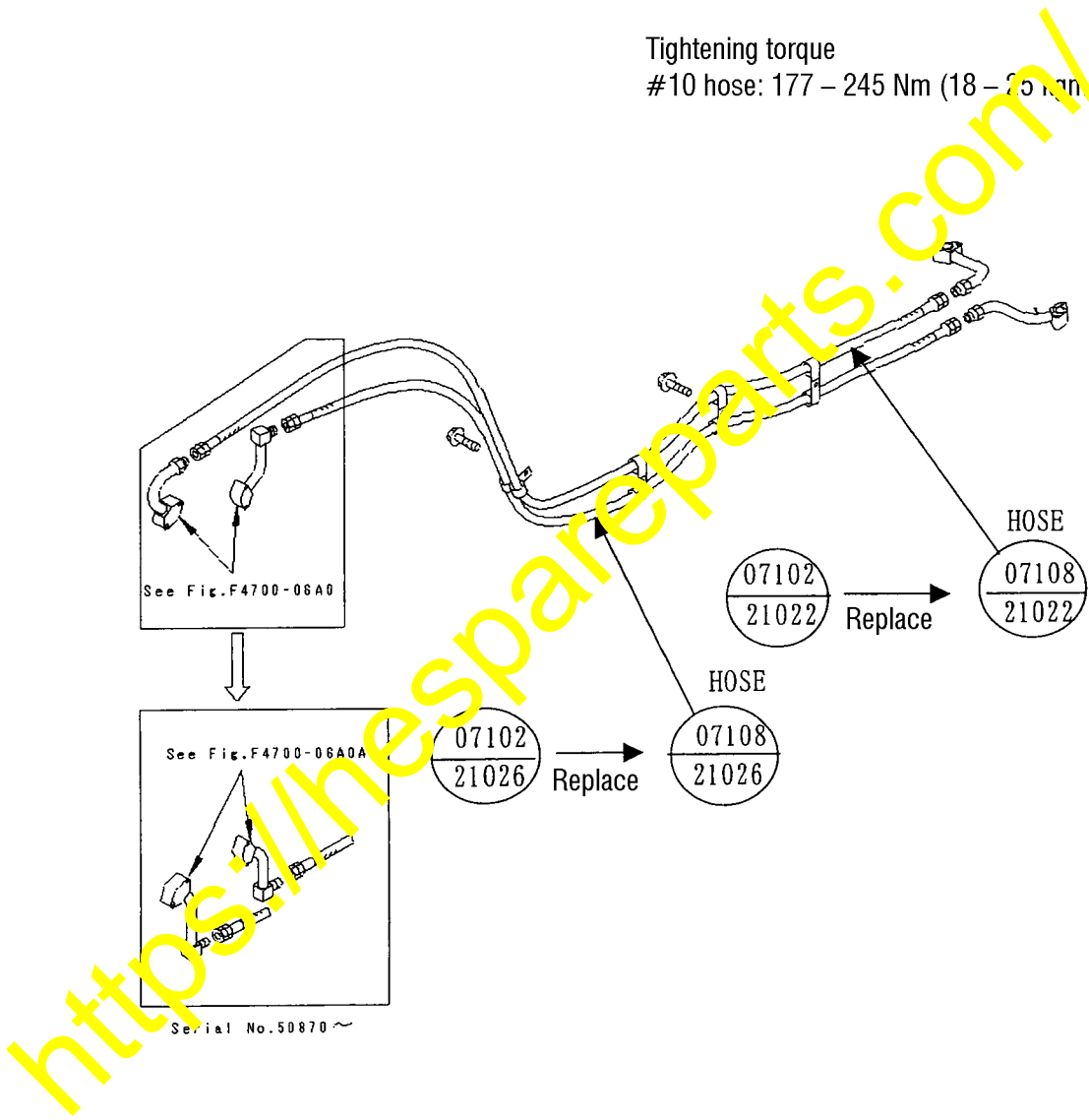

PJ2C231

Fig. 9

7. Steering oil cooler line

Replace the hoses as per the instructions given in Fig. 10.

Refer to the drawing regarding the serial numbers of the applicable machines.  
(Tier-1 & 2 Engine spec.)

Standard spec. machines

Tightening torque  
#10 hose: 177 – 245 Nm (18 – 25 kgm)

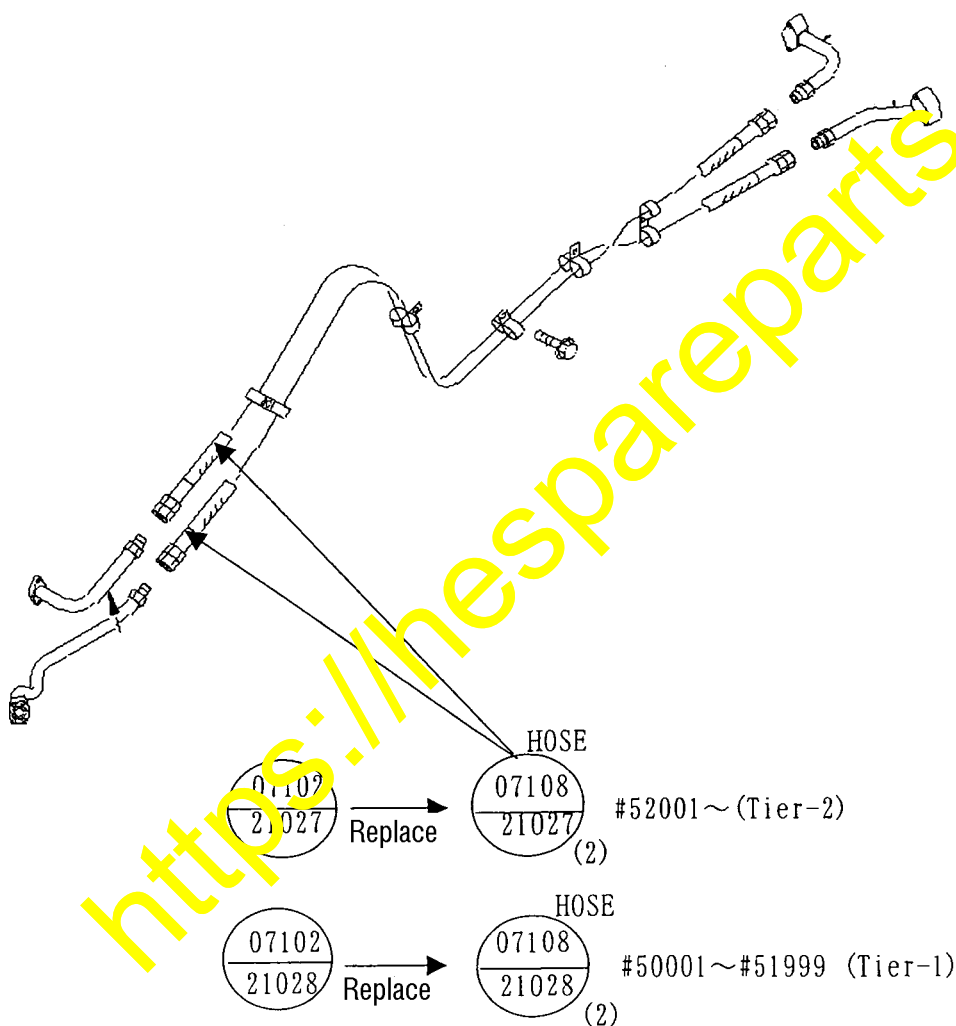

Fig. 10

8. Hydraulic (P.P.C.) line (1/4)

Replace the hoses as per the instructions given in Fig. 11.

Serial numbers of the applicable machines: #50001 and after (Tier-1 & 2 Engine spec.)

Standard spec. machines

Tightening torque  
#03 hose: 59 – 98 Nm (6.0 – 10.0 kgm)

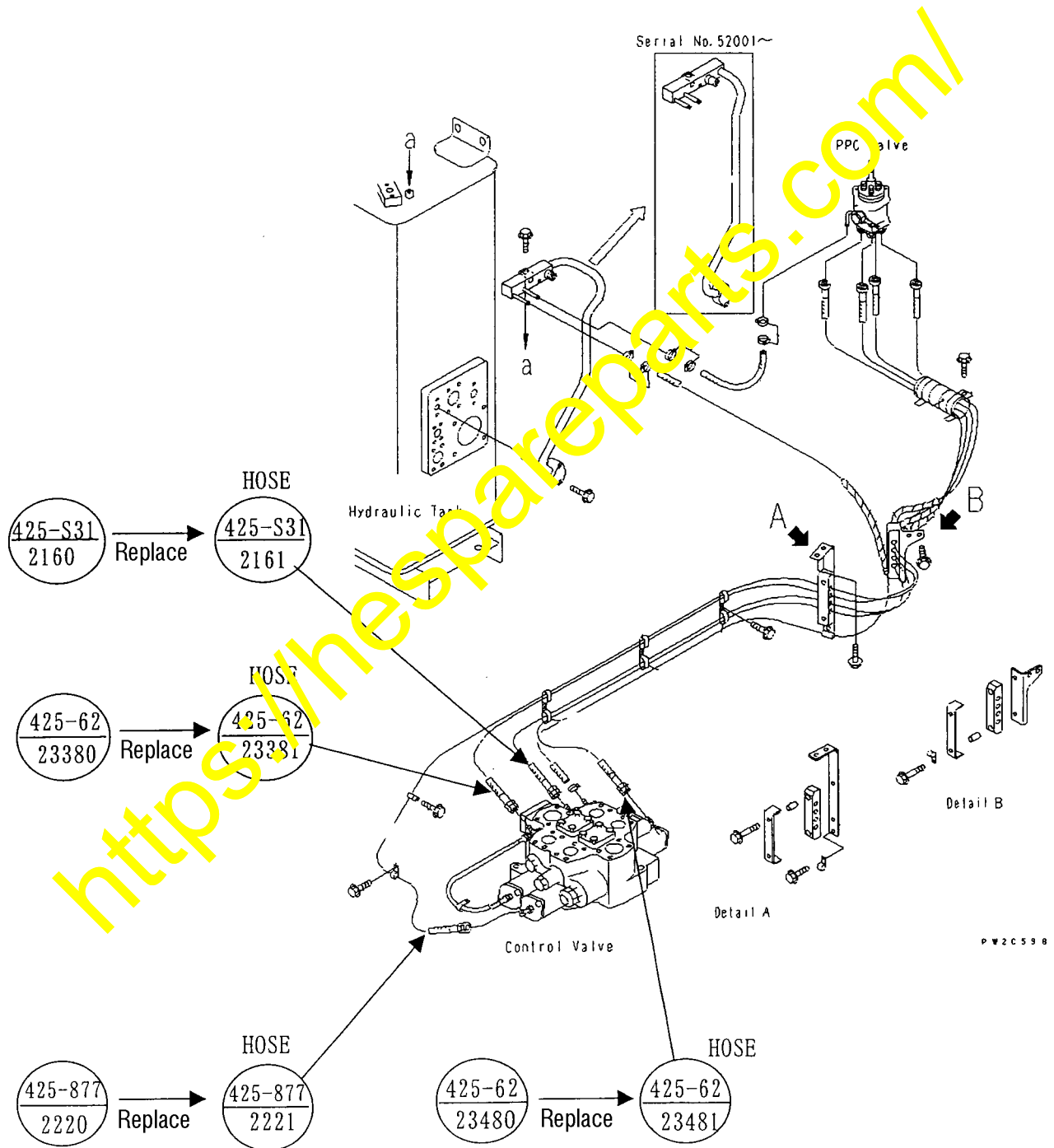

Fig. 11

8. Hydraulic (P.P.C.) line (2/4)

Replace the hoses as per the instructions given in Fig. 12.

Serial numbers of the applicable machines: #52001 and after (Tier-2 Engine spec.)

Machines equipped with the optional 3 spool valve

Tightening torque  
#03 hose: 59 – 98 Nm (6.0 – 10.0 kgm)

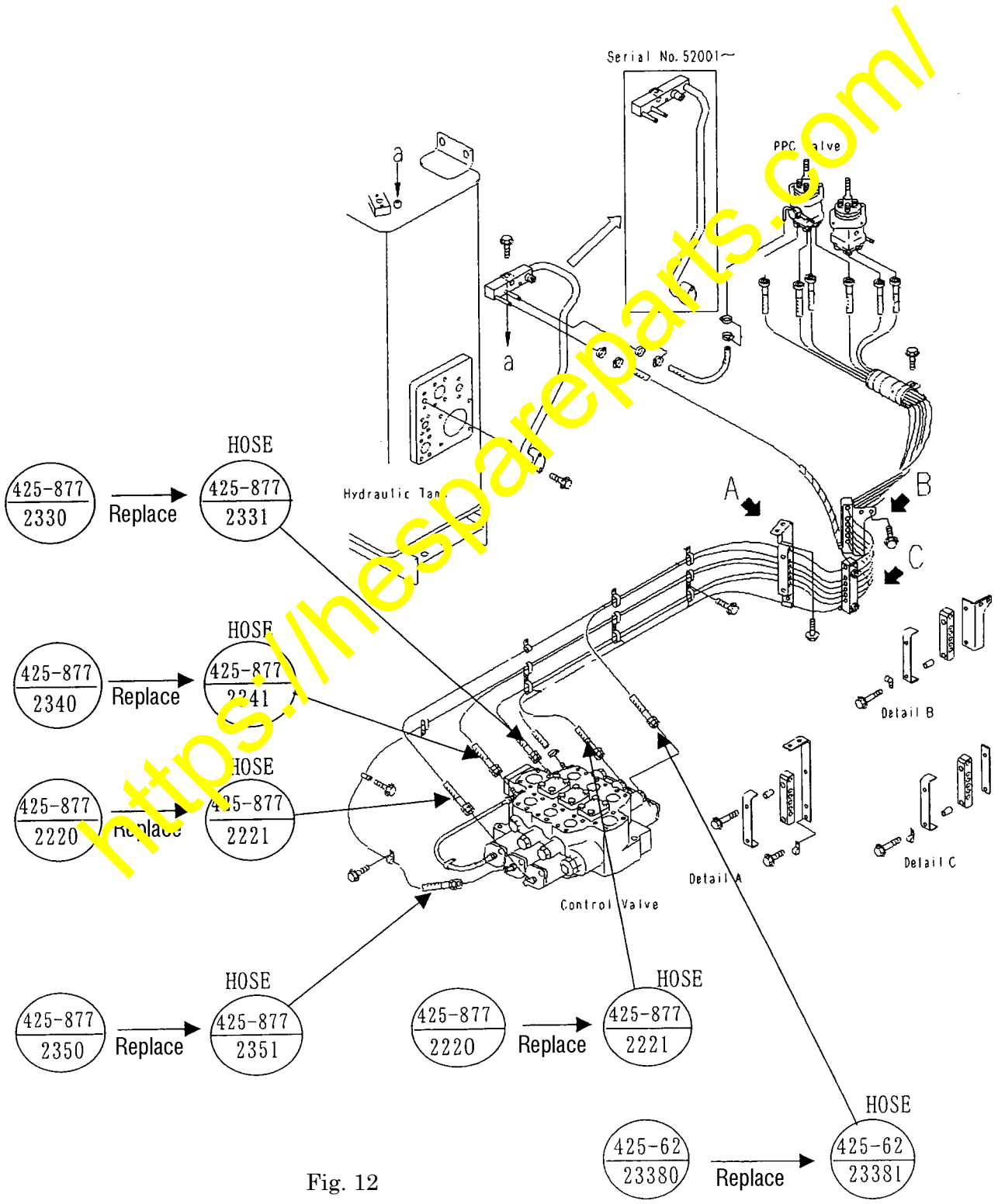

Fig. 12



8. Hydraulic (P.P.C.) line (3/4)

Replace the hoses as per the instructions given in Fig. 13.

Serial numbers of the applicable machines: #50001 – #51999 (Tier-1 Engine spec.)

Machines equipped with the optional 3 spool valve

Tightening torque  
#03 hose: 59 – 98 Nm (6.0 – 10.0 kgm)

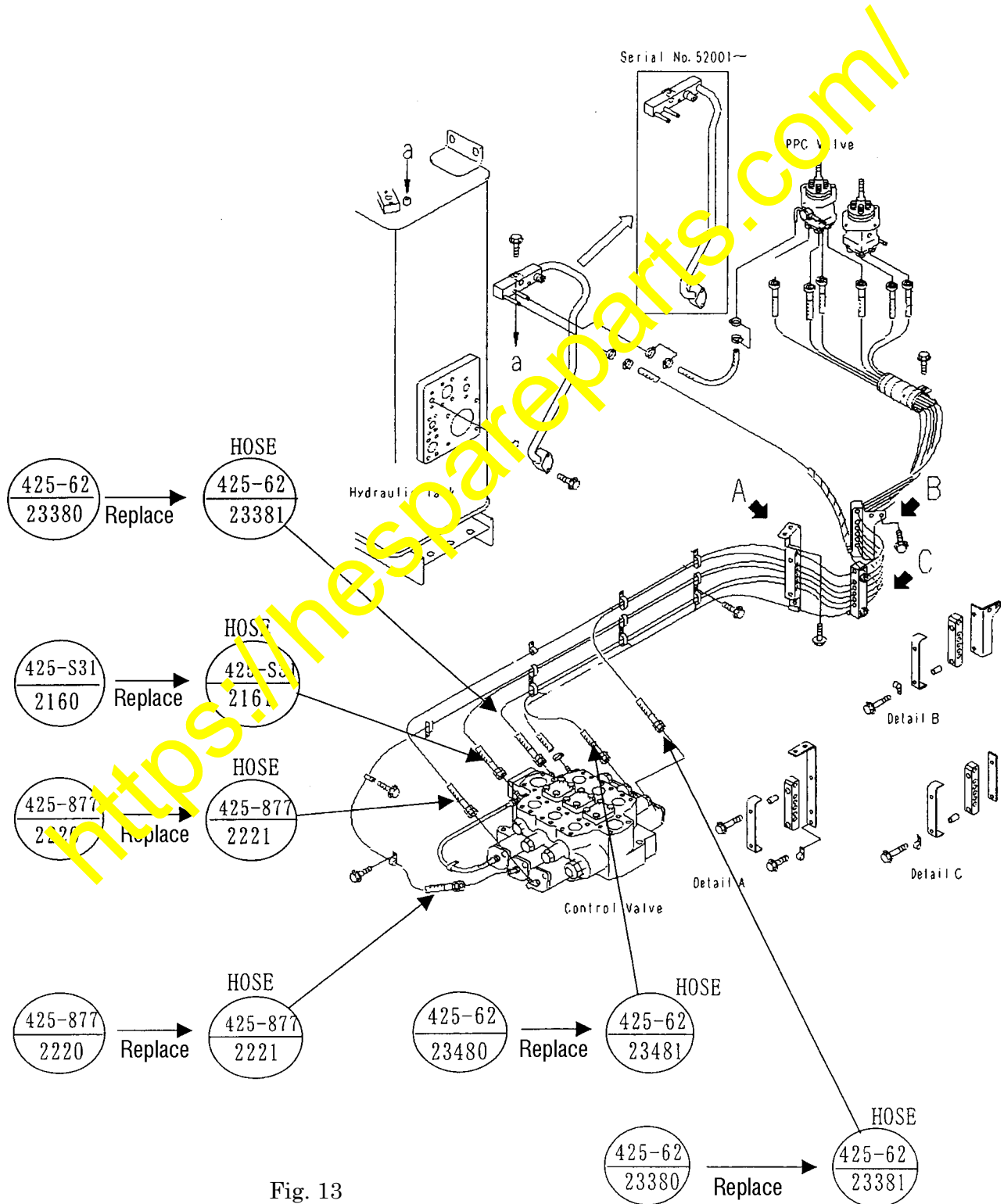

Fig. 13

8. Hydraulic (P.P.C.) line (4/4)

Replace the hoses as per the instructions given in Fig. 14.

Serial numbers of the applicable machines: #50001 and after (Tier-1 & 2 Engine spec.)

Machines equipped with the optional remote positioner

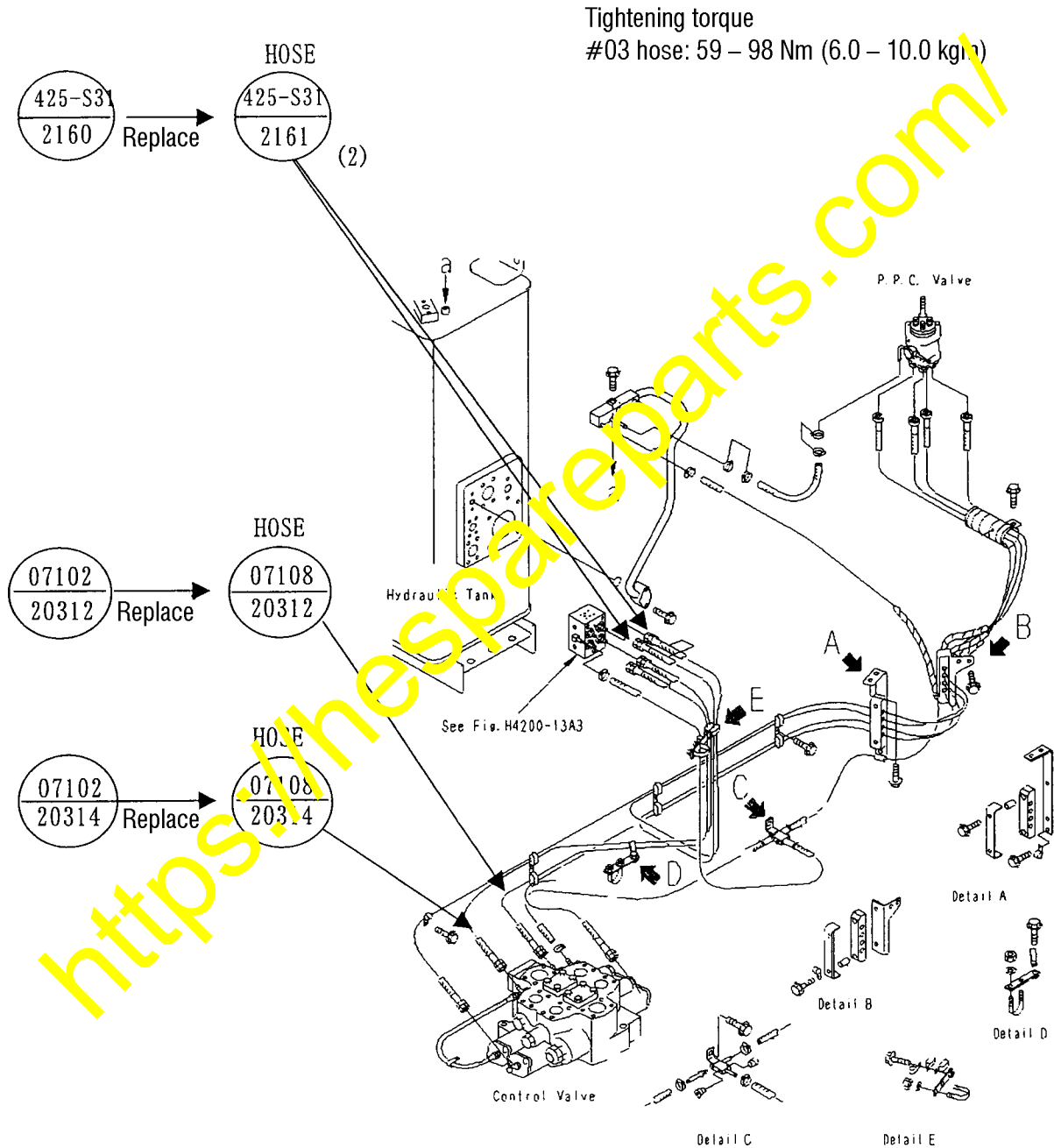

Fig. 14