

PARTS & SERVICE NEWS

REF NO.	AT97129
DATE	August 26, 1997

Page 1 of 2

SUBJECT: IMPROVEMENT SENSOR (ENGINE SPEED) ON 170 ENGINE

PURPOSE: To introduce dimensional modification of the revolution sensor

APPLICATION: WA700-AP-1 (SAA6D170E) Wheel Loader S/N 10001 thru 10140
WA700-1L Wheel Loader S/N A20001 and A20002

DESCRIPTION:

Introduction:

1. When replacing the revolution sensor for the above engine, it may become difficult to make proper adjustment of the clearance between the sensor and the ring gear to conform to the specifications, depending on the dimensional dispersions of the relevant parts. Consequently, when replacing the engine revolution sensor, use the sensor being introduced in this **PARTS & SERVICE NEWS**.
- 2.

PART NUMBER	PART NAME	Q'TY	REMARKS
7861-92-2340 &7861-92-2330)	Sensor (Sensor)	2 (2)	

- When replacing the revolution sensor for the SAA6D270E-2 engines. It may become difficult to make proper adjustment of the clearance between the sensor and the ring gear to conform to the specification, depending on the dimensional dispersions of the relevant parts. Consequently, when replacing the engine revolution sensor, use the sensor being introduced in this **PARTS & SERVICE NEWS**. (The part as is coded "16" in the schematic diagram below)

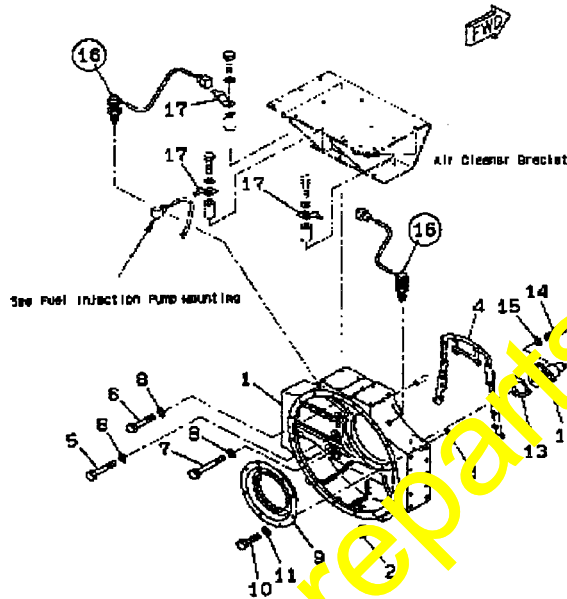

- Contents of the modification with the new engine revolution sensor

This dimension has been enlarged to provide more margin when the revolution sensor is matched to the ring gear.

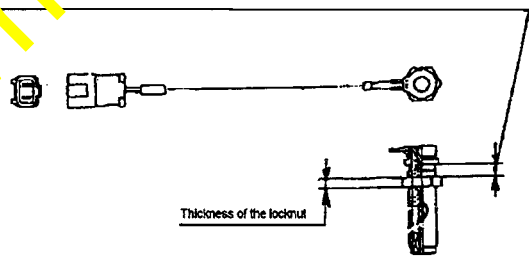

	Current sensor	New Sensor
Part Numbers	7861-92-2330	7861-92-2340
Thickness of the Locknut	16 mm	8 mm

- Refer to the Shop Manual (to the Chapter "Inspections and adjustment") when installing this new sensor.