

PARTS & SERVICE NEWS

REF NO.	AT99038
DATE	Apr. 12, 1999

Page 1 of 5

SUBJECT: REPAIR PROCEDURE OF TUBE FROM E/G TO T/C COOLER ON WA800/900, WD900

PURPOSE: To introduce modification procedures to prevent disconnection of the torque converter cooler piping (water piping) on WA800, WA900 and WD900 wheel loaders

APPLICATION: WA800-3 Wheel Loaders, Serial Nos. 50001, 50002, 50004, 50005
 WA900-3 Wheel Loaders, Serial Nos. 50001 thru 50004
 WD900-3 Wheel Loaders, Serial Nos. 50001 thru 50003

FAILURE CODE: 036403

DESCRIPTION:

1. Introduction

By deformation of the tubes connecting between the engine and the torque converter cooler on the WA800, WA900 and WD900 wheel loaders, the U bolts fastening these tubes may become loose to cause slipping out of the tubes from mating hoses by pressure of the water and by vibrations occurring while the machine is in operation. To prevent the above failure, make the modification introduced in this Service News by changing the designated parts to the improved versions.

2. List of parts

Part No.	Part Name	Purpose of part	Q'ty	Remarks
427-03-22282 (427-03-22281)	Bracket (Bracket)	} Replacement	1 (1)	
427-03-22270 (427-03-22270)	Tube (Tube)		1 (1)	
427-03-22261 (427-03-22260)	Tube (Tube)		1 (1)	
01010-81270 (07283-38973)	Bolt (Clip)		4 (2)	
07289-00105 (07281-01159)	Clamp (Clamp)		16 (16)	

3. Contents of the modification

- ① Modify the fastening method for the tube connecting between the engine and the torque converter cooler.
 - Change the current U-bolt fastening method to a new method where the tube fastening plate is welded to the tubes before mounting them to their positions.
- ② Modify the type of clamp for the hose connecting between the engine and the torque converter cooler.
 - Change the belleville spring clamp to the high-torque type clamp.

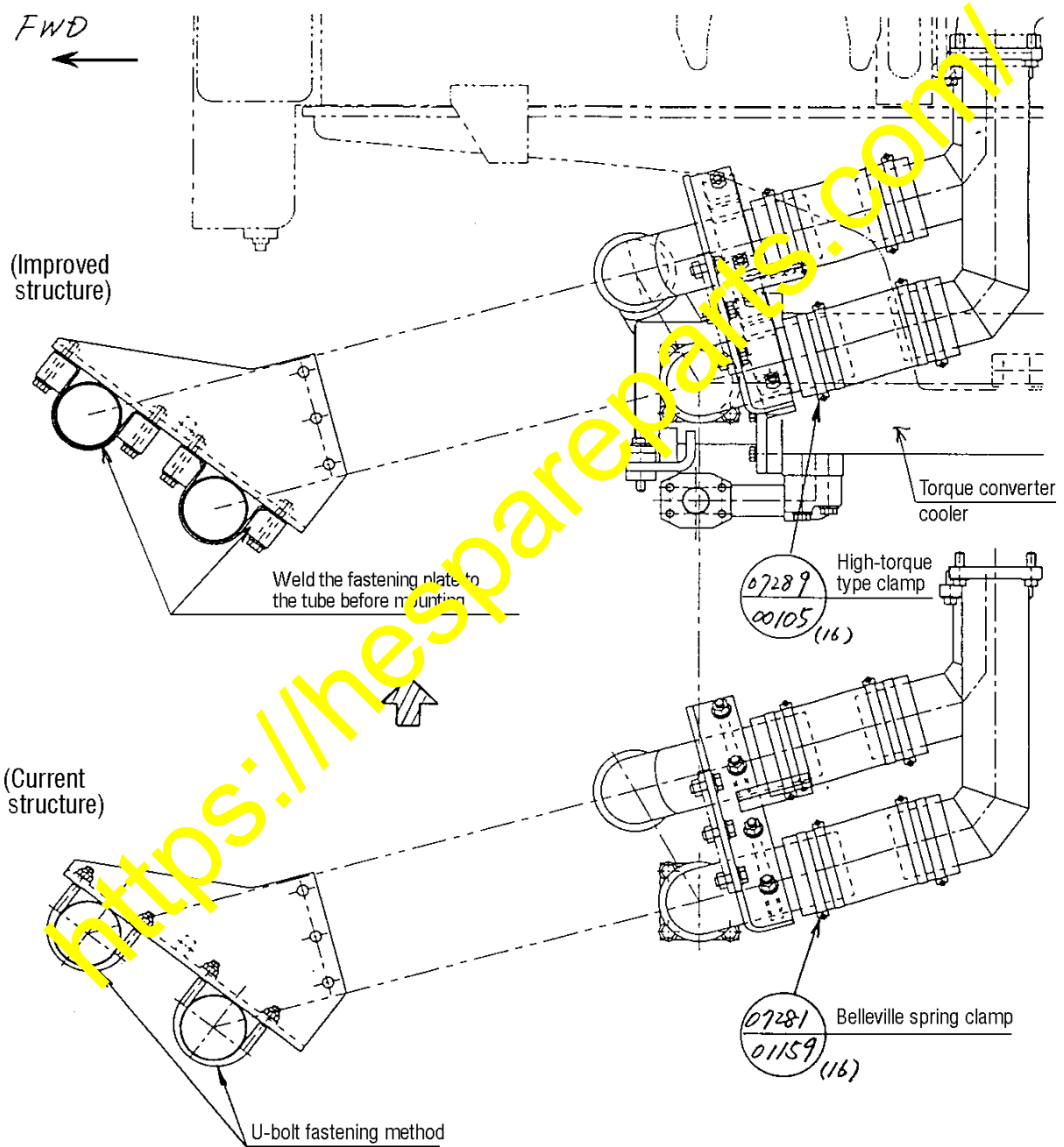

4. Parts to be removed

(Caution) Totally drain the cooling water before starting this work.

- Remove the parts with the part numbers circled in the ⊕ mark in the schematic diagram given below.

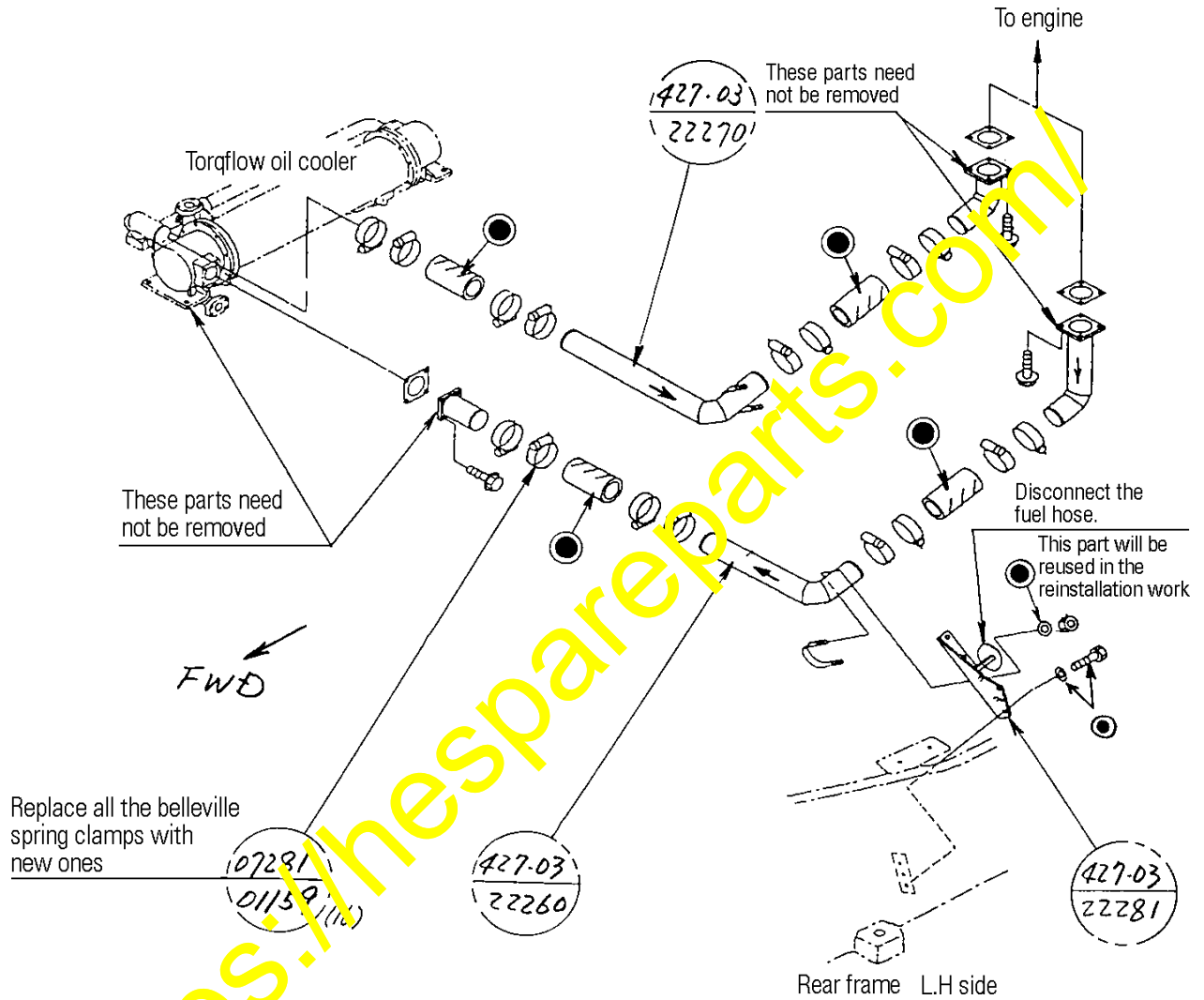

(Caution) Carefully preserve the parts marked ● since they are reused in the reinstallation work.

5. Reinstallation procedures

- Install the parts with the part numbers circled in the ⊖ mark designated in the schematic diagram given below.

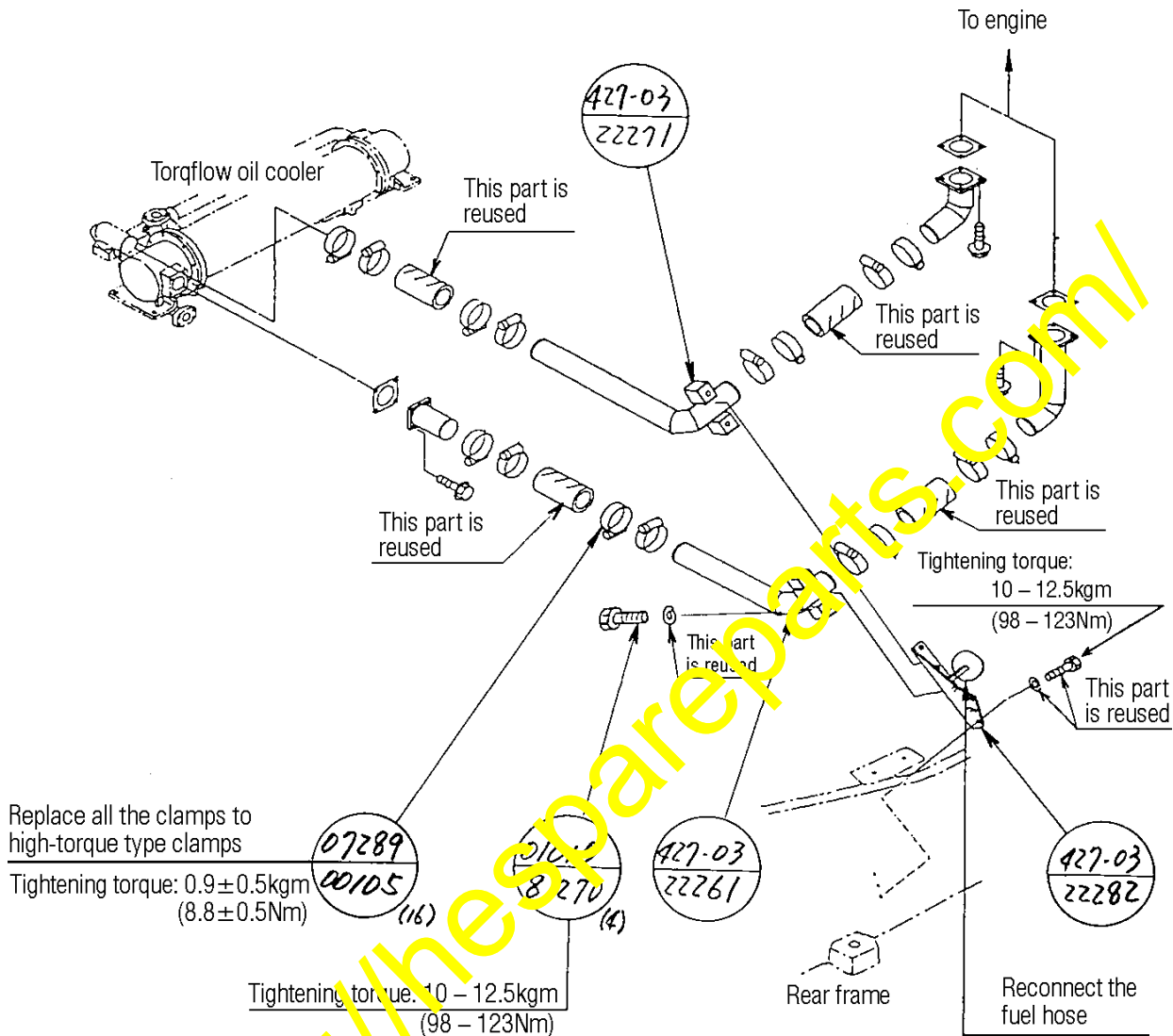

(Caution) When inserting the tubes into the hose, insert them as far as the dimension designated in the diagram given at right.

Also, apply Three-Bond's 1208E over the periphery of the tubes where the hose is fitted (75mm).

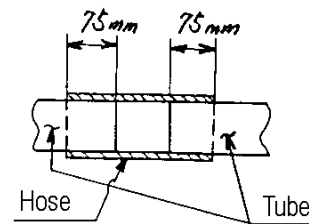

6. List of the serial numbers of the applicable machines and their destinations

WA800-3, WA900-3 and WD900-3

List of serial numbers applicable to the modification to prevent disconnection by slipping out of the torque converter cooler piping

No.	Model name	Serial No.	Production date	Vehicle location
1	WA800-3	50001	70425J	Rep. of South Africa
2	WA800-3	50002	80518J	Australia
3	WA800-3	50004	80630J	Spain
4	WA800-3	50005	80922J	Saudi Arabia

No.	Model name	Serial No.	Production date	Vehicle location
1	WA900-3	50001	97-6-30	Japan (Techno-Center)
2	WA900-3	50002	98-6-22	Australia
3	WA900-3	50003	98-9-30	Australia
4	WA900-3	50004	98-10-28	Australia

No.	Model name	Serial No.	Production date	Vehicle location
1	WD900-3	50001	80721J	Australia
2	WD900-3	50002	80729J	Australia
3	WD900-3	50003	80819J	Australia