

INSTALLATION MANUAL

REF NO.	BT02004
DATE	Feb. 25, 2002

Page 1 of 14

- SUBJECT:** INTRODUCTION OF EXHAUST MUFFLER ON HD465-5, HD605-5
- PURPOSE:** To introduce the optional exhaust muffler ass'y for use on HD465-5 and HD605-5 dump trucks
- APPLICATION:** HD465-5 Dump Trucks, Serial Nos. 4001 and up
HD605-5 Dump Trucks, Serial Nos. 1001 and up
- FAILURE CODE:** A1T0Z9

DESCRIPTION:

1. Introduction

This Service News will introduce an exhaust muffler ass'y being developed as optional parts for use on the HD465-5 and HD605-5 dump trucks.

This exhaust muffler ass'y is applicable to those dump trucks which are being used for hauling of rocks and stones which will not adhere to the body surface, or which are equipped with the rubber liner and have no body heating.

When installing this exhaust muffler, it becomes necessary to install the RH platform guard.

When the vehicle is not equipped with the RH platform guard, prepare the parts of the platform guard at the same time to install the guard to the vehicle.

2. List of parts

No.	Part No.	Part Name	Q'ty	Remarks
1	569-84-42112	Muffler A.	1	
2	569-84-62151	Tube	1	
3	569-95-41740	Band	2	
4	01010-81030	Bolt	2	
5	01580-11008	Nut	2	
6	01643-31032	Washer	2	
7	569-84-62130	Bracket	1	
8	01010-81230	Bolt	4	
9	01643-31232	Washer	4	
10	01010-81240	Bolt	4	
11	01580-11210	Nut	4	
12	01643-31232	Washer	4	
13	569-84-62141	Bracket	1	
14	01010-81225	Bolt	4	
15	01643-31232	Washer	4	
16	01010-81225	Bolt	2	
17	01643-31232	Washer	2	
18	01010-81240	Bolt	1	
19	01580-11210	Nut	1	
20	01643-31232	Washer	2	
21	234-62-22672	Elbow	1	
22	569-84-82161	Tube	1	
23	569-84-62121	Tube	1	
24	569-84-42170	Seat	2	} To be welded to the platform
25	286-62-19140	Seat	2	
26	569-84-62170	Plate	2	
27	569-84-62280	Plate	2	
28	569-84-62290	Plate	1	} To be welded to the body
29	569-84-62221	Plate	1	
30	569-84-62231	Plate	1	

Parts of Item Nos. 1 thru 30 can be acquired by the Sales Code "7HB51-G".

Component parts of the platform guard (It is necessary to order these parts in case the vehicle is not equipped with the R.H. platform guard.)

Part No.	Part Name	Q'ty	Remarks
569-74-61930	Guard	1	} For HD465-5
01010-81225	Bolt	18	
01643-31232	Washer	18	
569-83-65930	Guard	1	} For HD605-5
01010-81440	Bolt	8	
01643-31445	Washer	8	
01010-81430	Bolt	4	
01643-31445	Washer	4	}

<https://hespareparts.com/>

3. Installation procedure

Numbers given after the part names in the descriptive sentences and numbers given in the figures coincide with the Item Nos. in the list of necessary parts.

3-1 Preparations to make with the vehicle

Park the vehicle on a flat place, apply the parking brake and turn off the starting key. After that, insert the chock underneath each tire.

Then, open the battery box and separate the minus terminal connection of the battery.

3-2 Removing the parts which need to be removed for the installation work (Refer to Fig. 1.)

The index number shown in the illustration coincide with the numbers in the "Fig. 1111A EXHAUST PIPING" of Parts Book.

○ marked parts are being reused after their removal.

□ marked parts are not being reused after their removal.

Remove the exhaust tube and the parts being used between the tube and the body.

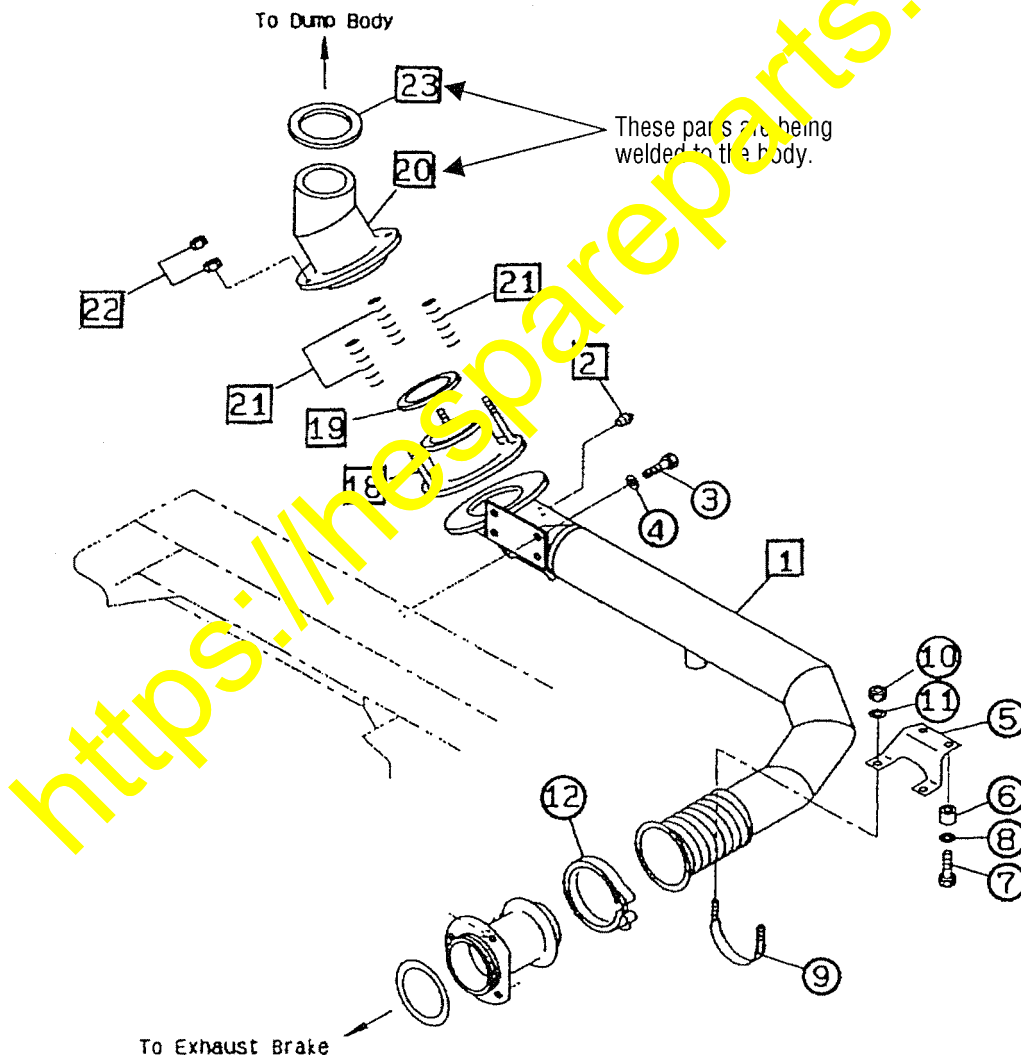

Fig. 1

3-3 Additional working for the R.H. platform (Refer to Fig. 2 and Fig. 3.)

- 1) Weld the plates 27 and 28 onto the upper surface of the platform and, after that, weld the seats 24 and 25.
- 2) Weld the plate 26 onto the bottom surface of the platform.

★ When carrying out the welding work, be sure to ground the platform body.

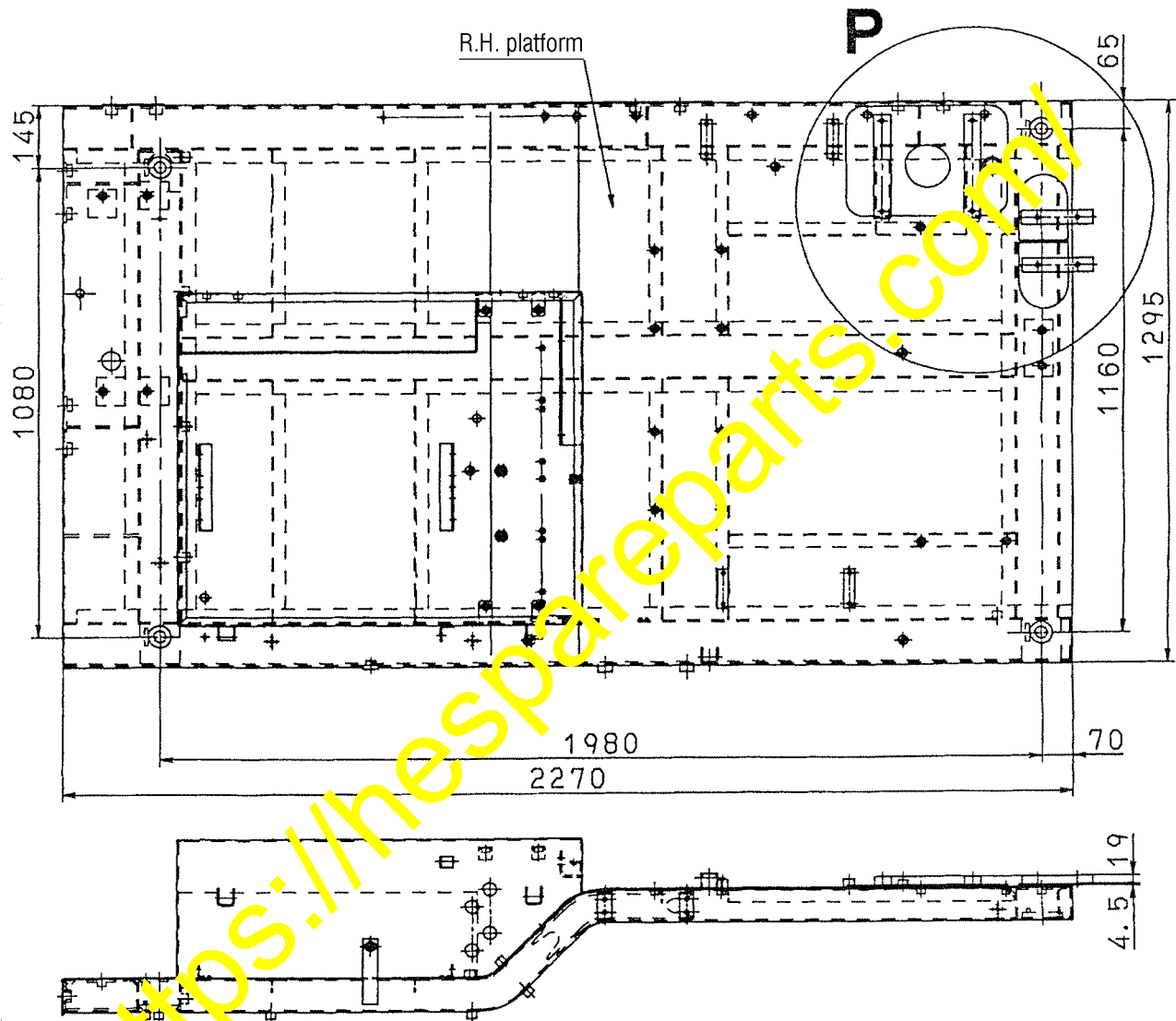

Fig. 2

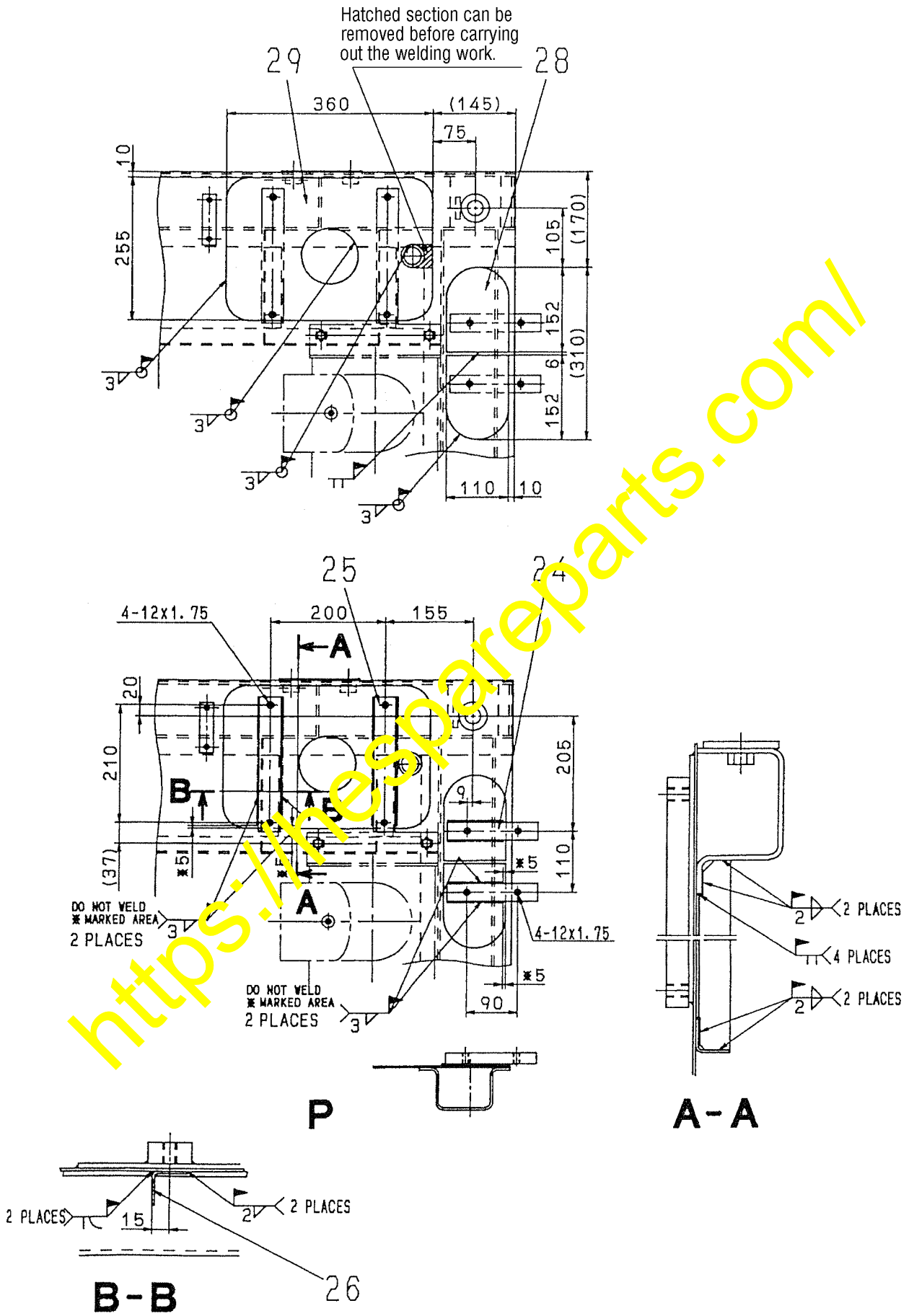

Fig. 3

3-4 Additional working for the body

In case of HD465-5 (Refer to Fig. 4.)

- 1) Remove the hatched exhaust gas inlet port material by gas cutting.
- 2) Finish the gas cut surfaces smoothly using a grinder.
- 3) Weld the plates 29 and 30 to close the hole.

In case of HD605-5 (Refer to Fig. 5.)

- 1) Remove the hatched exhaust gas inlet port material and exhaust gas outlet port material by gas cutting.
- 2) Finish the gas cut surfaces smoothly using a grinder.
- 3) Weld the plates 29 and 30 to close the hole.

★ When carrying out the welding work, be sure to ground the body itself

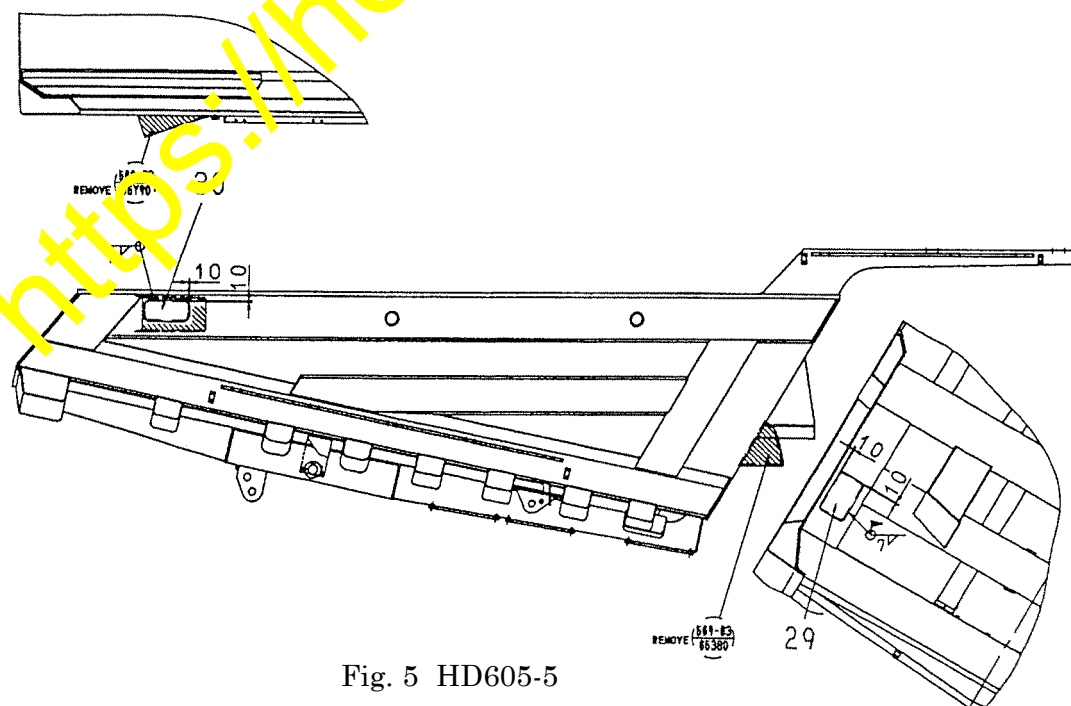
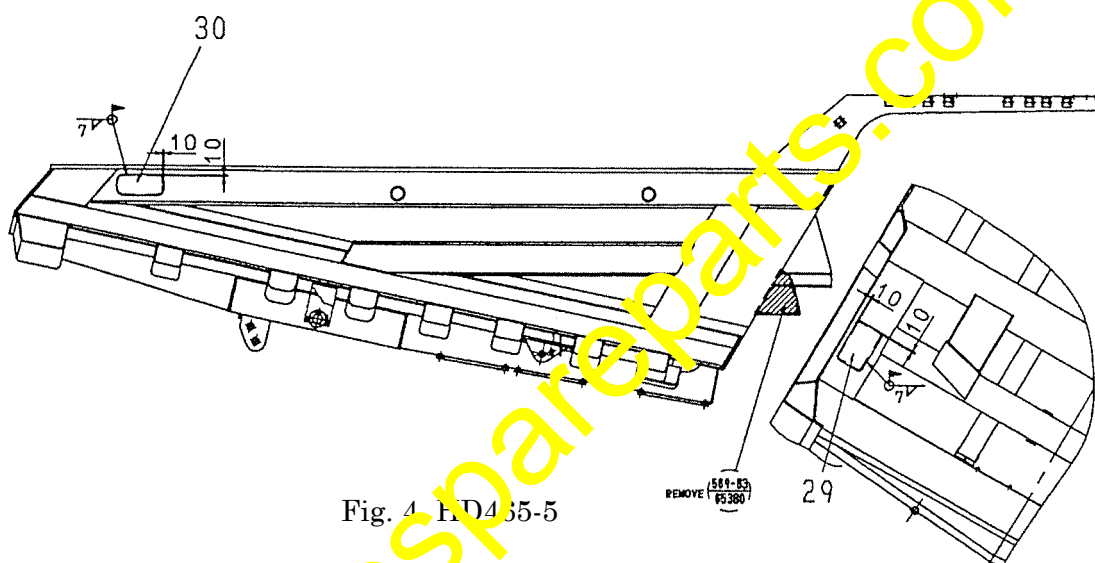

3-5 Installation (Refer to Fig. 6, Fig. 7, Fig. 8 and Fig. 9.)

- 1) Install the tube 23, muffler 1, brackets 7 & 13 and other parts as shown in the figure indicated below.

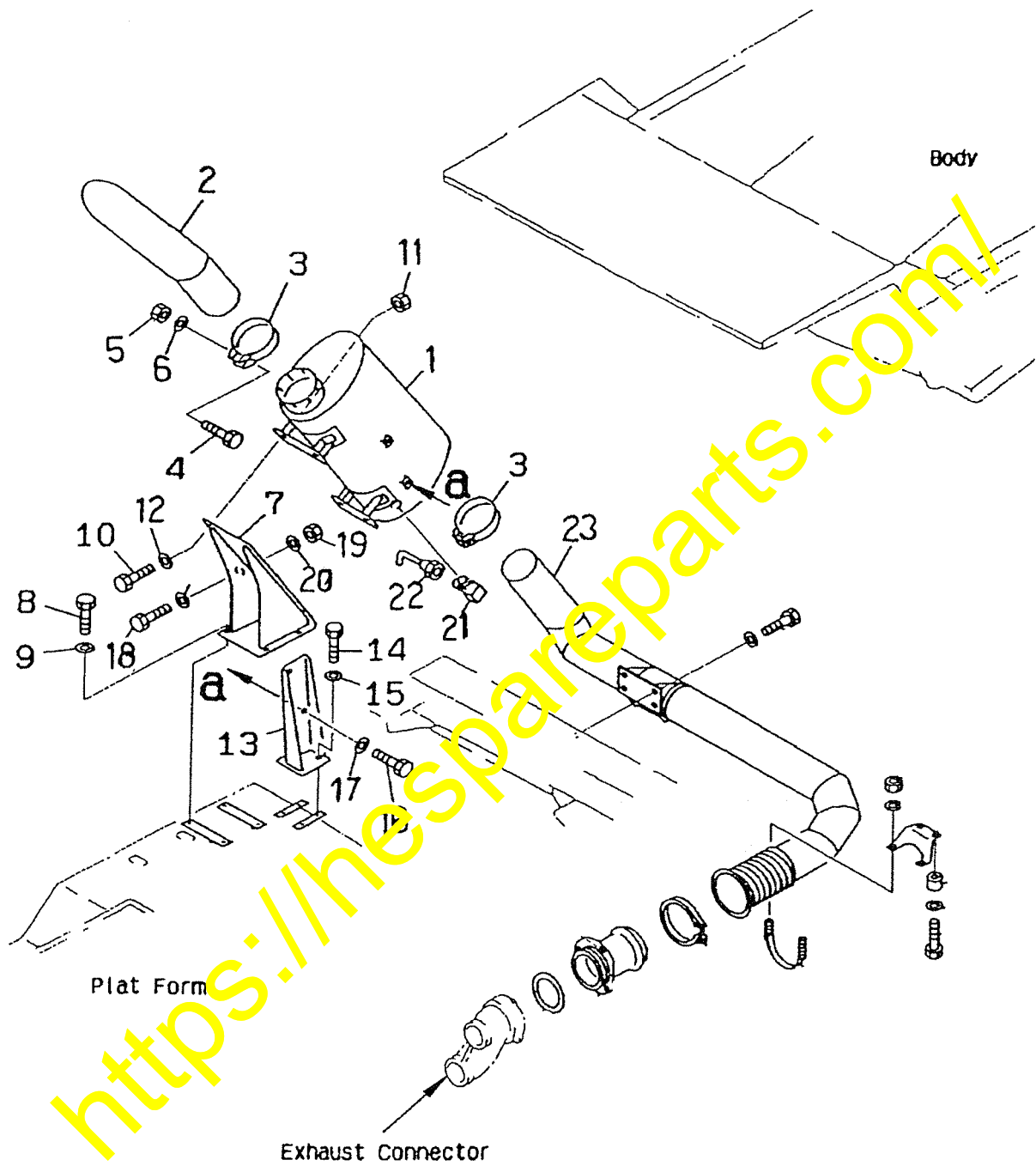

Fig. 6

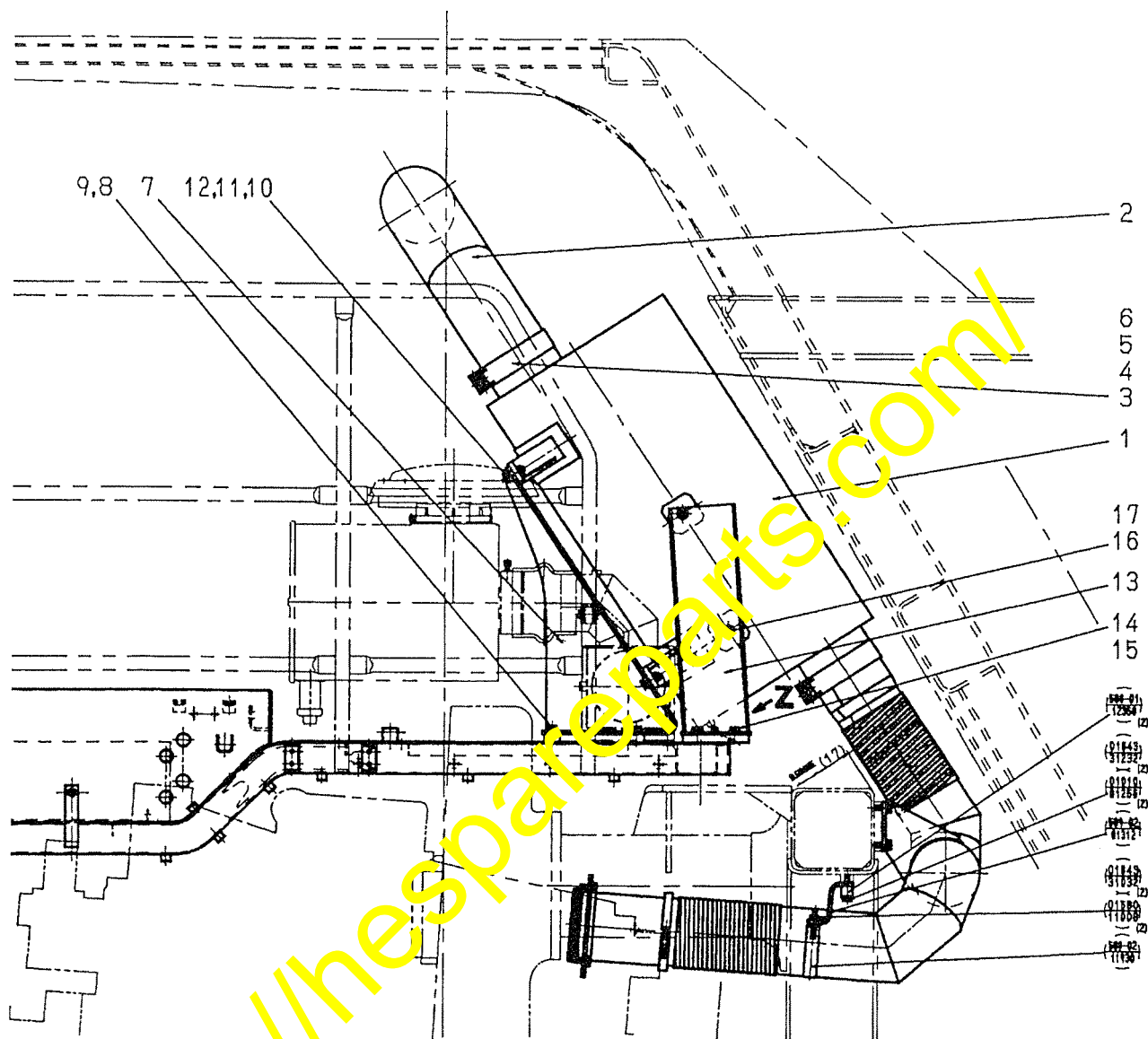

Fig. 7 Side view

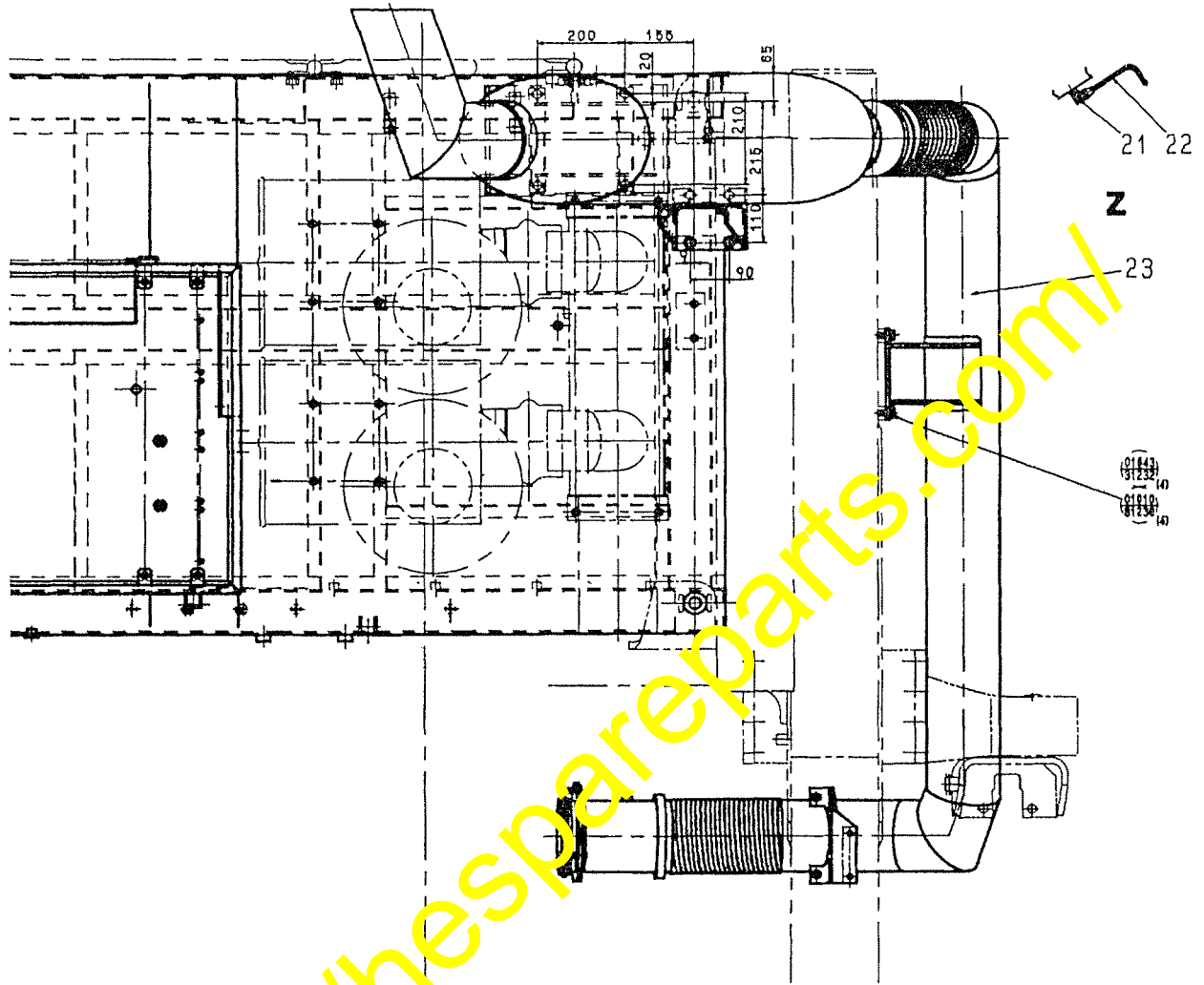

Fig. 8 Top view

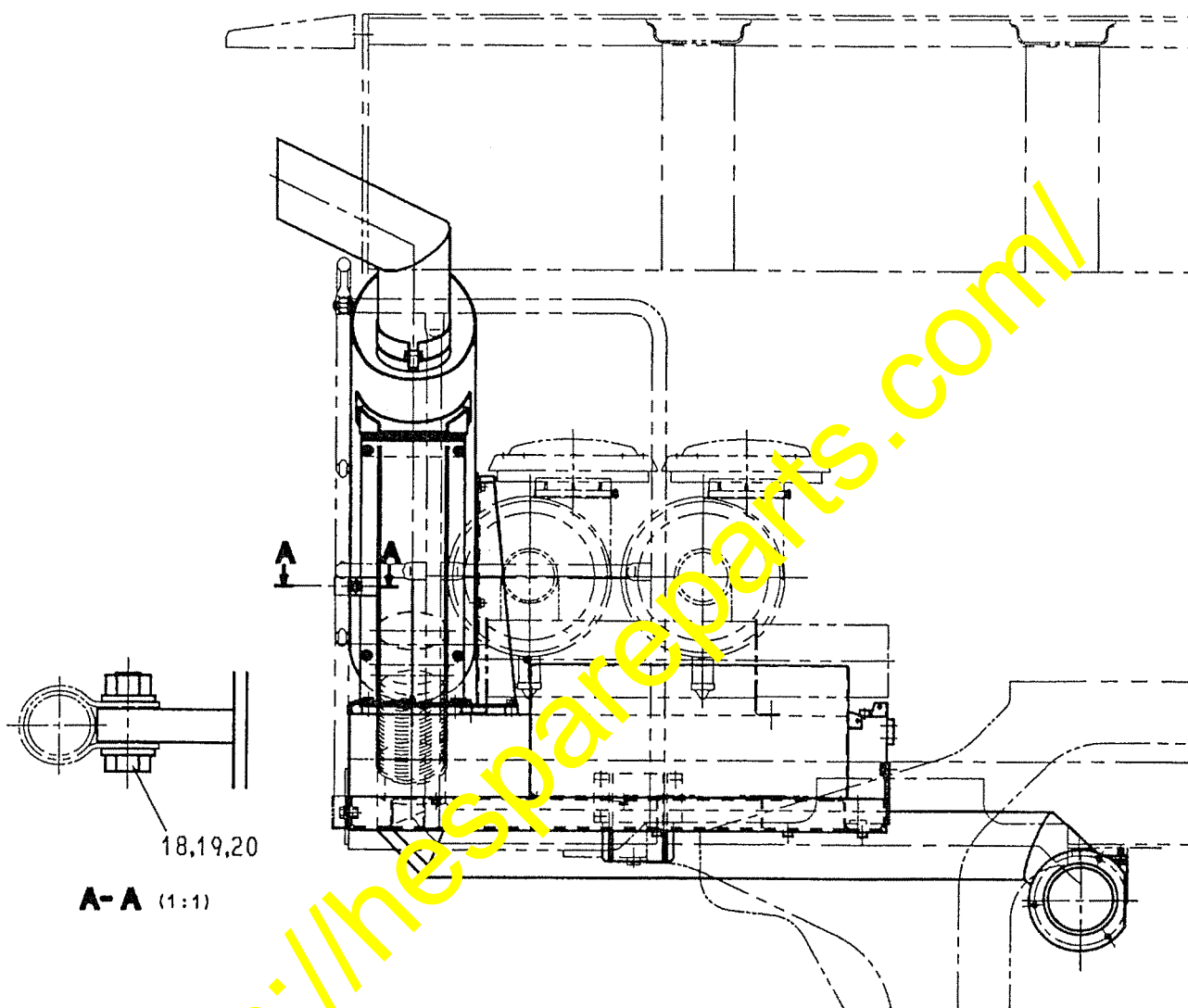

Fig. 9 Front view

4. Installation of the RH platform guard

In case the vehicle is not equipped with the R.H. platform guard, prepare the parts as per the table indicated below to install the guard to the vehicle.

In case of HD465-5

	Part No.	Part name	Q'ty
A	569-74-61930	Guard	1
B	01010-81225	Bolt	18
C	01643-31232	Washer	18

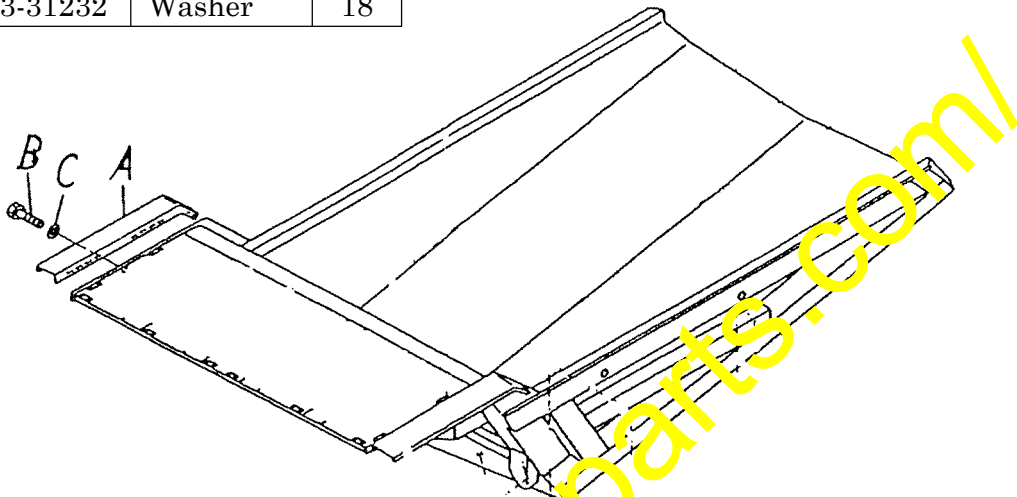

In case of HD605-5

	Part No.	Part name	Q'ty
D	569-83-65930	Guard	1
E	01010-81440	Bolt	8
F	01643-31445	Washer	8
G	01010-81430	Bolt	4
H	01643-61445	Washer	4

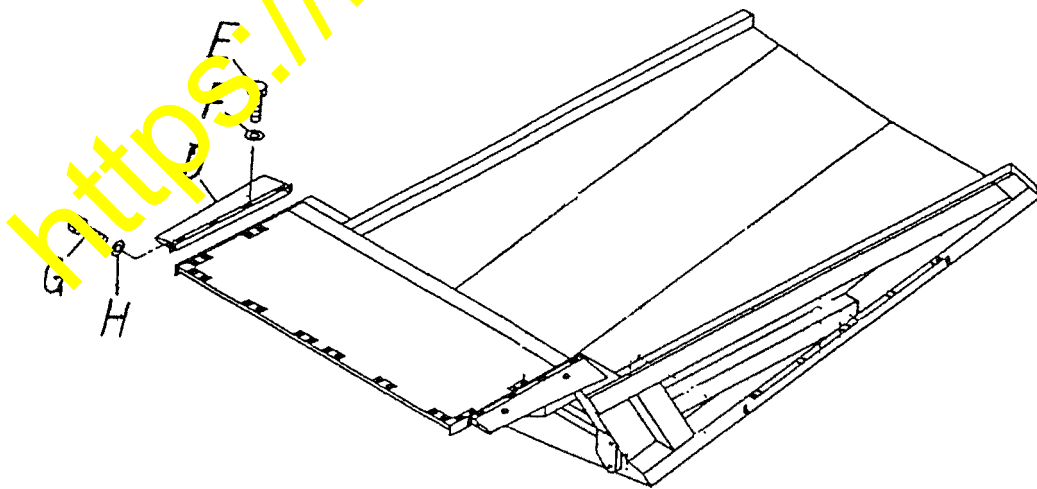

5. Restoration

Connect the minus terminal of the battery which was separated while preparing for this installation work.

6. When locally manufacturing the necessary parts

When locally manufacturing the necessary parts, make them as per the instructions given in the parts drawings indicated below. (Shown below are the seats and plates of the Item Nos. 24 thru 30.)

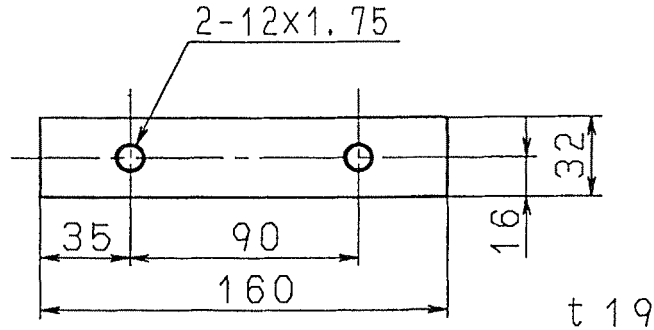

569-84-42170 SEAT SS400F

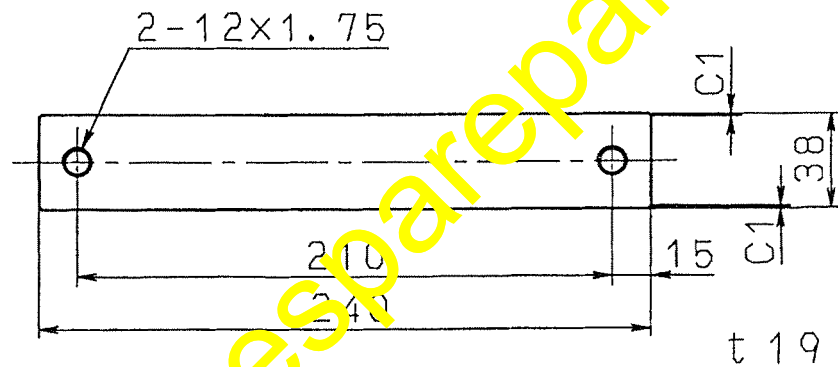

286-62-19140 SEAT SS400F

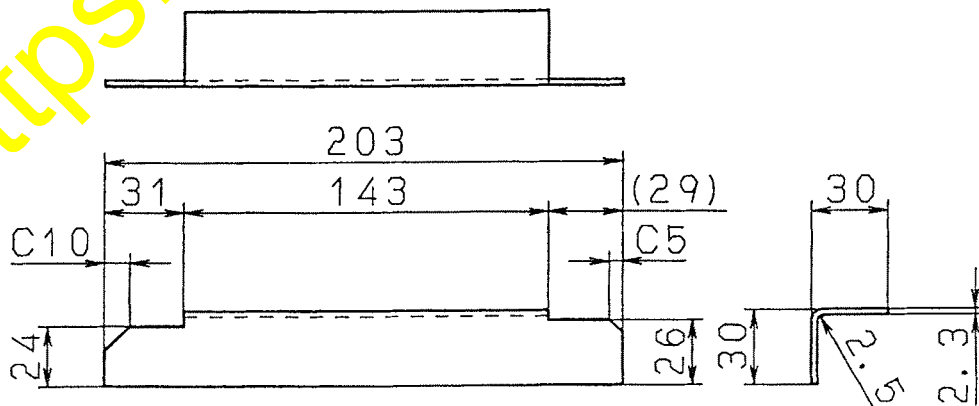

569-84-62170 PLATE SPHC

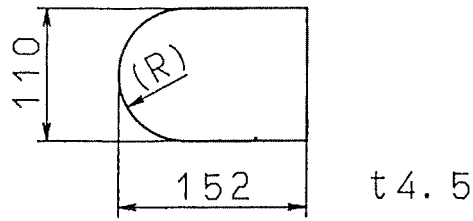

569-84-62280 PLATE SS400P

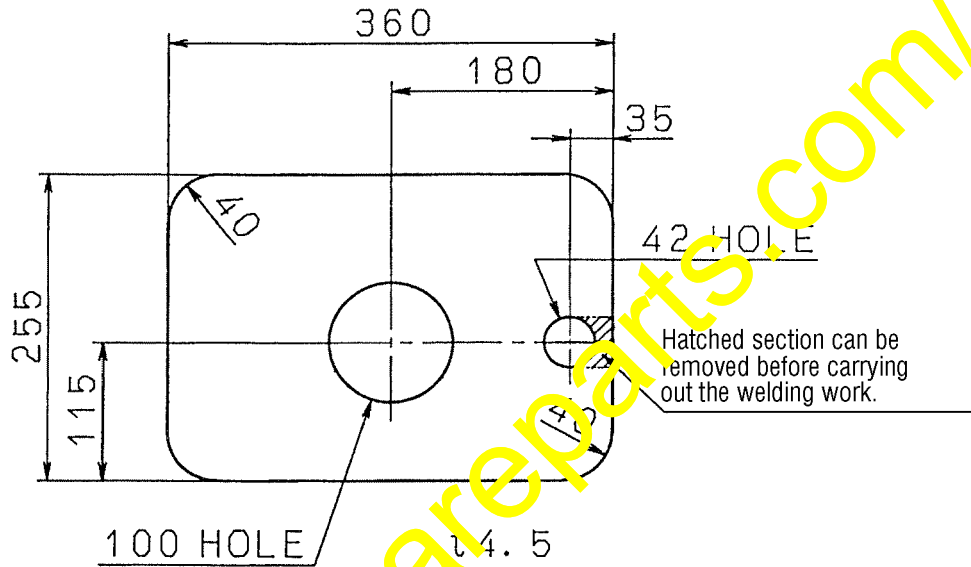

569-84-62290 PLATE SS400P

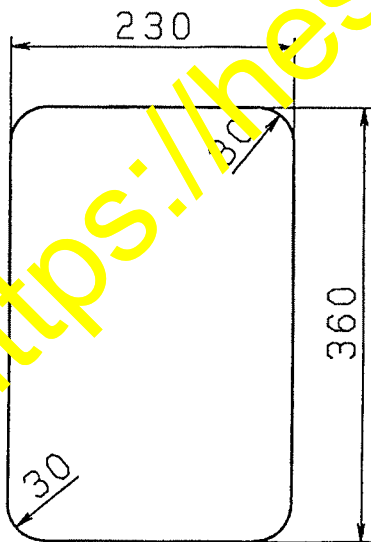

569-84-62221 PLATE
SS400P

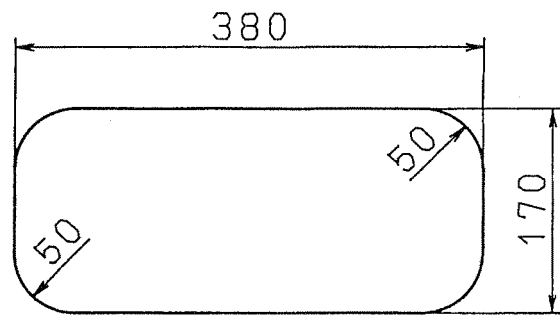

569-84-62231 PLATE
SS400P