

# INSTALLATION MANUAL

REF NO.	<b>BT99040A</b>
DATE	<b>Aug. 22, 2000</b>

Page 1 of 12

This INSTALLATION MANUAL supersedes the previous issue No. BT99040 dated Oct. 19, 1999, which should be discarded.

**SUBJECT:** INTRODUCTION OF DUST-PROOF SWITCHES ON HD325, HD405-6, HD465-5

**PURPOSE:** To introduce dust-proof switches for use on dump trucks

**APPLICATION:** HD325-6 Dump Trucks, Serial Nos. 5680 and up  
 HD405-6 Dump Trucks, Serial Nos. 1055 and up  
 HD465-5 Dump Trucks, Serial Nos. 4626 and up  
 HD605-5 Dump Trucks, Serial Nos. 1013 and up  
 HD785-5 Dump Trucks, Serial Nos. 4001 and up  
 HD985-5 Dump Trucks, Serial Nos. 1021 and up

**FAILURE CODE:** DD1050

## DESCRIPTION:





### 1-1. Introduction

Dust-proof types of emergency steering switch, shift limit switch and power mode selector switch have been prepared for use on above listed dump trucks and their installation procedures are outlined in this Service News.

### 1-2. Revised places:

10 places 	Aug. 22, 2000	Shift limit switch and power mode selector switch were changed.
-----------------------------------------------------------------------------------------------	---------------	-----------------------------------------------------------------

## 2. List of parts

No.	Part No.	Part Name	Q'ty	Remarks
1	 62411 <del>561-92-62410</del> (569-54-63923)	Plate (Plate)	1 (1)	For electric governor spec. only
2	 62511 <del>561-92-62510</del> (569-54-65921)	Plate (Plate)	1 (1)	For mechanical governor spec. only
3	561-92-62420 (569-40-65530)	Grommet (Grommet)	1 (1)	
4	561-92-62430 (569-54-64250)	Plate (Plate)	1 (1)	
5	 62441 <del>561-92-62440</del>	Wiring harness	2	1 piece for mechanical governor spec.
6	 65811 <del>569-06-65810</del> (569-06-61262)	Switch (Switch)	1 (1)	For electric governor spec. only
7	 65811 <del>569-06-65810</del> (569-06-61282)	Switch (Switch)	1 (1)	
8	569-06-65820	Cover	1	
9	569-06-65830	Ring	1	

### 3. Preparation for modification

- 1) Park the machine on a flat ground and put chocks to lock wheels.
- 2) With the engine-starting switch kept in off position, disconnect the battery cable from the minus (-) terminal of the battery.

**⚠** Read “Operation and Maintenance Manual” and “Shop Manual” carefully before implementing the modification.

### 4. Installation procedures

#### 4-1 Removal of parts (Fig-1, Fig-2)

##### 1) List of removing parts

No.	Part No	Part Name	Qty	Remarks
⑩	569-54-63923	Plate	1	For electric governor spec.
⑪	569-54-65921	Plate	1	For mechanical governor spec.
⑫	01023-20616	Screw	4	Reused
⑬	569-40-65530	Grommet	1	
⑭	569-54-64250	Plate	1	
⑮	568-95-11361	Switch	1	Reused
⑯	01010-80610	Bolt	2	Reused
⑰	01643-30610	Washer	2	Reused
⑱	569-06-61282	Switch	1	Electric governor spec., power mode selector switch
⑲	569-06-61282	Switch	1	Shift limit switch
⑳	01010-80812	Bolt	2	Reused
㉑	01643-30823	Washer	2	Reused

- 2) Remove plate ⑩ (for electric governor spec.), plate ⑪ (for mechanical governor spec.), and screws ⑫ from the center console box. Remove the bolts ⑳ and washers ㉑ then remove the parking brake valve. issue
- 3) Remove the switches ⑱ (power mode switch, for electric governor only) and ⑲ (shift-limit switch) from the wiring harness.
- 4) Remove the bolts ⑯ and washers ⑰, then remove the emergency steering switch ⑮ from the plate ⑩ (for electric governor spec.), plate ⑪ (for mechanical governor spec.).  
The plate ⑭ attached directly to emergency steering switch must be removed.  
(The ring used to fix this plate ⑭ to switch ⑮ is an accessory of the switch and reused.)

Store the parts ⑫,⑮,⑯,⑰,⑳ and ㉑ in a safe place so that they are not lost as they will be reused.

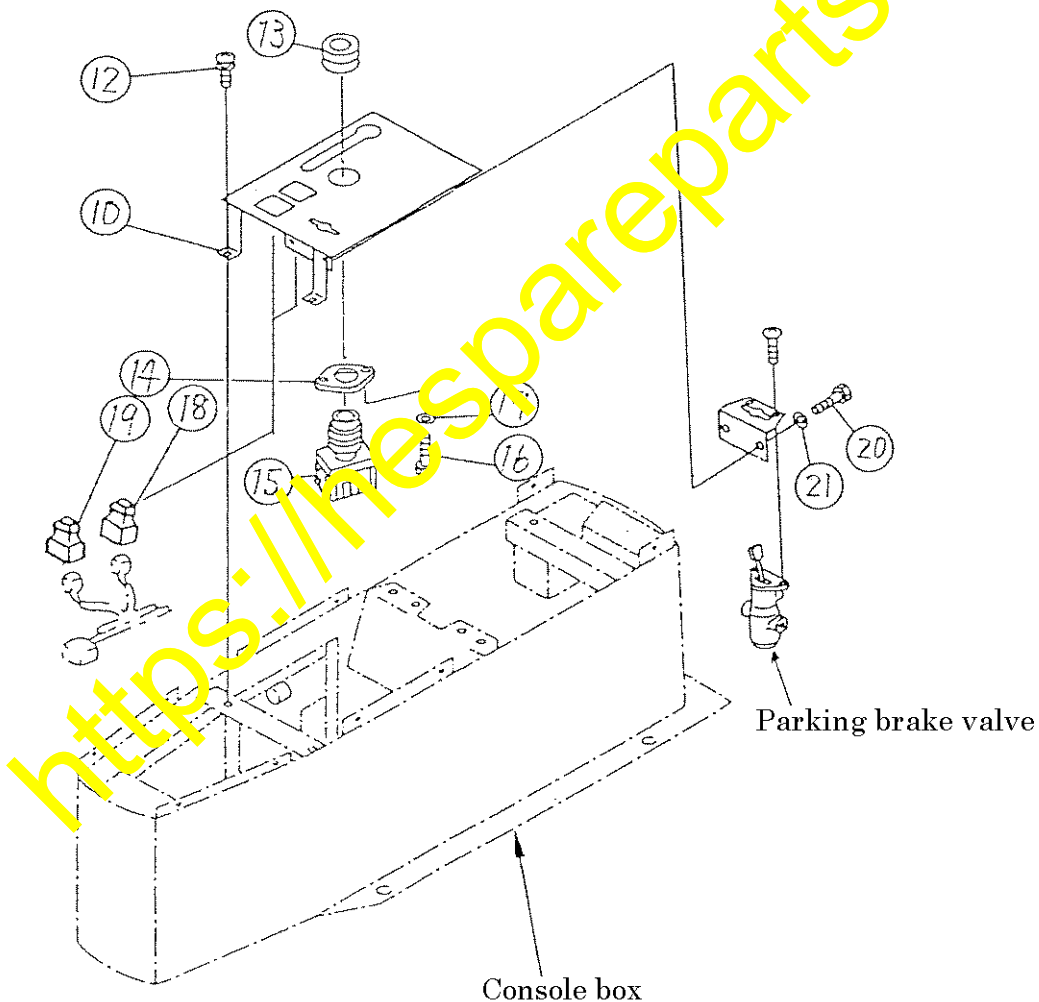

Fig-1 Electric governor specification

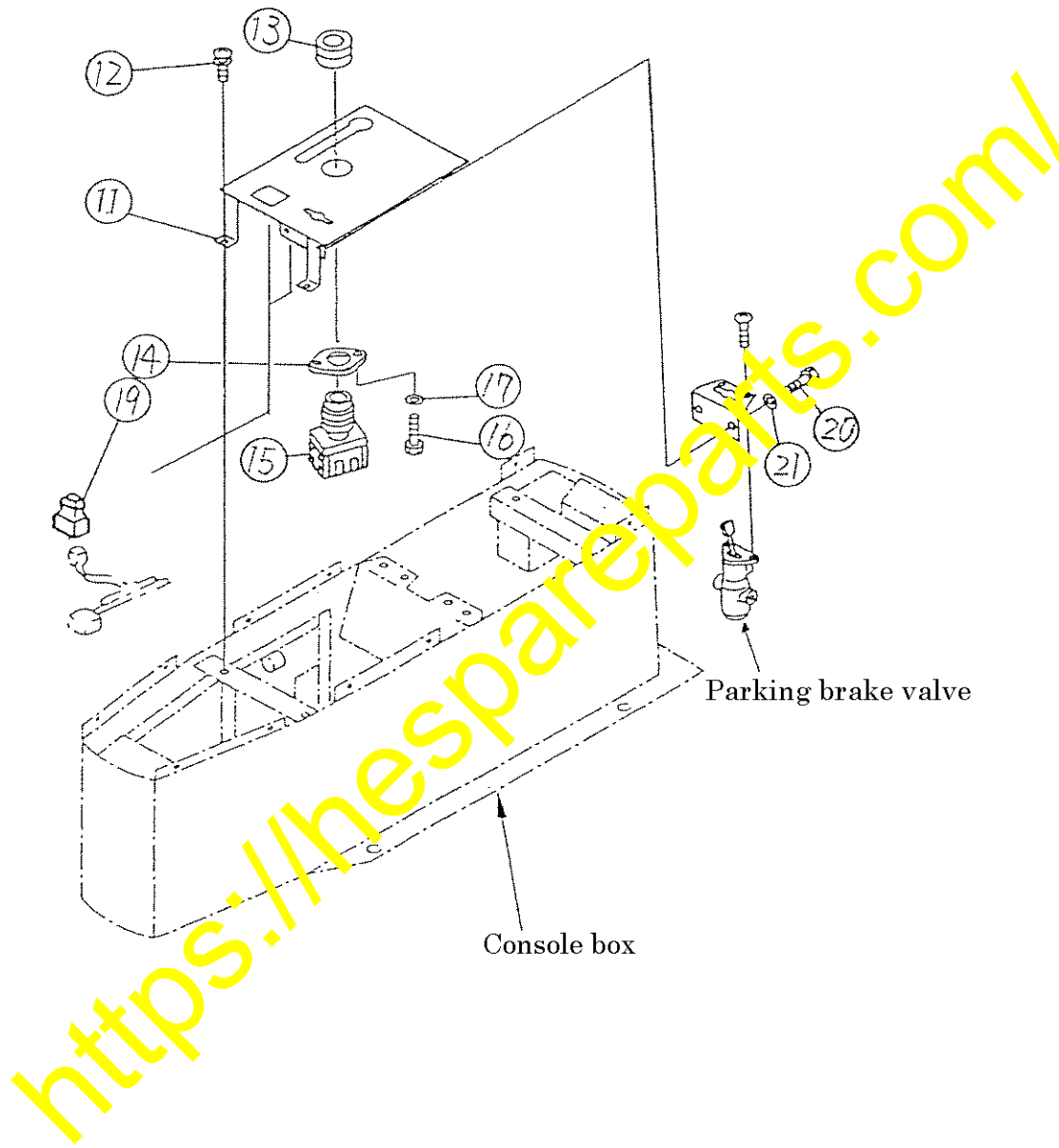

Fig-2 Mechanical governor specification

#### 4-2 Installation of parts (Fig-3, Fig-4)

##### 1) Emergency steering switch

- Mount the plate ④ to the emergency steering switch ⑮ using the ring, an accessory of emergency steering switch ⑮.
  - Mount the cover ⑧ to the emergency switch ⑮ using the ring ⑨. (Apply liquid sealant <Three bond 1211> to the outer periphery of the section where cover ⑧ and switch ⑮ are jointed.)
  - Mount the grommet ③ on the plate ① (for electric governor spec.), or the plate ② (for mechanical governor spec.).
  - Mount the emergency steering switch ⑮ on the plate ① (for electric governor spec.), or plate ② (for mechanical governor spec.) using the bolts ⑯ and washers ⑰.
- ※ When mounting the emergency steering switch ⑮ on the plate ① or ②, do so, so that grommet ③ and cover ⑧ are evenly spaced.

##### 2) Shift limit switch

- Mount the switch ⑦ on the plate ① (for electric governor spec.), or ② (for mechanical governor spec.). (Mount the switch at "Mark A" for electric governor spec.)  
When mounting the switch, apply LT1-A on the mating face between switch ⑦ and plate ① (for electric governor spec.) or ② (for mechanical governor spec.).
- Connect the connector SW of adapter harness ⑤ to the switch ⑦.
- Connect the connector HN of adapter harness to the connector SH of wiring harness from chassis side.

##### 3) Power mode selector switch ( for electric governor spec. only)

- Mount the switch ⑥ on the plate ①. (At the "Mark B" portion)  
When mounting the switch, apply LT1-A on the mating face between switch ⑥ and plate ①.
- Connect the connector SW of adapter harness ⑤ to the switch ⑥.
- Connect the connector HN of adapter harness to the connector PW of the wiring harness from chassis side.

##### 4) Other parts

- Mount the parking brake valve on the plate ① (for electric governor spec.), or plate ② (for mechanical governor spec.) using the bolts ⑳ and washers ㉑.
- Mount the plate ① (for electric governor spec.), or plate ② (for mechanical governor spec.) on the console box using the screws ㉒.

5. Checking the function

- 1) After the modification is complete, connect the battery cable to the minus (-) terminal, then switch ON the starting switch.
- 2) Checking the emergency steering switch  
Switch on the emergency steering switch, and check that the lamp (red) for the switch lights and steering can be operated for 20 seconds.
- 3) Checking the shift limit switch (Fig-5)  
Switch on the shift limit switch, and check that the lamp (green) for the switch is lit and that shift limit pilot lamp on the monitor panel is lit.
- 4) Checking the power mode selector switch (Fig-5 for electric governor spec. only)  
Switch on the power mode selector switch, and check that the lamp (green) for the switch lights and that indication on the monitor switches over from power mode to economy mode.

<https://hespareparts.com/>

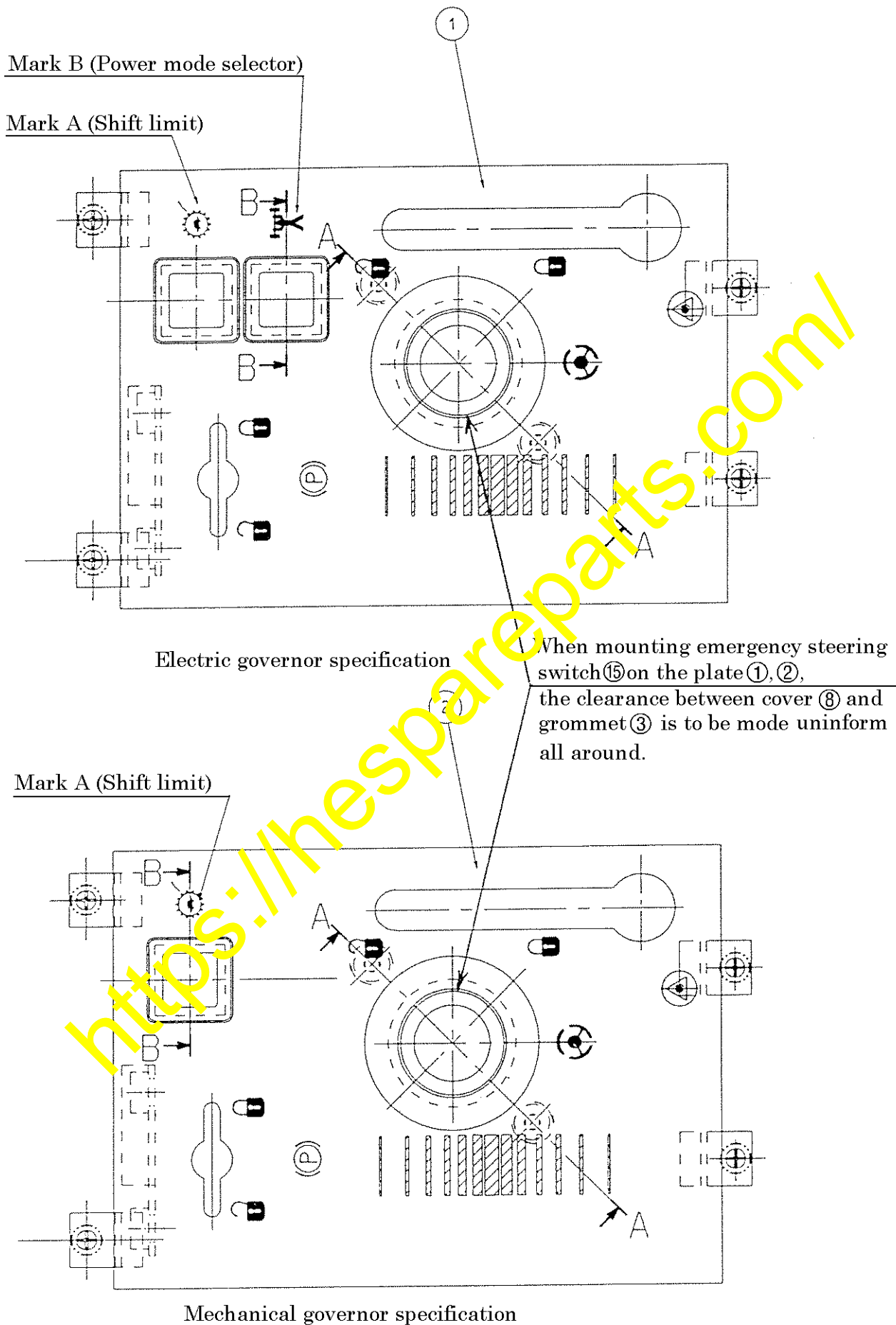

Fig-3



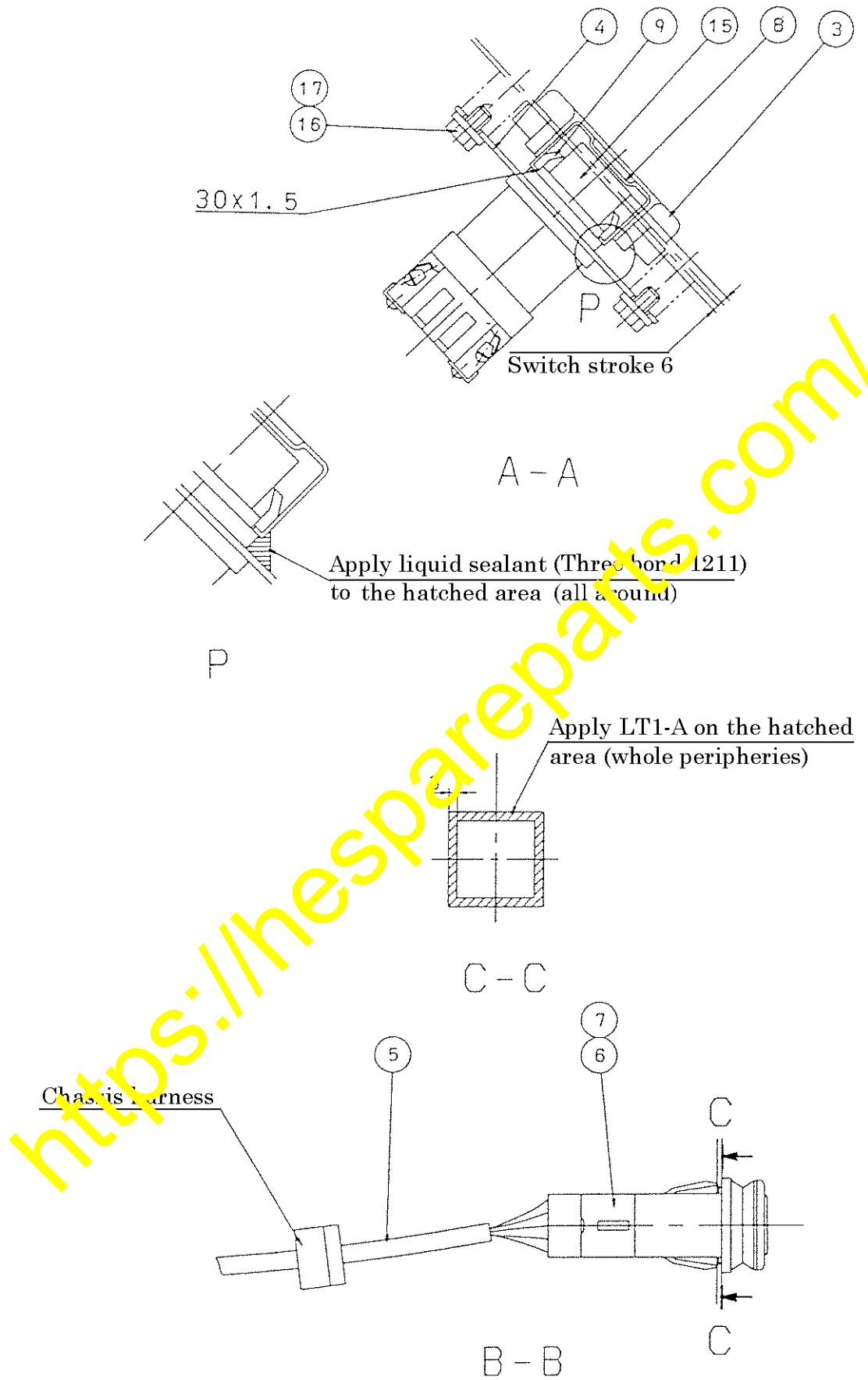
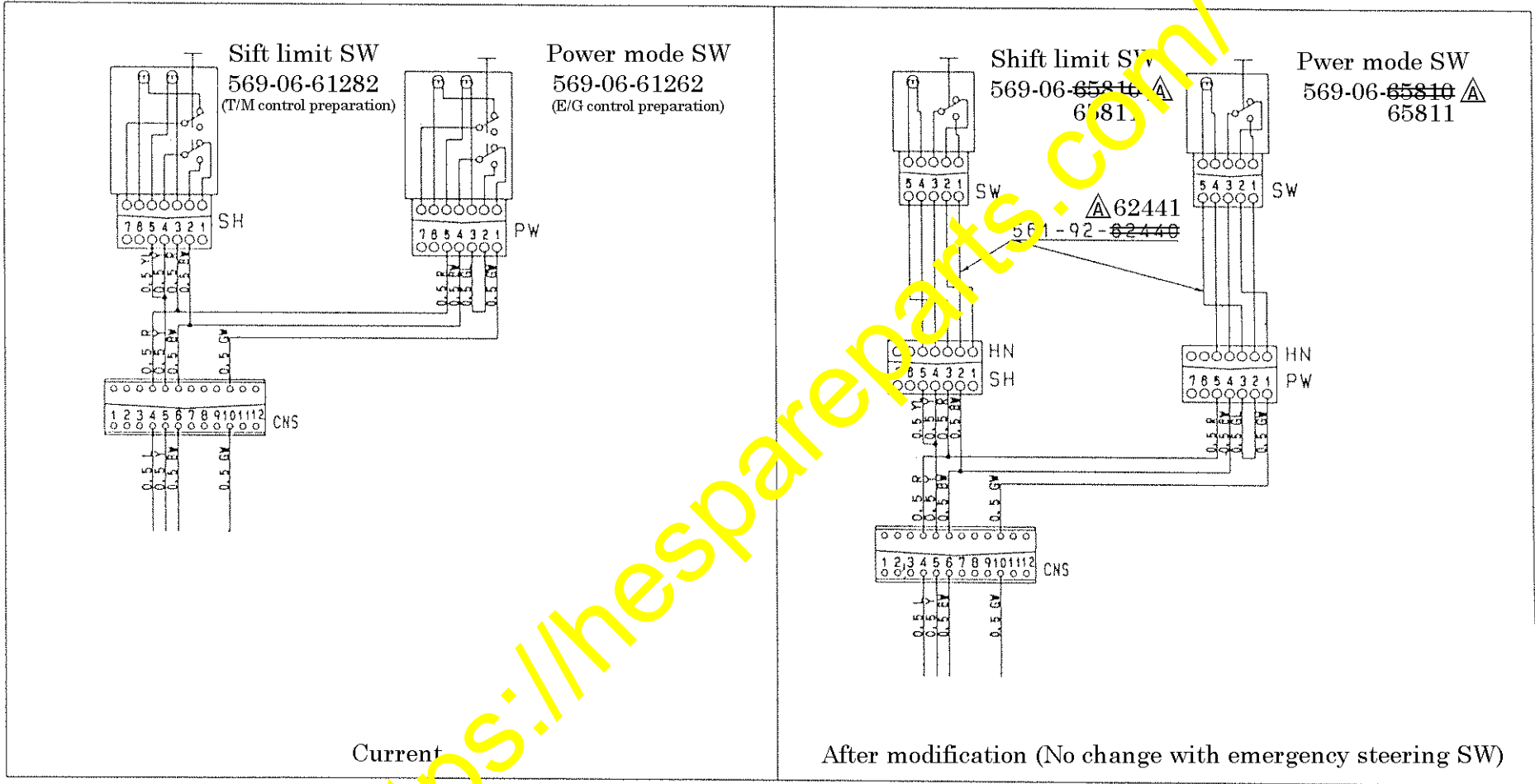
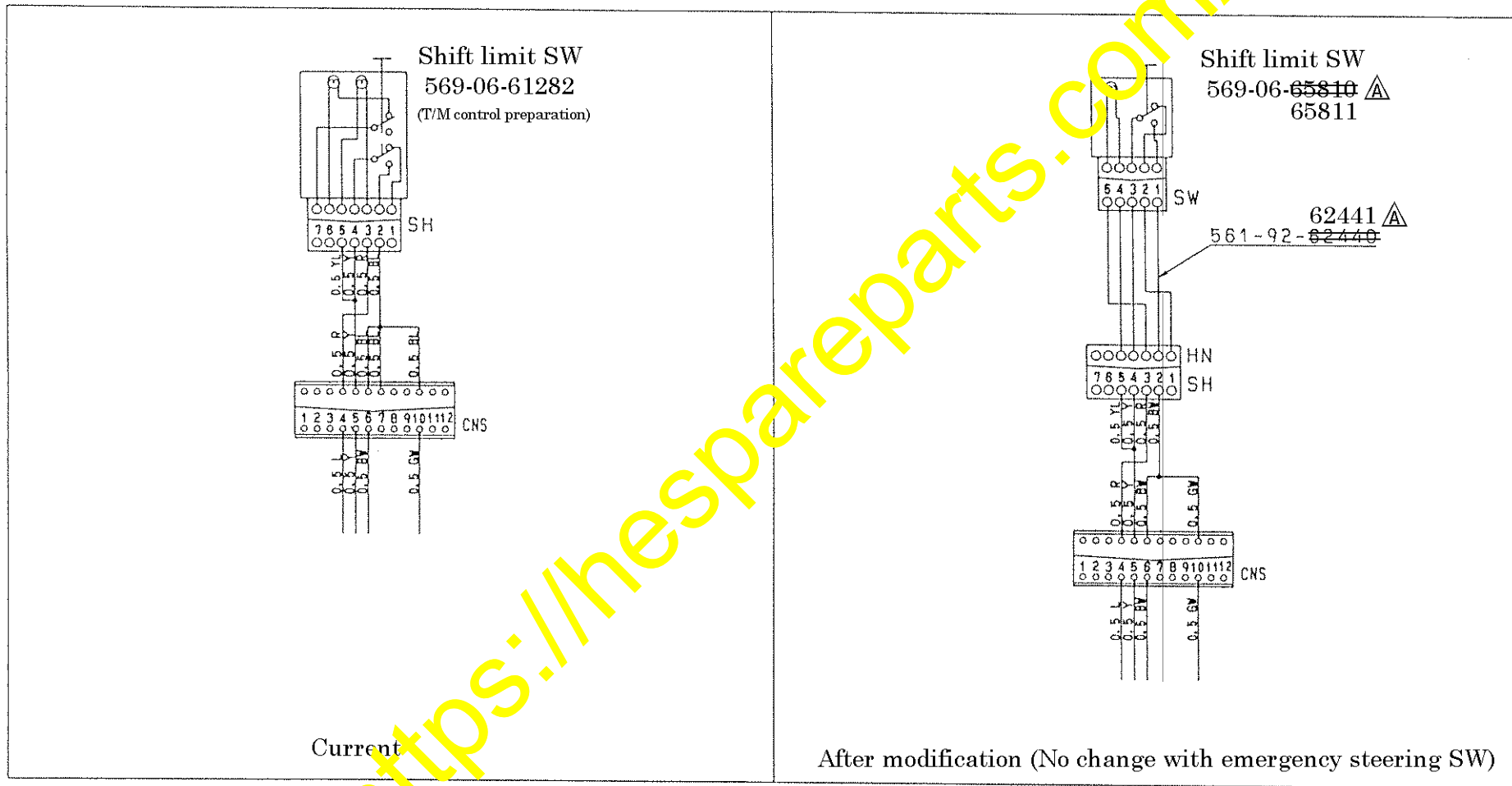

Fig-4



**WIRING DIAGRAM**  
 For electric governor specification



WIRING DIAGRAM  
For mechanical governor specification

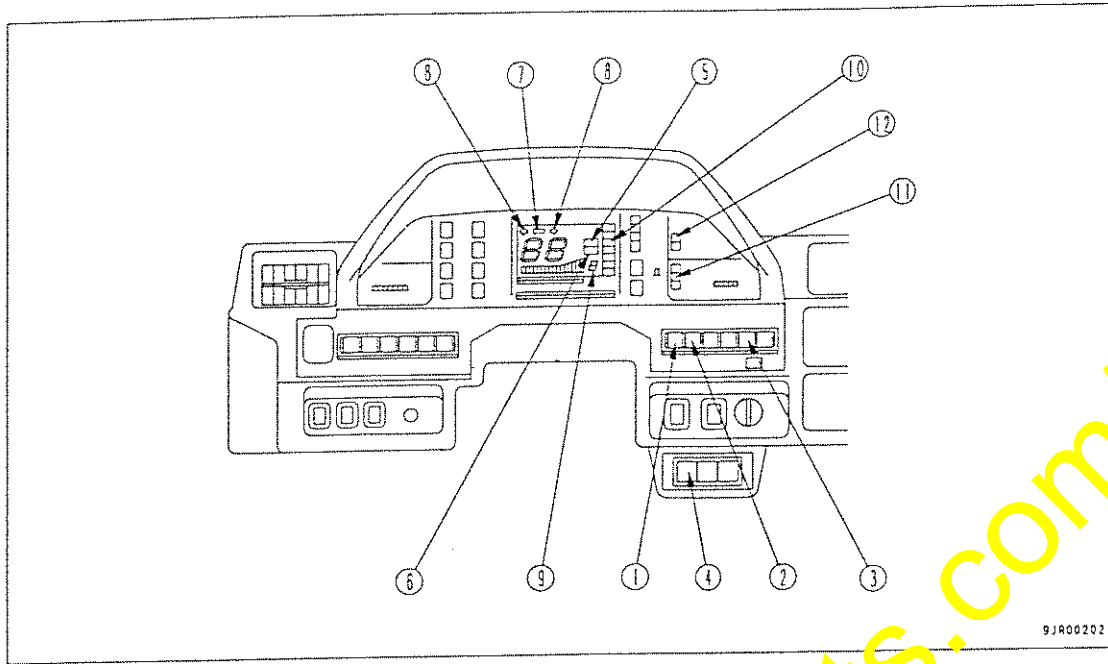

**Shift limiter pilot lamp**

When shift limiter switch is in ON position, this monitor (6) is lit.

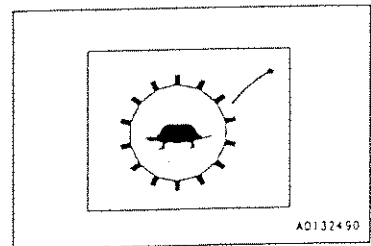

**Power mode display lamp (For electric governor spec. only)**

This monitor (12) displays the power mode. Select the mode by the power mode selector switch.

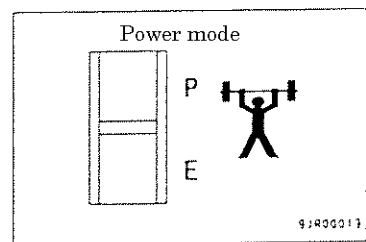

Fig-5